

# MAXIMUM™

## 45 L (12 U.S. Gallons)

### Wet/Dry Vacuum with High Performance Motor



Model no. 054-0253-0

#### **IMPORTANT:**

Please read this manual carefully before using this product, and save it for reference.

#### **INSTRUCTION MANUAL**

TABLE OF CONTENTS	PAGE
TECHNICAL SPECIFICATIONS	4
SAFETY GUIDELINES	5
KEY PARTS DIAGRAM	8
GENERAL ASSEMBLY INSTRUCTIONS	9
DRY VACUUM OPERATION	12
WET VACUUM OPERATION	14
BLOWER OPERATION	16
MAINTENANCE	17
CARTRIDGE FILTER	19
TROUBLESHOOTING	21
ACCESSORIES	22
EXPLODED VIEW	23
PARTS LIST	24
WARRANTY	25

**NOTE:** If any parts are missing or damaged, or if you have any questions, please call our toll-free helpline at 1-888-670-6682.



**SAVE THESE INSTRUCTIONS**  
This manual contains important safety and operating instructions. Read all instructions and follow them with use of this product.

**SPECIFICATIONS**

Tank size:	45 L (12 U.S. gallons / 10 Imperial gallons)
Peak horsepower:	6
Power:	120 V, 60 Hz, 11.8 A
Tank:	Polypropylene
Power cord:	20' (6 m)
Hose:	2 1/2" x 7' (6.4 cm x 2.1 m)
Water lift:	63" (160 cm) at end of hose
Air flow:	135 CFM at end of hose
Noise:	78 dBA
Filters:	Foam sleeve/wet filter, fine dust cartridge filter, fine dust high-efficiency collector bag
Weight:	21 lb 1 oz ( 9.53 kg)

**IMPORTANT SAFETY INSTRUCTIONS****Household Type****SAVE THIS MANUAL FOR FUTURE REFERENCE.**

- Read all instructions before using this appliance.
- Read and understand this instruction manual and all labels on the Wet/Dry Vacuum before using.
- Safety is a combination of common sense, staying alert and knowing how this Wet/Dry Vacuum works. Use this Wet/Dry Vacuum only as described in this manual. To reduce the risk of personal injury or damage to the Wet/Dry Vacuum, use only recommended accessories.

**Understanding Safety Terminology**

When using this Wet/Dry Vacuum follow basic safety precautions including the following:

To reduce the risk of fire, electric shock or injury:

- Do not run the Wet/Dry Vacuum unattended.
- Do not vacuum, or use this Wet/Dry Vacuum near liquids, gases, or explosive vapours like gasoline or similar fuels, lighter fluid, cleaners, oil-based paints, natural gas or hydrogen. Do not vacuum or use this Wet/Dry Vacuum near explosive dusts like coal dust, magnesium dust, grain dust, or gunpowder as sparks inside the motor can ignite flammable vapours or dust.
- Do not vacuum burning or smoking items such as cigarettes, matches, or hot ashes.
- Keep the cord away from heated surfaces.
- Do not expose to rain. Store indoors.
- Do not unplug by pulling on cord. To unplug, grasp the plug, not the cord.
- Do not use if the cord, plug or other parts are damaged.
- If the Wet/Dry Vacuum is not working correctly or has missing parts, has been dropped or damaged, left outdoors or dropped in water, return it to an independent service centre.

**DANGER!**

If safety information is not followed, someone will be seriously injured or killed.

**WARNING!**

If safety information is not followed, someone could be seriously injured or killed.

**CAUTION!**

If safety information is not followed, someone may be injured.

- Do not pull or carry by the cord. Do not use the cord as a handle, close a door on the cord, or pull the cord around sharp edges or corners.
- Do not run the Wet/Dry Vacuum over the cord.
- Do not handle the plug or the Wet/Dry Vacuum with wet hands.
- To reduce the risk of health hazards from vapours or dust, do not vacuum toxic materials.
- Do not use or store near hazardous materials.
- Do not use this Wet/Dry Vacuum with a torn filter or without installing the filter except when vacuuming liquids as described in the operation section of this manual.
- Do not use the Wet/Dry Vacuum as a toy. Pay particularly close attention when it is being used by or near children.
- To reduce the risk of injury from the Wet/Dry Vacuum accidentally starting, unplug the power cord before changing or cleaning the filter.
- Do not leave the Wet/Dry Vacuum unattended when it is plugged in. Unplug it from the power outlet when not in use and before servicing. Turn off the Wet/Dry Vacuum before unplugging.
- Do not put any objects into the ventilation openings. Do not vacuum with any ventilation openings blocked.
- Keep free of dust, lint, hair or any other items that may reduce the air flow.
- Keep hair, loose clothing, fingers, and all body parts away from openings and moving parts.
- To reduce the risk of falling, use extra care when cleaning on stairs.

#### When using as blower:

- Direct air discharge only at work area.
- Do not use Wet/Dry Vacuum as a sprayer.
- Do not direct air at bystanders.
- Keep children away when blowing.
- Wear safety goggles.

This Wet/Dry Vacuum is double-insulated, eliminating the need for a separate grounding system. Use only identical replacement parts. Read the servicing instructions before servicing the Wet/Dry Vacuum.

Use this Wet/Dry Vacuum only as described in this manual.

Observe the following warnings that appear on the motor housing of this Wet/Dry Vacuum.

 **DOUBLE INSULATED. GROUNDING NOT REQUIRED. WHEN SERVICING USE ONLY IDENTICAL REPLACEMENT PARTS.**



## WARNING!

For your own safety, read and understand this instruction manual. Do not operate unattended. Do not use this Wet/Dry Vacuum to pick up hot ashes, coals, toxic, flammable or other hazardous materials. Do not use near explosive liquids or vapours.



## WARNING!

To reduce the risk of electric shock, do not expose to rain. Store indoors.



## CAUTION!

Do not vacuum drywall dust or cold fireplace soot or ash with a standard wet/dry filter. This dust is very fine and hence will not be captured by the filter and may cause damage. Refer to the operation section for proper filter selection.



## CAUTION!

To reduce the risk of injury from moving parts, unplug before servicing.

### SERVICING OF DOUBLE-INSULATED WET/DRY VACUUM.

In a double-insulated Wet/Dry Vacuum, two systems of insulation are provided instead of grounding. No method of grounding is provided on a double-insulated appliance, nor should one be added. Servicing a double-insulated Wet/Dry Vacuum requires extreme care and knowledge of the system, and should be done only by qualified service personnel. Replacement parts for a double-insulated Wet/Dry Vacuum must be identical to the parts that are being replaced. This Wet/Dry Vacuum is marked with the words "DOUBLE INSULATED" and the symbol  may also be marked on the appliance.

- For household use only.
- To reduce the risk of electric shock, unplug before cleaning or servicing.
- DO NOT use without filters in place.
- To reduce the risk of electric shock, use indoors only.

### POLARIZATION

To reduce the risk of electric shock, this appliance has a polarized plug (one blade is wider than the other). This plug will fit in a polarized outlet only one way. If the plug does not fit fully in the outlet, reverse the plug. If it still does not fit, contact a qualified electrician to install the proper outlet. Do not change the plug in any way.

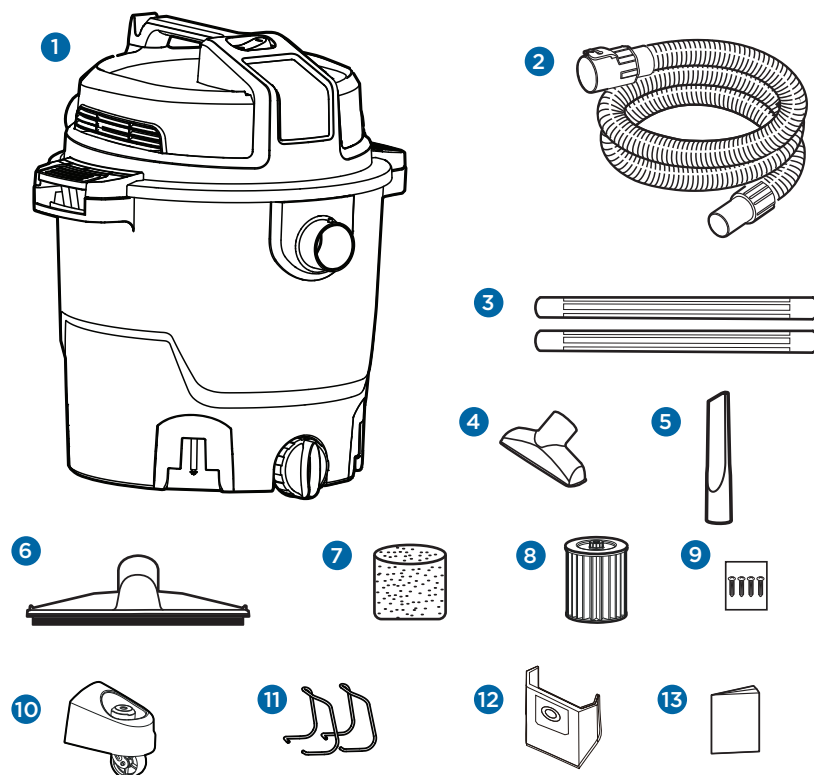

No.	Description
1	Vacuum Assembly
2	Hose
3	Extension Wands x 2
4	Utility Nozzle
5	Crevice Tool
6	Floor Squeegee Nozzle
7	Foam Sleeve Filter
8	Cartridge Filter
9	Caster Assembly Screws x 4
10	Caster Feet Assemblies x 4
11	Hose Storage Rack x 2
12	Dust bag
13	Operator's Manual

## GENERAL ASSEMBLY INSTRUCTIONS

A cross-head screwdriver is required. 

- 1 Ensure that the power cord is disconnected from the power outlet.

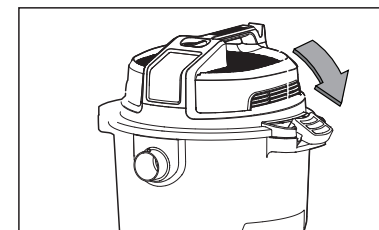
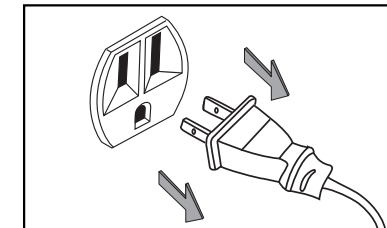

- 2 Undo the clasps.

- 3 Lift the top section off the tank.

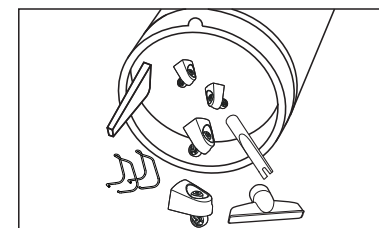
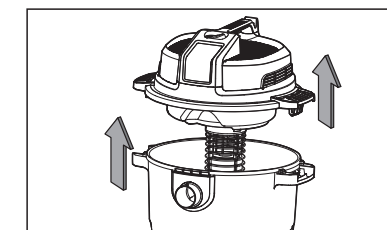

- 4 Remove the contents from inside the tank.



### WARNING!

Do not plug in power cord to power outlet. Make sure plug is disconnected before assembling the Wet/Dry Vacuum.

- 5 With the power head removed, turn the collection tank upside down. Insert the four caster assemblies into each socket. Apply pressure until caster assemblies are fully seated. Secure them with the screws provided. Do not over-tighten the screws.

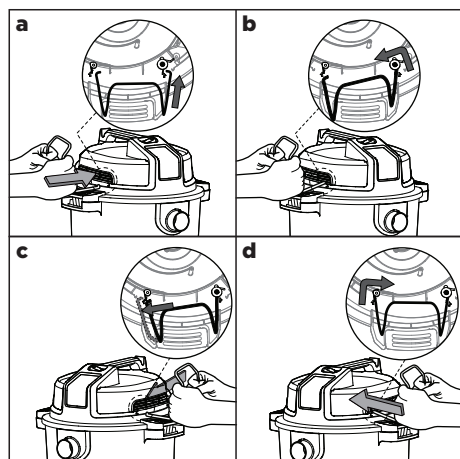
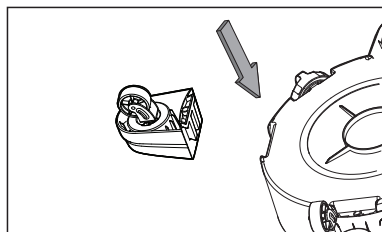

- 6 Position the hose storage rack as illustrated. Fully insert one end of the hose storage rack into the slot illustrated by the arrow, then pull the other end of the hose storage rack to align with the corresponding arrow and insert into the slot until it is secured in place.

- 7 For dry vacuum cleaning, install the supplied cartridge filter and dust bag.

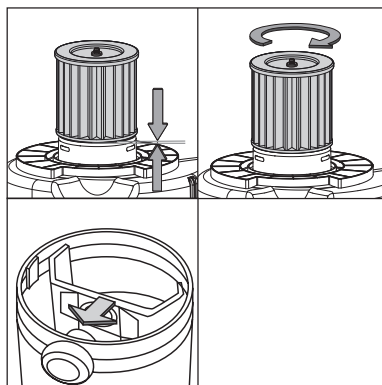

- 8 For wet vacuum cleaning, install the supplied foam filter.

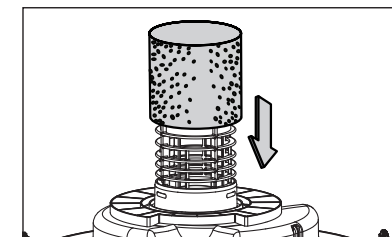

- 9 Replace the top section on the tank.

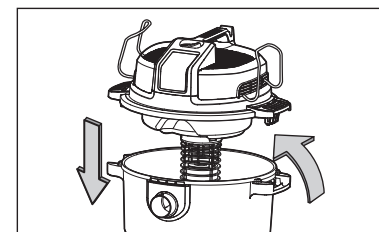

- 10 Secure into place using the 2 side latches.

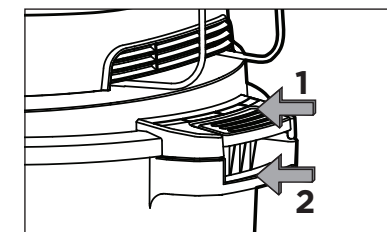

- 11 Insert the locking end of the hose into the port on the collection tank and turn to lock into place.

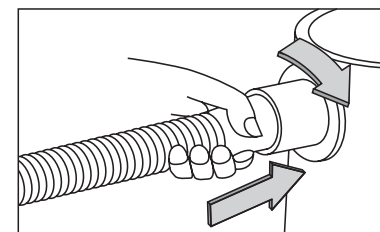

- 12 Choose the desired accessory and insert onto the end of the hose.

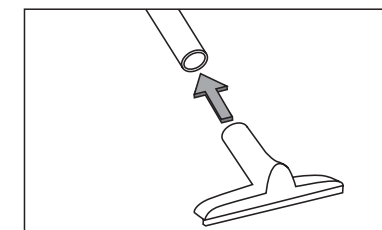

# OPERATING INSTRUCTIONS – DRY VACUUMING

- 1 Ensure that the power cord is disconnected from the outlet.

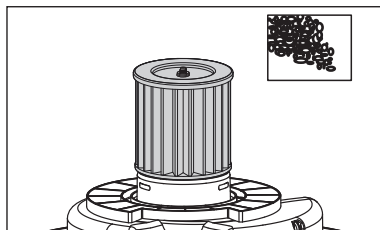
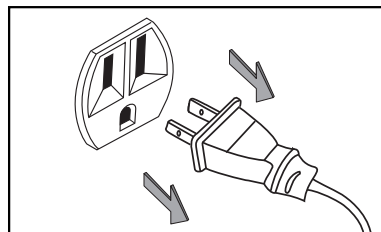

- 2 Ensure that the cartridge filter is completely mounted. Ensure that the filter is inserted all the way.

- 3 Replace the top section on the tank, and secure it in place using the clasps.

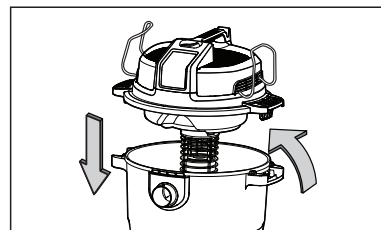

- 4 Insert the locking end of the hose into the vacuum port and lock in place.

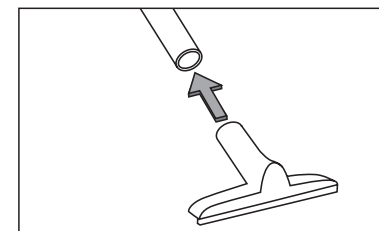
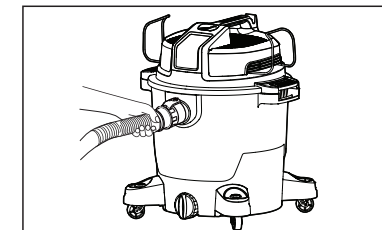

- 5 Choose the desired accessory and insert onto the end of the hose.

- 6 Plug the power cord into the power outlet.

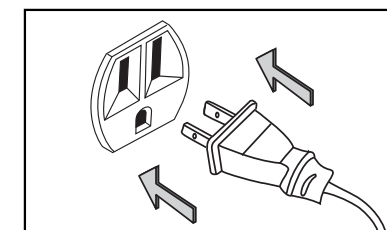

- 7 Turn the motor on by pressing the power switch to the “I” (ON) position and begin vacuuming.

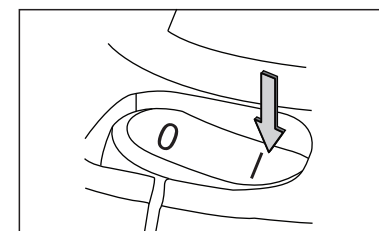

- 8 Once you have finished vacuuming, flip the switch to the “O” position and unplug the power cord from the power outlet.

**DO NOT USE THE CARTRIDGE FILTER FOR LIQUID VACUUMING.**  
**DO NOT USE DUST BAG FOR LIQUID VACUUMING.**  
**O = OFF    I = ON**



## WARNING!

Before starting please read, understand, and apply the safety instructions in Section 1. Reminder: **DO NOT** vacuum hazardous substances. The use of an incorrect dust bag will invalidate the warranty.



# OPERATING INSTRUCTIONS - WET VACUUMING

- 1 Ensure that the power cord is disconnected from the power outlet. Ensure that the tank is clean and free of dust and dirt.

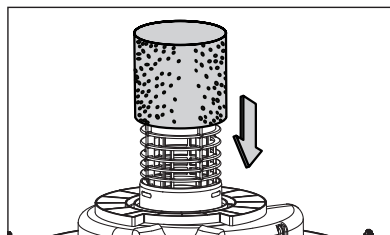
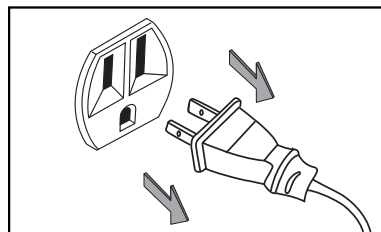

- 2 Remove the cartridge filter and install a foam filter over the filter basket and place the top section back on the tank. **DO NOT USE THE CARTRIDGE FILTER FOR LIQUID VACUUMING.**

- 3 Fit the desired nozzle to the vacuum hose.

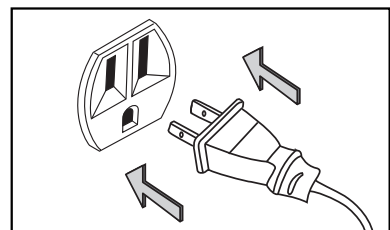
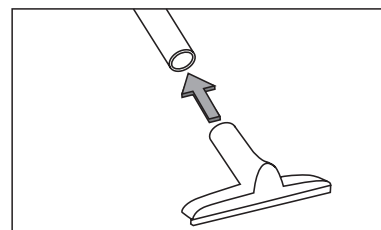

- 4 Ensure that the switch is in the "O" (OFF) position before plugging the power cord into the power outlet.

- 5 Turn the motor on by pressing the switch to the "I" ON position.

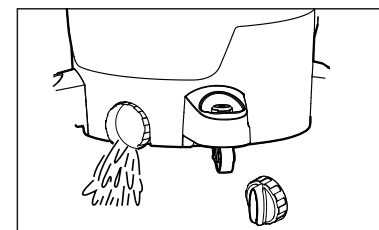
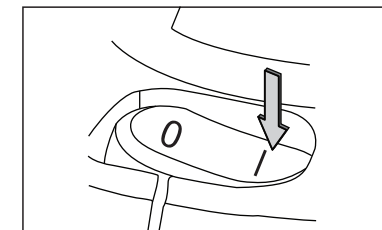

- 6 After use, empty the collection tank by unscrewing the drain cap and drain liquids into suitable receptacle or drain. Remember to refit the drain cap to the tank after draining.



## WARNING!

Before starting ensure to read, understand, and apply the safety instructions in section 1. Reminder: do not vacuum hazardous substances.



## IMPORTANT!

When vacuuming large quantities of liquids, do not immerse the nozzle completely in the liquid; leave a gap at the tip of the nozzle opening to allow air inflow. The machine is fitted with a float valve that stops the suction action when the collection tank reaches its maximum capacity. You will notice an increase in motor speed. When this happens, turn off the machine, disconnect from power supply, and drain the liquid into a suitable receptacle or drain. To continue vacuuming, refit the collection tank with the drain cap. After wet vacuuming, turn the machine off and remove plug from power supply. Empty the collection tank, clean and dry the inside and outside before storage.



## REMEMBER!

The foam filter must be removed after wet vacuuming, and a cartridge filter must be installed before dry vacuuming again.



This Wet/Dry Vacuum has blowing capabilities. To use the blower feature follow the instructions listed.

- 1 Remove hose from the vacuum port. Insert the large end of the hose into the blower connection in the top of the motor housing.

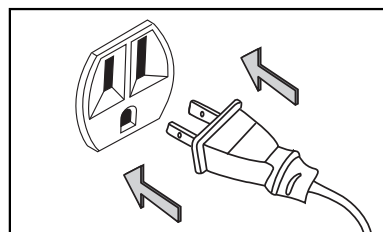
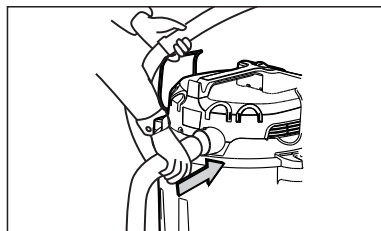

- 3 Switch on the power.

- 2 Ensure the power switch is turned off and plug in the power supply.

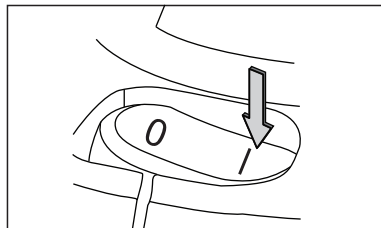

- 4 The unit will now blow through the vacuum hose and can be used to clear obstructions within the hose.

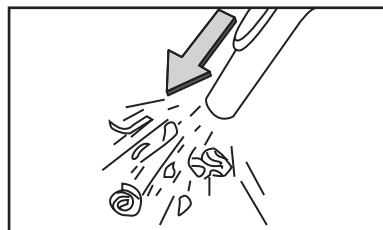

### WARNING!

Keep bystanders clear of blowing debris. Wear a dust mask if blowing creates dust that might be inhaled.



### WARNING!

If after a few seconds the hose continues to be blocked, turn off the unit and clear the hose manually.

## Emptying the Collection Tank

- 1 Ensure that the power cord is disconnected from the outlet.

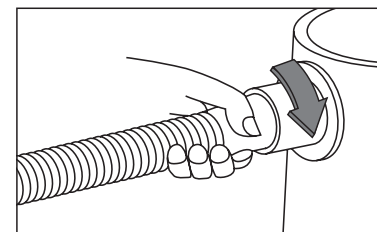
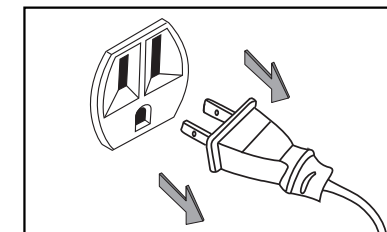

- 2 Disconnect the hose from the tank.

- 3 Undo the latches and remove the power head from the collection tank. Place power head on a soft, clean surface upside down.

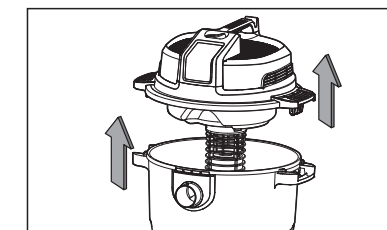

- 4 Clear all dirt or debris from the collection tank and hose into a proper waste container.

5 Clean the foam filter by washing it with a mild soapy solution.

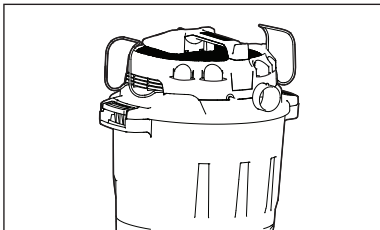
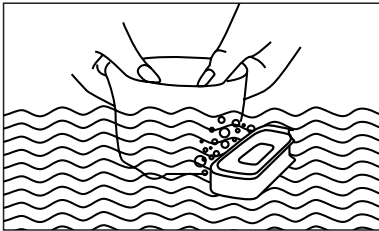

6 Check the hose, attachments and the power cord to ensure that they have not been damaged.

REPLACEMENT FILTERS

- Replace filters regularly.
- Foam Sleeve / Wet Filter (054-0035)
  - Dry Reusable Filter (054-0148)
  - Household Collector Bag (054-0003)
  - Fine Dust High Eff. Collector Bag (054-0214)
  - Fine Cartridge Filter (054-0255)
  - Regular Cartridge Filter (054-0008)
  - Hepa Cartridge Filter (054-0159)



**IMPORTANT!**  
CLEAN THE CARTRIDGE FILTER REGULARLY. IF THE MACHINE IS USED WITHOUT THE CARTRIDGE FILTER, THE MOTOR WILL BURN OUT AND THE WARRANTY WILL BE VOIDED. ALWAYS ENSURE TO KEEP SPARE FILTERS HANDY.

MAINTENANCE

Installation and cleaning

1 Slide cartridge filter down over filter cage.

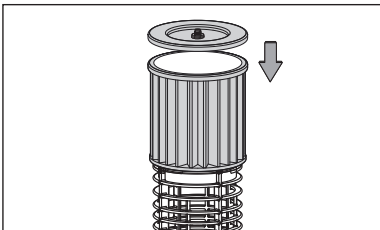
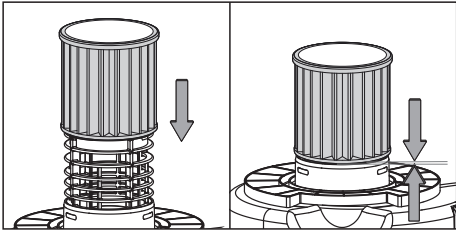

2 Place retainer on top of cartridge filter against hole of basket.

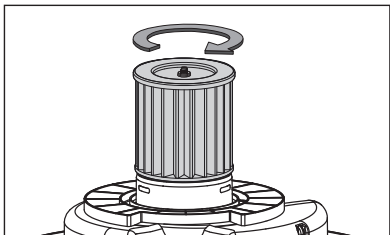

3 To secure filter, put on retainer nut and turn clockwise to tighten until snug. Do not over-tighten.



**NOTICE!**  
The filter included is made of high-quality material designed to stop small dust particles. The filter should be used for dry pick-up only. A dry filter is necessary to pick up dust. If the dust filter is wet, it will clog quickly and be very difficult to clean. Handle the filter carefully when removing it for cleaning and replacing it. Check the filters for tears or small holes; a small hole can let dust pass through and out of the cleaner. Do not use a filter with holes or tears; replace it immediately.

4 To remove filter for cleaning again, hold lid assembly with one hand and turn retainer counter-clockwise.

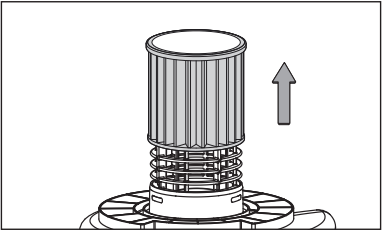
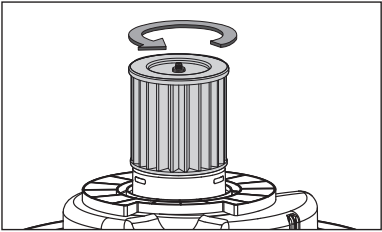

5 Slide cartridge filter off filter cage.

6 Clean filter by tapping it on inside of trash can. Clean filter by rinsing from the inside.

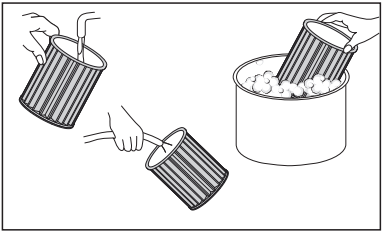

7 When wet (to prevent mould and/or mildew build-up), the cartridge filter should be moved and allowed to air-dry for a 24-hour period before being re-installed back onto the filter cage.



**WARNING!**

Always disconnect the plug from the power outlet before removing the power head from the collection tank.



**IMPORTANT!**

Clean or change the cartridge filter regularly for best performance. ALWAYS USE CARTRIDGE FILTER FOR DRY VACUUMING. If the machine is used without the cartridge filter, the motor will burn out and the warranty will be voided. Always keep spare filters on-hand.

Problem	Possible Causes	Corrective Action
Wet/Dry Vacuum will not operate.	No power supply.	Check power supply: cord, breakers, fuses.
	Faulty power cord.	Check the power cord and repair or replace as necessary.
	Tank is full of liquid.	Empty tank.
Motor cover emits dust.	The cartridge filter is missing or damaged.	Attach or replace the cartridge filter.
Reduced efficiency and motor/speed vibration.	Blockage in the nozzle, hose or the tank inlet.	Check the nozzle, the hose and the tank or filter inlet for blockage.
	Filter may be blocked by fine dust.	Remove the filter, wash and clean it. Do not reuse until it is completely dry. Use a new filter if necessary.

Additional accessories for your Maximum™ Wet/Dry Vacuum are available. Following up f ts when used with adapter, included with hose or vacuum.

Consumables	
054-0035	Foam Sleeve / Wet Filter
054-0148	Dry Reusable Filter
054-0003	Household Collector Bag
054-0214	Fine Dust High Efficiency Collector Bag
054-0255	Fine Cartridge Filter
054-0008	Regular Cartridge Filter
054-0159	Hepa Cartridge Filter

2 1/2" Accessories	
054-0013-2	Dusting Nozzle
054-0004-4	Crevice Tool
054-0033-4	Car Nozzle
054-0039-2	Wand
054-0049-8	Utility Nozzle
054-0054-4	Wet Nozzle
054-0057-8	Connector
054-0058-6	Floor Brush
054-0068-2	Detailing Kit
054-0074-6	Carpet Nozzle
054-0079-6	Claw Nozzle
054-0080-0	Adaptor
054-0081-8	Filter Nut

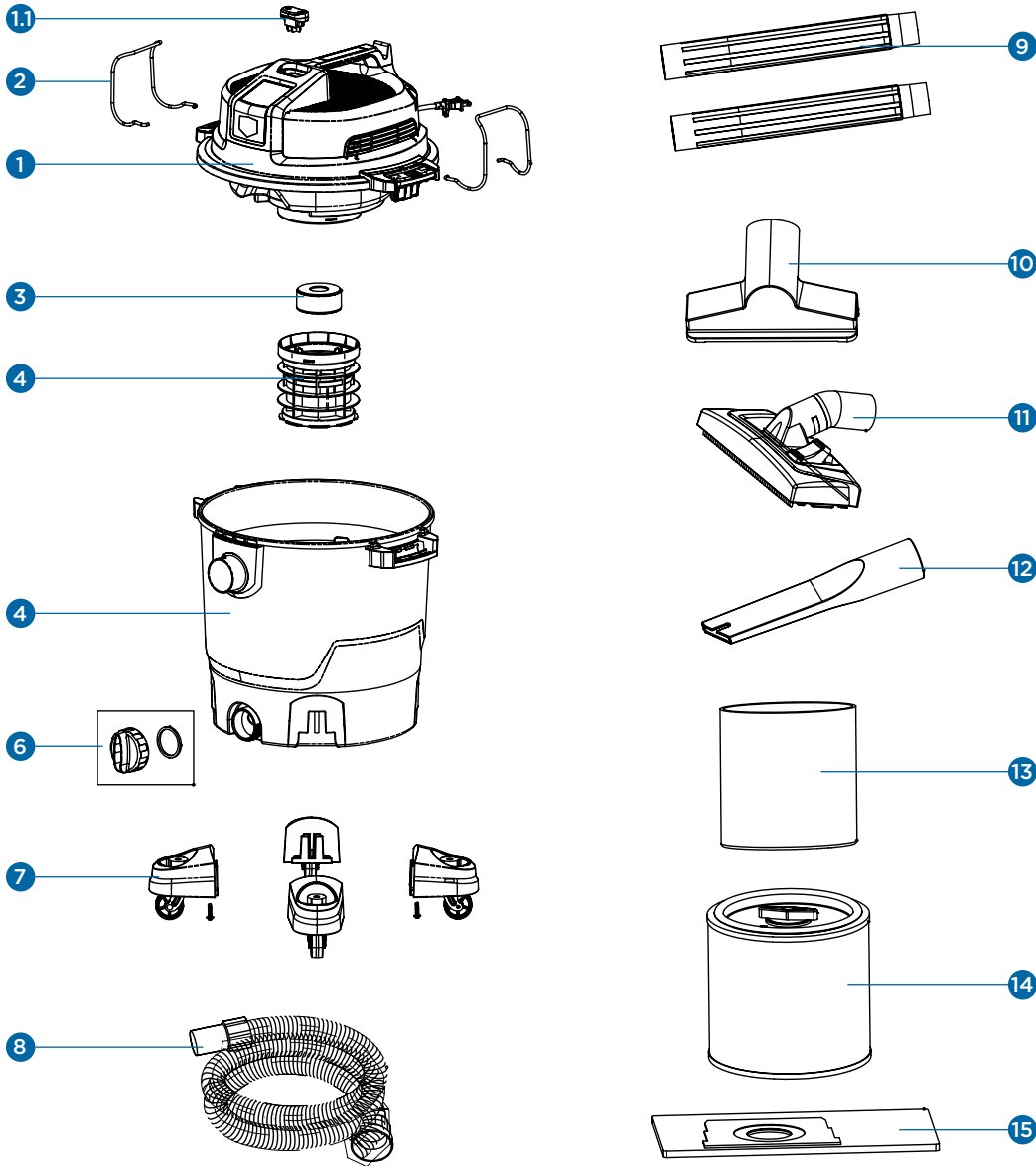

No.	Description
1	Power Head Assembly
1.1	Switch
2	Wire Form Hose Storage x 2
3	Float
4	Filter Cage
5	Tank
6	Drain Cap
7	Caster Foot Assembly x 4
8	Hose
9	Extension Wand x 2
10	Utility Nozzle
11	Floor Brush/Squeegee
12	Crevice Tool
13	Foam Sleeve Filter
14	Cartridge Filter
15	Dust Collection Bag

If any parts are missing or damaged, or if you have any questions, please call the Toll-free Helpline, at 1-888-670-6682.

3-Year Limited Warranty

This MAXIMUM product is guaranteed for a period of 3 years from the date of original retail purchase against defects in workmanship and materials.

Subject to the conditions and limitations described below, this product, if returned to us with proof of purchase within the stated warranty period and if covered under this warranty, will be repaired or replaced (with the same model, or one of equal value or specification), at the sole discretion of the Maximum Canada authorised repair centre (“Service Provider”). We will bear the cost of any repair or replacement and any costs of labour relating thereto.

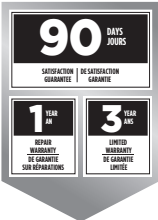

These warranties are subject to the following conditions and limitations:\*

- a) A bill of sale verifying the purchase and purchase date must be provided;
- b) defects in workmanship and material to be assessed and determined by the Service Provider;
- c) This warranty will not apply to any product or part thereof which is worn or broken or which has become inoperative due to abuse, misuse, accidental damage, neglect or lack of proper installation, operation or maintenance (as outlined in the applicable owner’s manual or operating instructions);
- d) This warranty does not apply to normal wear and tear or to expendable parts or accessories (including hose attachments and filters) that may be supplied with the product that by their nature have a limited life span and are expected to become inoperative or unusable after a reasonable period of use;
- e) This warranty will not apply to routine maintenance and consumable items such as, but not limited to, fuel, lubricants, vacuum bags, blades, belts, sandpaper, bits, fluids, rubber o-rings, tune-ups or adjustments;
- f) This warranty excludes the following components that may accompany your product:
  - (1) The carrying case, which is only for a period of 1-year from the date of original retail purchase against defects in workmanship and materials.
  - (2) Accessories, including hose attachments and filters, which do not carry a warranty of any kind.
- g) This warranty will not apply where damage is caused by repairs made or attempted by others (i.e. persons not authorized by the manufacturer), and any such unauthorized repairs or attempted repairs shall void this warranty in its entirety;
- h) This warranty will not apply to any parts other than original parts, except to the extent that the retailer or manufacturer or persons authorized by either of them have repaired or replaced them;
- i) This warranty will not apply to any product that was sold to the original purchaser as a reconditioned or refurbished product (unless otherwise specified in writing);
- j) This warranty will not apply to any product or part thereof if any part from another manufacturer is installed therein or any repairs or alterations have been made or attempted by unauthorized persons;
- k) This warranty will not apply to normal deterioration of the exterior finish, such as,

- but not limited to, scratches, dents, paint chips, or to any corrosion or discolouring by heat, abrasive and chemical cleaners; and
- l) This warranty will not apply to component parts sold by and identified as the product of another company, which shall be covered under that product manufacturer's warranty, if any;
  - m) Any products replaced by the retailer in attempt to fulfill warranty obligations is subject to the original product warranty conditions and related time period as initiated by the original date of purchase; if product is purchased in Quebec, the warranty term will be extended for a period equal to the time during which the Quebec retailer possesses the product in attempt to fulfill warranty obligations; replaced product will not default to new product warranty conditions; and
  - n) The retailer and manufacturer's sole obligation and the purchaser's sole remedy under this warranty shall be as set out herein. The warranties contained herein are not transferable and are given only to the purchaser. FURTHER, THE WARRANTIES SET OUT HEREIN ARE IN LIEU OF ALL OTHER WARRANTIES OR CONDITIONS, WHETHER EXPRESS, IMPLIED OR STATUTORY (INCLUDING SUCH AS ARISE UNDER THE SALE OF GOODS ACT OR THE INTERNATIONAL SALE OF GOODS ACT), ARISING OUT OF A COURSE OF DEALING OR USAGE OF TRADE OR OTHERWISE, INCLUDING, SUBJECT TO APPLICABLE LAW, ANY IMPLIED WARRANTIES OR CONDITIONS OF MERCHANTABILITY, MERCHANTABLE QUALITY, FITNESS OR ADEQUACY FOR A PARTICULAR PURPOSE OR USE, AND ALL OTHER SUCH WARRANTIES ARE EXPRESSLY DISCLAIMED BY THE RETAILER AND MANUFACTURER.

### Additional Limitations

This warranty applies only to the original purchaser and may not be transferred.

This warranty applies for a period of 3 years from the date of original retail purchase, as indicated on the bill of sale.

Neither the retailer, Maximum Canada, nor the manufacturer shall be liable for any other expense, loss or damage, including, without limitation, any indirect, incidental, consequential or exemplary damages arising in connection with the sale, use or inability to use this product.

Under no circumstances shall the retailer, Maximum Canada, or manufacturer be liable to the purchaser for any claim for (a) indirect, special, punitive, incidental, exemplary, or consequential damages, (b) compensation for loss of profits, anticipated revenue, savings or goodwill, or other economic loss of the purchaser, (c) exemplary, aggravated or punitive damages howsoever incurred, (d) contribution or set-off in respect of any claims against the purchaser, (e) any damages whatsoever relating to third party products or services or the purchaser's materials, or (f) any damages whatsoever relating to interruption, delays, errors or omissions; in each case under any theory of law or equity, arising out of or in any way related to this warranty, even if advised of the possibility thereof. Notwithstanding any provision herein or entitlement

of the purchaser at law, in equity or otherwise, in no event shall the liability of the retailer or manufacturer under this warranty, whether in contract, tort, product liability or otherwise, exceed, in the aggregate, the amount paid by the purchaser to the retailer for the product to which this warranty applies.

### \*Notice to consumer

This warranty gives you specific legal rights, and you may have other rights, which may vary from province to province. The provisions contained in this warranty are not intended to limit, modify, take away from, disclaim or exclude any statutory warranties set forth in any applicable provincial or federal legislation.

In addition to the 3-Year Limited Warranty, this MAXIMUM product is covered by our:

### 1-Year Repair Warranty

Maximum Canada will maintain this product and replace critical parts which have worn beyond reasonable use through normal use of such product, any time during the first year after purchase.

The following are excluded from this 1-Year Repair Warranty:

- a) Missing or damaged parts or components that are a result of abuse or misuse;
- b) Any wear and tear to non-critical parts or accessories that do not affect the core function of the product.

### 90-Day Satisfaction Guarantee

If you are not completely satisfied with the performance of your MAXIMUM product for any reason, you can return it within 90 days from the date of purchase with proof of purchase for exchange or a full refund.

Made in China

Imported by  
MAXIMUM Canada Toronto, Canada M4S 2B8