

INSTRUCTION MANUAL

ASPEN 46-INCH CEILING FAN

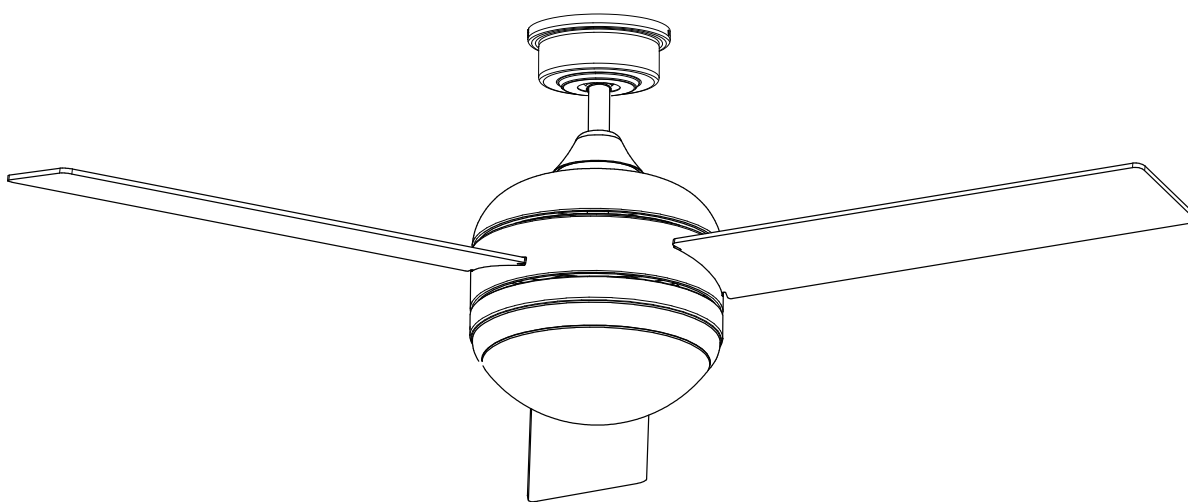

Questions, problems, missing parts? Before returning to the store,
call CANARMNA Customer Service
8 a.m. - 5 p.m., EST, Monday-Friday.

1-800-265-1833

ressalescanada@canarmna.ca

IMPORTANT: Please read and understand this manual before any assembly. Before beginning assembly of product, make sure all parts are present. Compare parts with packaging contents list.

Table of Contents

Table of Contents	2	Assembly	6
Safety Information	2	Operation	11
Warranty	3	Troubleshooting	12
Pre-Installation	3	Maintenance	13
Installation	6		

Safety Information

READ AND SAVE THESE INSTRUCTIONS.

1. Turn off power at main electrical service box before starting installation. ¹⁴
2. Electrical connections must comply with local code ordinances, national electrical codes, CEC, NEC and ANSI/NFPA 70. ¹³
3. Make sure the installation site you choose allows the fan blades to rotate freely without any obstructions.
4. When mounting the fan on a ceiling outlet box, Use an approved (CSA for Canada and UL for U.S.) ceiling fan box marked "FOR FAN SUPPORT". Ensure the outlet box is securely installed in place such that it is able to support at least the fan weight.
5. **WARNING:** To reduce the risk of fire, electric shock, or other personal injury, mount fan only on an outlet box or supporting system marked acceptable for fan support of 35 lbs (15,9 kg) or less and use the mounting screws provided with the outlet box. Most outlet boxes commonly used for the support of lighting fixtures are not acceptable for fan support and may need to be replaced. Consult a qualified electrician if in doubt.
6. All set screws must be checked and retightened where necessary before installation.
7. The fixing means for attachment to the ceiling such as hooks or other devices shall be fixed with a sufficient strength to withstand 4 times the weight of the ceiling fan. ⁷
8. The mounting of the suspension system shall be performed by the manufacturer, its service agent or suitably qualified persons. ⁸
9. This ceiling fan is pre-built with luminaire. Do not use any other luminaire for this fan. ⁹
10. This appliance is not intended for use by persons (including children) with reduced physical, sensory or mental capabilities, or lack of experience and knowledge, unless they have been given supervision or instruction concerning use of the appliance by a person responsible for their safety. ¹
11. Children should be supervised to ensure that they do not play with the appliance. ²



WARNING: To reduce the risk of personal injury, DO NOT bend the blade brackets when installing the brackets, balancing the blades or cleaning the fan. Also, DO NOT insert foreign objects in between rotating fan blades. ¹⁰



WARNING: To reduce the risk of fire, electric shock, or personal injury, mount to outlet box marked acceptable for fan support and use mounting Screws provided with the outlet box. ¹¹



WARNING: Mount with the lowest moving parts at least 2.10 Meters (7 Feet) above floor or grade level.



WARNING: DO NOT operate reversing switch while fan blades are in motion. Fan must be turn off and rotating blades stopped completely, operate reverse switch and then operate speed switch for the opposite direction.



WARNING: Direct wiring to an external variable speed wall control or dimmer switch of this fan and or external light kit will void warranty and make fan and light inoperable

Warranty

5 YEAR LIMITED WARRANTY

“Thank you” for purchasing our product. It is our policy to furnish you with high quality products at a fair price. With proper installation your fan should provide you with years of money saving comfort.

This fan is guaranteed to be free from defects in workmanship and Material for a period of five (5) years from date of purchase. Within the first (1) year from date of purchase any defective product should be returned to your **RETAIL OUTLET** along with proof of purchase. For the balance of the warranty, four (4) years, the **MOTOR WINDINGS ONLY** shall be free of defects. We will correct such defects or replace the motor assembly at our option if the product is returned, **FREIGHT PREPAID**, to us. The returned fan must be accompanied by your proof of purchase and a cheque for \$20.00 for handling and labour charges. All costs of removing and re-installing the product are **YOUR RESPONSIBILITY** damage to any part as such by accident, misuse, improper installation or by affixing any accessories **IS NOT** covered by this warranty. As a result of varying climatic conditions in your area this warranty does not cover any changes in finishes, including rusting, pitting, corroding, tarnishing or peeling. **WARRANTY VOID: In cases of alteration, abuse, installation not in accordance with instructions or REMOVAL Of the CSA Sticker.**

Pre-Installation

SPECIFICATIONS

Size	Speed	Volts	Amps	Watts	RPM	CFM	Net Weight	Gross Weight	Cube Feet
46 in.	Low	120	0.22	15.0	99	1928	15.43 lb (7.0 kg)	17.19 lb (7.8 kg)	1.81 cu.ft.
	Medium		0.28	25	143	2657			
	High		0.34	39.4	181	3364			



NOTE: These are approximate measures. They do not include the amps and wattage used by the light kit.

TOOLS REQUIRED



Phillips
screwdriver



Flat blade
screwdriver



Adjustable
wrench



Electrical
tape



Wire
cutter /
stripper



Step ladder

Pre-Installation (continued)

HARDWARE INCLUDED



NOTE: Hardware not shown to actual size.

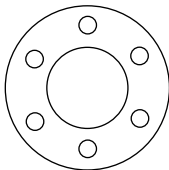

AA



BB



CC



DD



EE



FF



GG

Part	Description	Quantity
AA	Rubber bushing	1
BB	Rubber gasket	2
CC	J-Hook	1
DD	Metal washer	10
EE	Fiber washer	10
FF	Blade bracket screw	10
GG	Temporary hook	1

PACKAGE CONTENTS

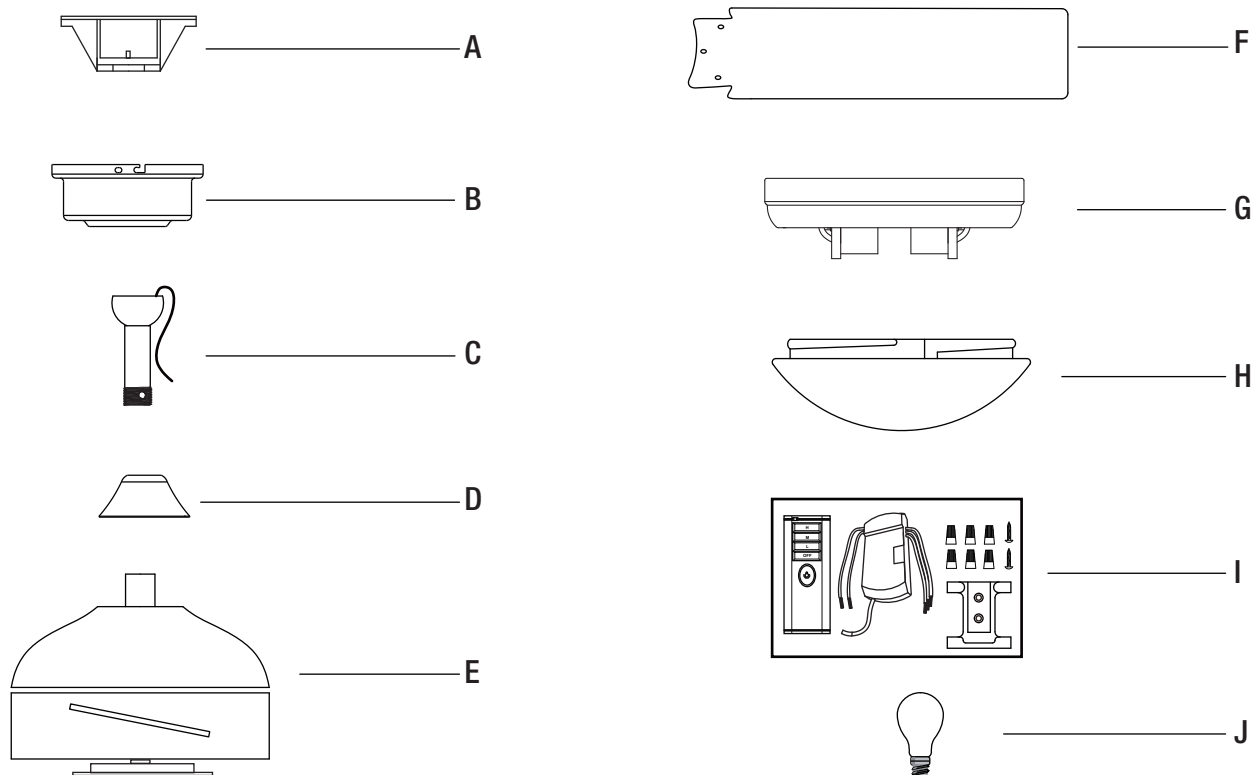

Part	Description	Quantity
A	Mounting bracket c/w ground wire	1
B	Ceiling canopy	1
C	Ball/Downrod assembly	1
D	Yoke cover	1
E	Motor assembly	1

Part	Description	Quantity
F	Blade	3
G	Light kit	1
H	Glass	1
I	Remote control (Includes Transmitter & Receiver & Wire nuts & screws & Wall bracket)	1
J	Bulb	2

Assembly

1 MOUNTING BLADES TO MOTOR

- Attach the blades (F) to the fan motor (E) assembly using the blade bracket screws (FF), metal washers (DD) and fiber washers (EE).

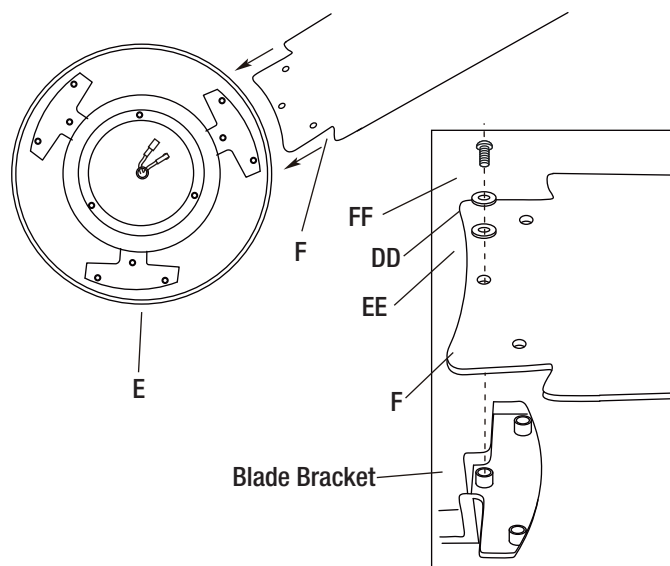

2 INSTALLING THE LIGHT KIT

- Remove light kit screws and washers.
- Connect polarized connectors of light kit (G) to corresponding connectors found in switch housing.
- Carefully tuck electrical wires back into switch housing, align light kit (G) with switch housing and secure with three light kit screws and washers.

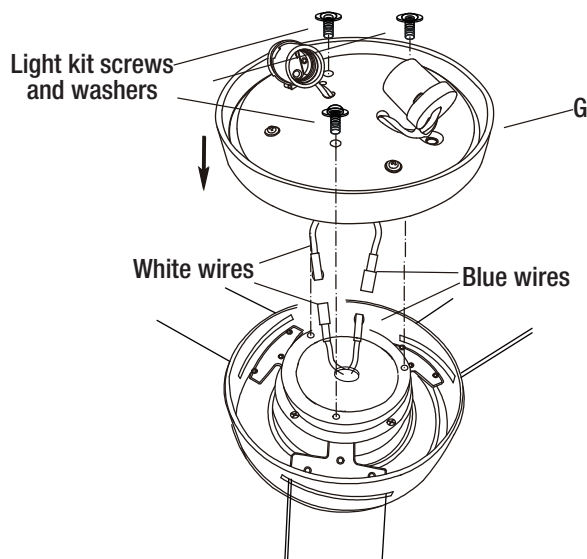

3 PREPARING FOR MOUNTING

- Release the mounting bracket (A) from the canopy (B) by removing the two screws (marked "a" on diagram) and washers, and loosening the two screws (marked "b" on diagram) and washers.

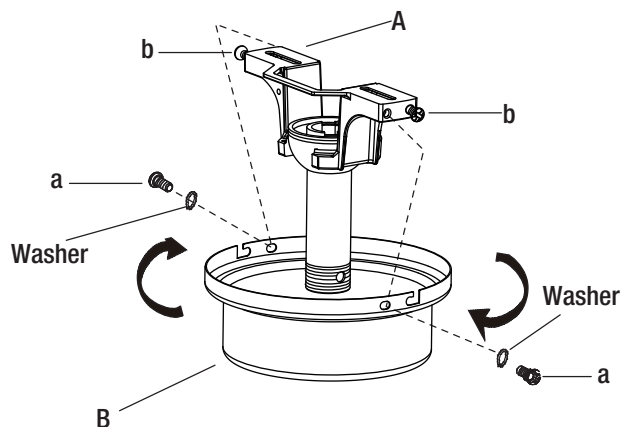

4 ASSEMBLING THE FAN

a DOWNROD MOUNT

- Remove the hemisphere from downrod (C) by loosening the hemisphere jam screw and lock pin.
- Remove bolt, flat and cotter pin from the yoke. Slightly loosening the 2 jam screws on the yoke.
- Route the wires and safety cable through the downrod (C) and screw the downrod (C) into the yoke and align holes for the bolt to go through. **Ensure not to damage the wires.** Place the flat washer and cotter pin to lock the bolt. Re-tighten the 2 jam screws on the yoke.

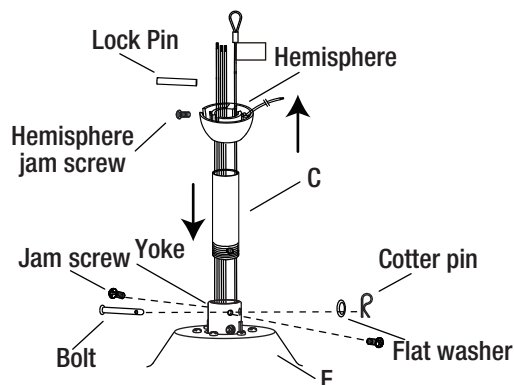

Assembly (continued)

a DOWNROD MOUNT (continued)

- Slide the yoke cover (D), rubber ring and canopy (B) into the downrod (C).
- Re-attach the hemisphere into the downrod (C). Insert the lock pin through the hole of downrod (C) and put the lock pin in place on the hemisphere.
- Tighten the hemisphere jam screw against the downrod (C).

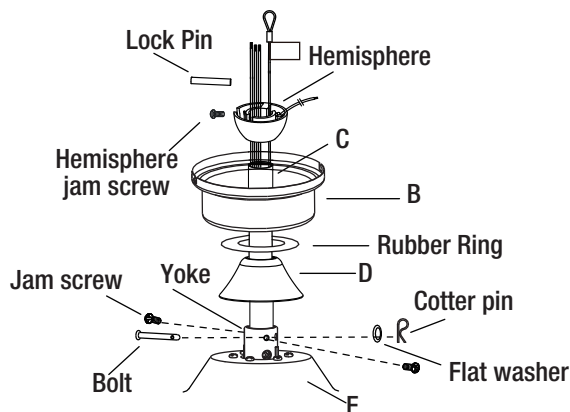

b FLUSH MOUNT

- Remove the rubber ring from the canopy (B).

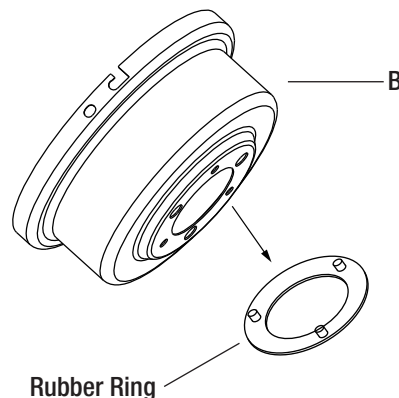

- Remove the yoke screws and lock washers which correspond to the holes in the canopy (B).
- Place canopy (B) on fan housing by aligning 3 larger holes of canopy (B) over 3 existing screws on the motor housing. Secure canopy (B) to motor (E) housing by placing 3 screws and washers (supplied in hardware package) in the 3 smaller holes in the canopy (B). Ensure to place the rubber bushing (AA) between the canopy (B) and motor (E).

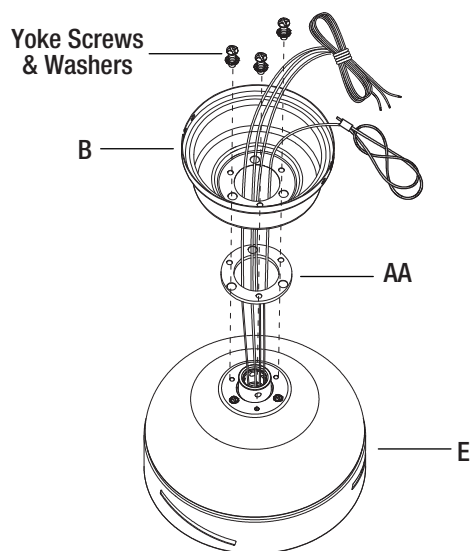

5 INSTALLING THE MOUNTING BRACKET



WARNING: To Reduce The Risk Of Fire, Electric Shock, Or Personal Injury, Mount To UL/CSA Listed Outlet Box Marked Acceptable for Fan Support And Use Mounting Screws Provided With The Outlet Box.

a DOWNROD MOUNT

- Install the J-Hook (CC) through center of the outlet box and into the wood joist.
- Secure the mounting bracket (A) and rubber gaskets (BB) to the outlet box.
- Hang downrod mount, fan on mounting bracket (A) by aligning tab on mounting bracket (A) with groove in hanger ball on downrod.
- Hang the fan on the mounting bracket (A).

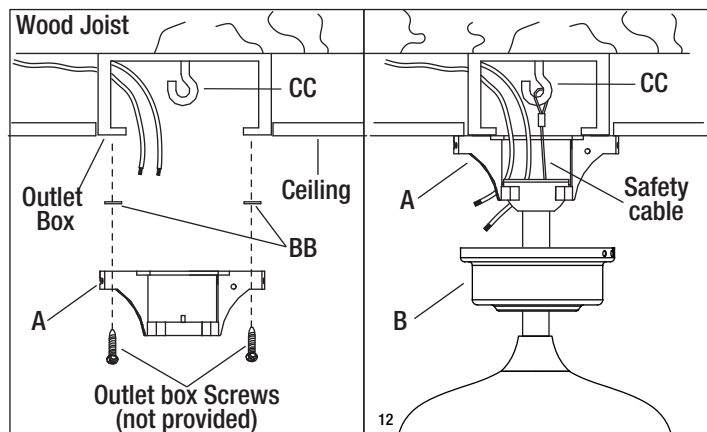

Assembly (continued)

b FLUSH MOUNT

- ❑ Install the J-Hook (CC) through the center of the outlet box and into the wood joist.
- ❑ Secure the mounting bracket (A) and rubber gaskets (BB) to the outlet box.
- ❑ Hang the safety cable onto the J-hook (CC).
- ❑ Hang the temporary hook (GG) on the mounting bracket (A). Hang the fan on the temporary hook (GG).

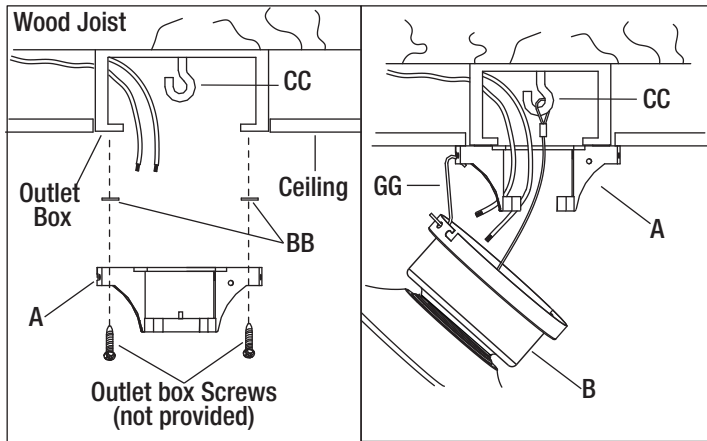

6 ENGAGING THE HEMISPHERE (Downrod Mount Only)

- ❑ Carefully rotate the fan assembly until the groove in the hemisphere locks over the tab of the mounting bracket (A) assembly.



WARNING: Failure to seat the tab in the groove could cause damage to electrical wires and possible shock or fire hazard.

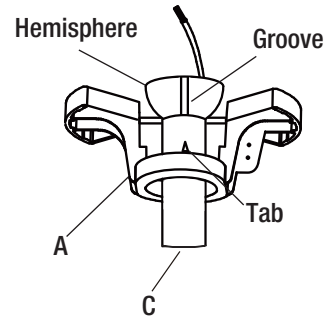

NOTE: When installing the fan on a sloped ceiling, make sure the tab on the hanger bracket faces towards the top of the slope. Depending on the slope, a longer downrod may be required to prevent fan blades from hitting the ceiling.

7 ELECTRICAL HOOK-UP

Direct wiring to an external variable speed wall control or dimmer switch of this fan and or external light kit will void warranty and make fan and light inoperable.

- a**
- ❑ Make the following wire connections to the receiver unit using the wire nuts supplied.
 - ❑ Connect GREEN fan wire to BARE (ground) wire.
 - ❑ Connect BLACK receiver unit wire to BLACK supply wire.
 - ❑ Connect WHITE receiver unit wire to WHITE supply wire.
 - ❑ Connect WHITE receiver unit wire (MOTOR N) to WHITE fan wire.
 - ❑ Connect BLACK receiver unit wire (MOTOR L) to BLACK fan wire.
 - ❑ Connect BLUE receiver unit wire (FOR LIGHT) to BLUE light wire.
 - ❑ After making the wire connections, ensure the wires should be spread apart with the grounded conductor and the equipment-grounding conductor on one side of the outlet box and the ungrounded conductor on the other side of the outlet box. ¹⁵
 - ❑ Ensure the splices after being made should be turned upward and pushed carefully up into the outlet box. ¹⁶

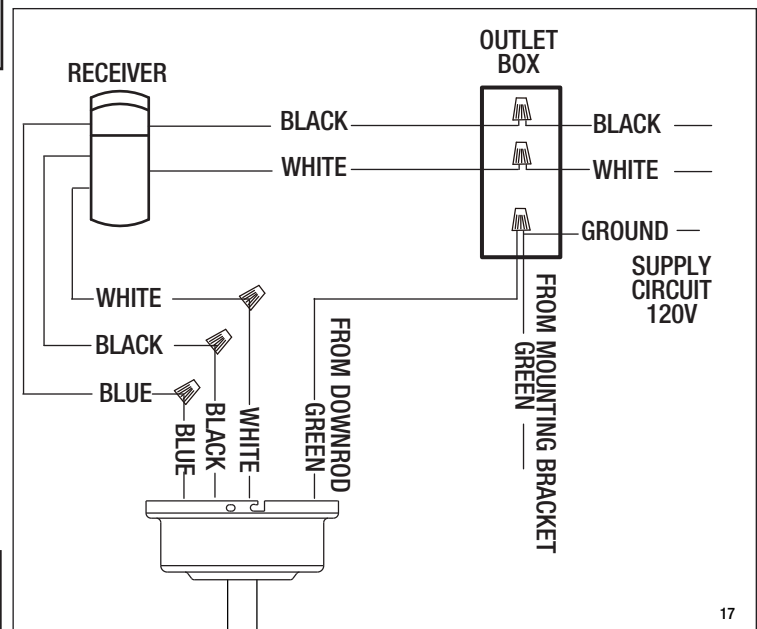

17

In Quebec, the installation of this product must be carried out by a qualified electrician.



NOTE: Once ground wires are connected, carefully tuck all wires and wire nuts into the metal outlet box making sure that the wires are clear of the hemisphere and downrod when positioned in mounting bracket.

Assembly (continued)

7 ELECTRICAL HOOK-UP (continued)

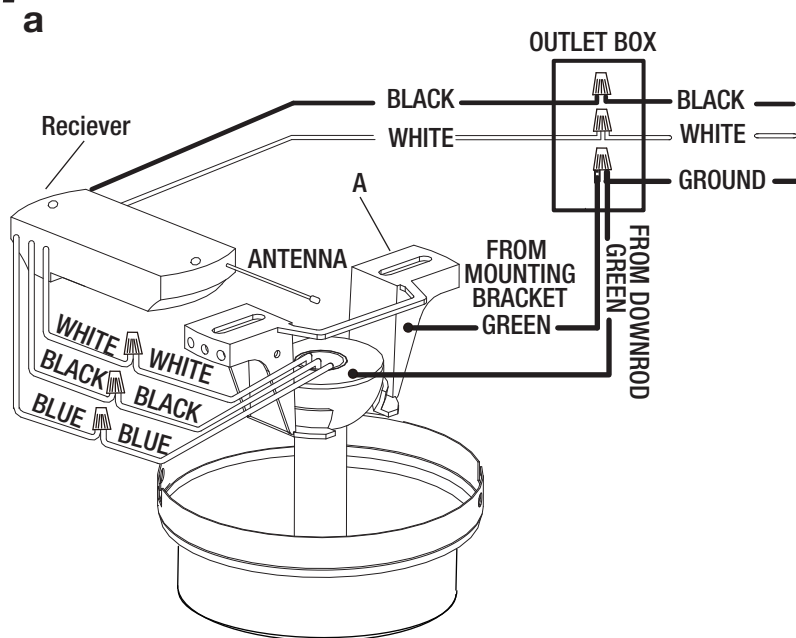

- b**
- ☐ Push all connected wires up into ceiling box.
 - ☐ Position the receiver into the mounting bracket (A) as shown.

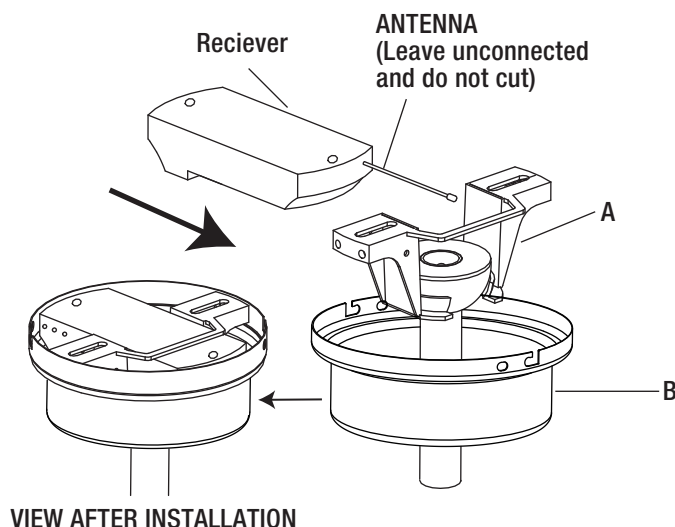

c LEARNING PROCESS

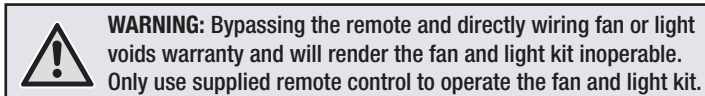

- ☐ After installation of the fan, power on the fan. Open battery cover and install battery, DC1.5V/ AAA*2 pcs that are not included. Use a ball pen to press and hold the “LEARN” key for 1-3 seconds.
- ☐ FAN will be turned “OFF” and then “ON” at medium speed. This indicates the learning process is completed.
- ☐ Please GO through this learning process within 30 seconds after power on.
- ☐ If just replace batteries, no need to re-learn.
- ☐ Please note that the transmitter can learn in multiple receiver while doing learning process.
- ☐ Please make sure NOT to turn on other fans while learning.

LIGHT FUNCTION SELECT SWITCH

- ☐ If a fluorescent lamp is used, slide the function switch to “O” position.
- ☐ If a regular incandescent lamp is used, slide switch to the “DIM” position.

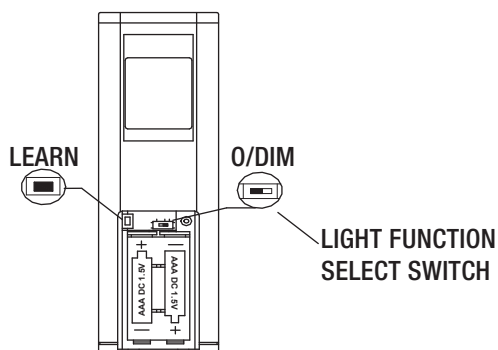

8 INSTALLING THE REMOTE CONTROL WALL BRACKET

If desired, the wall bracket can be installed to house the remote control (I).

- ☐ Use the screws to secure the wall bracket at the desired mounting location.
- ☐ Place the remote control (I) into the wall bracket.

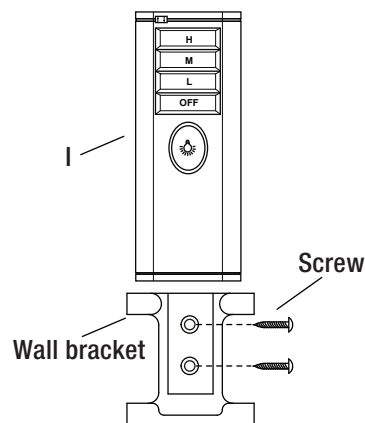

9 MOUNTING THE FAN ASSEMBLY

- Place two screws and washers on the mounting bracket (A) which correspond with the slots in the canopy (B). Screw in two turns.
- Position the canopy (B) to the mounting bracket (A) by aligning the slots to the screws (marked "b" on diagram) then turn to lock.
- Position and tighten the two screws and washers (marked "a" on diagram) then tighten the two screws (marked "b" on diagram).

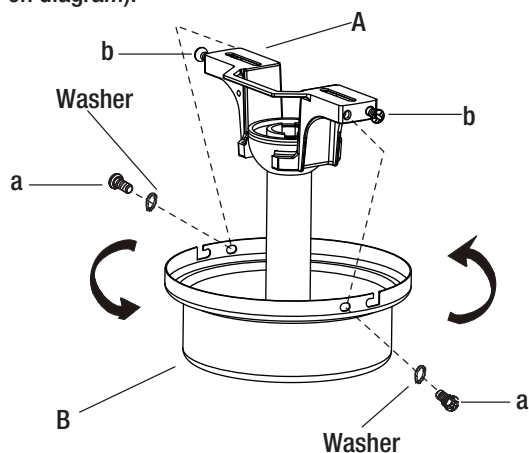

10 INSTALLING THE GLASS



WARNING: BE SURE TO TURN OFF POWER BEFORE INSTALLING.

- Install proper wattage and type of bulb (J) identified on light kit (G).
- Place glass (H) onto the fan and turn to secure.

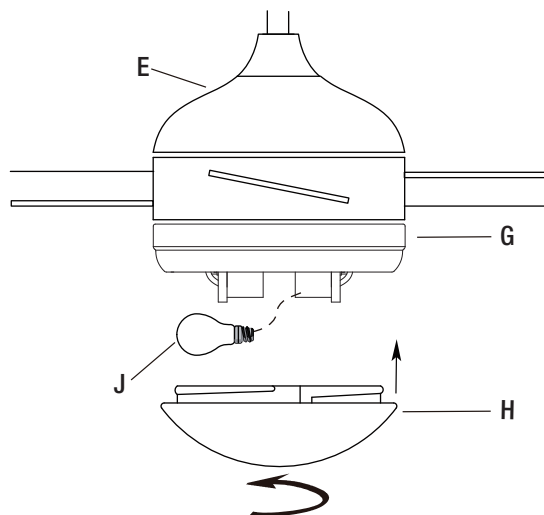

WARNING: Ensure that all connections, set screws and screws are securely tightened before the next step.

Operation

USING THE REMOTE CONTROL

Operation buttons on the remote:

- ☐ H : Turn on the fan at high speed
 - ☐ M : Turn on the fan at medium speed
 - ☐ L : Turn on the fan at low speed
 - ☐ OFF : Turn off the ceiling fan
 - ☐ LIGHT ON/OFF: Press and release immediately to turn on or off the light.
 - ☐ DIMMER- Press and hold to dim or brighten lights to the desired level and release. (Incandescent light bulbs or dimmable LED bulb only).
Hold down to increase or decrease the light.
- The light has a memory function so the light will stay at the same brightness as the last time it was turned off.

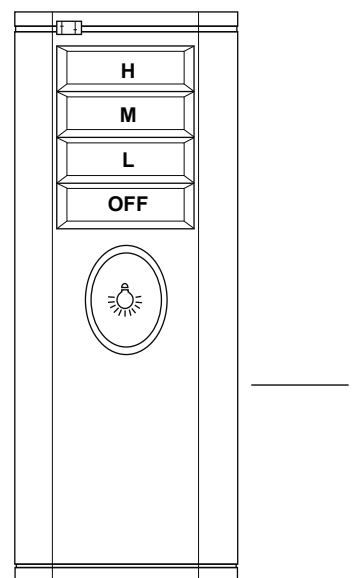

The slide switch is for Forward/Reverse.
This setting would usually be changed twice per year.

Downdraft in summer to create a wind chill to give a cooling effect.

Updraft in winter to circulate the hot stratified air off the ceiling and back down to the floor without creating a wind chill.

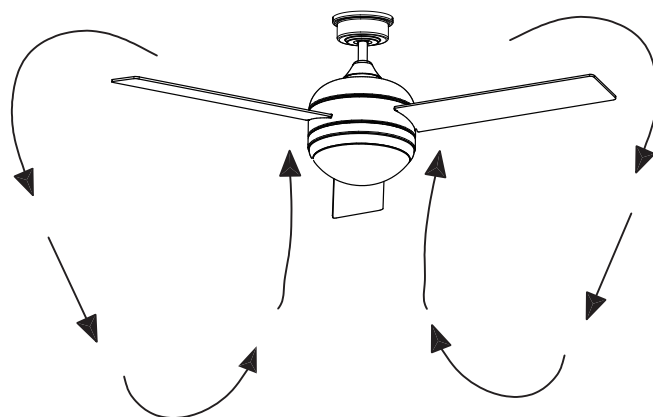
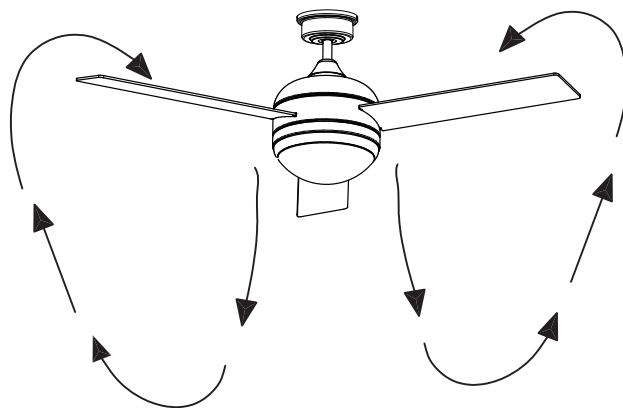

Troubleshooting

Problem	Solution
The fan will not start.	<ul style="list-style-type: none">□ Check wiring connections to fan.□ Check fuses and circuit breakers.□ Check wiring connections in switch housing. CAUTION: Turn power off for last two items.
Fan sounds noisy.	<ul style="list-style-type: none">□ Check to make sure that all screws in motor housing are snug.□ Check to make sure that blade bracket screws are tight.□ Check to make sure that wire nuts in switch housing are not rattling against wall of switch housing.□ If fan has a light kit make sure switch housing screws and set screws are tight.□ Some fan motors are sensitive to signals from solid state variable controls. If solid state controller is used, change to an alternative control.□ Allow a 24-hour break- in period to eliminate most noises.
Fan wobbles or shakes excessively	<ul style="list-style-type: none">□ Check that all blades are screwed firmly into blade brackets□ Check that blade brackets are secured firmly to motor.□ Check distance from tip of blades to ceiling.□ Check distance between blade tip to blade tip. All measurements should be equal. Loosen blade screws and position blade until even then re-tighten.□ Check that the downrod hemisphere notch is engaged in canopy.□ Check to make sure that jam screws in downrod are tightened.□ Make sure canopy and mounting bracket are tightened securely to wooden joist.□ Make sure warpage has not occurred in wooden blades. If so, contact the customer service department for replacement parts.

Maintenance

- ☐ When properly maintained, fans can be expected to give years of trouble free operation.
- ☐ Properly maintained fans must be inspected every 3 months for vibration and wear on the support mechanism and that all screws, nuts, etc. are tight. 4
- ☐ To clean the fixture, turn off the power, wait for it to cool, and wipe the fixture with a clean, soft cloth.
- ☐ The replacement of parts of the safety suspension system device shall be performed by the manufacturer, its service agent or suitably qualified persons. 6
- ☐ **WARNING: If unusual oscillating movement is observed, immediately stop using the ceiling fan and contact the manufacturer, its service agent or suitably qualified persons. 3**
- ☐ Refer to below for maintenance schedule

DATE INSTALLED:		
Visible Vibration Check Every 3 Months	Support Mechanism Refer to Installation Instructions (Every 3 Months)	Screws Refer to Installation Instructions (Every 3 Months)