

INSTRUCTION MANUAL

KOLT 42-INCH CEILING FAN

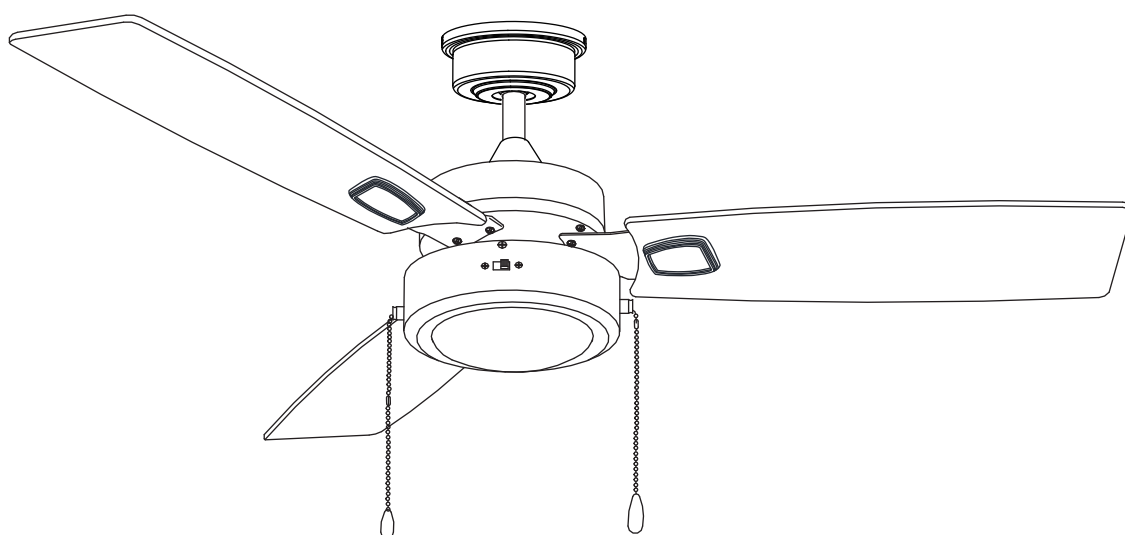

Questions, problems, missing parts? Before returning to the store,
call CANARMNA Customer Service
8 a.m. - 5 p.m., EST, Monday-Friday.

1-800-265-1833

ressalescanada@canarmna.ca

IMPORTANT: Please read and understand this manual before any assembly. Before beginning assembly of product, make sure all parts are present. Compare parts with packaging contents list.

Table of Contents

Table of Contents	2	Assembly	6
Safety Information	2	Operation	10
Warranty	3	Troubleshooting	11
Pre-Installation	3	Maintenance	12
Installation	6		

Safety Information

READ AND SAVE THESE INSTRUCTIONS.

1. Turn off power at main electrical service box before starting installation. ¹⁴
2. Electrical connections must comply with local code ordinances, national electrical codes, CEC, NEC and ANSI/NFPA 70. ¹³
3. Make sure the installation site you choose allows the fan blades to rotate freely without any obstructions.
4. When mounting the fan on a ceiling outlet box, Use an approved (CSA for Canada and UL for U.S.) ceiling fan box marked "FOR FAN SUPPORT". Ensure the outlet box is securely installed in place such that it is able to support at least the fan weight.
5. **WARNING:** To reduce the risk of fire, electric shock, or other personal injury, mount fan only on an outlet box or supporting system marked acceptable for fan support of 35 lbs (15,9 kg) or less and use the mounting screws provided with the outlet box. Most outlet boxes commonly used for the support of lighting fixtures are not acceptable for fan support and may need to be replaced. Consult a qualified electrician if in doubt.
6. All set screws must be checked and retightened where necessary before installation.
7. The fixing means for attachment to the ceiling such as hooks or other devices shall be fixed with a sufficient strength to withstand 4 times the weight of the ceiling fan. ⁷
8. The mounting of the suspension system shall be performed by the manufacturer, its service agent or suitably qualified persons. ⁸
9. This ceiling fan is pre-built with luminaire. Do not use any other luminaire for this fan. ⁹
10. This appliance is not intended for use by persons (including children) with reduced physical, sensory or mental capabilities, or lack of experience and knowledge, unless they have been given supervision or instruction concerning use of the appliance by a person responsible for their safety. ¹
11. Children should be supervised to ensure that they do not play with the appliance. ²



WARNING: To reduce the risk of personal injury, DO NOT bend the blade brackets when installing the brackets, balancing the blades or cleaning the fan. Also, DO NOT insert foreign objects in between rotating fan blades. ¹⁰



WARNING: To reduce the risk of fire, electric shock, or personal injury, mount to outlet box marked acceptable for fan support and use mounting Screws provided with the outlet box. ¹¹



WARNING: Mount with the lowest moving parts at least 2.10 Meters (7 Feet) above floor or grade level.



WARNING: DO NOT operate reversing switch while fan blades are in motion. Fan must be turn off and rotating blades stopped completely, operate reverse switch and then operate speed switch for the opposite direction.

Warranty

5 YEAR LIMITED WARRANTY

“Thank you” for purchasing our product. It is our policy to furnish you with high quality products at a fair price. With proper installation your fan should provide you with years of money saving comfort.

This fan is guaranteed to be free from defects in workmanship and Material for a period of five (5) years from date of purchase. Within the first (1) year from date of purchase any defective product should be returned to your **RETAIL OUTLET** along with proof of purchase. For the balance of the warranty, four (4) years, the **MOTOR WINDINGS ONLY** shall be free of defects. We will correct such defects or replace the motor assembly at our option if the product is returned, **FREIGHT PREPAID**, to us. The returned fan must be accompanied by your proof of purchase and a cheque for \$20.00 for handling and labour charges. All costs of removing and re-installing the product are **YOUR RESPONSIBILITY** damage to any part as such by accident, misuse, improper installation or by affixing any accessories **IS NOT** covered by this warranty. As a result of varying climatic conditions in your area this warranty does not cover any changes in finishes, including rusting, pitting, corroding, tarnishing or peeling. **WARRANTY VOID: In cases of alteration, abuse, installation not in accordance with instructions or REMOVAL Of the CSA Sticker.**

Pre-Installation

SPECIFICATIONS

Size	Speed	Volts	Amps	Watts	RPM	CFM	Net Weight	Gross Weight ⁵	Cube Feet
42 in.	Low	120	0.15	8.5	78	1001	11.24 lb (5.1 kg)	12.35 lb (5.6 kg)	1.02 cu.ft.
	Medium		0.23	19	130	1682			
	High		0.32	36.1	183	2369			



NOTE: These are approximate measures. They do not include the amps and wattage used by the light kit.

TOOLS REQUIRED



Phillips
screwdriver



Flat blade
screwdriver



Adjustable
wrench



Electrical
tape



Wire
cutter /
stripper



Step ladder

Pre-Installation (continued)

HARDWARE INCLUDED



NOTE: Hardware not shown to actual size.

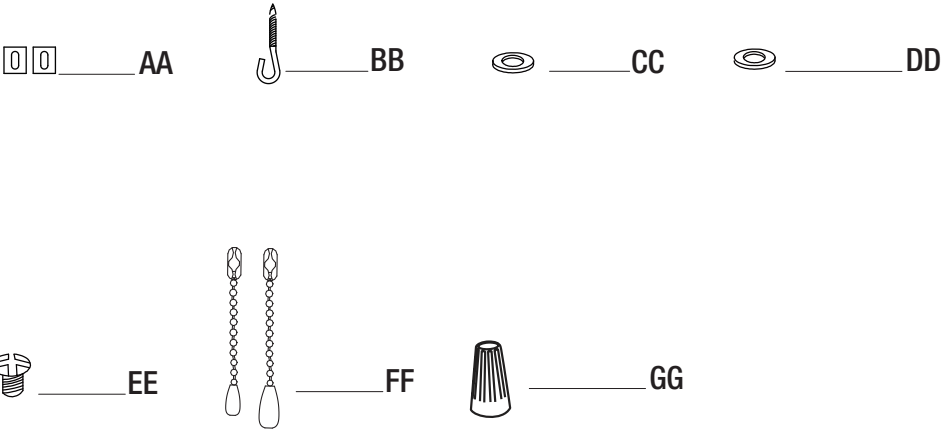

Part	Description	Quantity
AA	Rubber gasket	2
BB	J-Hook	1
CC	Flat washer	10
DD	Fiber washer	10
EE	Blade bracket screws	10
FF	Pull chain	2
GG	Wire nut	3

PACKAGE CONTENTS

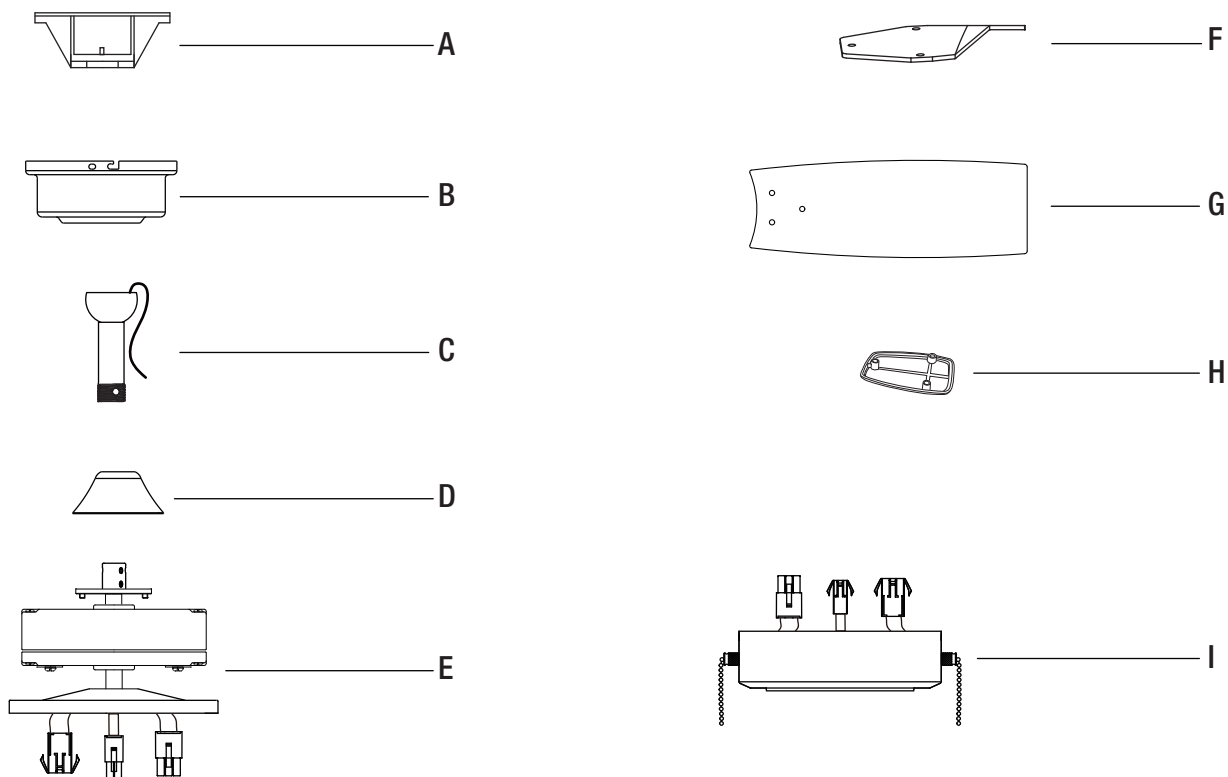

Part	Description	Quantity
A	Mounting bracket c/w ground wire	1
B	Ceiling canopy	1
C	Ball/Downrod assembly	1
D	Yoke cover	1
E	Motor assembly	1

Part	Description	Quantity
F	Blade bracket	3
G	Blade	3
H	Blade bracket cover	3
I	Light kit	1

Assembly

1 PREPARING FOR MOUNTING

- Release the mounting bracket (A) from the canopy (B) by removing the two screws (marked “a” on diagram) and washers, and loosening the two screws (marked “b” on diagram) and washers.

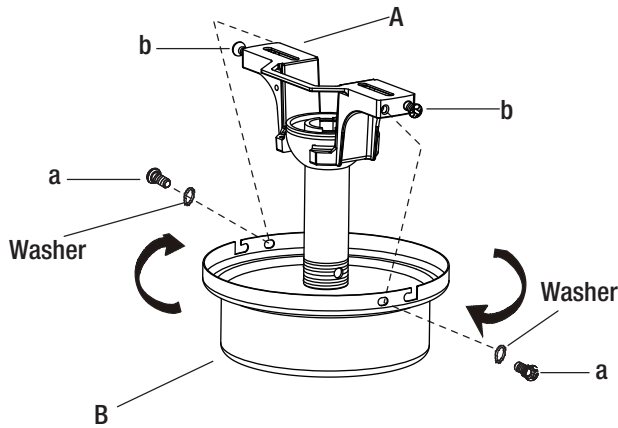

2 ASSEMBLING THE FAN

DOWNROD MOUNT

- Remove the hemisphere from downrod (C) by loosening the hemisphere jam screw and lock pin.
- Remove Bolt, flat and cotter pin from the yoke. Slightly loosening the 2 jam screws on the yoke.
- Route the wires and safety cable through the downrod (C) and screw the downrod (C) into the yoke and align holes for the bolt to go through. **Ensure not to damage the wires.** Place the flat washer and cotter pin to lock the bolt. Re-tighten the 2 jam screws on the yoke.

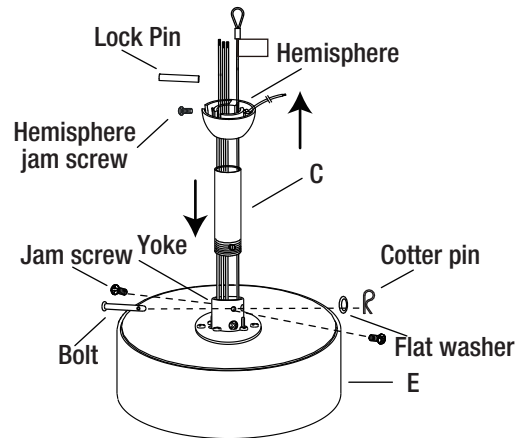

- Slide the yoke cover (D), rubber ring and canopy (B) into the downrod (C).
- Re-attach the hemisphere into the downrod (C). Insert the lock pin through the hole of downrod (C) and put the lock pin in place on the hemisphere.
- Tighten the hemisphere jam screw against the downrod (C).

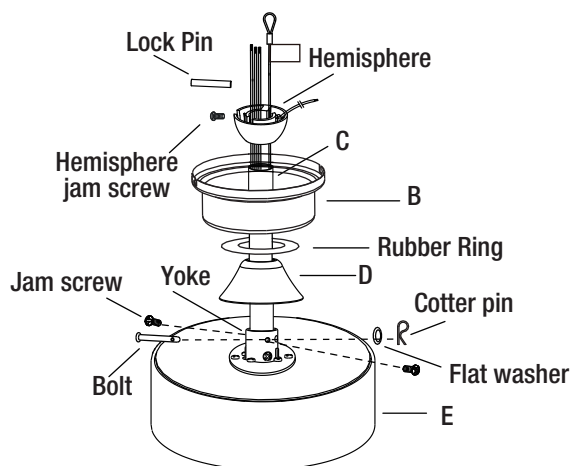

3 INSTALLING THE MOUNTING BRACKET



WARNING: To Reduce The Risk Of Fire, Electric Shock, Or Personal Injury, Mount To UL/CSA Listed Outlet Box Marked Acceptable for Fan Support And Use Mounting Screws Provided With The Outlet Box.

DOWNROD MOUNT

- Install the J-Hook (BB) through center of the outlet box and into the wood joist.
- Secure the mounting bracket (A) and rubber gaskets (AA) to the outlet box.
- Hang downrod mount, fan on mounting bracket (A) by aligning tab on mounting bracket (A) with groove in hanger ball on downrod.
- Hang the fan on the mounting bracket (A).

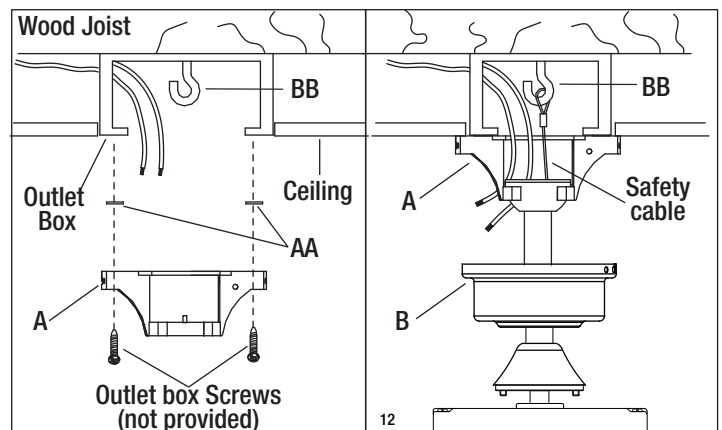

Assembly (continued)

4 ENGAGING THE HEMISPHERE (Downrod Mount Only)

- Carefully rotate the fan assembly until the groove in the hemisphere locks over the tab of the mounting bracket (A) assembly.



WARNING: Failure to seat the tab in the groove could cause damage to electrical wires and possible shock or fire hazard.

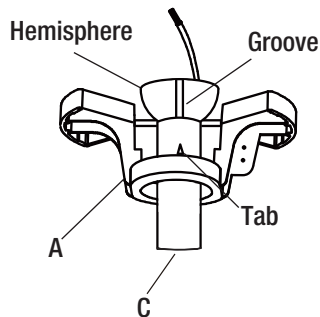

NOTE: When installing the fan on a sloped ceiling, make sure the tab on the hanger bracket faces towards the top of the slope. Depending on the slope, a longer downrod may be required to prevent fan blades from hitting the ceiling.

5 ELECTRICAL HOOK-UP

- There are several different wiring combinations that can be used to control your ceiling fan depending on your specific requirements.

CAUTION

Green Wire - GROUND
Black Wire (Fan) - POWER
White Wire (Fan) - COMMON
Blue Wire (Light Kit) - POWER

**SEE SAFETY PRECAUTIONS ON
PG. #2 BEFORE WIRING**

- Connect ground wire from outlet box to green wire from mounting bracket and downrod using a wire nut (GG).
- Connect white wire from outlet box to white wire from fan using a wire nut (GG).
- Connect black wire from outlet box to black wire from fan plus (blue wire) using a wire nut (GG).
NOTE: A blue wire would be power for a light kit if applicable.
- After making the wire connections, ensure the wires should be spread apart with the grounded conductor and the equipment-grounding conductor on one side of the outlet box and the ungrounded conductor on the other side of the outlet box. ¹⁵
- Ensure the splices after being made should be turned upward and pushed carefully up into the outlet box. ¹⁶



NOTE: Once wires are connected, carefully tuck all wires and wire nuts into the metal outlet box making sure that the wires are clear of the hemisphere and downrod when positioned in mounting bracket.

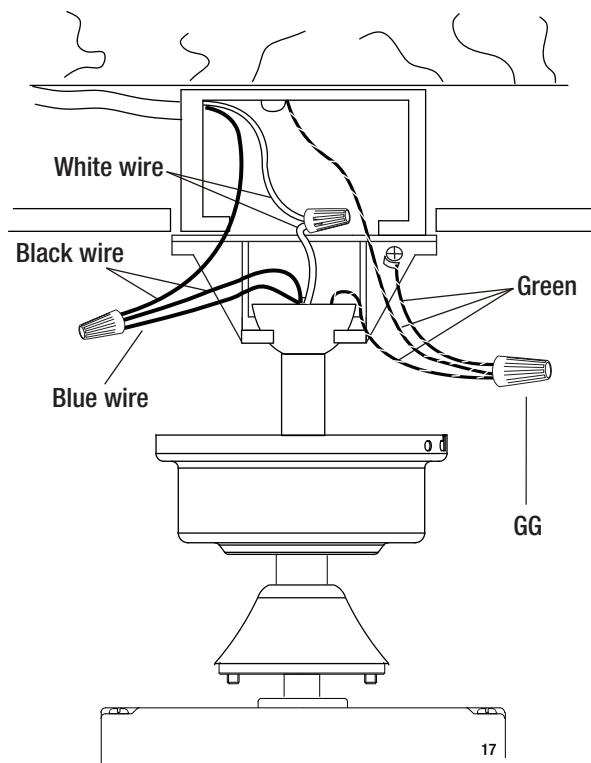

6 MOUNTING THE FAN ASSEMBLY

- Place two screws and washers on the mounting bracket (A) (marked "b" on diagram) which correspond with the slots in the canopy (B). Screw in two turns.
- Position the canopy (B) to the mounting bracket (A) by aligning the slots to the screws (marked "b" on diagram) then turn to lock.
- Position and tighten the two screws and washers (marked "a" on diagram) then tighten the two screws (marked "b" on diagram).

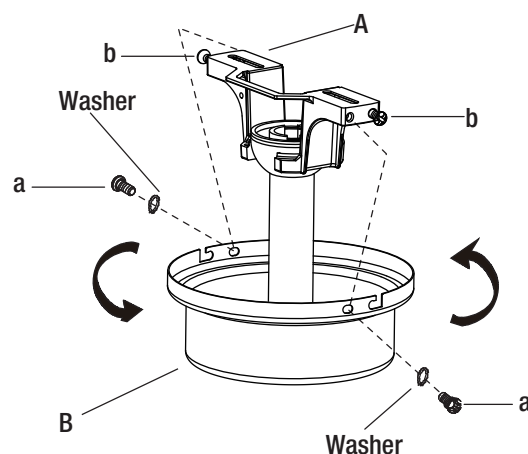

7 MOUNTING THE BLADE BRACKETS AND BLADE BRACKET COVER TO BLADES

- Place a blade bracket screw (EE) through a blade bracket (F), flat washer (CC), fiber washer (DD), blade (G) and blade bracket cover (H).
- Align with corresponding hole in the blade bracket cover (H).
- Repeat for the 2 remaining screws and tighten.

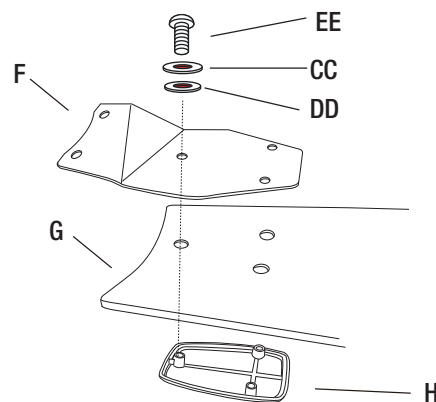

8 MOUNTING BLADES TO MOTOR

- Remove motor screws, lock washers and gaskets on motor (E).
- Place lock washers over motor screws, position motor screws in blade brackets (F), place fiber bracket gaskets over screws and secure to motor (E). Make sure all screws are tightened securely.

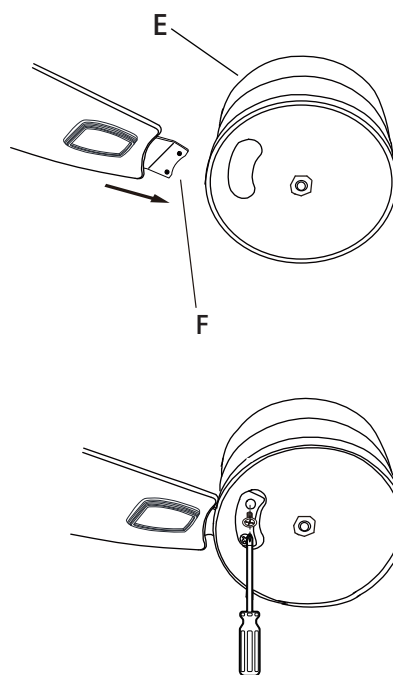

9 INSTALLING THE LIGHT KIT



WARNING: BE SURE TO TURN OFF POWER BEFORE INSTALLING.

- Remove light kit screws and washers.
- Connect polarized connectors of light kit (I) to corresponding connectors found in switch housing.
- Carefully tuck electrical wires back into switch housing, align light kit (I) with switch housing and secure with three light kit screws and washers.
- Attach the pull chain extensions (FF) to the light pull chain and fan pull chain.



WARNING: Ensure that all connections, set screws and screws are securely tightened before the next step.

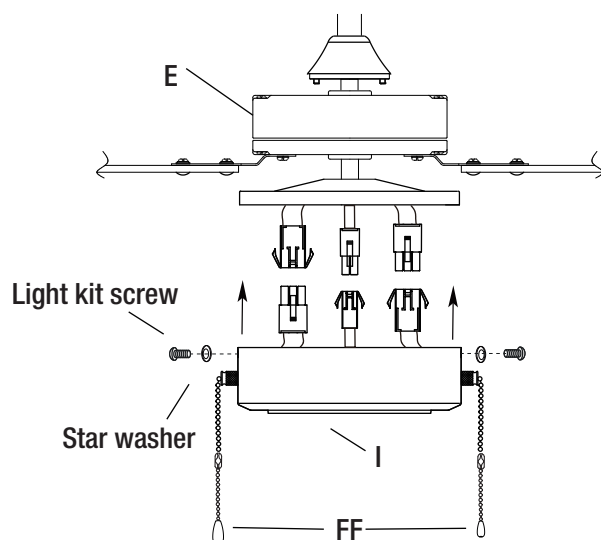

Operation

USING THE PULL CHAIN AND SLIDE SWITCH

A ceiling fan has a completely internal switching system for total operation by way of pull chains. On a fan/light combination, two pull chains will exist:

One for light, on and off. The second is for fan speeds.

This will be marked (SPEED) on the fan switch housing.

- ☐ 1st Pull will give fan High Speed
- ☐ 2nd Pull will give fan Medium Speed
- ☐ 3rd Pull will give fan Low Speed
- ☐ 4th Pull will Shut Fan Off

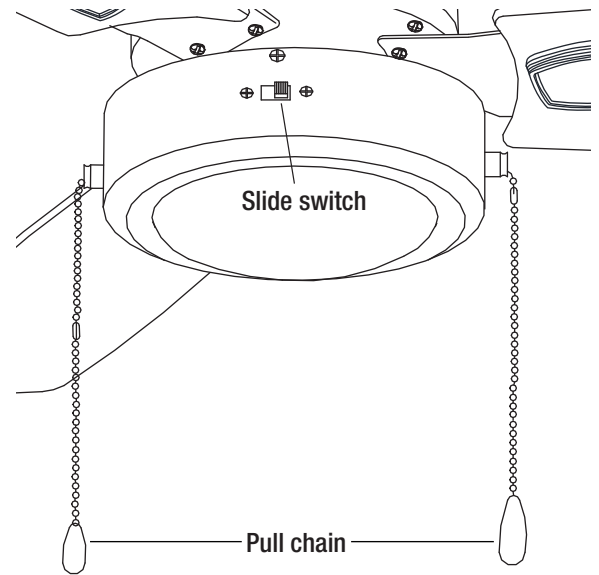

The slide switch is for Forward/Reverse.

This setting would usually be changed twice per year.

Downdraft in summer to create a wind chill to give a cooling effect.

Updraft in winter to circulate the hot stratified air off the ceiling and back down to the floor without creating a wind chill.

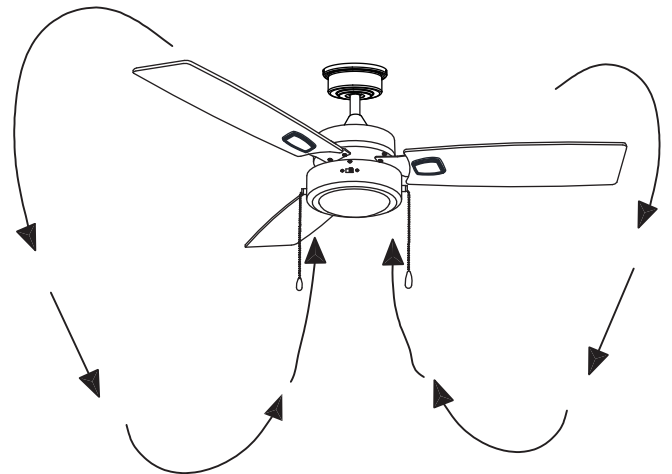
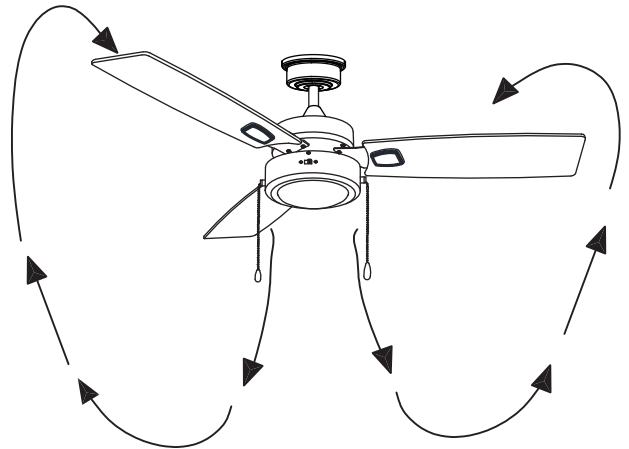

Troubleshooting

Problem	Solution
The fan will not start.	<ul style="list-style-type: none"> □ Check wiring connections to fan. □ Check fuses and circuit breakers. □ Check wiring connections in switch housing. <p>CAUTION: Turn power off for last two items.</p>
Fan sounds noisy.	<ul style="list-style-type: none"> □ Check to make sure that all screws in motor housing are snug. □ Check to make sure that blade bracket screws are tight. □ Check to make sure that wire nuts in switch housing are not rattling against wall of switch housing. □ If fan has a light kit make sure switch housing screws and set screws are tight. □ Some fan motors are sensitive to signals from solid state variable controls. If solid state controller is used, change to an alternative control. □ Allow a 24-hour break- in period to eliminate most noises.
Fan wobbles or shakes excessively	<ul style="list-style-type: none"> □ Check that all blades are screwed firmly into blade brackets □ Check that blade brackets are secured firmly to motor. □ Check distance from tip of blades to ceiling. □ Check distance between blade tip to blade tip. All measurements should be equal. Loosen blade screws and position blade until even then re-tighten. □ Check that the downrod hemisphere notch is engaged in canopy. □ Check to make sure that jam screws in downrod are tightened. □ Make sure canopy and mounting bracket are tightened securely to wooden joist. □ Make sure warpage has not occurred in wooden blades. If so, contact the customer service department for replacement parts.

Maintenance

- ☐ When properly maintained, fans can be expected to give years of trouble free operation.
- ☐ Properly maintained fans must be inspected every 3 months for vibration and wear on the support mechanism and that all screws, nuts, etc. are tight. 4
- ☐ To clean the fixture, turn off the power, wait for it to cool, and wipe the fixture with a clean, soft cloth.
- ☐ The replacement of parts of the safety suspension system device shall be performed by the manufacturer, its service agent or suitably qualified persons. 6
- ☐ **WARNING: If unusual oscillating movement is observed, immediately stop using the ceiling fan and contact the manufacturer, its service agent or suitably qualified persons. 3**
- ☐ Refer to below for maintenance schedule

DATE INSTALLED:		
Visible Vibration Check Every 3 Months	Support Mechanism Refer to Installation Instructions (Every 3 Months)	Screws Refer to Installation Instructions (Every 3 Months)