

ENGLISH

NOMA<sup>®</sup> MD

COLOUR-CHANGING  
LED PUCK LIGHTS

model no. 052-7850-0

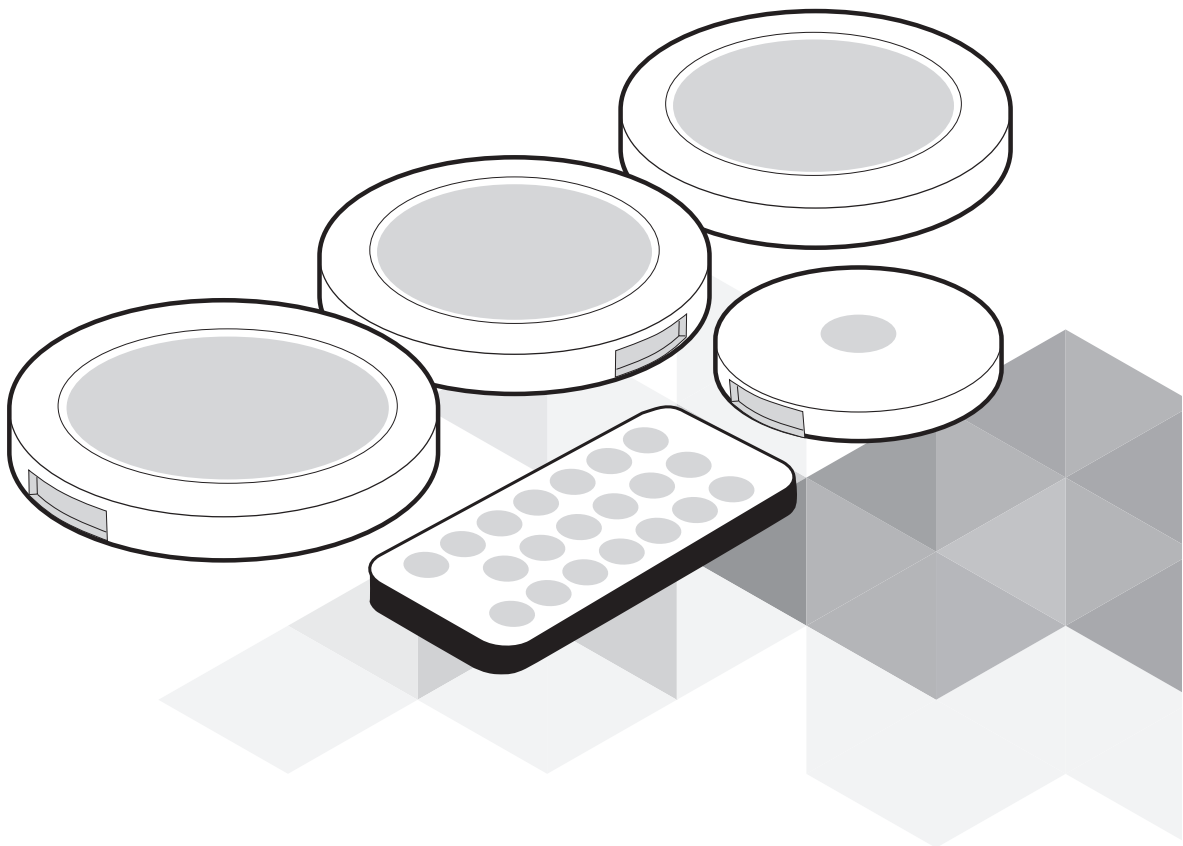

**Toll-free: 1-866-827-4985**

**IMPORTANT:** Please read this manual carefully  
before installation and save it for reference.

**Instruction Manual**

Specifications	3
Know Your LED Puck Light	3
Installation	4
Operation	5
Cleaning	6
Troubleshooting	6
Safety	7
Warranty	7

Model	052-7850-0
Voltage	24 V DC
Frequency	60 Hz
Watt/Lumens	3.5 W/150 Lm
Sensing Range	Within 23' (7 m)
Dimensions (Dia x H)	2 25/32 x 19/64" (70.5 x 7.6 mm)

Light Beam Spread

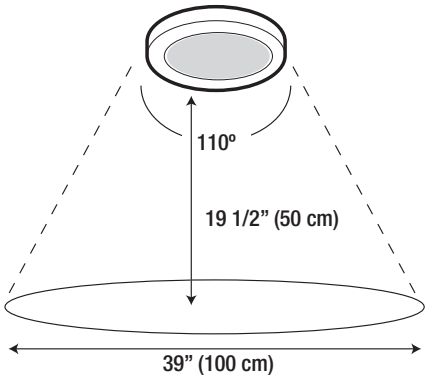

1. Remote control sensor	1
2. Colour-changing puck lights	3
3. Double-sided tapes	4
4. Remote control	1
5. Jumper cable connectors	3 x 20" (50 cm)
6. Wire guides	10
7. AC/DC plug-in adapter	24 V, 0.62 A
8. Plug-in adapter connector	1 x 17.5" (45 cm)

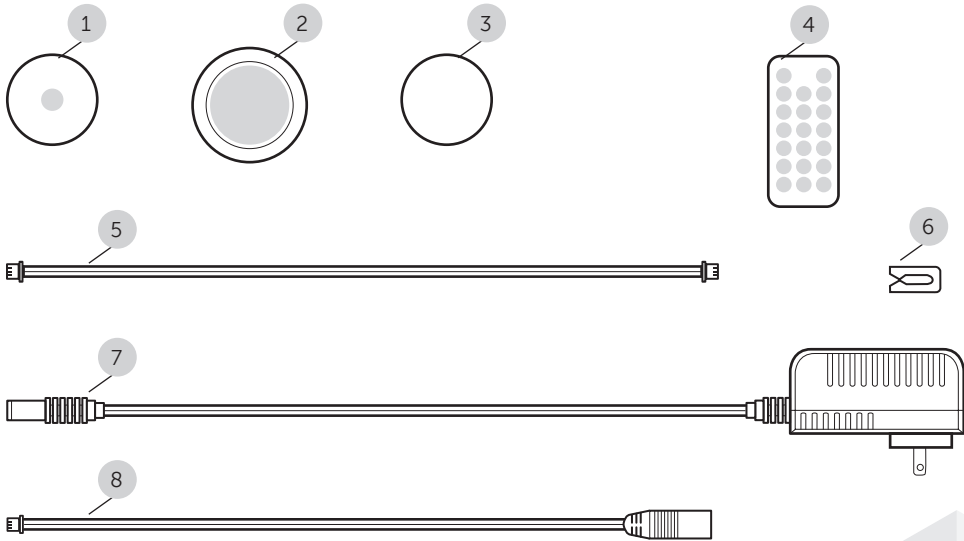

KNOW YOUR LED PUCK LIGHTS

Before installing this product, familiarize yourself with all operating features and safety rules.

1. Mark the desired area where you want to install. Remove one side of the tape and secure to the LED puck light. Then remove the other side of the tape and secure to where you want to install.

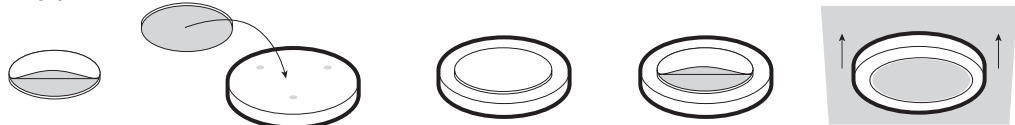

2. Remove one side of the double-sided tape and secure it to the sensor.

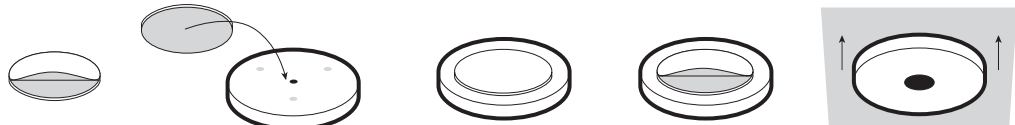

3. Connect the puck lights to each other using the jumper cable connectors. Then connect the wave sensor to the desired location.

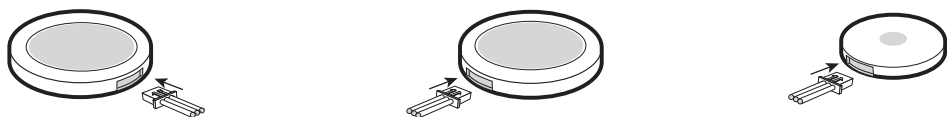

Connection options

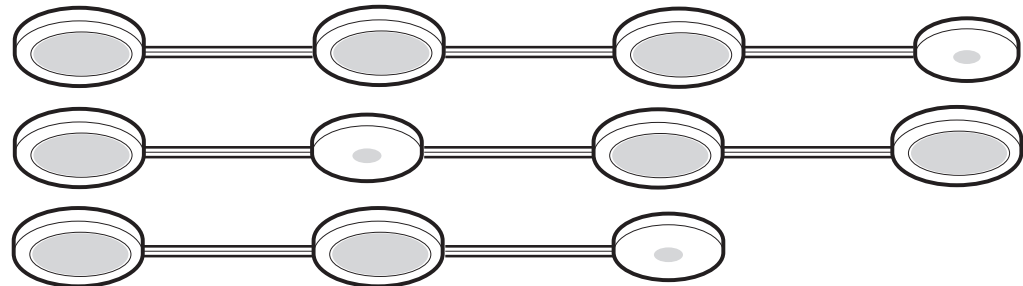

**REMINDER:** Please read all instructions before assembling and using your new LED puck light kit.

**IMPORTANT:** FOR INDOOR AND DRY LOCATION USE ONLY. ADHESIVE TAPE MAY DAMAGE SURFACE IF REMOVED.

**INSTALLATION:** Before installation, make sure the surface you intend to mount the product on is free of moisture, oil, grease, dust and dirt to ensure proper adhesion. Test painted surfaces.

4. Connect the plug-in adapter connector (A) to the puck light. Then connect the AC/DC plug-in adapter connector jack end (B) to the adapter connector round socket end.

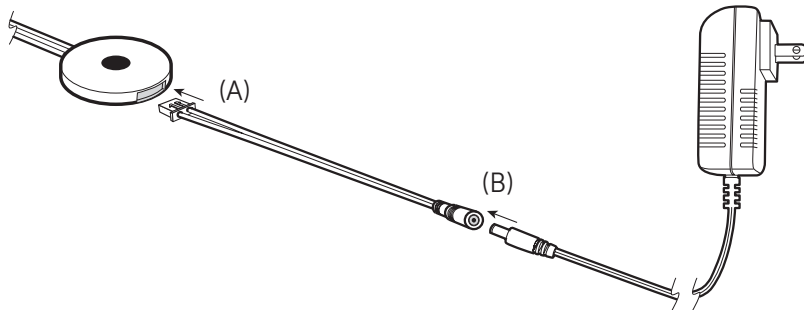

5. Affix self-adhesive wire guides to desired locations as needed to guide and secure jumper cables and AC/DC plug-in adapter cord.

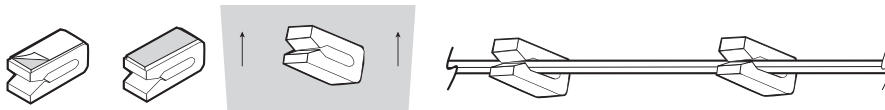

6. Plug the AC/DC plug-in adapter into the power outlet. The LED puck lights are ready to be used.

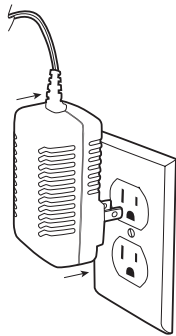

7. Operate the light by IR remote controller.

	Turns on the light
	Turns off the light
	Changes LED colours gradually
	Colour jumps in sequence
	Increases the brightness of light
	Decreases the brightness of light
	Light will return to red



**WARNING:** Prior to cleaning, always disconnect the plug from the electrical wall outlet.

1. No need to demount your LED Puck Lights when cleaning.
2. Always disconnect the plug from electrical wall outlet before cleaning.
3. Dust or wipe with a damp clean cloth. Do not use solvents or abrasive cleansers.
4. To remove grease use a mild soap like dishwashing liquid. Dissolve dishwashing liquid with warm water. Using a clean cloth, wet and wring out excess water to wipe clean the LED Puck Lights and jumper cables.
5. Do not submerge LED Puck Lights and accessories in the water.

Please check the following items before having it repaired.

Problem	Reason	Solution
Light does not operate.	Adapter is not properly inserted into electrical outlet.	Insert adapter securely into the electrical wall outlet.
	Loose jumper cable connection.	Check all connections are fully inserted into the puck lights.
	Battery in remote is not place correctly.	Verify that battery "+" faces exterior of battery compartment.
	Battery is exhausted.	Replace with a new battery (lithium CR2025).

READ AND SAVE THESE INSTRUCTIONS!

**WARNING:** To reduce the risk of fire, electric shock or injury to persons: Changes or modifications to this unit not expressly approved by the party responsible for compliance could void the user's authority to operate the equipment.

**CAUTION:**

- TO REDUCE THE RISK OF FIRE, ELECTRIC SHOCK OR INJURY TO PERSONS:
1. Use only insulated staples or plastic ties to secure cords.
  2. Route and secure cords so that they will not be pinched or damaged when the cabinet is pushed into wall.
  3. Position the under-cabinet light with respect to the cabinet so the lamp replacement markings can be read during re-lamping.
  4. Not intended for recessed installation in ceiling, or soffits; and
  5. Do not permit cords to be concealed where damage to insulation may go unnoticed. To prevent fire danger, do not run cords behind walls, ceiling, soffits, or cabinets where it may be inaccessible for examination. Cords should be visually examined periodically and immediately replaced when any damage is noted.

This device complies with Part 15 of the FCC Rules. Operation is subject to the following two conditions: (1) this device may not cause harmful interference, and (2) this device must accept any interference received, including interference that may cause undesired operation.

**NOTE:** This equipment has been tested and found to comply with the limits for a Class B digital device, pursuant to Part 15 of the FCC Rules. These limits are designed to provide reasonable protection against harmful interference in a residential installation. This equipment generates, uses and can radiate radio frequency energy and, if not installed and used in accordance with the instructions, may cause harmful interference to radio communications. However, there is no guarantee that interference will not occur in a particular installation. If this equipment does cause harmful interference to radio or television reception, which can be determined by turning the equipment off and on, the user is encouraged to try to correct the interference by one or more of the following measures:

- Reorient or relocate the receiving antenna.
- Increase the separation between the equipment and receiver.
- Connect the equipment into an outlet on a circuit different from that to which the receiver is connected.
- Consult the dealer or an experienced radio/TV technician for help.

This device complies with ICES-003 of the IC rules; operation is subject to the following two conditions:  
(1) This device may not cause interference, and  
(2) This device must accept any interference received, including interference that may cause undesired operations.

This product carries a **one (1) year** warranty against defects in workmanship and materials. Noma Canada agrees to replace a defective product, within the stated warranty period, when returned to the place of purchase with **proof of purchase**. This product is not guaranteed against wear or breakage due to misuse and/or abuse.

MADE IN CHINA

Imported by  
Noma Canada  
Toronto, Canada M4S 2B8

