

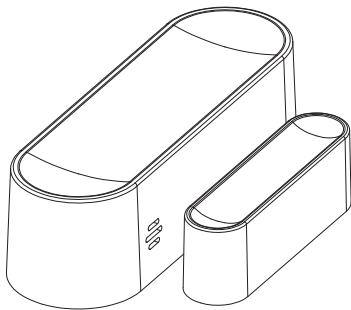

Smart door and window sensor

046-3370-2



USER MANUAL

————— READ AND SAVE THESE INSTRUCTIONS —————

TABLE OF CONTENTS

01. WHAT'S IN THE BOX	3
02. INSTALLATION	5
03. WARNING	7

WHAT'S IN THE BOX

PRODUCT INFORMATION

- 01. SMART DOOR AND WINDOW SENSOR
- 02. MOUNTING ACCESORY
- 03. CR123A BATTERY



smart door and
window sensor



mounting
accessory



CR123A

PRODUCT INFORMATION

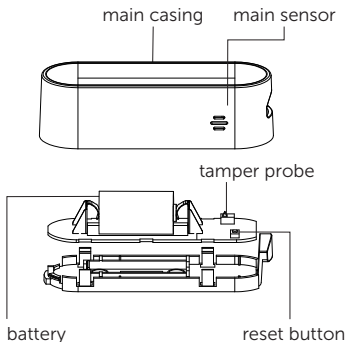

secondary sensor

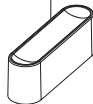

NOTE:

Tamperproof: When the magnetic shell is removed, the app will receive a notification and report the status (Open/Closed).

SMART WATER LEAK SENSOR PAIRING/MOUNTING INSTRUCTIONS

PAIRING INSTRUCTIONS

- Hold the main sensor and slide the casing in an upward direction. Once the casing is off, remove the small plastic tab on the battery terminal. The battery will be connected, and the sensor will automatically be in pairing mode.
- If not in pairing mode press and hold the power/reset button for 5 seconds until flashing rapidly.

MOUNTING INSTRUCTIONS

Note: The sensor must be installed indoors.

- When you select your mounting location, make sure the surface area is clean.
- During the mounting process ensure that both the main sensor and secondary sensor are aligned correctly. Use the alignment lines indicated on the main and secondary sensor. The sensors must touch in order to work correctly.
- Place the included adhesive tape on the back of the main and secondary sensors. Select your location and mount the main and secondary sensors.

SMART WATER LEAK SENSOR

PAIRING/MOUNTING INSTRUCTIONS

ALIGNMENT INSTRUCTIONS

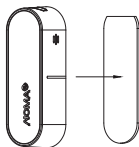

Step 1: Glue the main device to the door frame (or window frame) with 3m adhesive tape

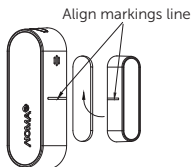

Step 2: The magnet shell is glued to the door (or window) with 3M adhesive, and the two marks are aligned

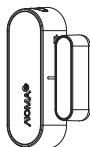

Complete installation



Position of X axis 0

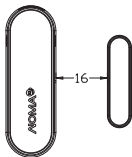

Maximum distance of X axis 16MM

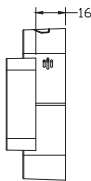

Maximum positive distance of Z axis 16MM

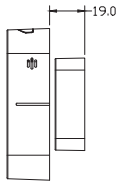

Maximum negative distance of Z axis 19MM

WARNING

WARNING AND CAUTION

WARNING:

Keep batteries away from children and pets.

- Follow the battery manufacturer's safety and usage instructions.
- Insert the battery observing the proper polarity (+/-) as indicated inside the battery compartment.

CAUTION:

Failure to properly align the battery polarity can cause personal injury and/or property damage.

- Remove a spent or discharged battery from the product. Remove the battery when not using the product for an extended period.
- Never throw batteries into a fire. Do not expose batteries to fire or other heat sources.

DISPOSAL OF USED BATTERIES:

Battery may contain hazardous substances which could endanger the environment and human health. Used batteries shall not be treated as municipal waste, but left at the appropriate collection point for recycling. For more information about collection and recycling of used batteries, please contact your local municipality or waste disposal service.

- Use type CR123A battery (Smart Door and Window Sensor)
- Install only new batteries of the same type in your product.
- Failure to insert batteries in the correct polarity, as indicated in the battery compartment, may shorten the life of the batteries or cause batteries to leak.
- Danger of explosion if battery is incorrectly replaced.
- Batteries should be recycled or disposed of as per state and local guidelines.
- Do not mix old and new batteries.
- Do not mix Alkaline, Standard (Carbon-Zinc) or Rechargeable (Nickel Cadmium) or (Nickel Metal Hydride) batteries.

WARNING

SPECIFICATIONS

SAVE THESE INSTRUCTIONS FOR FUTURE REFERENCE.

READ ALL INSTRUCTIONS BEFORE USE.

- WARNING - To reduce the risk of fire, electric shock, or serious personal injury:
- Do not immerse or expose the main body in/to water or other liquids.
- This product is not intended for use by children and contains small parts that may pose a choking hazard to children under the age of three. Keep the product out of the reach of children and pets.

SPECIFICATIONS

- Required battery: CR123A
- Standby current: 13 μ A
- Working current: 115 mA-120 mA
- Wireless type: 2.4 GHz
- Wireless range: 45 m
- Wireless Protocol: IEEE 802.11b/g/n

WARNING

BATTERY REPLACEMENT & WARRANTY

BATTERY REPLACEMENT:

1. Hold the main sensor and slide the casing in an upward direction.
2. Remove the spent battery and place CR123A batteries into the battery compartment.
3. Replace the battery compartment cover.

LIMITED WARRANTY:

This device is warranted for 1 year from the date of purchase. If it fails before that time, we will replace it. Send Globe Electric the sensor, proof of purchase and register receipt along with your complete name and address. See caution text for proper use. This warranty is void if this product is misused in any way. This replacement is the sole remedy available and liability for incidental or consequential damage is expressly excluded.