

MASTERCRAFT™/MC

Milkhouse UTILITY HEATER

Model No: 043-8409-0

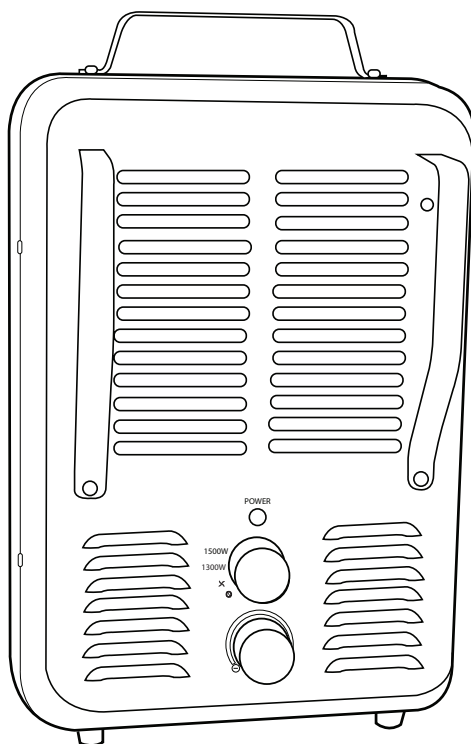

IMPORTANT:

Please read this manual carefully before running this heater and save it for reference.

INSTRUCTION MANUAL

TABLE OF CONTENTS

Technical Specifications	4
Safety Guidelines	5
Key Parts Diagram	7
Operating Instructions	8
Maintenance	10
Warranty	11

NOTE:

If any parts are missing or damaged, or if you have any questions, please call our toll-free helpline at 1-800-689-9928.



SAVE THESE INSTRUCTIONS

This manual contains important safety and operating instructions.
Read all instructions and follow them with use of this product.

FEATURES

Adjustable Thermostat

Two Settings

II - High (1500 W)

I - Low (1300 W)

Front-mounted Control Panel

Power Indicator Light

Safety Overheat Protection

Safety Tip-over Protection

Convenient Stay-cool Carry Handle

Quiet High Efficiency Fan

SPECIFICATIONS

Model	CZ798CA2
Power	120 V AC / 12.5 A
Frequency	60 Hz
Settings	High 1500 W, Low 1300 W

SAFETY GUIDELINES

When using this electric unit, basic safety precautions should always be followed to reduce the risk of fire, electric shock, and injury to persons, including the following:

- Read ALL instructions before using this unit.
- CAUTION: Risk of electric shock. DO NOT open or try to repair the heater yourself.
- This heater may get hot when in use. To avoid burns, DO NOT let bare skin touch hot surfaces. If provided, use handles when moving this heater.
- Keep combustible materials, such as furniture, pillows, bedding, paper, clothes, and curtains at least 3' (0.9 m) from the front of the heater and keep them away from the sides, top and rear. DO NOT place towels or other objects on the heater.
- Extreme caution is necessary when any heater is used by or near children or the disabled, or any time the heater is operating.
- Do not operate this heater unattended or while sleeping.
- DO NOT operate any heater with a damaged cord, or after the heater malfunctions, has been dropped or damaged in any manner. Return heater to authorized service facility for examination, electrical or mechanical adjustment, or repair.
- This heater is not intended for use in bathrooms, laundry areas and similar indoor locations. NEVER locate heater where it may fall into a bathtub or other water container. To protect against electrical hazards, DO NOT immerse in water or other liquids. This heater is not intended to be a primary heat source or replacement for a furnace.
- DO NOT touch the control panel or plug with a wet hand.
- DO NOT run cord under carpeting. DO NOT cover cord with throw rugs, runners, or similar coverings. Arrange cord away from traffic areas and where it will not be tripped over.
- DO NOT insert or allow foreign objects to enter any ventilation or exhaust opening as this may cause an electric shock or fire, or damage the heater.
- To prevent a possible fire, DO NOT block the air intakes or exhaust in any manner. DO NOT use on soft surfaces, like a bed, where openings may become blocked.
- A heater has hot and arcing or sparking parts inside. DO NOT use in areas where gasoline, paint, explosive and/or flammable liquids are used or stored. Keep unit away from heated surfaces and open flames.
- Always plug heaters directly into a wall outlet/receptacle. Never use with an extension cord or relocatable power tap (outlet/power strip).
- To avoid fire or shock hazard, plug the unit directly into a 120 V AC electrical outlet.
- To disconnect heater, turn controls to OFF, then remove plug from outlet. Pull firmly on the plug. DO NOT unplug by pulling on the cord.
- Always unplug the unit before moving or cleaning, or whenever the heater is not in use.
- Use only for intended household use as described in this manual. Any other use not recommended by the manufacturer may cause fire, electric shock, or injury to persons. The use of attachments not recommended or sold by unauthorized dealers may cause hazards.
- Always use on a dry, level surface. Use on floor only.
- DO NOT use outdoors.
- WARNING: To reduce the risk of fire or electric shock, DO NOT use this unit with any solid-state speed control device.
- DO NOT attempt to repair or adjust any electrical or mechanical functions this unit. Doing so will void your warranty. The inside of the unit contains no user-serviceable parts. Qualified personnel should perform all servicing only.

- Connect to properly-grounded outlets only.
- PET OWNERS NOTE: The health of birds and some small pets are extremely sensitive to the fumes given off during the initial use of many appliances. Although these fumes are not harmful to humans, it is recommended that this heater not be used around birds and small pets during its initial use until the manufacturing corrosion coatings burn off.
- This appliance is not intended for use by persons (including children) with reduced physical, sensory or mental capabilities, or lack of experience and knowledge, unless they have been given supervision or instruction concerning use of the appliance by a person responsible for their safety.
- Children should be supervised to ensure that they do not play with the appliance.
- WARNING: In order to avoid overheating, do not cover the heater.
- Save these instructions.

SAFETY TIP-OVER PROTECTION FEATURE

- This heater is equipped with a safety tip-over protection feature. Once the heater is tipped over, an internal switch will automatically shut the heater off. Once the heater is restored an upright position, the heater will reset. To continue operation, turn on the heater as shown in the operating instructions.

THERMAL CUT-OFF PROTECTION FEATURE

- This heater is equipped with a thermal cut-off protection feature. When the heater's internal components reach a certain temperature that could cause overheating and possible fire, the heater will automatically shut off. To reset, turn the heater off. Unplug the heater and let it cool down for around 20 minutes. Plug the heater back into the wall outlet and resume operation as shown in the operating instructions.

PARTS LIST

No.	Description	Qty.
1	Filter Cover	1
2	Thermostat Control	1
3	Anti-freeze Setting	1
4	On/Off Power Level/Fan Dial	1
5	Power Indicator Light	1

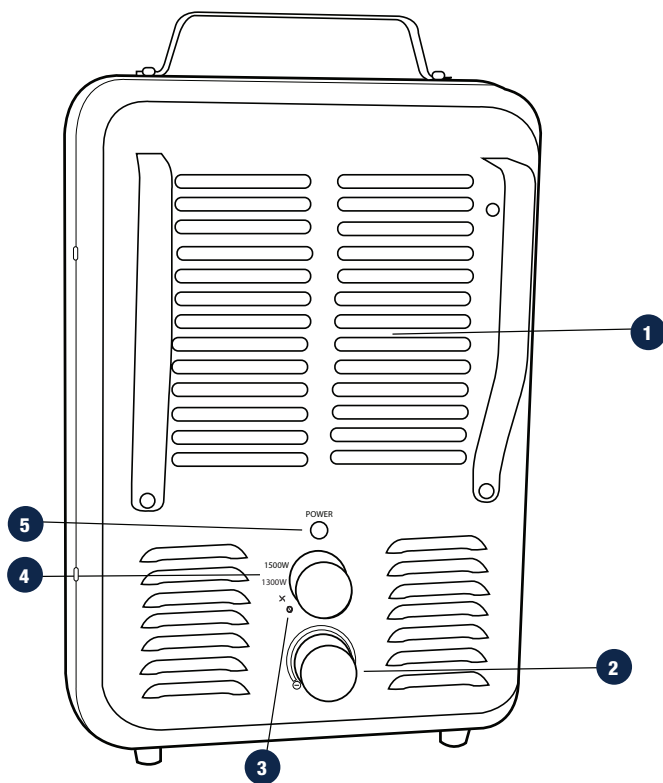

PREPARATION

Place the heater on a firm, level surface, plug into a grounded, 120 V (60 Hz) power outlet and turn the power switch on the front of the unit. Only operate heater in upright position.

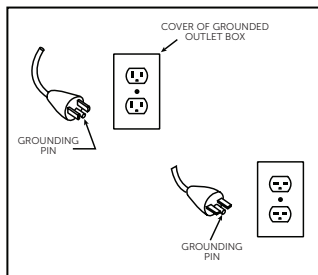

ASSEMBLY INSTRUCTIONS

Before initial use some assembly is required. With a cross-head screwdriver, attach handle to heater body using screws provided as shown in the illustration.

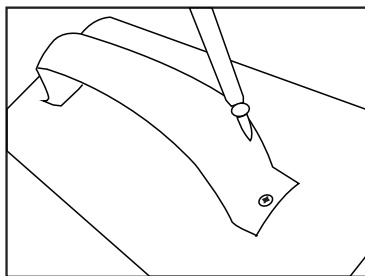

TURNING HEATER ON

- 1 To start the heater, turn the On/Off power level/fan dial from the OFF position to the 1300 or 1500 W setting. Then rotate the thermostat control clockwise to the HIGH thermostat position as described below. During the heaters initial use, you may experience a slight odour or smoking. This is the result of the heating element lubrication "burning off". This is normal and will go away after a few minutes of use.

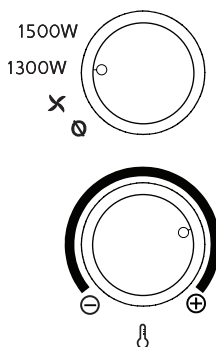

WARNING!

This heater has a voltage rating of 120 V. The cord has a plug as shown. The three-blade grounding plug extending from the adaptor must be connected to a permanent ground such as a properly-grounded outlet box. The adaptor should not be used if a three-slot grounded receptacle is available.

DO NOT DEFEAT THE SAFETY PURPOSE OF THE GROUNDED PLUG.

It is normal for the power cord to feel warm to the touch; however, a loose fit between the outlet and the plug may cause overheating of the plug. If the plug is loose, do not use this outlet. Rather, try inserting the plug into a different outlet. Contact a qualified electrician to inspect the original outlet.

POWER LEVEL SWITCH

- 2 This heater has two heat settings: 1300 and 1500 W. Use the higher setting (1500 W) to raise the room temperature quickly. When the desired temperature is reached, use the lower 1300 W setting. It is usually sufficient to maintain a comfortable temperature.

ADJUSTABLE THERMOSTAT WITH ANTI-FREEZING SETTINGS

- 3 After heater has been turned on and the room has reached the desired temperature, slowly rotate the thermostat knob counter-clockwise until the heater shuts off (you should hear a faint "click"). By leaving the thermostat at this setting it will automatically maintain this temperature. To lower temperature, rotate the knob further counter-clockwise (towards the LOW position). To raise the temperature, rotate the thermostat knob clockwise (towards the HIGH position).

When set to the anti-freeze setting, the heater will turn on whenever the temperature drops below 40°F (4°C), which is helpful to economically prevent ice formation in garages and other unheated spaces.

TURNING OFF

- 4 Turn the On/Off power level/fan dial to the OFF position before unplugging or plugging in the heater. Heater should be unplugged when not in use. To disconnect heater, turn controls to OFF, then remove plug from outlet.

NOTE: To prevent overloading a circuit, do not plug the heater into a circuit that is servicing other electrical needs.

STORAGE

- Store the heater in a cool, dry location when not in use. To prevent dust and dirt build-up, use the original packaging to repack the unit.

CLEANING

1. Turn off the power switch in the rear of the unit.
2. Unplug the unit and let it cool completely.
3. To keep the heater clean, the outer shell may be cleaned with a soft, damp cloth. You may use a mild detergent if necessary. After cleaning, dry the unit with a soft cloth.
CAUTION: DO NOT let liquid enter the heater.
4. DO NOT use alcohol, gasoline, abrasive powders, furniture polish, or rough brushes to clean the heater. This may cause damage or deterioration to the surface of the heater.
5. DO NOT immerse the heater in water.
6. Wait until the unit is completely dry before use.

CLEANING THE AIR FILTER

1. Clean the air filter after three months or if it appears to be blocking airflow. With the heater unplugged, remove the two filter screws. Clean all parts of the filter assembly and allow parts to completely dry.
2. Reassemble and reinstall the filter.
3. DO NOT use the heater without the filter assembly in place.

NOTE:

- Do not operate the heater without the grille in place. Do not use the heater if it has malfunctioned or become damaged in any way. Return heater to authorized facility for examination, electrical or mechanical adjustment or repair.
- The heater may not be operating if the thermostat is set lower than the room temperature. To begin operation, increase the thermostat temperature for a higher heat setting.

This Mastercraft product is guaranteed for a period of **one (1) year** from the date of original retail purchase, against defects in materials and workmanship.

Subject to the conditions and limitations described below, this product, if returned to us with proof of purchase within the stated warranty period and if covered under this warranty, will be repaired or replaced (with the same model, or one of equal value or specification), at our option. We will bear the cost of any repair or replacement and any costs of labour relating thereto.

The warranty is subject to the following conditions and limitations

- a. a bill of sale verifying the purchase and purchase date must be provided;
- b. this warranty will not apply to any product or part thereof which is worn or broken or which has become inoperative due to abuse, misuse, accidental damage, neglect or lack of proper installation, operation or maintenance (as outlined in the applicable owner's manual or operating instructions) or which is being used for industrial, professional, commercial or rental purposes;
- c. this warranty will not apply to normal wear and tear or to expendable parts or accessories that may be supplied with the product which are expected to become inoperative or unusable after a reasonable period of use;
- d. this warranty will not apply to routine maintenance and consumable items such as, but not limited to, fuel, lubricants, vacuum bags, blades, belts, sandpaper, bits, fluids, tune-ups or adjustments;
- e. this warranty will not apply where damage is caused by repairs made or attempted by others (i.e., persons not authorized by the manufacturer);
- f. this warranty will not apply to any product that was sold to the original purchaser as a reconditioned or refurbished product (unless otherwise specified in writing);
- g. this warranty will not apply to any product or part thereof if any part from another manufacturer is installed therein or any repairs or alterations have been made or attempted by unauthorized persons;
- h. this warranty will not apply to normal deterioration of the exterior finish, such as, but not limited to, scratches, dents, paint chips, or to any corrosion or discolouring by heat, abrasive and chemical cleaners; and
- i. this warranty will not apply to component parts sold by and identified as the product of another company, which shall be covered under the product manufacturer's warranty, if any.

Additional Limitations

This warranty applies only to the original purchaser and may not be transferred. Neither the retailer nor the manufacturer shall be liable for any other expense, loss or damage, including, without limitation, any indirect, incidental, consequential or exemplary damages arising in connection with the sale, use or inability to use this product.

Notice to Consumer

This warranty gives you specific legal rights, and you may have other rights, which may vary from province to province. The provisions contained in this warranty are not intended to limit, modify, take away from, disclaim or exclude any statutory warranties set forth in any applicable provincial or federal legislation.

Made in China.

Imported by Mastercraft Canada Toronto, Canada M4S 2B8