

NOMA®

SurfaceElite+™
Portable Spot Cleaner

PRODUCT NO. 043-7128-4

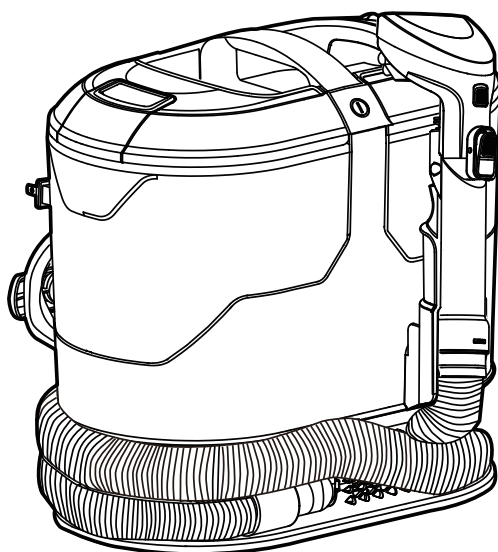

USER MANUAL

— READ AND SAVE THESE INSTRUCTIONS —

NOMA® Customer Support: 1-866-827-4985

SAFETY / CAUTIONS

IMPORTANT SAFETY INSTRUCTIONS

READ ALL INSTRUCTIONS BEFORE USING YOUR PORTABLE SPOT CLEANER.

Always connect a polarized outlet (one slot is wider than the other). Unplug from outlet when not in use and before conducting maintenance. When using an electrical appliance, basic precautions should be observed, including the following:

WARNING TO REDUCE THE RISK OF FIRE, ELECTRIC SHOCK, OR INJURY:

- This product is designed only for clearing a small amount of liquid waste generated by cleaning upholstery/fabric items. Do not use it to vacuum a large amount of water/liquid waste or clean up solid waste to avoid overflow or damage to the cleaner.
- Read the user manual carefully and follow the instructions closely.
- Use your spot cleaner only as described in this user manual. Use only manufacturer's recommended attachments.
- Fully assemble before operating.
- Operate cleaner only at voltage specified on data plate.
- Do not leave spot cleaner when plugged in. Unplug from outlet when not in use and before performing maintenance.
- Do not expose to rain. Store indoors.
- Do not immerse. Use only on carpet moistened by cleaning process.
- Do not allow to be used as a toy. Close attention is necessary when used by or near children.
- Do not use with a damaged cord or plug. If spot cleaner is not working as it should, has been dropped, damaged, left outdoors, or dropped in water, immediately discontinue use and call 1-866-827-4985 for assistance.
- Do not pull or carry by cord, use cord as a handle, close a door on cord, or pull cord around sharp edges or corners. Do not run spot cleaner over cord. Keep cord away from heated surfaces.
- Do not unplug by pulling on cord. To unplug, grasp the plug, not the cord.
- Do not handle plug or spot cleaner with wet hands.
- Do not put any objects into openings.
- Do not use with any opening blocked; keep free of dust, lint, hair, and anything that may reduce airflow.
- Keep hair, loose clothing, fingers, and all parts of body away from openings and moving parts.
- Turn off all controls before unplugging.
- Use extra care when cleaning on stairs. To avoid personal injury or damage, and to prevent the spot cleaner from falling, always place spot cleaner at bottom of stairs or on floor. Do not place spot cleaner on stairs or furniture, as it may result in injury or damage.
- Do not put on chairs, tables, etc. Keep on floor.
- Do not use spot cleaner to pick up flammable or combustible liquids (gasoline, cleaning fluid, perfumes, etc.), or use in areas where they may be present. The fumes from these substances can create a fire hazard or explosion.
- To reduce the risk of health hazards from vapours or dust, do not vacuum toxic materials.
- Do not use or store near hazardous materials.
- Do not pick up anything that is burning or smoking, such as cigarettes, matches, or hot ashes.
- Do not use spot cleaner without tanks in place.
- Do not clean over floor electrical outlets.
- Do not use the spot cleaner to pick up sharp hard objects, small toys, pins, paper clips, etc. They may damage the spot cleaner or dust cup.
- Do not use sharp objects to clean out hose as they can cause damage.

- To help prevent matting and resoiling, avoid contact with carpets until they are dry. Keep children and pets away from carpets until they are completely dry.
- Do not store the spot cleaner with solution in tanks.
- This spot cleaner is provided with double insulation. Use only identical replacement parts. See DOUBLE INSULATION INSTRUCTIONS.
- You are responsible for making sure that your spot cleaner is not used by anyone unable to operate it properly.



CAUTION To reduce the risk of injury from moving parts, unplug before servicing.



WARNING To reduce the risk of electric shock, unplug before cleaning or servicing.

DOUBLE INSULATION INSTRUCTIONS

This spot cleaner is double insulated, eliminating the need for a separate grounding system. Use only identical replacements parts. Read the instructions for Servicing Double-Insulated Spot Cleaners before servicing. Use this spot cleaner as described in this manual. Observe the following warnings that appear on the motor housing of your spot cleaner.



Double Insulated. Grounding not required. When servicing, use only identical replacement parts.



WARNING To reduce the risk of electric shock, do not expose to rain. store indoors.



WARNING For your own safety, read and understand the User Manual. Do not run unattended. Do not pick up hot ashes, coals, toxic, flammable or other hazardous materials. Do not use around explosive liquids or vapours.



WARNING Servicing Double-Insulated Spot Cleaners

With a double-insulated spot cleaner, two systems of insulation are provided instead of grounding. No grounding means is provided on a double-insulated appliance, nor should a means for grounding be added. Servicing a double insulated spot cleaner requires extreme care and knowledge of the system and should be done only by qualified service personnel. Replacement parts for a double-insulated spot cleaner must be identical to the parts they replace. Your double-insulated spot cleaner is marked with the words 'Double Insulated' and the symbol  (square within a square) may also be marked on the appliance.

SAVE THESE INSTRUCTIONS FOR FUTURE USE

This model is for household use only.

TABLE OF CONTENTS

A. KNOW YOUR SPOT CLEANER	05
B. OPERATING INSTRUCTIONS	07
C. CLEANING INSTRUCTIONS	13
D. PRODUCT SPECIFICATIONS	18
E. TROUBLESHOOTING	19
F. WARRANTY AND DISPOSAL	21



KNOW YOUR SPOT CLEANER

FEATURES

01. POWER BUTTON
02. TOOL RELEASE BUTTON
03. HOSE STORAGE HOLDER
04. FLEXIBLE HOSE
05. DIRTY WATER TANK
06. DIRTY WATER TANK COVER RELEASE
07. CARRYING HANDLE
08. POWER CORD
09. CORD HOOKS
10. CLEAN WATER TANK
11. CLEAN WATER TANK CAP
12. TOUGH STAIN TOOL
13. NOMA® CLEANING SOLUTION
14. HOSE CLEANING TOOL

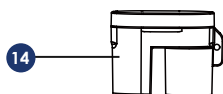
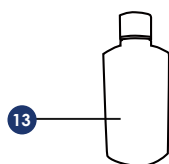
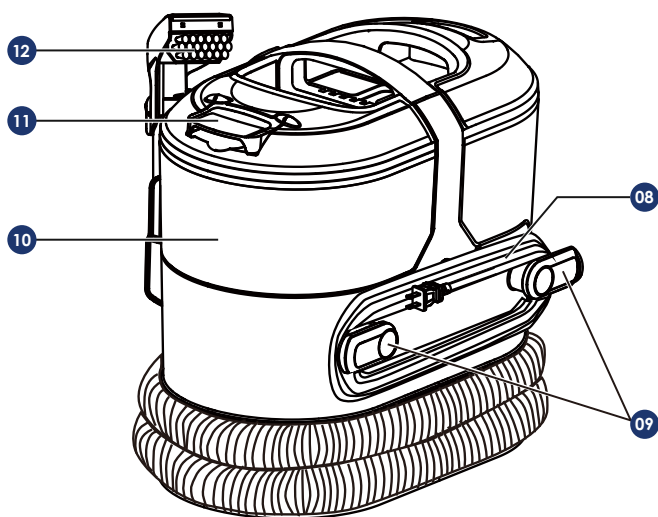
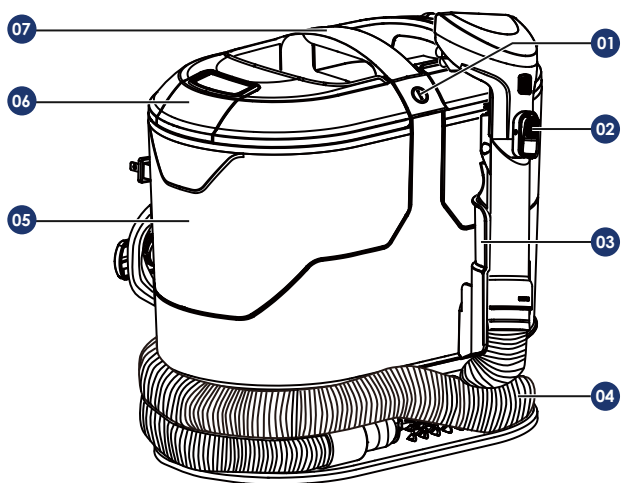

ASSEMBLY

⚠ WARNING

Do not plug in your spot cleaner until you are familiar with all instructions and operating procedures.

Your **SurfaceElite+™ Portable Spot Cleaner** comes in three easy-to-assemble components and a cross-head screwdriver is required to assemble.



Remove all components from the packaging.

- Spot Cleaner Body
- Hose Storage Holder
- Tough Stain Tool

01

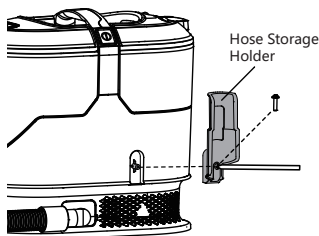

Loosen the screw pre-attached on the hose storage holder. Secure the hose storage holder onto the spot cleaner body with the screw. Tighten the screw with a cross-head screwdriver. Ensure that the screw is secured.

02

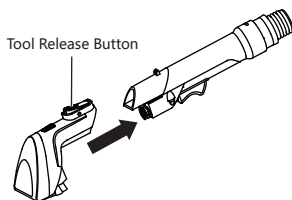

Align the tough stain tool with the end of the hose and insert it into place until you hear a 'click'.

To remove: Press the tool release button and pull out the tough stain tool.

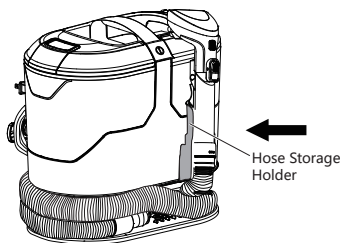

NOTE: Snap the end of the hose with the tool installed into the hose storage holder when not in use.

GETTING STARTED

FILLING THE CLEAN WATER TANK

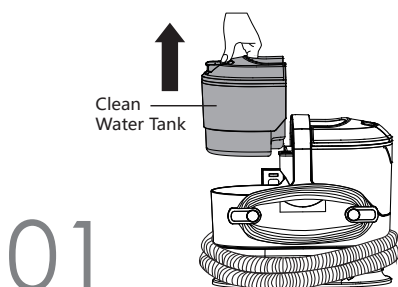

Place the spot cleaner on the ground. Lift up the clean water tank from the side of the unit.

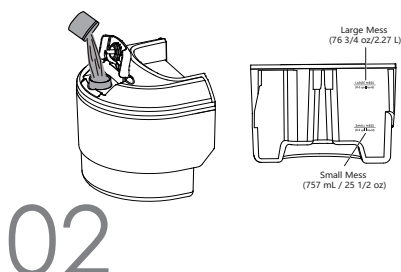

Open the clean water tank cap. Fill the tank with room temperature water to the desired water fill line (for **SMALL** or **LARGE** messes). For a small job, add 3 capfuls (30 mL) of cleaning formula to the tank. For a large job, add 9 capfuls (90 mL) of cleaning formula.

Room Temperature Water	NOMA® Cleaning Solution
Small mess – bottom fill line (757 mL / 25 1/2 oz liquid)	3 caps
Large mess – top fill line (2.27 L / 76 3/4 oz liquid)	9 caps

CAUTION

Do not fill with water above 40°C (104°F).

NOTE: A 236 mL (8 oz) bottle of NOMA® cleaning solution is provided with this spot cleaner. Ensure the cleaning formula and water are mixed correctly. Water must be at room temperature. Always use the NOMA® cleaning solution as directed by the manufacturer. Once depleted, buy replacement NOMA® cleaning solution at Canadian Tire.

Using more than the recommended amount of cleaning formula may cause excessive foaming. **KEEP OUT OF REACH OF CHILDREN.** In case of eye contact, thoroughly flush with cold water. If irritation persists, consult a physician.

03

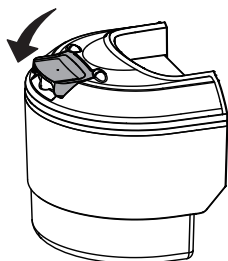

Snap the clean water tank cap back into place.

04

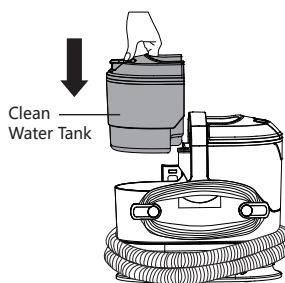

Slide the clean water tank back into the unit, pressing down firmly until it feels secure.

OPERATION

USING THE SPOT CLEANER

NOTE: Make sure that the clean water tank is filled with clean water and the dirty water tank is empty. Both of the tanks must be installed in place properly.

NOTE: Before using the spot cleaner, use a vacuum to remove loose dirt from area to be cleaned. Test a small hidden area for colour fastness. Gently rub surface with a dampened white cloth. Wait 10 minutes and check for colour removal with a white paper towel. If colour changes, do not use.

NOTE: To prevent staining, use plastic or aluminum foil to protect wood or metal surfaces from possible water spray.

To protect the wood floors underneath rugs or carpet, place waterproof material (e.g., plastic) underneath them before cleaning.

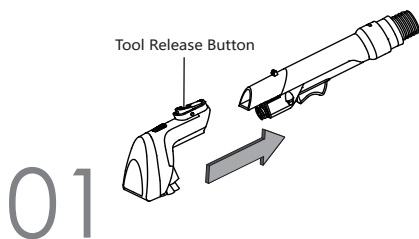

Unwrap the hose from the unit. Check to make sure the tough stain tool is connected securely

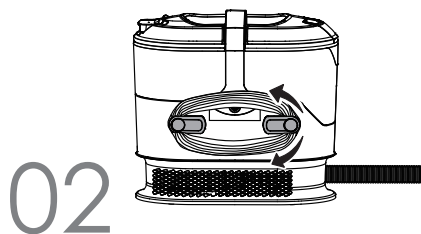

Unwind power cord. For faster unwind or long length, turn the cord hooks inward from either side to release the power cord.

⚠ WARNING To reduce the risk of electric shock, this appliance has a polarized plug (one blade is wider than the other). This plug will fit in a polarized outlet only one way. If the plug does not fit fully in the outlet, reverse the plug. If it still does not fit, contact a qualified electrician to install the proper outlet. Do not change the plug in any way.

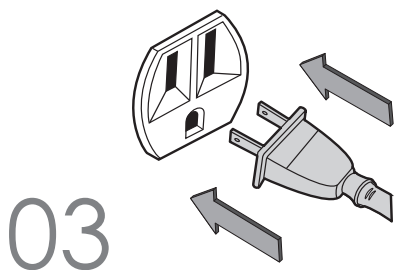

Detach the power cord plug from the power cord. Plug the power cord plug into an outlet located near the floor.

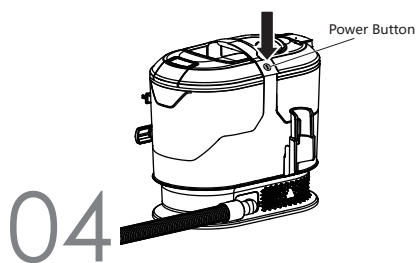

Press the power button to turn on the spot cleaner.

⚠ WARNING

- When any abnormality/failure occurs, stop using the product immediately and disconnect the power plug.
- DO NOT clean over floor electrical outlets. Water will drip from the tool after use and may puddle.

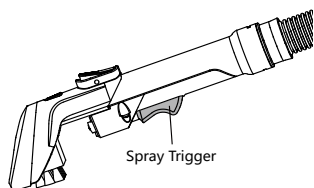

05

Hold the tool about 2.5 cm (1") over the stain to be cleaned. Squeeze the spray trigger to spray a generous amount of cleaning solution over the soiled area. Use the brush on the tool to agitate stains by scrubbing in a back and forth motion.

NOTE: If you find the water output from the brush head is small, release the spray trigger for a while and then press it again.

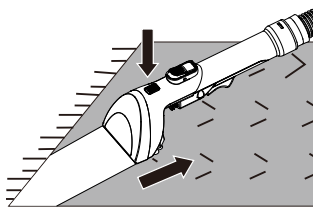

06

To lift away the stain, apply downward pressure on the front of the brush tool and pull the tool backward slowly to vacuum up excess dirty liquids. Repeat as necessary.

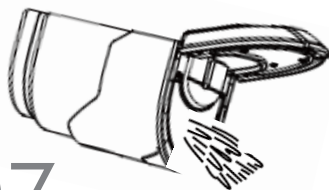

07

Empty the dirty water tank when the dirty liquid reaches the "Max Fill" line and there is a loss in suction. See instructions in **EMPTYING AND CLEANING DIRTY WATER TANK**. Clean the dirty water tank immediately after use to avoid odour.

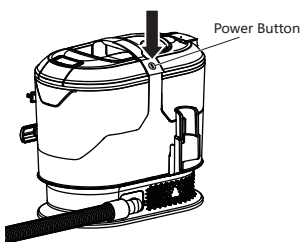

08

Once you have completed cleaning, press the power button and unplug the power cord plug from the outlet.

09

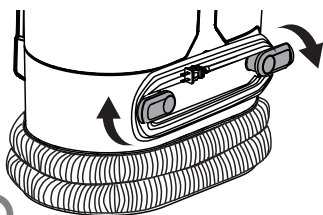

NOTE: Make sure to wrap the power cord around the right cord hook first, and then around the left cord hook to avoid damaging the power cord.

Turn the cord hooks to the proper position and wrap the cord loosely around the cord hooks.



WARNING

Wrapping the cord too tightly with excessive stress on the cord may cause cord damage. A damaged cord is an electric shock hazard and could cause personal injury or damage.

ACCESSORY OVERVIEW

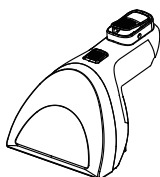

Tough Stain Tool

Use for carpet stains, furniture and other hard-to-reach surfaces.

C CLEANING INSTRUCTIONS

CARE AND MAINTENANCE

WARNING

Disconnect electrical supply before servicing or cleaning the spot cleaner. Failure to do so could result in electric shock or personal injury from spot cleaner suddenly starting.

EMPTYING AND CLEANING DIRTY WATER TANK

WARNING

Always unplug power cord from electrical outlet before performing any service on spot cleaner.

Empty the dirty water tank when the dirty liquid reaches the “Max Fill” line and there is a loss in suction. During normal use, debris may accumulate in the dirty water tank. In order to keep the spot cleaner functioning properly, rinse out the dirty water tank with clean water after each use.

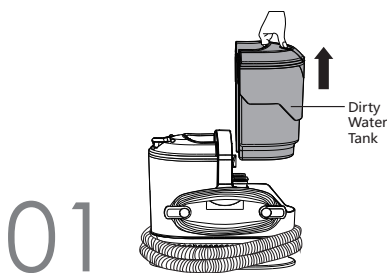

Lift up the dirty water tank from the side of the unit.

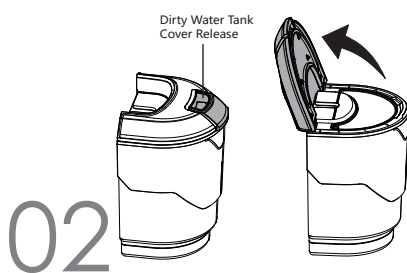

Pull the dirty water tank cover release horizontally, and open the cover.

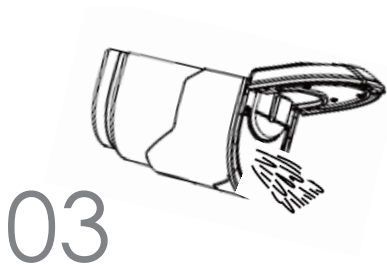

Empty dirty water tank, rinse and let air dry before storage.

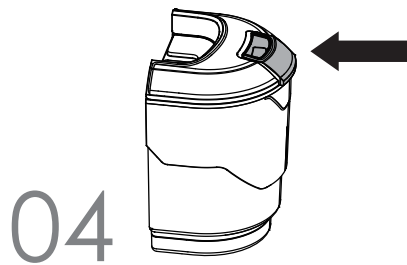

Close the tank cover. Push back the cover release to original place to secure the cover.

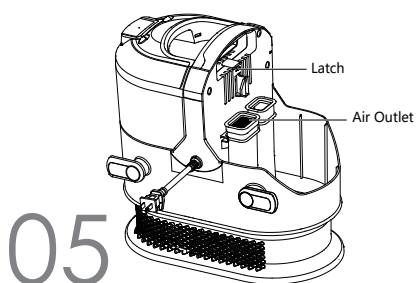

Before replacing tank back into the unit, remove any debris from the air outlet area as shown.

NOTE: The latch mechanism as illustrated can secure the dirty water tank when putting it back.

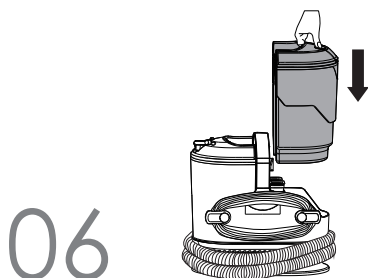

Replace the dirty water tank back into the unit, pressing down until it is locked by the latch.

CLEANING THE TOUGH STAIN TOOL

It is recommended to clean the tough stain tool with water after each use.

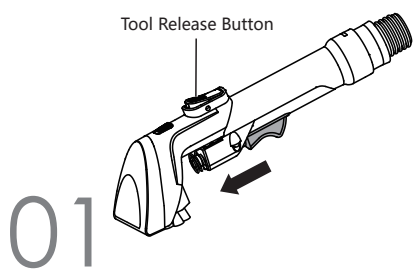

Press the tool release button to remove the tool from the hose.

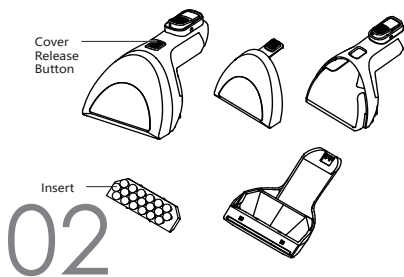

Press the cover release button on the tool and pull off tool cover. Remove the insert by pulling it off with force, if necessary.

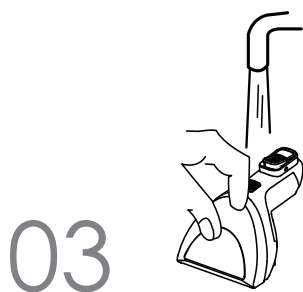

Rinse thoroughly with clean water. Allow the parts to air dry before storage.

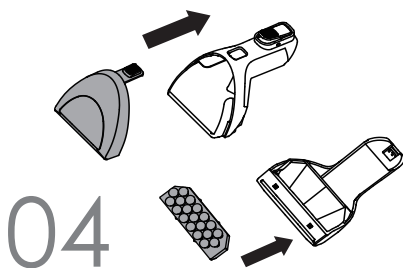

Reinstall the tool cover and the insert back into place until a click is heard.

CLEANING THE FLEXIBLE HOSE

It is recommended to clean the hose using the hose cleaning tool after each use.

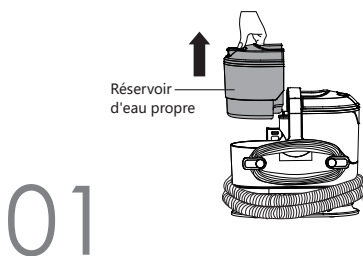

Remove the clean water tank and fill with clean water below 104°F (40°C).

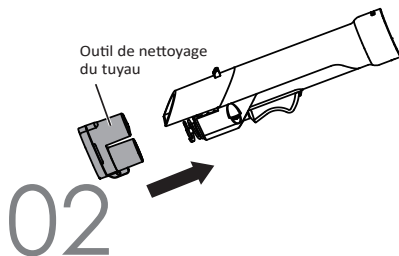

Attach the hose cleaning tool to the hose. Ensure any tools or attachments are removed.

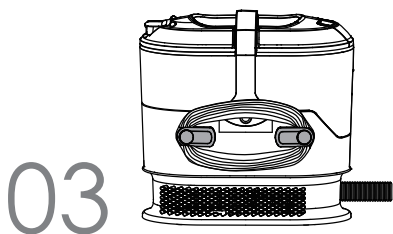

Make sure both the clean and dirty water tanks are secured on the unit.

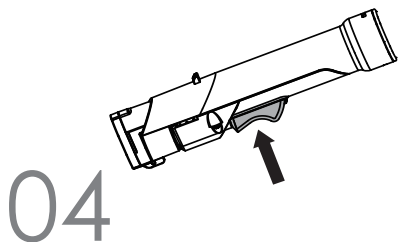

Press the power button to turn the spot cleaner on and hold the spray trigger for 30 seconds. The clean water will rush through the hose, effectively cleaning and removing any trapped dirt and debris in the hose which may build up over time. Repeat as needed. Let the machine run for 5–10 seconds before turning off.

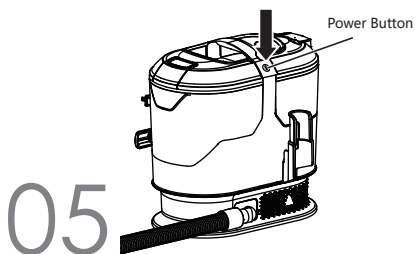

Turn off and unplug spot cleaner.

SPOT CLEANER STORAGE

WARNING

Wrapping the cord too tightly puts stress on the cord and can cause cord damage. A damaged cord is an electrical shock hazard and could cause personal injury or damage.

01. Replace flexible hose and accessory in storage position.
02. Gather the cord and wrap it loosely around the cord hooks. Lock plug retainer onto the power cord.
03. Empty the clean water tank (if necessary). Rinse it out before replacing on the unit. Open the clean water tank cap to allow it to air dry.
04. Empty the dirty water tank then rinse, clean and dry before placing back on the unit. The wide tank opening is designed to fit your hand inside to thoroughly clean, rinse and dry.
05. Store the spot cleaner in a dry, indoor area at room temperature.



PRODUCT SPECIFICATIONS

OVERVIEW

Product Name	NOMA® SurfaceElite+™ Portable Spot Cleaner
Product Model	043-7128-4
Voltage	120 V AC 60 Hz
Current	7 A
Clean Water Tank Capacity	2.5 L
Dirty Water Tank Capacity	1.9 L

E TROUBLESHOOTING

COMMON PROBLEMS

If you have any problem with the product, please complete simple user checklist before contacting NOMA® Customer Support: 1-866-827-4985.

COMMON PROBLEMS	POSSIBLE CAUSES	SUGGESTED SOLUTIONS
The spot cleaner does not work.	Unplugged at wall outlet.	Make sure the unit is fully plugged into a good wall outlet.
	Defective power cord.	Check the power cord for damage. If loose or if any damage found, contact customer support.
Poor job of dirt pick-up.	Dirty water tank is not installed correctly.	Check the dirty water tank for correct installation. Ensure it is installed in place.
	Dirty water tank is full.	Empty the dirty water tank.
	The flexible hose is clogged.	Clean the hose.
	The brush tool is worn.	Replace with new brush tool.
	Incorrect cleaning solution.	Choose NOMA® cleaning solution.
Water escapes from the cleaner.	Dirty water tank is full.	Empty the dirty water tank.
	Dirty water tank is not installed correctly.	Check the dirty water tank for correct installation. Ensure it is installed in place.
	Clean water tank is not installed correctly.	Check the clean water tank for correct installation. Ensure it is installed in place.
The cleaner will not dispense.	Clean water tank is empty.	Fill the clean water tank.
	Clean water tank is not installed correctly.	Check the clean water tank for correct installation. Ensure it is installed in place.

Hose nozzle will not spray after filling the clean water tank.	Air is trapped in the pump and hose.	Turn on the cleaner. If hose does not spray, prime the pump by lowering the hose down to the floor and hold the trigger for up to 1 minute.
Motor noise becomes high-pitched.	Dirty water tank is full.	Empty the dirty water tank.
	The flexible hose is clogged.	Clean the hose.
	The float in the dirty water tank has been activated.	Empty and clean the dirty water tank.



Please do not return this product to store.

For difficulties, questions or concerns, call NOMA® customer service at 1-866-827-4985 and a member of our team will be happy to help you!



WARRANTY AND DISPOSAL

ENVIRONMENTALLY FRIENDLY

3-YEAR LIMITED WARRANTY

This NOMA® product carries a three (3) year warranty against defects in workmanship and materials. At its discretion, NOMA Canada agrees to have any defective part(s) replaced free of charge within the stated warranty period, when returned with proof of purchase. This product is not guaranteed against wear or breakage due to misuse and / or abuse.



You can help protect the environment!

Your appliance contains a number of materials that may be recovered or recycled. Please leave your unit at a local civic waste collection point.



MADE IN CHINA

IMPORTED BY
NOMA CANADA
TORONTO, CANADA M4S 2B8