

NOMA[®] MD

OSCILLATING RADIANT HEATER

model no. 043-5999-2

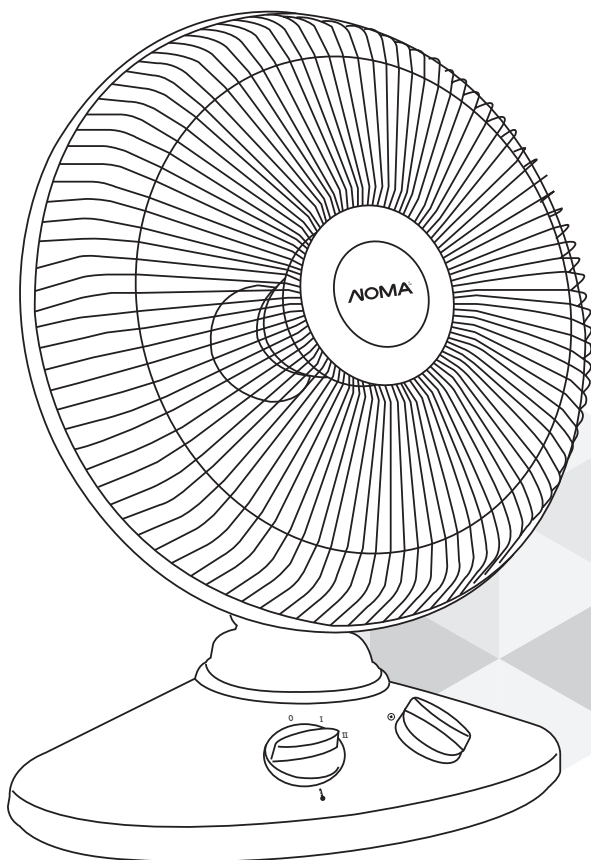

Toll-free 1-866-827-4985

IMPORTANT: Please read this manual carefully before running this heater and save it for reference.

Instruction Manual

Table of Contents

Specifications	2
Packaging Contents	2
Product Diagram	3
Operation	4
Cleaning and Maintenance/Safety Features	6
Important Safeguards	8
Warranty	10

Specifications

Model	043-5999-2
Voltage	120 V AC / 8.33 A
Frequency	60 Hz
Settings	High 1000 W, Low 700 W

Packaging Contents

1. Infrared Heater
2. Instruction Manual

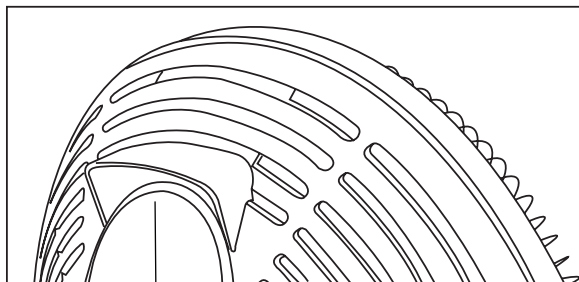

A

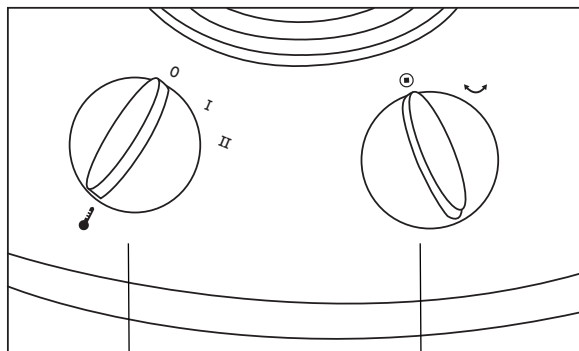

B

C

- O - OFF
- I - LOW Heat (700 W)
- II - High Heat (1000 W)
- Oscillation Function Works in Both HIGH and LOW Settings

- A. Stay-cool Moulded Handle
- B. 3-position Rotary Dial Control
- C. Oscillation Function Control

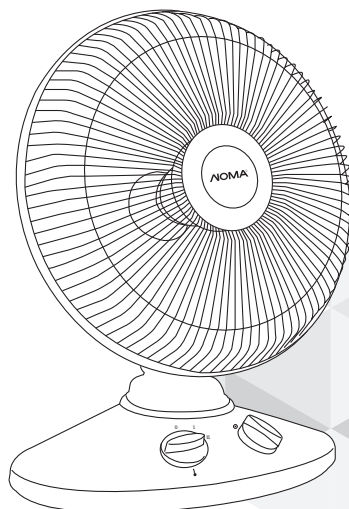

PREPARATION

Place the heater on a firm, level surface.
Plug into a grounded, 120 V (60 Hz) power outlet.

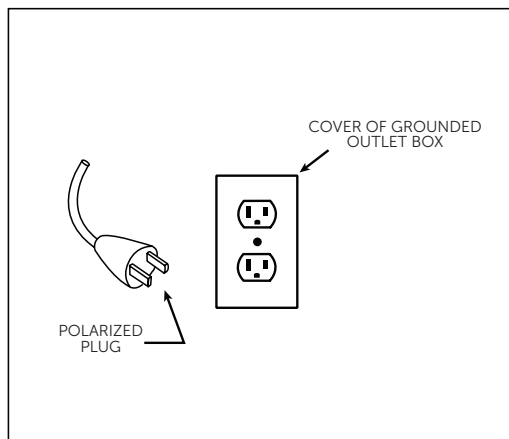

WARNING: This heater has a voltage rating of 120 V. The polarized plug should be connected to a properly grounded three prong outlet.

DO NOT DEFEAT THE SAFETY PURPOSE OF THE POLARIZED PLUG.



WARNING: It is normal for the power cord to feel warm to the touch; however, a loose fit between the outlet and the plug may cause overheating of the plug. If the plug is loose, do not use this outlet. Rather, try inserting the plug into a different outlet. Contact a qualified electrician to inspect the original outlet.

HEATER OPERATION

Always operate the heater in the upright position following all instructions and recommendations listed in this manual. **HEATER LOCATION:** Place the heater in the area of the room that is coldest. **HEATER CONNECTION:** Plug heater directly into 120 V AC, 60 Hz wall outlet. Be sure plug fits tightly in outlet. A loose connection may cause overheating and damage to the plug or heater. **NOTE:** The heater draws 8.33 A during operation. To prevent overloading a circuit, do not plug the heater into a circuit that is servicing other electrical needs.

TURNING HEATER ON

To start the heater, turn the POWER SWITCH (left knob) from the **O** (OFF) position to the **I** (Low –700 W) or **II** (HIGH –1000 W) position. During the heater's initial use, you may experience a slight odour or smoking. This is the result of the heating element lubrication "burning off". This is normal and will go away after a few minutes of use.

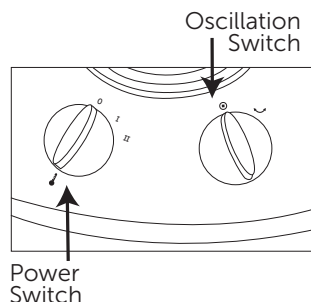

OPERATION SWITCH

This heater has two heat settings:

I (Low –700 W) and **II** (High –1000 W). Use the **II** (High) setting to raise the room temperature quickly. When the desired temperature is reached use the **I** (LOW) setting to maintain temperature. It is usually sufficient to maintain a comfortable temperature.

TILT FEATURE

Your heater can tilt for adjusting the direction of heat. To adjust the angle, loosen tilt adjustment knob and move angle of the heater to desired position. Tighten tilt adjustment knob to hold heater in position. Do not force the heater in either direction beyond its guides.

TURNING OFF

Turn the selector switch to the **"O"** (OFF) position before unplugging or plugging in the heater. Heater should be unplugged when not in use.

OSCILLATION CONTROL

You can turn the oscillation feature on by rotating the oscillation control switch (right knob) to  position.

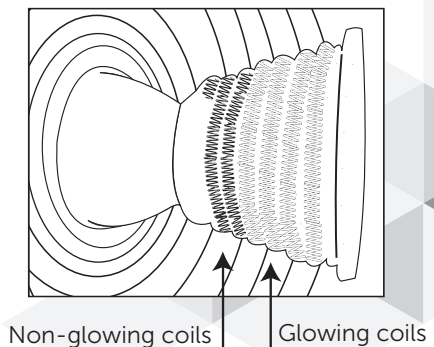

CLEANING:

CAUTION: Before cleaning the heater, be sure to disconnect power cord and allow the heater to cool completely. This heater should be cleaned at least once a year to maintain proper performance. Clean the outside surface with a clean, damp cloth.

Do not use harsh chemical or abrasive cleaners.

DO NOT IMMERSE THE HEATER IN WATER. Allow heater to dry completely before use.

REPAIR:

DO NOT OPERATE THE HEATER WITHOUT THE GRILLE IN PLACE. DO NOT USE THE HEATER IF IT HAS MALFUNCTIONED OR BECOME DAMAGED IN ANY WAY.

STORAGE:

Keep original carton for storage of the heater. Coil and tie the power cord to avoid damage during storage.

IMPORTANT SAFETY FEATURES:

The heater is equipped with an automatic overheat protection device and an automatic tip-over sensor located under the base of the heater. If the heater grille is obstructed, the automatic overheat device will turn the heater off. If the heater is tipped over, the automatic tip-over switch will turn off the heater. If either safety sensor is activated, make sure the heater is on a level surface and clear of all obstacles. Unplug the heater and allow it to cool down. Restart the heater once it has cooled down and obstacles have been removed.

INTENDED USE:

This product is intended for indoor residential and office use only, not for industrial or other commercial application. Use only with electrical wiring that is in good working order and that meets applicable codes and ordinances. This heater must be plugged in to a 120 V AC, 15 A (or larger) circuit. Do not plug anything additional into the same circuit. If you have any questions whether your wiring is adequate, consult a qualified electrician. Risk of fire, overheating, malfunction, property damage, injury or even death may result if not adhered to.

Use your heater only with a working smoke detector located in the vicinity of your heater.

While using your heater, you should follow the **IMPORTANT INSTRUCTIONS** listed below. As part of those instructions, we have used the word **"WARNING"** to indicate the level of hazard: **"WARNING"** indicates a hazard which, if not avoided, could result in injury or death.

IMPORTANT INSTRUCTIONS:

When using electrical appliances, basic precautions should always be followed to reduce the risk of fire, electric shock and injury to persons, including the following:

1. Read all the instructions before using this heater/fan.
2. This heater is hot when in use. To avoid burns, do not let bare skin touch hot surfaces. Use provided handle when moving this heater. Keep combustible materials, such as furniture, pillows, bedding, papers, clothes and curtains at least 3' (0.9 m) from the front of the heater-fan and keep them away from the sides and rear.
3. Do not use heater unattended. Use of extreme caution is necessary when any heater is used by or near children, invalids, disabled persons or pets.
4. Do not operate the heater with a damaged power cord or after the heater malfunctions, has been dropped or damaged in any manner. Return heater to authorized service facility for examination, electrical or mechanical adjustment or repair.
5. Do not use heater outdoors.
6. Use your heater only in dry environments. This heater is not intended for use in a bathroom, laundry area, or similar locations, or near sinks, washing machines, swimming pools or other sources of water. Never locate heater where it may fall into a bathtub or other water container. Do not use in damp environments such as flooded basements.
7. Do not place the heater on a small, unlevel, uneven surface or any surface which might allow heater to tip or fall.
8. For proper operation, heater should be placed on a smooth, non-combustible surface. Do not place on rugs, carpet, vinyl flooring or other plastic surfaces. Not for use outdoors or in wet areas.
9. This heater is not designed as a primary heat source.

10. Always plug heaters directly into a wall outlet/receptacle. Never use with an extension cord or relocatable power tap (outlet/power strip). Always unplug heater when not in use.
11. Do not run power cord under carpeting. Do not cover cord with throw rugs, runners or similar coverings. Arrange cord away from traffic area where it will not be tripped over.
12. To disconnect heater, turn controls off then remove plug from outlet.
13. Do not insert or allow foreign objects to enter any ventilation or exhaust opening as this may cause an electric shock or fire or damage the heater.
14. To prevent a possible fire, do not block air intakes or exhaust in any manner. Do not use on soft surfaces like a bed, where openings may become blocked.
15. A heater has hot and arcing or sparking parts inside. Do not use it in areas where gasoline, paint or flammable liquids are used or stored.
16. Use this heater only as described in this manual. Any other use not recommended by the manufacturer may cause fire, electric shock or injury to persons or property.

WARNING: SHOCK HAZARD

Use your heater only in dry environments. This heater is not intended for use in a bathroom, laundry area, or similar locations, or near sinks, washing machines, swimming pools or other sources of water. Never locate heater where it may fall into a bathtub or other water container. Do not use heater outdoors. Do not use in damp environments such as flooded basements.

WARNING: HOT SURFACES

Do not touch body of heater when in use. This heater is hot when in use, to avoid burns, do not let bare skin touch hot surfaces. If provided, use handles when moving this heater.

WARNING: FIRE HAZARD

Heater has hot and arcing or sparking parts inside. Do not use near combustible materials or flammable gases or sources of heat. DO NOT USE in areas where gasoline, paint or flammable materials are used or stored. Keep combustible materials such as furniture, pillows, bedding, papers, clothes and curtains at least 3' (0.9 m) from the front of the heater and keep them away from the sides and rear. To prevent a possible fire, do not block air intakes or exhaust in any manner. Do not use on soft surfaces, like a bed, where openings may become blocked. Do not place the heater near a bed because objects such as pillows or blankets can fall off the bed and be ignited by the heater. Do not insert or allow foreign objects to enter any ventilation or exhaust opening as this may cause an electric shock, fire, or damage the heater.

WARNING: ELECTRIC SHOCK HAZARD

Do not use with damaged cord or plug. Use with adequate electrical system that is up to code.

The supply cord has a polarized plug. As a safety feature this plug will fit in a polarized outlet only one way. To prevent electric shock, match wide blade of plug to wide slot and fully insert plug. If the plug does not fit, contact a qualified electrician.

Do not operate any heater with a damaged cord or plug, or after heater malfunctions, has been dropped or damaged in any manner. Do not operate heater with a broken heating element or ceramic cone or any visual imperfections. For repairs covered under warranty, see warranty statement. For all other repairs contact by telephone or mail for information and assistance.

PET OWNERS NOTE:

The health of birds and some small pets are extremely sensitive to the fumes given off during the initial use of many appliances. Although these fumes are not harmful to humans, it is recommended that this heater not be used around birds and small pets during its initial use until the manufacturing corrosion coatings burn off.

LIMITED 1-YEAR WARRANTY

This product carries a **one (1) year** warranty against defects in workmanship and materials. NOMA Canada agrees to replace a defective product, within the stated warranty period, when returned to the place of purchase with **proof of purchase**. This product is not guaranteed against wear or breakage due to misuse and/or abuse.