

MASTER
Chef™

10 X 20" FLAT TOP ELECTRIC GRIDDLE

Model no. 043-5782-6

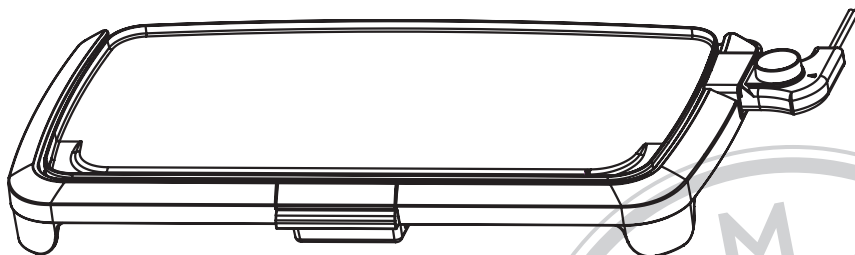

INSTRUCTION MANUAL

Read this booklet thoroughly before using this product and save it for future reference.

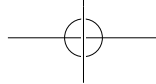

Model no. 043-5782-6 | Contact us: 1-855-803-9313

Important Safeguards	2-3
Know your Griddle	4
How to use Griddle	4-5
Cleaning and Maintenance	6
Warranty	7

11. Extreme caution must be used when moving an appliance containing hot oil or grease.
12. Be careful as the appliance may cause oil splashing during cooking. It is recommended to use oven mitts or pot holders.
13. Do not operate the appliance for other than its intended use.
14. This appliance is not intended for use by persons (including children) with reduced physical, sensory or mental capabilities, or lack of experience and knowledge, unless they have been given supervision or instruction concerning use of the appliances by a person responsible for their safety.
15. This appliance can be used by children aged from 8 years old and above and persons with reduced physical, sensory or mental capabilities or lack of experience and knowledge if they have been given supervision or instruction concerning use of the appliance in a safe way and understand the hazards involved.
16. Children should not play with the appliance. Cleaning and user maintenance should not be made by children without supervision."
17. Before using, ensure the voltage on the rating label corresponds with the mains voltage in your home.

IMPORTANT SAFEGUARDS

Before using the electrical appliance, the following basic precautions should always be followed including the following:

1. Read all instructions. Save these instructions for future reference.
2. To prevent scalding, do not touch hot surface. Use control knobs and handles.
3. To protect against electric shock do not immerse cord, plugs, or the body of the appliance in water or other liquids.
4. Close supervision is necessary when any appliance is used by or near children.
5. Unplug from power outlet when not in use, before attaching or removing parts, and before cleaning. To unplug, grasp the plug and pull to remove from power outlet. outlet. Never pull from the power cord.
6. Do not operate any appliance with a damaged cord or plug or after the appliance malfunctions, or is dropped or damaged in any manner. Return appliance to the nearest authorized service facility for examination, repair or electrical or mechanical adjustment.
7. The use of accessories not recommended by the manufacturer may cause injuries to persons.
8. Do not use outdoors.
9. Do not let cord hang over the edge of a table or touch hot surfaces.
10. Do not place on or near a hot gas or electric burner, or in a heated oven.



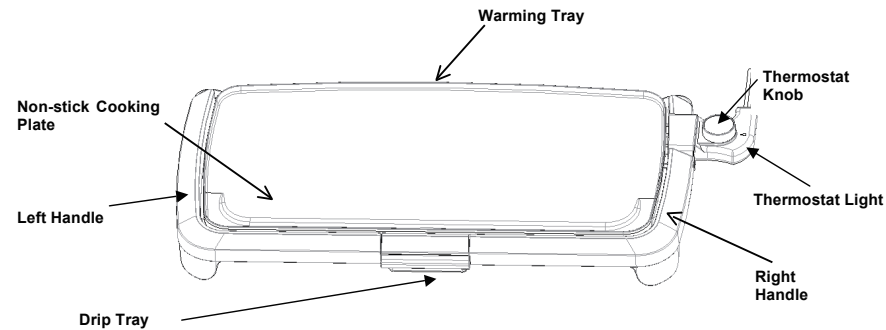

Unpack the unit and place it on a flat horizontal countertop. Wipe the outer surface and non-stick plate with a soft, damp soft cloth. Plug the appliance into a power outlet to start preheating. It is recommended to coat a layer of vegetable oil on the cooking surface when preheating. This helps to protect the non-stick surface. Some odour may be emitted during initial preheating; this is normal and will disappear after one or two uses.

1. Before use, check that the cooking plate is clean and free from dust and food particles. Wipe with a damp cloth if necessary.
2. Plug the appliance into a power outlet and adjust the temperature. The orange light will be illuminated. The orange light indicates that the heating element is on and will turn off when the heating element is turned off by the thermostat.
3. It will take approximately 10 minutes for the griddle to preheat to the desired temperature. Then you can place food onto the cooking plate.
4. Make sure the drip tray is positioned correctly. Place the prepared plate on unit. It is recommended to use oven mitts or pot holders to reduce the risk of injury from touching hot surface.
5. Grilling time should be approximately 20 minutes. Exact grill time will vary according to your personal taste and food being grilled.
6. Once the grilling has finished, remove grilled food with a plastic or wooden spatula. Never use metal utensils as this will damage the non-stick coating.
7. Disconnect the power supply and press the button to release the pot after unit cool down. When the unit has completely cooled down, you can clean the drip tray.
8. **Note:** The appliance has an auto-shut off function to ensure safety after continuous 3 hours operation. Disconnect from the power outlet and plug it in again to reset it.

Model no. 043-5782-6 | Contact us: 1-855-803-9313

SAVE THESE INSTRUCTIONS HOUSEHOLD USE ONLY



Before first use

Carefully unpack your Griddle and remove all packing materials. To remove any dust that may have accumulated during packing, wipe with a damp, lint-free cloth or sponge.

Assemble the temperature control plug, warming tray and drip tray correctly.

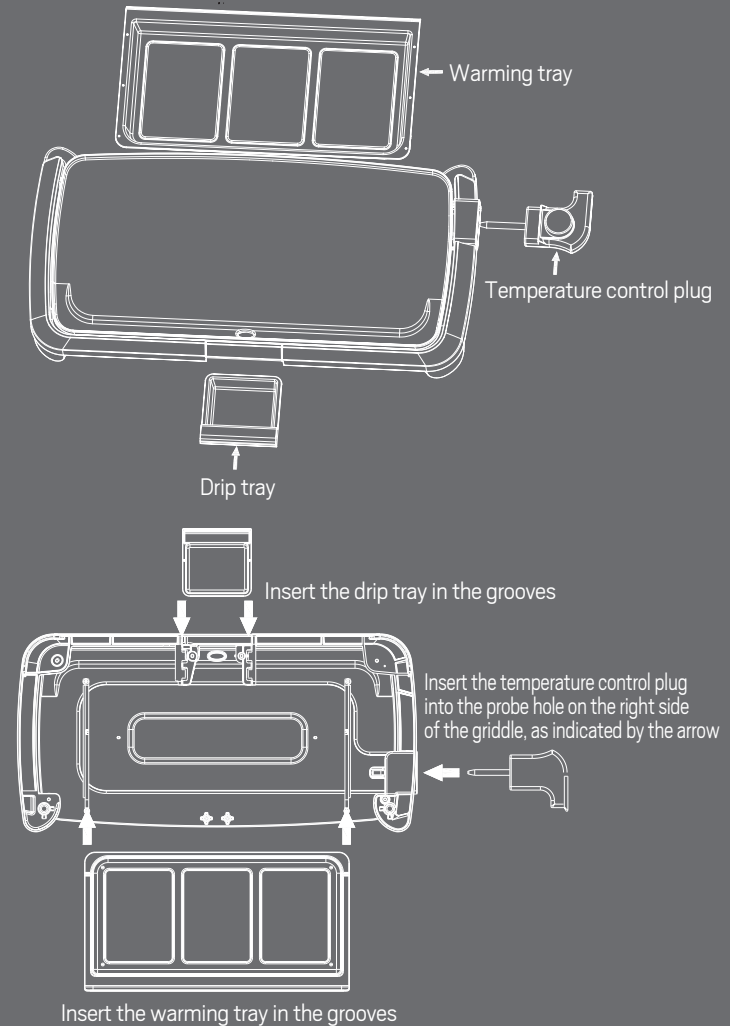

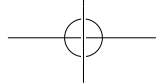

6

7

Model no. 043-5782-6 | Contact us: 1-855-803-9313

MASTER
Chef™

How to use Griddle



Temperature Control Knob

Turn the temperature dial to select the temperature. The electric griddle will heat up to and maintain the maximum temperature as shown below when operating stably.

Setting 1: 110 °C ±20 °C (230 °F ±36 °F)

Setting 2: 140 °C ±20 °C (284 °F ±36 °F)

Setting 3: 160 °C ±20 °C (320 °F ±36 °F)

Setting 4: 180 °C ±20 °C (356 °F ±36 °F)

Setting 5: 200 °C ±20 °C (392 °F ±36 °F)



Notes for Power cord:

- a) A short power-supply cord (or detachable power-supply cord) is provided to reduce risks resulting from becoming entangled in or tripping over a longer cord.
- b) Longer detachable power-supply cords or extension cords are available and may be used if care is exercised in their use.
- c) If a long detachable power-supply cord or extension cord is used:
 - 1) The marked electrical rating of the detachable power-supply cord or extension cord should be at least as great as the electrical rating of the appliance;
 - 2) If the appliance is of the grounded type, the extension cord should be a grounding type 3-wire cord;
 - 3) The longer cord should be arranged so that it will not drape over the counter top or table top where it can be pulled on by children or tripped over

1. Unplug the appliance and wait for it to completely cool down before cleaning.
 2. Clean warming tray and drip tray. Warming tray can be placed in dishwasher for cleaning. Immerse the drip tray into warm, soapy water and clean. Rinse and dry. It is recommended not to wash the drip trays in a dishwasher as it is likely to become deformed and deteriorate after several washes.
 3. Wipe the cooking plate with absorbent paper or toweling or a soft cloth. Never use abrasive cleaner to wipe the non-stick cooking plate.
- WARNING:** Never immerse the appliance into water for cleaning as electric shock may occur.
4. Store the appliance in a safe clean place.

Cleaning and Maintenance

1-Year Limited Warranty

This product carries a one (1) year warranty against defects in workmanship and materials. Trileaf Distribution agrees to replace the defective product free of charge within the stated warranty period, when returned by the original purchaser with proof of purchase. This product is not guaranteed against wear, misuse and/or abuse.

Made in China

Imported by Trileaf Distribution Trifeuil Toronto, Canada M4S 2B8

WARRANTY

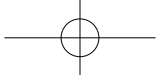

Customer service hotline:
Masterchef Tel: 1-855-803-9313