



PADERNO^{TM/MC}

User Manual 2-SLICE EVEN-HEAT TOASTER

Model No. TOA005

Product No. 043-5271-2



Product No. 043-5271-2

The Paderno™ 2-Slice Even Heat Toaster with wide slots allows you to perfectly toast your favourite bread and bagels. The intuitive dial with 9 heat settings provides you precise control for perfect results every time.

Table of Contents

IMPORTANT SAFETY INSTRUCTIONS	4
Technical Information	6
Using Your Toaster	8
Cleaning and Maintenance	10
Troubleshooting	11
Our Guarantee	12

UNDERSTAND SIGNAL WORDS

A signal word – DANGER, WARNING or CAUTION – is used with the safety alert symbol. DANGER denotes the most serious hazards, resulting in severe personal injury or death if instructions are not immediately followed. WARNING indicates that severe personal injury or death could result if instructions are not followed. CAUTION indicates a potentially hazardous situation, which, if not avoided, could result in minor to moderate injury.

WARNING: Do not store or use gasoline or other flammable vapours, liquids or material near this or any other appliance.

NOTE: This appliance is NOT designed for installation in manufactured (mobile) homes or in recreational vehicles (RVs). DO NOT install this appliance outdoors.

IMPORTANT SAFETY INSTRUCTIONS

When using electrical appliances, basic safety precautions should always be followed including the following:

1. Please read the instructions carefully before using any appliance.
2. Always ensure that the voltage on the rating label corresponds to the mains voltage in your home.
3. To protect against fire, electric shock and injury to persons do not immerse cord, plug, or appliance in water or other liquid.
4. Close supervision is necessary when any appliance is used by or near children.
5. DO NOT operate any appliance with a damaged cord or plug or after the appliance malfunctions, or has been damaged in any manner. The appliance should not be repaired or opened by an unlicensed person. Refer to the "Our Guarantee" section regarding the product's warranty before returning the appliance to the point of purchase.
6. DO NOT place on or near a hot gas or electric burner, or in a heated oven.
7. The cord is short to prevent accidents.
8. DO NOT use outdoors.
9. DO NOT let cord hang over edge of table or counter, or touch hot surface.
10. DO NOT use appliance for other than intended use.
11. DO NOT modify this appliance.
12. Unplug from outlet when not in use and before cleaning. Allow appliance to cool before attaching or removing parts and before cleaning the appliance.
13. DO NOT try to put out a fire or flames with water: turn off the appliance, remove the plug from the socket and smother the flames with a fire blanket or any other appropriate means.
14. The use of accessories not recommended by the appliance manufacturer may result in fire, electric shock or injury to persons.
15. Extreme caution must be used when moving the appliance.

-
16. The toaster can get very hot during operation. Do not touch any hot surfaces. Use the control knob functions or the toaster lever.
 17. Make sure the toaster lever is elevated before you plug in or unplug the toaster.
 18. Make sure that the air around the toaster can circulate freely. DO NOT place anything on top of the toaster. A fire may occur if the toaster is covered with or touch flammable material, including curtains, draperies, walls or similar, when in operation.
 19. DO NOT try to remove food from the toaster when it is plugged in.
 20. DO NOT insert oversized food, metal foil packages, metallic objects such as knives, forks, spoons into the toaster as they may involve a risk of fire or electric shock.
 21. To disconnect, make sure all controls are turned off, then unplug the cord from the wall outlet.
 22. DO NOT attempt to dislodge food when the toaster is plugged in.
 23. DO NOT use this appliance as a source of heating or drying.
 24. DO NOT leave toaster unattended during operation.

**SAVE THESE
INSTRUCTIONS
THIS PRODUCT
IS INTENDED FOR
HOUSEHOLD USE
ONLY**

Technical Information

Polarized Plug

This appliance has a polarized plug (one blade is wider than the other). To reduce the risk of electric shock, the plug will fit in a polarized outlet only one way. If the plug does not fully fit the outlet, reverse the plug and reinsert. If it still does not fit, contact a qualified electrician. DO NOT modify the plug in any way.

Notes on the Power Cord

A short power-supply cord (or detached power-supply cord) is provided to reduce risks resulting from becoming entangled in or tripping over a long cord.

Longer detachable power-supply cords or extension cords are available and may be used if care is exercised in their use.

If a long detachable power-supply cord or extension cord is used:

- The marked electrical rating of the detachable power-supply cord or extension cord should be at least as great as the electrical rating of the appliance.
- If the appliance is of the grounded type, the extension cord should be a grounding-type 3-wire cord.

- The longer cord should be arranged so that it will not drape over the counter top or table top where it can be pulled on by children or tripped over.

Electric Power

If the electric circuit is overloaded with other appliances, your appliance may not operate. It should be operated on a separate electrical circuit from other appliances. If you are not sure the reason of overloading or cannot find a separate circuit, contact a qualified electrician.

Volts: 120 Volts AC only.

Hertz: 60 Hz

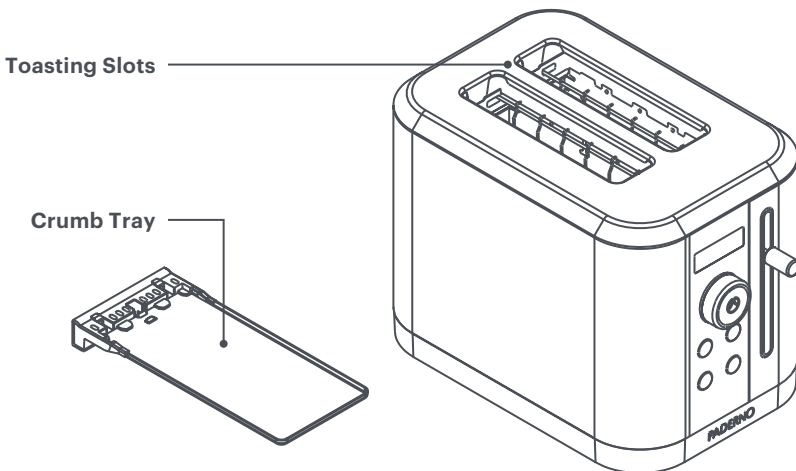
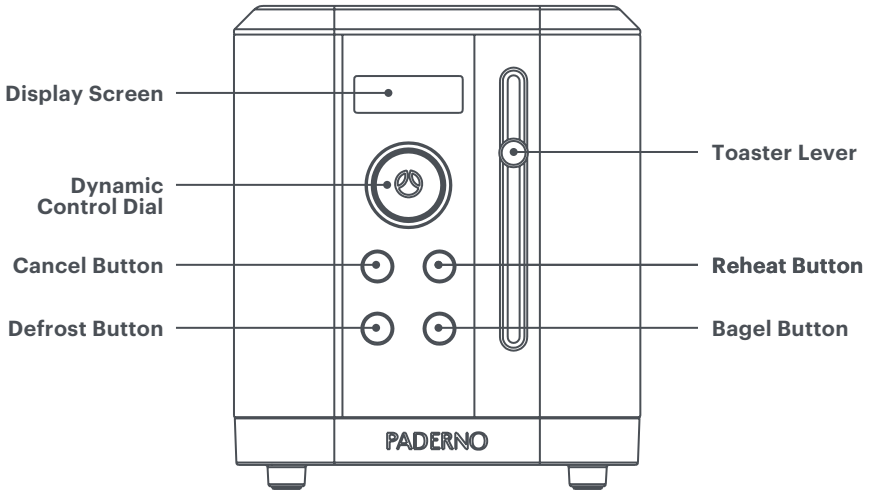

Note: Product may vary slightly from illustration.

Using Your 2-Slice Even-Heat Toaster

Quickly toast your favourite breads and bagels in your Paderno™ 2-Slice Even-Heat Toaster.

WARNING: Electrical Shock Hazard

- Do not use an adaptor
- Failure to follow these instructions could result in death, fire or electrical shock

CAUTION

- During first use there may be some smoke and odours. This is normal and not detrimental to the performance of the toaster.
- The toaster must always be used in the upright position.
- Before each use, make sure that the crumb tray is in its proper location.
- The toasting lever must be in the raised position before plugging in or unplugging from an outlet.
- If the bread jams in the slots after toasting, the unit will automatically shut off. Unplug immediately from the outlet and wait for the toaster to cool before attempting to remove.
- Do not toast bread thicker than 1 inch in the toasting slots.
- Do not put paper towels, cardboard or plastic in, on or under the toaster.

Before First Use

1. Remove all stickers and any packing or printed material that might have fallen inside during shipping or handling. Do not probe inside the toaster with a metal object.
2. Refer to the Cleaning & Maintenance section of this manual. Clean the appliance thoroughly before first use.
3. Use the toaster for the first time without any bread in it.
4. Turn the Dynamic Control Dial to increase the power level to 9 and press the toaster lever down. In this way you will burn off any dust that has fallen into the toaster during production or transport.

NOTE: During first use there may be some smoke and odours.

Operating Instructions

1. If necessary, shorten the cord by wrapping it under the base.
2. Plug in the toaster.
3. Insert the bread in the slot. Remember that bread is not normally square, you may need to turn the bread on its side to get a better fit and optimize the toasting surface area.
4. Rotate the Dynamic Control Dial to choose the desired browning level (Level 1 to 9, light to dark).

5. Push down on the toaster lever to begin the toasting operation.
6. During toasting, rotate the Dynamic Control Dial to increase or decrease the toasting time by increments of 5 seconds for a total of up to 30 seconds.
7. Selecting the Defrost button will defrost frozen bread and toast it to the desired browning level.
8. Selecting the Bagel button will toast one side only to the desired browning level. Defrost can also be selected with the Bagel button to defrost frozen bagels and toast them to the desired browning level.
9. Selecting the Reheat button will begin a shorter toasting cycle to warm up bread or bagels that have already been toasted.
10. When the timer countdown reaches "0:00", the toaster lever will automatically release.
11. Selecting the Cancel button during the toasting operation will cancel the cycle.
12. The toaster will go into sleep mode after 2 minutes of inactivity. Rotate the dial, press the Cancel button, or push the toaster lever down to wake the toaster up.

WARNING: If the appliance is not plugged in, the toaster lever will not lock.

User Hints & Tips

1. The first batch of toast enables the heating elements to reach the correct toasting temperature. Please note that further batches of toast could take less time.
2. Remember that the type of bread used will impact toasting times. Fresher bread will take longer to toast. Adjust the browning level and toasting time accordingly.
3. For best results, try the following:
 - Toast only one type of bread at a time.
 - Toast bread slices of the same thickness.
 - Use bread slices no thicker than 1" (2.5 cm).
 - If using hand-cut bread, try to cut slices as evenly as possible.
 - Be aware that very thin or broken slices of bread could burn.

Cleaning and Maintenance

Care and Maintenance

CAUTION: Be sure to unplug this appliance and allow it to cool down before cleaning the toaster or crumb tray. To protect against electrical shock, do not immerse cord, plug or unit in water or liquid. After each use, always make sure plug is first removed from wall outlet.

- To keep the surfaces in good condition, clean regularly after use. Let them cool first.
- Never use abrasive cleaners or chlorine-based acids.
- Wipe the surface using the damp cloth, then wipe over thoroughly and dry with a soft cloth or microfibre cloth.

NOTE: If grease or oil splatters on the toaster, wipe it off immediately using a clean, damp cloth.

- Do not use metallic sponges or sharp scrapers as they will damage the surfaces.

Cleaning the Crumb Tray

1. Push the crumb tray to unlock it, and then pull to slide it out and empty it. The crumb tray should be emptied after each use.
NOTE: The crumb tray is hand-washable. Always dry the tray thoroughly before putting it back in the toaster.
2. Put the crumb tray back in the toaster. Press it in firmly until it clicks into position. Do not use the toaster without the crumb tray in the proper position.

The appliance should not be repaired or opened by an unlicensed person. Refer to the “Our Guarantee” section regarding the product’s warranty before returning the appliance to the point of purchase.

Disposal of Appliance

DO NOT dispose of this product in household waste. Many parts of this product are recyclable. Dispose of as per the requirements of your local municipality.

The appliance is packed in non-polluting and recyclable materials. Dispose of the packing materials at an appropriate disposal facility.

WARNING: Danger of suffocation from plastic packaging. Do not leave the packaging or any part of it unattended. Do not let children play with the plastic bags.

Troubleshooting

WARNING: Electrical Shock Hazard

- Do not use an adaptor
- Failure to follow these instructions could result in death, fire or electrical shock

If toaster fails to operate, check the following:

1. Check that the toaster is plugged into a grounded 3-prong electrical outlet. If it is, unplug the toaster.
2. Plug in the toaster.
3. If the toaster still does not work, check the household fuse or circuit breaker.

Our Guarantee

If you experience any issues with your Paderno™ 2-Slice Even-Heat Toaster, please refer to the warranty terms below to determine the corrective course of action.

2-Year Limited Warranty

Padinox Inc. ("Paderno") has been fuelling your passion for cooking since 1979. This iconic Canadian brand gives you outstanding durability and performance, so you can concentrate on the important things, like what to make next.

That's why we stand by all our products! Starting from the date of purchase, Paderno warrants that your Kitchen Appliance is free from any manufacturing defects in materials or workmanship for a period of 2 years.

This warranty is only offered on Paderno appliances sold and used in Canada. The Paderno warranty covers all costs related to restoring the proven defective product through the repair or replacement of any defective part and necessary labour so that it conforms to its original specifications. A replacement product may be provided instead of repairing a defective product at Paderno's discretion.

The Paderno warranty does not apply to appliances that have been used commercially or in non-household applications. The warranty does not cover damages resulting from misuse or abuse of the product and/or uses inconsistent with this Use and Care manual, attempts at repair, theft, use with unauthorized attachments or failure to follow the instructions provided with the product. This warranty becomes void if attempts at repair are made by non-authorized third parties and/or if spare parts, other than those provided by Paderno, are

used. You may also arrange for service after the warranty expires at an additional cost. **There are no other express warranties except as set forth herein and any applicable implied warranties of merchantability and fitness (or those provided for by law) are limited in duration to the period of coverage of this express written limited warranty.**

CONTACT:

If you have any trouble with the product during the warranty period, please visit us online at **www.Paderno.com** or contact us at: **1-800-263-9768** or via email **customer.service@padinox.ca**

Padinox Inc. Toronto Canada M4P 2V8

A receipt indicating the purchase date is required for any claims, so please keep it in a safe place. We recommend that you register your product on our website **<https://www.paderno.com/pages/product-registration>**

Although greatly appreciated, the product registration is not required to activate any warranty and product registration does not eliminate the need for the original proof of purchase.



Cook. For life.

Valued by professional chefs and passionate home cooks alike, PADERNO™ offers an exceptional level of durability and performance guaranteed.

Connect with us at paderno.com to learn more and register your product.

For questions and concerns, please contact:
Customer.service@padinox.ca
1-800-263-9768