



PADERNO^{TM/MC}

User Manual ELECTRIC FOOD SLICER

Model No. FDS023

Product No. 043-1032-6



Product No. 043-1032-6

The PADERNO™ Electric Food Slicer is durable, powerful and quiet with precise and safe control. Adjust the thickness for slicing a variety of foods including meats, cheese, vegetables and bread. Prepare fresh, delicious sandwiches, charcuterie boards and other dishes with ease and convenience.

Table of Contents

IMPORTANT SAFETY INSTRUCTIONS	4
Technical Information	6
Using Your Food Slicer	8
Cleaning and Maintenance	10
Our Guarantee	11

IMPORTANT SAFETY INSTRUCTIONS

When using electrical appliances, basic safety precautions should always be followed including the following:

Important Safeguards

- | | |
|---|--|
| <p>1. Read all instructions before using. Save these instructions for future reference.</p> <p>2. Only plug the food slicer into a grounded power outlet. Check that the voltage on the rating label of the appliance corresponds to that of the mains voltage in your home.</p> <p>3. To protect against fire, electric shock and injury to persons, do not immerse cord, plug or machine in water or other liquids.</p> <p>4. DO NOT operate any appliance with a damaged cord or plug or after the appliance malfunctions, or has been damaged in any manner. The appliance should not be repaired or opened by an unlicensed person. Refer to the "Our Guarantee" section regarding the product's warranty before returning the appliance to the point of purchase.</p> <p>5. This appliance is not intended for use by persons (including children) with reduced physical, sensory, or mental capabilities, or lack of experience and knowledge, unless they are closely supervised and instructed concerning use of the appliance by a person responsible for their safety. Close supervision is necessary when any appliance is used by or near children. Children</p> | <p>should be supervised to ensure that they do not play with the appliance.</p> <p>6. Always disconnect the appliance from the power supply if it is left unattended and before assembling, disassembling or cleaning.</p> <p>7. DO NOT let cord hang over edge of table or counter or touch hot surfaces.</p> <p>8. DO NOT place appliance on or near a hot gas or electric burner, or in a heated oven.</p> <p>9. Switch off the appliance and disconnect from supply before changing accessories or approaching parts that move during use.</p> <p>10. Only use accessory attachments recommended by the appliance manufacturer. The use of accessory attachments not recommended by the appliance manufacturer may cause injuries.</p> <p>11. Turn the appliance OFF, then unplug from the outlet when not in use, before assembling or disassembling parts and before cleaning. To unplug, grasp the plug and pull from the outlet. Never pull from the power cord.</p> |
|---|--|

12. Avoid contact with moving parts.
DO NOT feed food into the slicer by hand. Always use completely assembled slicer with food carriage and food pusher.
13. The use of attachments not recommended or sold by the manufacturer may cause fire, electric shock or injury.
14. The blade is extremely sharp and must be handled with caution.
15. DO NOT use this appliance outdoors.
16. DO NOT use this appliance for other than its intended use.

**SAVE THESE
INSTRUCTIONS
THIS PRODUCT
IS INTENDED FOR
HOUSEHOLD
USE ONLY**

Technical Information

Polarized Plug

This appliance has a polarized plug (one blade is wider than the other). To reduce the risk of electric shock, the plug will fit in a polarized outlet only one way. If the plug does not fully fit the outlet, reverse the plug and reinsert. If it still does not fit, contact a qualified electrician. DO NOT modify the plug in any way.

Notes on the Power Cord

A short power-supply cord (or detached power-supply cord) is provided to reduce risks resulting from becoming entangled in or tripping over a long cord. Longer detachable power-supply cords or extension cords are available and may be used if care is exercised in their use.

If a long detachable power-supply cord or extension cord is used:

- The marked electrical rating of the detachable power-supply cord or extension cord should be at least as great as the electrical rating of the appliance.
- If the appliance is of the grounded type, the extension cord should be a grounding-type 3-wire cord.
- The longer cord should be arranged so that it will not drape over the counter top or table top where it can be pulled on by children or tripped over.

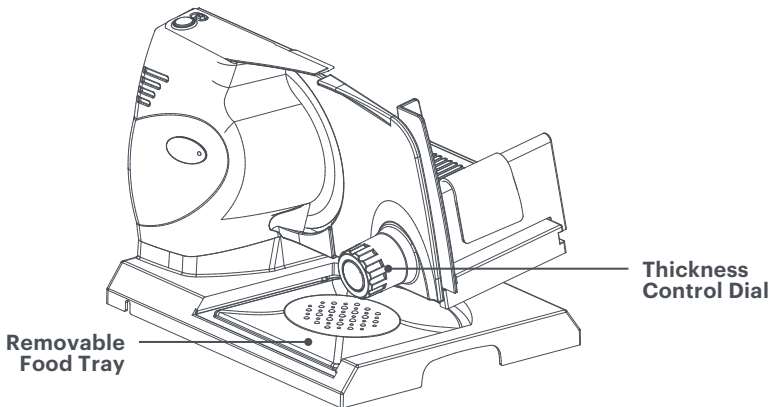
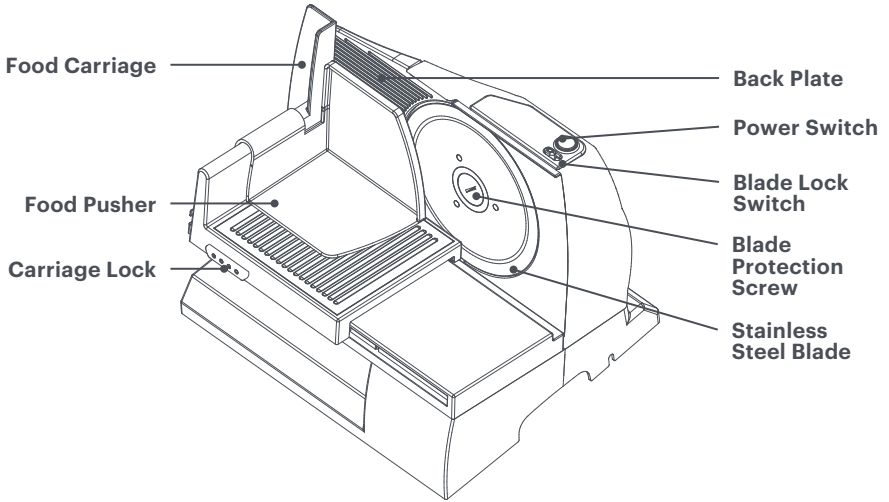

Note: Product may vary slightly from illustration.

Using Your Electric Food Slicer

Effortlessly and precisely prepare sliced meats, cheeses, vegetables, bread and much more with your PADERNO™ Electric Food Slicer.

Operating Instructions

1. Place the food slicer on a flat surface. Ensure there is enough space to slide the food carriage without reaching across the blade.
2. Place the food on the food carriage and push the food firmly against the back plate.
3. Align the food pusher by placing it on the food carriage with the teeth against the food.
4. Select the desired slice thickness using the thickness control dial on the back of the slicer. The thickness can be adjusted up to 1" (2.5 cm).
5. Switch the food slicer on by sliding the blade lock switch to the unlocked position and pressing the Power button, as shown in Fig. 1.

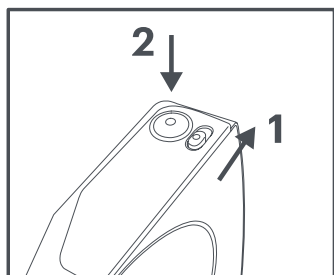

Fig. 1

6. For Pulse mode, hold the blade lock switch in the unlocked position while pressing and releasing the power button, as shown in Fig. 2.

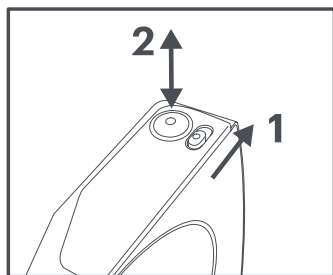

Fig. 2

7. For Continuous mode, release the blade lock switch while holding the power button. When the blade lock switch is in the locked position, release the power button, as shown in Fig. 3.

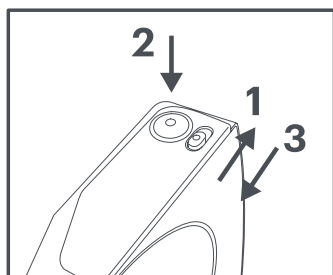

Fig. 3

8. Hold the food in place using the food pusher.
NOTE: Always use the food pusher when slicing food as the blade is extremely sharp.

9. Slide the carriage back and forth along the housing to slice the food, as shown in Fig. 4. The food will fall onto the food tray.

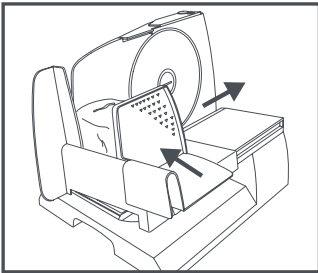

Fig. 4

NOTE: Do not reach across the blade when slicing.

NOTE: Do not use the food slicer for more than 3 minutes at one time.

10. When slicing is finished, switch the appliance off by sliding the Blade Lock Switch (as shown in Fig. 5) and collect the food slices from the removable tray. Turn the thickness control dial back to 0 after use.

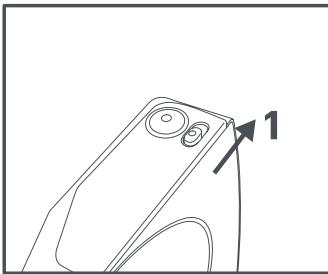

Fig. 5

11. Before storing the food slicer, push the Food Carriage to the far right and slide the Carriage Lock left to lock it in place. This will ensure it is secure when being stored.

Cleaning and Maintenance

Cleaning and Maintenance

1. Disconnect the slicer from the power supply and ensure the thickness control dial is set at 0.
2. Wipe down the housing of the food slicer using a damp cloth and soap.
NOTE: Never immerse appliance in water or any other liquid.
3. The food carriage, food pusher and tray can be removed for cleaning. Wash the food carriage in warm water with soap. Wash the food pusher and tray in warm water with soap or in a dishwasher.
4. Remove the blade by rotating the blade protection screw clockwise. Remove the screw and then carefully remove the blade.
5. Wash the blade in warm water with soap. Dry thoroughly before placing the blade back on the appliance and securing it with the blade protection screw. Do not use abrasive cleaners.
NOTE: Do not remove grease behind the blade when cleaning. Ensure the blade protection screw is correctly inserted after cleaning. The screw should be tightened by hand, but must be flush with the blade for proper assembly.

CAUTION: Use caution when handling the blade as it is extremely sharp.

The appliance should not be repaired or opened by an unlicensed person. Refer to the “Our Guarantee” section regarding the product’s warranty before returning the appliance to the point of purchase.

Disposal of Appliance

DO NOT dispose of this product in household waste. Many parts of this product are recyclable. Dispose of as per the requirements of your local municipality.

Our Guarantee

If you experience any issues with your PADERNO™ Electric Food Slicer, please refer to the warranty terms below to determine the corrective course of action.

2-Year Limited Warranty

Padinox Inc. ("PADERNO") has been fuelling your passion for cooking since 1979. This iconic Canadian brand gives you outstanding durability and performance, so you can concentrate on the important things, like what to make next.

That's why we stand by all our products! Starting from the date of purchase, PADERNO warrants that your Kitchen Appliance is free from any manufacturing defects in materials or workmanship for a period of 2 years.

This warranty is only offered on PADERNO appliances sold and used in Canada. The PADERNO warranty covers all costs related to restoring the proven defective product through the repair or replacement of any defective part and necessary labour so that it conforms to its original specifications. A replacement product may be provided instead of repairing a defective product at PADERNO's discretion.

The PADERNO warranty does not apply to appliances that have been used commercially or in non-household applications. The warranty does not cover damages resulting from misuse or abuse of the product and/or uses inconsistent with this Use and Care manual, attempts at repair, theft, use with unauthorized attachments or failure to follow the instructions provided with the product. This warranty becomes void if attempts at repair are made by non-authorized third parties and/or if spare parts, other than those provided by

PADERNO, are used. You may also arrange for service after the warranty expires at an additional cost. **There are no other express warranties except as set forth herein and any applicable implied warranties of merchantability and fitness (or those provided for by law) are limited in duration to the period of coverage of this express written limited warranty.**

CONTACT:

If you have any trouble with the product during the warranty period, please visit us online at **www.PADERNO.com** or contact us at: **1-800-263-9768** or via email **customer.service@padinox.ca**

Padinox Inc. Toronto Canada M4P 2V8

A receipt indicating the purchase date is required for any claims, so please keep it in a safe place. We recommend that you register your product on our website - **<https://www.PADERNO.com/pages/product-registration>**

Although greatly appreciated, the product registration is not required to activate any warranty and product registration does not eliminate the need for the original proof of purchase.



Cook. For life.

Valued by professional chefs and passionate home cooks alike, PADERNO™ offers an exceptional level of durability and performance guaranteed.

Connect with us at PADERNO.com to learn more and register your product.

For questions and concerns, please contact:
Customer.service@padinox.ca
1-800-263-9768