

Variable Speed Immersion Blender

User Manual

Model
HH1001208
SKU
043-0768-2

vida[™]
by PADERNO

Table of Contents

| | |
|------------------------------|----|
| Important Safeguards | 04 |
| Notes on the Cord | 05 |
| Blender Configuration | 06 |
| Chopper Configuration | 06 |
| Whisk Configuration | 07 |
| Using Your Immersion Blender | 07 |
| Using the Chopper | 08 |
| Using the Whisk | 09 |
| Cleaning and Maintenance | 10 |
| Quick Cleaning | 10 |
| Our Guarantee | 11 |

4

Important Safeguards

Before using the electrical appliance, basic precautions should always be followed, including the following:

1. Read all instructions. Save these instructions for future reference.
2. Check that the wall outlet voltage corresponds to the one shown on the rating plate.
3. Do not operate any appliance with a damaged cord, plug, or after the appliance malfunctions, is dropped, or is damaged in any manner. The appliance should not be repaired or opened by an unlicensed person. Refer to the "Our Guarantee" section regarding the product's warranty before returning the appliance to the point of purchase.
4. If the power cord is damaged, it must be replaced by the manufacturer, an authorized service agent, or a qualified technician in order to avoid a hazard.
5. Turn the appliance OFF, then unplug from the power outlet when not in use, before assembling or disassembling parts and before cleaning. To unplug, grasp the plug and pull from the power outlet. Never pull from the power cord.
6. Do not let cord hang over the edge of a table or touch hot surfaces.
7. To protect against the risk of electric shock, do not immerse the upper part of the blender in water or other liquids.
8. Close supervision is necessary when your appliance is being used near children.
9. Avoid contact with moving parts.
10. Keep hands and utensils out of the container while blending or chopping food to reduce the risk of severe injury to persons, or damage to the unit. A scraper may be used but must only be used when the unit is not running.
11. The appliance cannot be used for chopping ice or blending hard and dry substances; the blade could be damaged or become dull.
12. To reduce the risk of injury, never place chopper blade into chopper jar without setting jar on a smooth, horizontal surface.
13. Be sure chopper lid is securely locked in place before operating the appliance. Do not open chopper lid until the blades completely stop.
14. The use of accessory attachments not recommended by the manufacturer may cause personal injury or damage the appliance.
15. Do not operate the appliance for other than its intended use.
16. This appliance should not be used by children, and care should be taken when used near children.

5

17. Do not let the cord contact hot surfaces, including the stove.
18. Do not use outdoors.
19. Always remove the blade assembly before pouring contents from jar.
20. Be sure to switch off the appliance after each use. Make sure the motor stops completely before disassembling.
21. The metal blades are extremely sharp, please handle carefully.
22. Always hold the blade stem instead of cutting edge when handling and cleaning the blade.
23. Any misuse can lead to injury. Care shall be taken when handling the sharp cutting blades, emptying the bowl and during cleaning.
24. Be careful if hot liquid is poured into the bowl or cup as it can splash and cause burns.
25. This appliance is intended for household use only.
26. This appliance is not intended for use by persons (including children) with reduced physical, sensory or mental capabilities, or lack of experience and knowledge, unless they have been given supervision or instruction concerning use of the appliance by a person responsible for their safety.
27. The running time of the unit without food or liquids should not exceed 15 seconds.
28. If the machine stops working due to the activation of the thermal safety device as a result of temperature, it can be restarted after the internal temperature drops.

SAVE THESE INSTRUCTIONS HOUSEHOLD USE ONLY

Notes on the Cord

This appliance has a polarized plug (one blade is wider than the other). To reduce the risk of electric shock, this plug will fit in a polarized outlet only one way. If the plug does not fit fully into the outlet, reverse the plug. If it still does not fit, contact a qualified electrician. Do not modify the plug in any way.

6

Blender Configuration

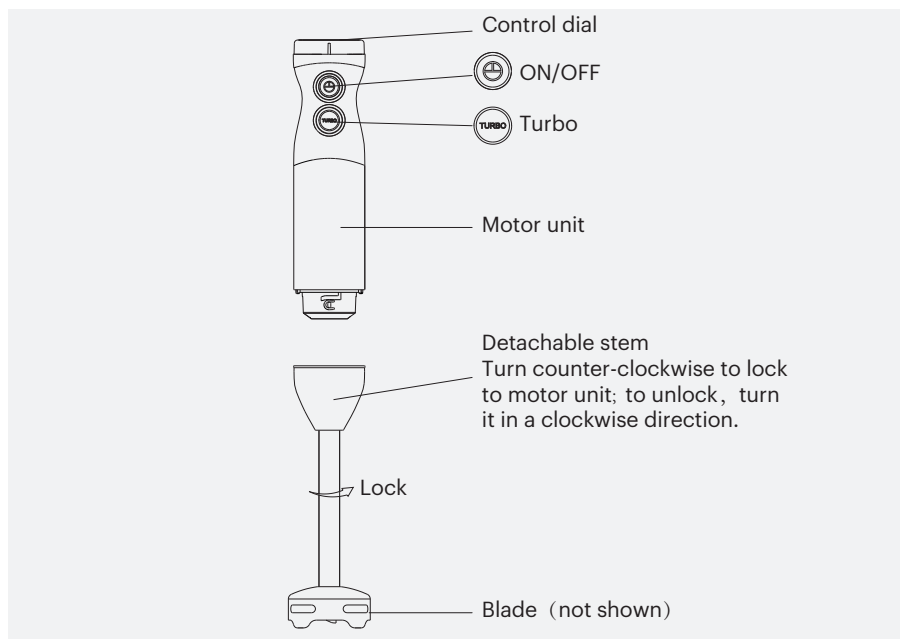

Chopper Configuration

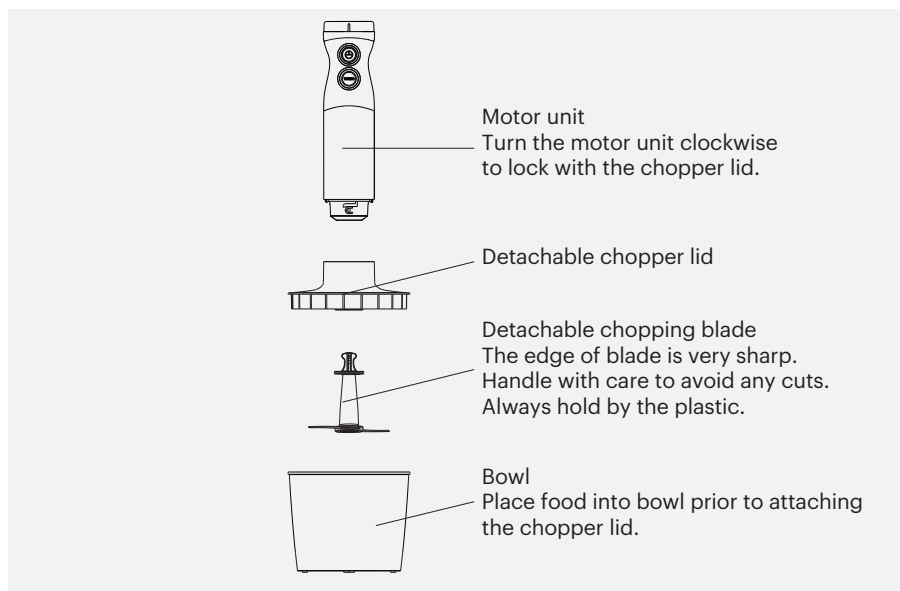

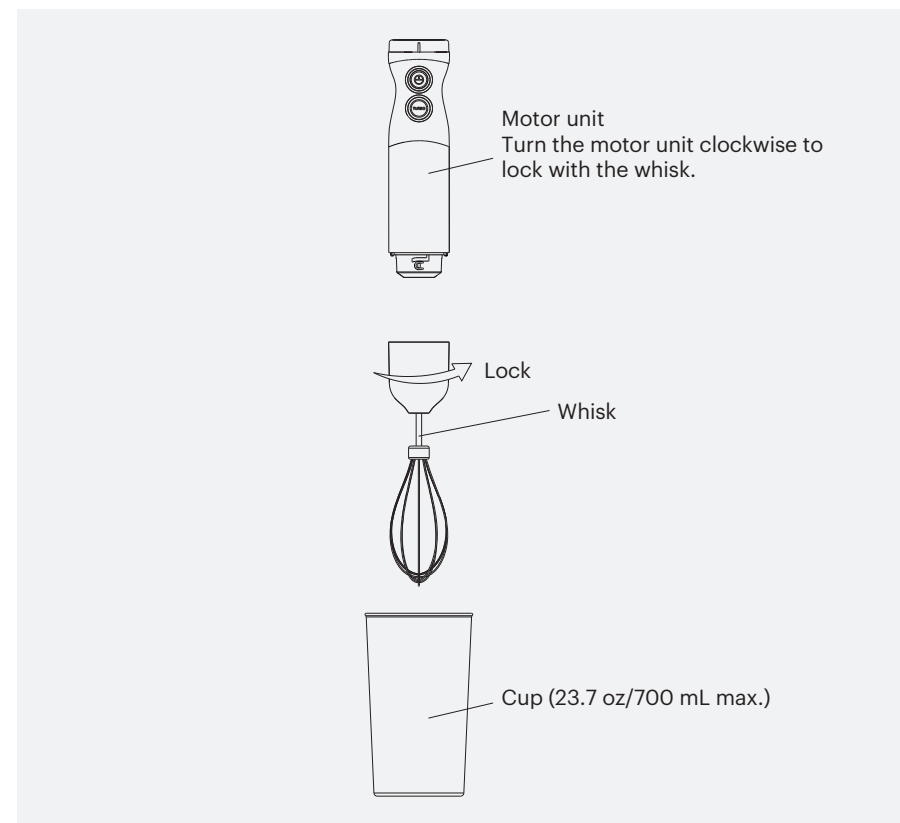

7

Whisk Configuration



Using Your Immersion Blender

Before the first use, clean the blender according to the "Quick Cleaning" section.

1. The maximum continuous run time is 1 minute. The immersion blender must rest for 3 minutes between each use cycle.
2. To assemble the detachable shaft with the motor unit, turn the shaft in a counter-clockwise direction until tightened. To disassemble, turn in clockwise direction.
3. Plug the hand blender into a power outlet.
4. Lower the hand blender into food and press the ON button  at the top of the motor unit.
5. To stop the hand blender, release the ON button  at the top of the motor unit.

8

- When blending hard vegetables, dice into 3/8" (1 cm) cubes and add liquid prior to blending. Do not exceed 10 oz (280 g) of hard vegetables and add 15 oz (420 g) liquid before blending. For example, when blending carrot, cut carrots into small pieces, place them into the chopper bowl, and add 1 3/4 c (420 g) water before blending.

Note: There is a speed control knob that you can spin clockwise to increase speed and counter-clockwise to decrease speed while the ON button is pressed. If the turbo button  is pressed instead of the ON button, the speed control dial will not affect speed.

Using the Chopper

- The maximum continuous run time in the chopper configuration is 30 seconds. The immersion blender must rest 3 minutes between each run cycle.
 - Place the chopper bowl on a clean, level surface.
 - Assemble the stainless steel chopping blade into the chopper bowl (see Fig. 1).
 - Place food into the chopper bowl.
 - Attach the lid onto the chopper bowl until it locks into position (see Fig. 2).
 - Attach motor unit to the chopper assembly by screwing the motor unit onto the lid of the chopper (see Fig. 3).
 - Plug the appliance into a power outlet and press the ON button to begin operation.
 - To stop the appliance, release the ON button  at the top of the motor unit.
 - After finishing chopping, unplug the cord from the outlet first, then remove the motor unit from the chopper lid by turning it counter-clockwise.
 - Open the chopper lid and remove the chopped food.
- Caution:**
- To reduce the risk of injury, never place cutting blade on base without first placing the bowl properly in place.
 - Ensure the chopper lid is securely locked in place when operating the appliance.
 - Do not remove the chopper lid with the immersion blender motor unit attached. Disconnect chopper bowl with lid from the immersion blender motor first, then remove chopper lid from bowl.

9

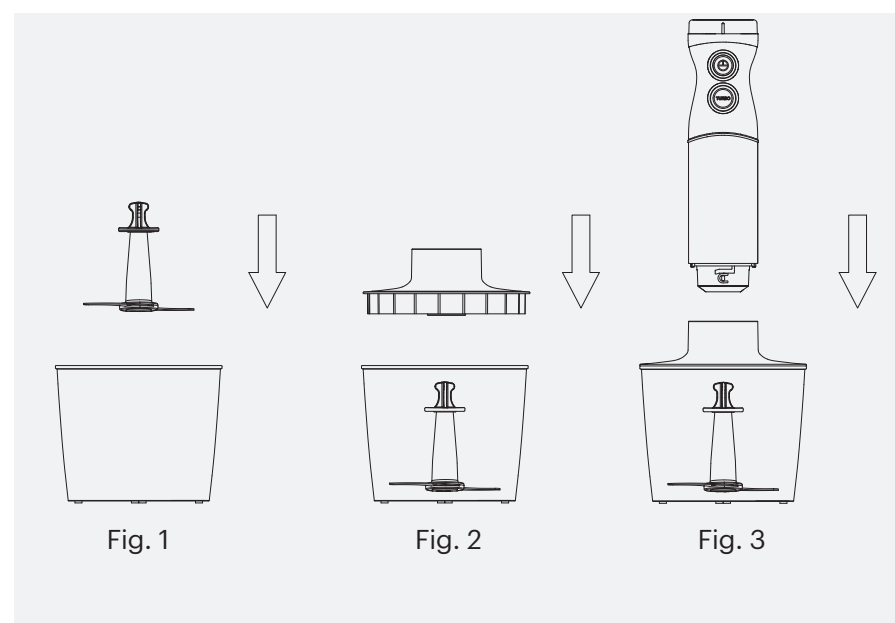



Fig. 1

Fig. 2

Fig. 3

Using the Whisk

The maximum continuous run time in the whisk configuration is 2 minutes. The immersion blender must rest 3 minutes between each run cycle.

- To assemble the whisk to the motor unit, turn the whisk in a counter-clockwise direction until tightened. To disassemble, turn in a clockwise direction.
- Plug the hand blender into a power outlet.
- Place food into the cup.
- Lower the immersion blender into food and press the ON  switch at the top of the motor unit.
- To stop the hand blender release the ON  switch at the top of the motor unit.

Cleaning and Maintenance

1. Unplug the appliance and remove the detachable stem.
NOTE: Do not immerse the detachable stem of the blender in water as the lubrication on the bearings may wash away.
2. Wash the detachable stem under running water, without the use of abrasive cleaner or detergents. Place upright so that any water that may have entered the unit can drain out. The stem is dishwasher safe.
3. Wash the cup, bowl, whisk and blade in warm, soapy water. It is recommended that the bowl and whisk not be placed in the dishwasher as the plastic component may deteriorate after prolonged use.
4. Wipe the motor housing with a damp cloth. Never immerse it in water for cleaning as there is risk of electric shock.
5. Dry thoroughly.
Caution: Blades are very sharp; handle with care.

Quick Cleaning

Between uses or before first use, place the detachable stem in 1 cup (250 mL) of warm water and run for a few seconds.

Our Guarantee

2-Year Limited Warranty:

Starting from the date of purchase, Vida by PADERNO warrants that your product is free from any manufacturing defects in materials or workmanship for a period of 2 years. This warranty is only offered on Vida by PADERNO products sold and used in Canada. The Vida by PADERNO warranty covers all costs related to restoring the proven defective product through the repair or replacement of any defective part and necessary labour so that it conforms to its original specifications. A replacement product may be provided instead of repairing a defective product at Vida by PADERNO's discretion.

The Vida by PADERNO warranty does not apply to products that have been used commercially or in non-household applications. The warranty does not cover damages resulting from misuse or abuse of the product and/or uses inconsistent with this Use and Care manual, attempts at repair, theft, use with unauthorized attachments or failure to follow the instructions provided with the product. This warranty becomes void if attempts at repair are made by non-authorized third parties and/or if spare parts, other than those provided by Vida by PADERNO, are used.

There are no other express warranties except as set forth herein and any applicable implied warranties of merchantability and fitness (or those provided for by law) are limited in duration to the period of coverage of this express written limited warranty.

CONTACT:

For warranty inquiries or if you have any questions, please contact us at:
1-800-263-9768

TRILEAF DISTRIBUTION TRIFEUIL,
2180 Yonge Street, Toronto, ON, Canada, M4S 2B8

A receipt indicating the purchase date is required for any claims, so please keep it in a safe place.