

PADERNO^{TM/MC}

User Manual **12-CUP PROGRAMMABLE COFFEE MAKER**

Model No. HH1007280

Product No. 043-0186-6



Product No. 043-0186-6

The PADERNO™ 12-Cup Programmable Coffee Maker is specially designed for brewing large pots of delicious coffee conveniently.

Enjoy fast, freshly brewed coffee, customized to your personal taste.

The removable water reservoir can be easily filled using your kitchen tap.

Select “Regular” or “Bold” brew strength to adjust the taste to your personal preference. Then use the Keep Warm setting to maintain the coffee at the perfect temperature ready for you to enjoy.

Table of Contents

IMPORTANT SAFETY INSTRUCTIONS	4
Technical Information	6
Using Your Coffee Maker	8
Cleaning and Maintenance	12
Our Guarantee	14

IMPORTANT SAFETY INSTRUCTIONS

When using electrical appliances, basic safety precautions should always be followed including the following:

IMPORTANT SAFEGUARDS

1. Please read the instructions carefully before using any appliance.

2. Always ensure that the voltage on the rating label corresponds to the mains voltage in your home.

3. To protect against fire, electric shock and injury to persons, do not immerse cord, plug, or appliance in water or other liquid.

4. Close supervision is necessary when any appliance is used by or near children.

5. Unplug from outlet when either the appliance or display clock is not in use and before cleaning. Allow the appliance to cool before attaching or removing parts, and before cleaning the appliance.

6. Do not operate any appliance with a damaged cord or plug or after the appliance malfunctions or has been damaged in any manner. The appliance should not be repaired or opened by an unlicensed person. Refer to the “Our Guarantee” section regarding the product’s warranty before returning the appliance to the point of purchase.

7. The use of accessories not recommended by the appliance manufacturer may result in fire, electric shock or injury to persons.

8. Do not use outdoors.
9. Do not let the cord hang over edge of table or counter or touch hot surface.

10. Do not place on or near a hot gas or electric burner or in a heated oven.

11. Do not use the appliance for other than its intended use.

12. To disconnect, turn off the appliance and remove plug from the power outlet. Always hold the plug when removing from the outlet. Never pull the cord.

13. The carafe is designed for use with this appliance. It must never be used on a stovetop.

14. Do not place a hot carafe on a wet or cold surface.

15. Do not use a cracked carafe or a carafe having a loose or weakened handle.

16. Do not clean carafe with cleansers, steel wool pads, or other abrasive material.

17. Scalding may occur if the cover is removed during the brewing cycles. Be careful not to get burned by the steam.

18. Some parts of appliance are hot when operated, so do not touch parts with hand. Use handles or knobs only.

CAN ICES-003(B)/NMB-003(B)

19. Children must be supervised to ensure that they do not play with the appliance.
20. Do not let the coffee maker operate without water.
21. To reduce risk of fire or electric shock, do not open. There are no user-serviceable parts inside. The appliance should not be repaired or opened by an unlicensed person.

FOR HOUSEHOLD USE ONLY SAVE THESE INSTRUCTIONS



WARNING: Any change or modifications to this unit not expressly approved by the party responsible for compliance could void the user's authority to operate equipment.

NOTE: This equipment has been tested and found to comply with the limits for a Class B digital device, pursuant to part 15 of the FCC Rules. These limits are designed to provide reasonable protection against harmful interference in a residential installation. This equipment generates, uses and can radiate radio frequency energy and, if not installed and used in accordance with the instructions, may cause harmful interference to radio communications. However, there is no guarantee that interference will not occur in a particular installation. If this equipment does cause harmful interference to radio or television reception, which can be determined by turning the equipment off and on, the user is encouraged to try to correct the interference by one or more of the following measures:

- Reorient or relocate the receiving antenna.
- Increase the separation between the equipment and receiver.
- Connect the equipment to an outlet on a circuit different from that which the receiver is connected.
- Consult the dealer or an experienced radio/TV technician for help.

Technical Information

Polarized plug

This appliance has a polarized plug (one blade is wider than the other). To reduce the risk of electric shock, this plug is intended to fit into a polarized outlet only one way. If the plug does not fit fully into the outlet, reverse the plug. If it still does not fit, contact a qualified electrician. DO NOT modify the plug in any way.

Notes on the Power Cord

A short power-supply cord (or detached power-supply cord) is provided to reduce risks resulting from becoming entangled in or tripping over a long cord. Longer detachable power-supply cords or extension cords are available and may be used if care is exercised in their use.

If a long detachable power-supply cord or extension cord is used:

- The marked electrical rating of the detachable power-supply cord or extension cord should be at least as great as the electrical rating of the appliance.
- If the appliance is of the grounded type, the extension cord should be a grounding-type 3-wire cord.
- The longer cord should be arranged so that it will not drape over the countertop or tabletop where it can be pulled on by children or tripped over.

Coffee Maker Parts

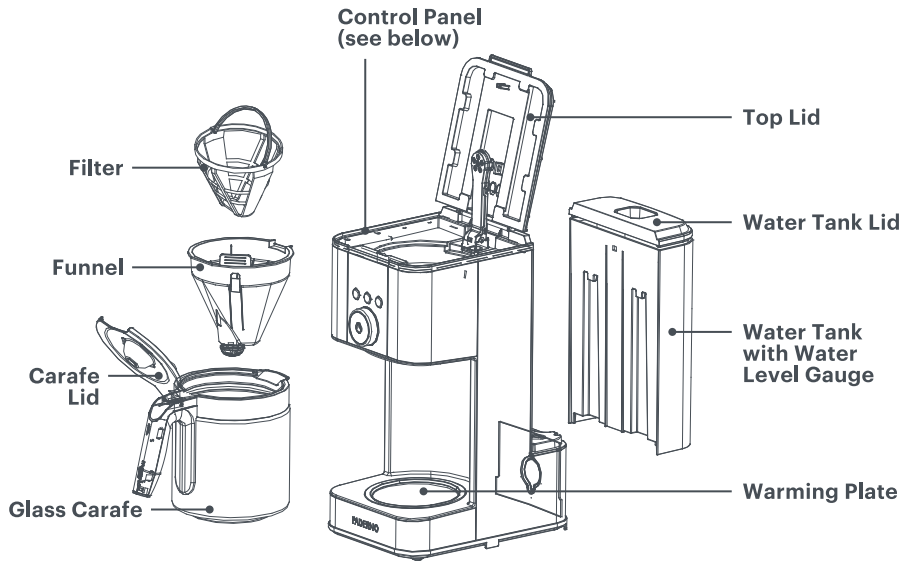

Control Panel

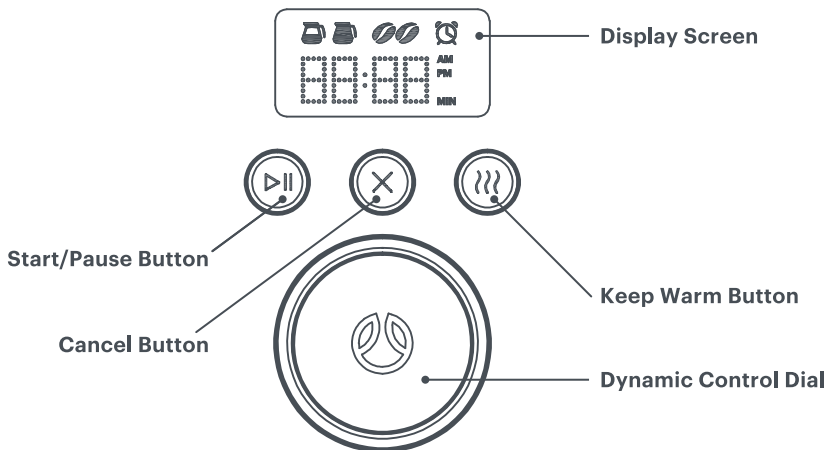

Using Your Coffee Maker

Before First Use

1. Check that all accessories are complete and the unit is not damaged.
2. Add water into water tank to the “MAX” level and brew water several times without coffee grounds to remove any residue left from the manufacturing process.
3. Discard water.
4. Clean all detachable parts thoroughly with warm water.

Initial Set Up

1. Plug the power cord into the outlet. The display screen will briefly display all the icons.
2. Click and hold the dial for 2 seconds to enter into the Clock Setting mode. Rotate the dial to adjust the Hour. To increase the Hour, rotate the dial clockwise; to decrease the Hour, rotate the dial counter-clockwise. After setting the Hour, click the dial to confirm. Note: The time cycle is 12 hours.
3. Rotate the dial to adjust Minutes using the same process as previous step. Click dial to confirm, as shown in Fig. 1.

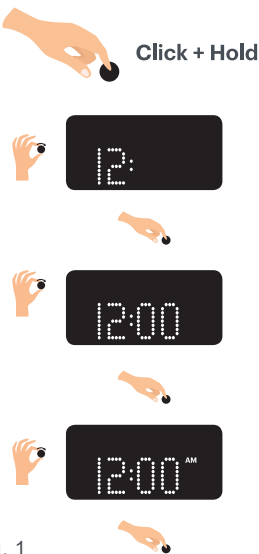

Fig. 1

4. To enter Brew Setting mode, click dial.
5. When setting Brew Size, carafe icons will blink. Rotate dial to choose between Small Brew or Full Brew. Click dial to confirm selection, as shown in Fig. 2.



Fig. 2

Note: The brew size setting heats and adjusts the flow of water and temperature for a consistent brew strength. Be sure to fill the reservoir with the appropriate amount of water based on the brew size selected.



6. When setting Brew Strength, coffee bean icons will blink. Rotate dial to choose between Regular brew strength  or Bold brew strength . Click dial to confirm selection, as shown in Fig. 3.



Fig. 3

7. When setting timer to delay brewing, alarm clock icon will blink. Rotate dial to choose between setting a timer, or not setting a timer. Click dial to confirm selection.
- If setting a timer is selected, the Hour on the clock will blink. Rotate dial to set hour. Click dial to confirm selection.
 - The Minutes on the clock will blink after hour selection. Rotate dial to set minutes. Click dial to confirm selection.
 - Press Start/Pause to finish setting timer. Set time will appear on screen for 2 seconds and Start/Pause will remain lit to indicate that brew cycle will start at set time.
 - When brewing is completed, coffee machine will enter Keep Warm mode for 2 hours.

NOTE: To begin brewing immediately, select Start/Pause again.

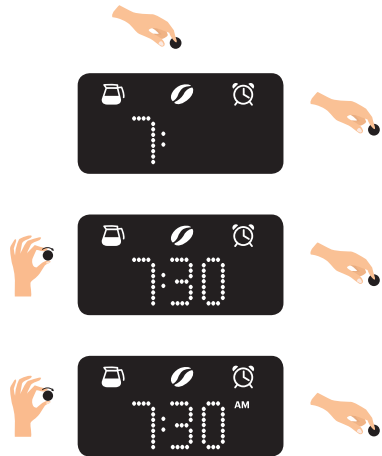

Fig. 4

NOTE: Sleep mode is activated if no action is taken for 2 minutes at any stage. The dial turns off and only the clock will show on the display screen. To wake the coffee maker, user can either click/rotate the dial once or press any button. The dial will become illuminated. The display screen will then return to the settings it was set at before going into sleep mode.

Operating Instructions

1. Open the top lid and fill the water tank with cold drinking water. The water level should not exceed MAX level as indicated on the water level gauge.
2. Place the funnel into the funnel support and ensure the funnel is positioned correctly. Then place the permanent filter or filter paper in the funnel, and ensure it is positioned correctly.
3. Add proper coffee grounds into permanent filter or filter paper. Usually a cup of coffee needs a level spoon of coffee grounds, but you may adjust according to your personal taste.
4. Insert the glass carafe on the warming plate horizontally.
5. To reset brewing preferences, click dial to enter Brew Settings mode.
6. To begin brewing immediately, press Start/Pause button. The Start/Pause and Cancel buttons will become illuminated. The display screen will show time counting up during brewing process.
NOTE: Glass carafe can be removed at any time during brewing cycle. The appliance will stop dripping automatically. The carafe should be put back into position on the warming plate within 30 seconds.
7. Press Start/Pause to temporarily stop brewing cycle. Press Start/Pause again to resume process.
8. When brewing cycle is complete, the coffee maker will beep. The coffee maker will go into Keep Warm mode, and the Keep Warm button will become illuminated. The display screen will show time counting up to indicate time elapsed in Keep Warm mode. After 2 hours, the machine will beep and the Keep Warm button will turn off.
NOTE: Keep Warm can only be used when Brew Size setting is set to Full Brew.
NOTE: To deactivate Keep Warm mode, press the button again. If the button is pressed after the 2 hours are done, Keep Warm mode will activate again.
9. Remove the glass carafe to serve when finished brewing (remove about one minute after the coffee stops dripping).
NOTE: The coffee you get will be less than the water you have added, as some water is absorbed by the coffee grounds.
10. Always turn the coffee maker off and disconnect power supply when not in use.
NOTE: Pay attention when pouring the coffee to avoid spilling coffee. Coffee will be hot and may cause injury.

Tips for Great-tasting Coffee

- A clean coffee maker is essential for making great-tasting coffee. Regularly clean the coffee maker as specified in the “Cleaning and Maintenance” section of this user manual. Always use fresh, cold water in the coffee maker.
- Store unused coffee grounds in a cool, dry place. After opening a package of coffee grounds, reseal it tightly and store it in a refrigerator to maintain its freshness.
- For an optimum coffee taste, buy whole coffee beans and finely grind them just before brewing.
- Do not reuse coffee grounds since this will greatly reduce the coffee’s flavour. Reheating coffee is not recommended as coffee is at its peak flavour immediately after brewing.
- Clean the coffee maker when over-extraction causes oiliness. Small oil droplets on the surface of brewed, black coffee are due to the extraction of oil from the coffee grinds.
- Oiliness may occur more frequently if heavily roasted coffees are used.

Cleaning and Maintenance

Cleaning

CAUTION: Be sure to unplug this appliance and allow it to cool down before cleaning. To protect against electrical shock, do not immerse cord, plug or unit in water or liquid. After each use, always make sure plug is first removed from wall outlet.

1. Clean all detachable parts after each use with hot water and soap.
2. Wipe the appliance's exterior surface with a soft, damp cloth to remove stains.
3. Water droplets may build up in the area above the funnel and drip onto the appliance base during brewing. To control the dripping, wipe off the area with a clean, dry cloth after each use.
4. Never use abrasive cleaners to clean any part of the coffee maker.
5. Replace all parts and keep for next use.

Removing Mineral Deposits

To keep your coffee maker operating efficiently, you should clean the mineral deposits left by the water.

Follow these directions:

1. Fill the water tank with water and descaler to the MAX level at a ratio of 4:1. Use "household descaler", and refer to the instructions on package of the descaler. You can also use citric acid instead of descaler.
2. Put the glass carafe on the warming plate. Ensure that the centre line of glass carafe aligns with that of funnel.
3. Press the Start/Pause button once. After a while, water will drip out automatically.
4. After brewing the equivalent of one cup, switch off the appliance by pressing the Start/Pause button once again.
5. Leave the solution to work for 15 minutes.
6. Repeat steps 3 – 5. Brew the remaining solution until the water tank is completely empty.
7. To remove solution, brew with water only (no coffee grounds) at least 3 times.

Disposal of Appliance

DO NOT dispose of this product in household waste. Many parts of this product are recyclable. Dispose of as per the requirements of your local municipality.

Product No. 043-0186-6

Our Guarantee

If you experience any issues with your PADERNO™ 12-Cup Programmable Coffee Maker, please refer to the warranty terms below to determine the corrective course of action.

2-Year Limited Warranty

Padinox Inc. ("PADERNO") has been fuelling your passion for cooking since 1979. This iconic Canadian brand gives you outstanding durability and performance, so you can concentrate on the important things like what to make next.

That's why we stand by all our products! Starting from the date of purchase, PADERNO warrants that your Kitchen Appliance is free from any manufacturing defects in materials or workmanship for a period of 2 years.

This warranty is only offered on PADERNO appliances sold and used in Canada. The PADERNO warranty covers all costs related to restoring the proven defective product through the repair or replacement of any defective part and necessary labour so that it conforms to its original specifications. A replacement product may be provided instead of repairing a defective product at the discretion of PADERNO.

The PADERNO warranty does not apply to appliances that have been used commercially or in non-household applications. The warranty does not cover damages resulting from misuse or abuse of the product and/or uses inconsistent with this Use and Care manual, attempts at repair, theft, use with unauthorized attachments, or failure to follow the instructions provided with the product. This warranty becomes void if attempts at repair are made by non-authorized third parties and/or if spare parts, other than those provided by PADERNO, are used. You may also arrange

for service after the warranty expires at an additional cost. **There are no other express warranties except as set forth herein and any applicable implied warranties of merchantability and fitness (or those provided for by law) are limited in duration to the period of coverage of this express written limited warranty.**

CONTACT:

If you have any trouble with the product during the warranty period, please visit us online at **www.Paderno.com** or contact us at: **1-800-263-9768** or via email **customer.service@padinox.ca**

Padinox Inc. Toronto Canada M4P 2V8

A receipt indicating the purchase date is required for any claims, so please keep it in a safe place.

1-800-263-9768 paderno.com



Cook. For life.

Valued by professional chefs and passionate home cooks alike, PADERNO™ offers an exceptional level of durability and performance guaranteed.

Connect with us at paderno.com to learn more.

For questions and concerns, please contact:
Customer.service@padinox.ca
1-800-263-9768