

Care and Maintenance

1. If the Mini Can Opener slows during cutting, this may indicate low battery level and the batteries should be replaced. If the Mini Can Opener stops during operation, see "Trouble Shooting" below.

2. To clean the cutter, open up the Battery Door, then remove the Front Cap (Fig.10). Wipe the cutter with a damp cloth or a sponge, using a mild non-abrasive cleaner, followed with a clean, dry cloth to dry it completely. Replace the Front Cap and the Battery Door after the cleaning.

NOTE: The Front Cap cannot be removed without lifting up the Battery Door as they are interlocked. This also means that the battery door cannot be closed unless the Front Cap is fully closed first. This is a safety feature.

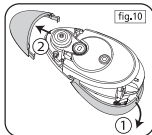

Trouble Shooting

1. If the Mini Can Opener is jammed due to low battery level or a deformed can rim, press and hold the Reverse Switch at the rear of the Mini Can Opener. The Mini Can Opener will move in the reverse direction and release the can. Keep the Reverse Switch depressed until the Mini Can Opener stops (see fig.11).

2. If batteries are depleted the Mini Can Opener may not be released by pressing the Reverse Switch. In this case, replace with a new set of batteries. The Mini Can Opener will automatically start again when the Battery Door is closed again.

3. Cans with heavy seams, odd shapes, or uneven rims may stall the Mini Can Opener. If this happens, follow above procedure to release the can. Start the cutting action just beyond any minor bump or dent in a can.

NOTE:

The Mini Can Opener will not open rimless cans or cans with odd corners.

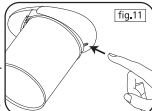

Technical Specifications

Operate voltage: DC2.4-3V

Battery: 2 x AA alkaline or rechargeable batteries

Can cutting size: diameter 52 mm-153 mm (2" -6")

Maximum can cutting size in one cycle: diameter 98 mm (3.85")(preferred)

Disposal

The packaging material can be recycled. Please dispose of it in an Environmentally friendly manner and take it to a recycling centre.



If you wish to dispose of this equipment at any point, please do so in an environmentally friendly manner. It should not be disposed of alongside general household waste. Instead, please take it to recycling point for electrical goods. Your local authority will be able to advise you further.

Batteries should not be thrown away in household waste. Please ensure that you always dispose of batteries and rechargeable batteries only when they are empty. Your local authority will be able to advise you further.

LIMITED WARRANTY: Springfield Instruments warrants this product to be free from defects in workmanship and material for a period of one year from date of purchase, and will repair or replace at our option without charge. This warranty does not cover damage through accident or misuse. For information, call 1-844-687-4040.

© 2008 Daka Research Inc. All rights reserved.
www.onetouchproducts.com

Patented and Patent Pending
Printed in China

Rev.240708

Distributed by:
Springfield Instruments
104 Barr Street
Ville St-Laurent, Quebec
H4T 1Y4
1-844-687-4040

ONE TOUCH™

www.ONETOUCHPRODUCTS.com

AUTOMATIC Mini Can Opener (The Special Edition)



USER MANUAL

Model no.: KC26

CAUTION

- Read all instructions carefully before using your Mini Can Opener.
- Close supervision is necessary when your Mini Can Opener is used by or near children.
- **DO NOT** open pressurized (aerosol-type) cans.
- **DO NOT** open cans of flammable liquids such as lighter fluids.
- Make sure the motor has stopped completely before lifting up the Battery Door for battery replacement.
- Avoid contact with moving parts. Keep hands, hair, jewelry, clothing etc away from moving parts during operation to prevent injury, and/or damage to the Mini Can Opener.
- To maintain your Mini Can Opener at its optimal condition, **DO NOT** immerse it in water or any other liquids.
- **DO NOT** try to adjust or remove the cutter screw.
- **NOT** suitable for dish washer.

SAVE THESE INSTRUCTIONS

This Mini Can Opener is intended for household use only. Read the following instructions before using for the first time.

Parts and Functions

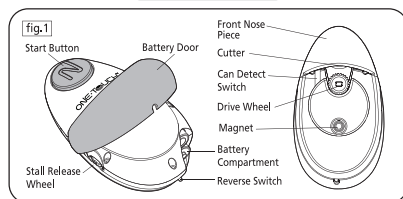

Getting Started

BATTERY INSTALLATION

1. Hold top of unit with left hand, thumb on top, fingers on the bottom and using the right hand, place thumb and index fingers on indentations of rubber grip (see fig.2).

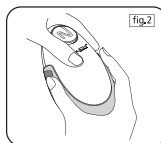

2. Squeeze with thumb and index finger and pull backward in one strong, sharp movement (see fig.3).

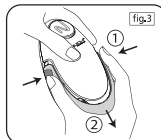

3. Rotate rubber grip upward to access battery compartment (see fig.4).

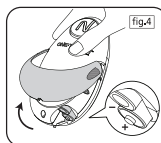

4. Lower the rubber grip and push back into original position (see fig.5).

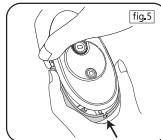

If front nose piece pops out, simply push it back into place.

USING THE "ONE TOUCH" Mini Can Opener

1. Place your Mini Can Opener on top of the can with its rim positioned in the groove at the bottom of the Mini Can Opener (see fig.6).

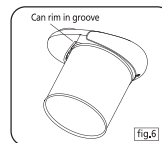

NOTE: The cutter will not operate unless it is positioned correctly on the rim of the can. To open the cans with tab, turn them upside-down, so that the Mini Can Opener can work on the lid without tab.

2. With the can on a flat surface, press the Start button for about one second and release it once the Mini Can Opener starts to cut the can (see fig.7). After cutting, the Mini Can Opener will stop automatically. (see fig.8)

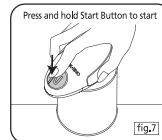

Press button one for standard cans. Press button again to resume cutting on larger cans up to 15.3cm in diameter.

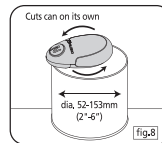

NOTE: The maximum can size that can be fully cut in one cycle is 98 mm (3.85") diameter. If you need to completely remove the lid of a bigger can, press the Start Button again and the Mini Can Opener will resume cutting and stop automatically after cutting. The can cutting size of Can Opener II is from 52 mm (2") to 153 mm (6").

3. When the cutting is completed, lift the Mini Can Opener off the can. A magnet on the Mini Can Opener will pick up the lid for your convenience (see fig.9).

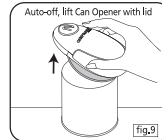

NOTE: There is functional sharp edge on the round cutter, and should be treated with care.