

## What's in the Box:

### Talon

- Talon deck with three vacuum mounts attached
- (1) HUSKE Fork Mount Body
- (2) 1.25x1/4-20 hex head bolts
- (2) 1/4-20 nylon insert lock nuts
- (2) flat washers
- (1) Rear Wheel Strap
- (1) Crank Arm Strap
- (1) spare vacuum pump
- 5g Lube Tube
- 7/16 box wrench
- 5/32 Allen wrench

**Talon**  
1-Bike Rack BT1004

**Mini Bomber**  
2-Bike Rack BM2006

**Bomber**  
3 Bike Rack BB3008

### Mini Bomber

- Mini Bomber deck with four vacuum mounts attached
- (2) HUSKE Fork Mount Bodies
- (4) 1.5x1/4-20 hex head bolts
- (4) 1/4-20 nylon insert lock nuts
- (4) flat washers
- (2) Rear Wheel Straps
- (2) Crank Arm Straps
- (1) spare vacuum pump
- 5g Lube Tube
- 7/16 box wrench
- 5/32 Allen wrench

### Bomber

- Bomber deck with five vacuum mounts attached
- (3) HUSKE Fork Mount Bodies
- (1) 3/4" Riser Block
- (4) 1.5x1/4-20 hex head bolts
- (2) 2.25x1/4-20 hex head bolts
- (6) 1/4-20 nylon insert lock nuts
- (6) flat washers
- (3) Rear Wheel Straps
- (3) Crank Arm Straps
- (1) spare vacuum pump
- 5g Lube Tube
- 7/16 box wrench
- 5/32 Allen wrench

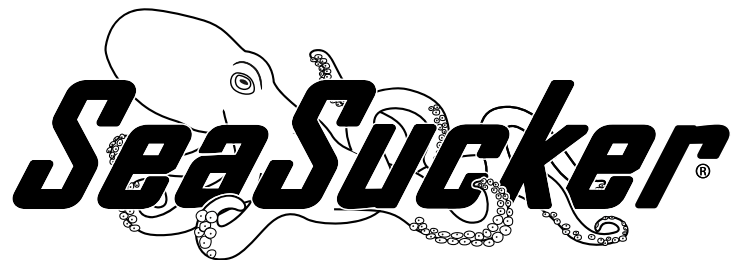

Designed and manufactured by:

**SeaSucker, LLC**

**Bradenton, Florida**

**[www.SeaSucker.com](http://www.SeaSucker.com)**



### Assembly

Place the HUSKE Fork Mount Body over the mounting holes in the rack deck and push the two mounting bolts through the fork mount and the deck. Place a flat washer over the end of each bolt and then thread a nylon insert lock nut onto the end of the bolt. Using the supplied wrenches, tighten the nuts until secure - the fork mount should be held firmly in place and should not rock or move when pressure is applied.

NOTE - The multiple mounting holes on the Mini Bomber and Bomber decks allow some flexibility in positioning the fork mounts. The angle of the fork mounts can be changed to prevent wider handle bars from touching.

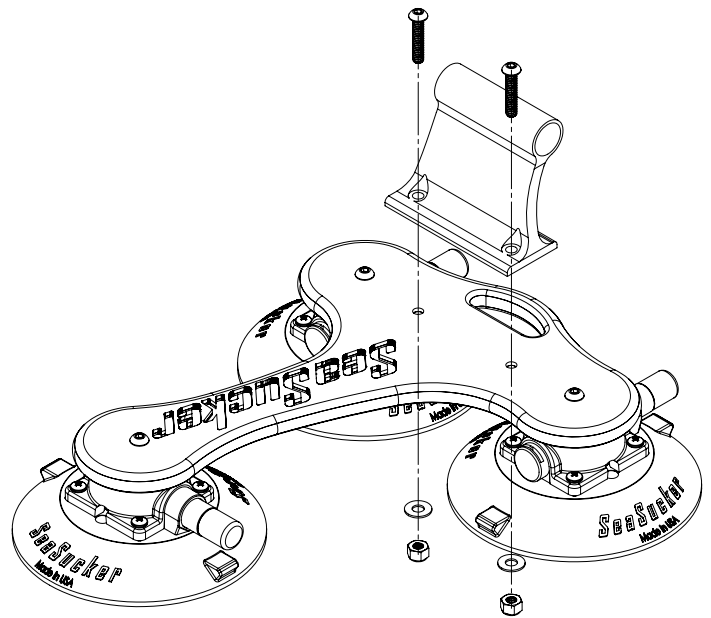

### Special Instructions for the Bomber

Bomber racks are assembled in the same way as Mini Bomber racks except that Bomber racks come with a Riser Block that should be installed under the center fork mount. The Riser Block raises the height of the handlebars on the bike in the middle position to provide additional clearance for wider handlebars.

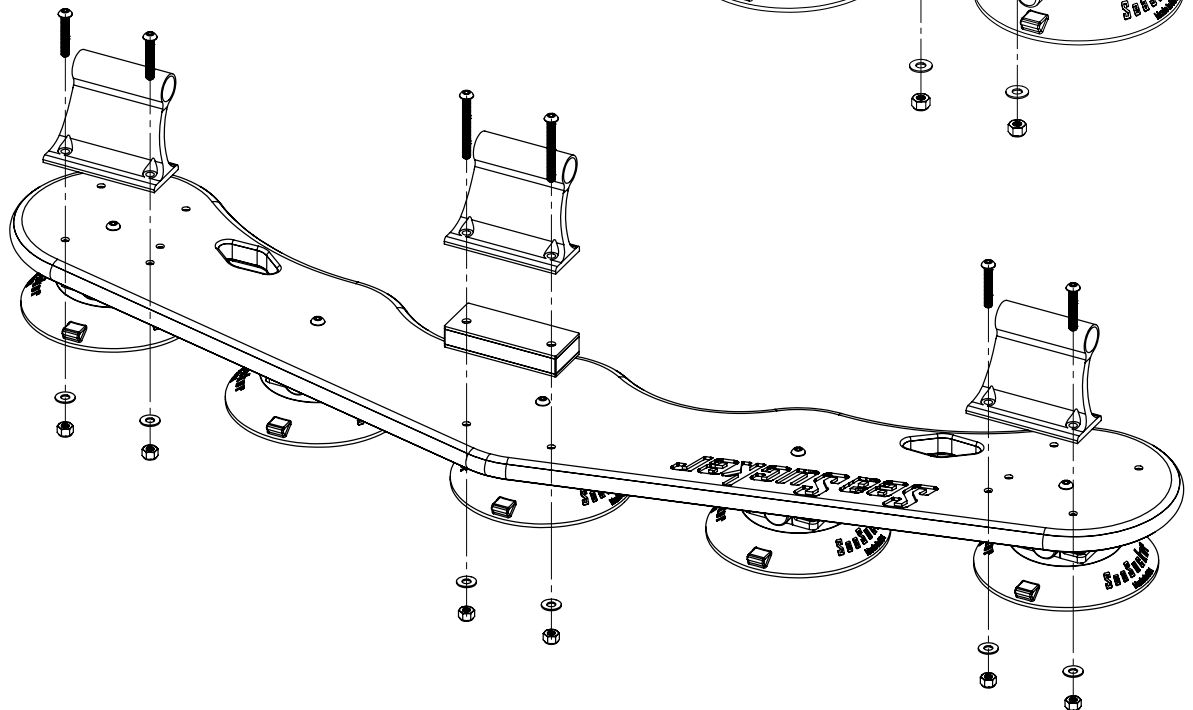
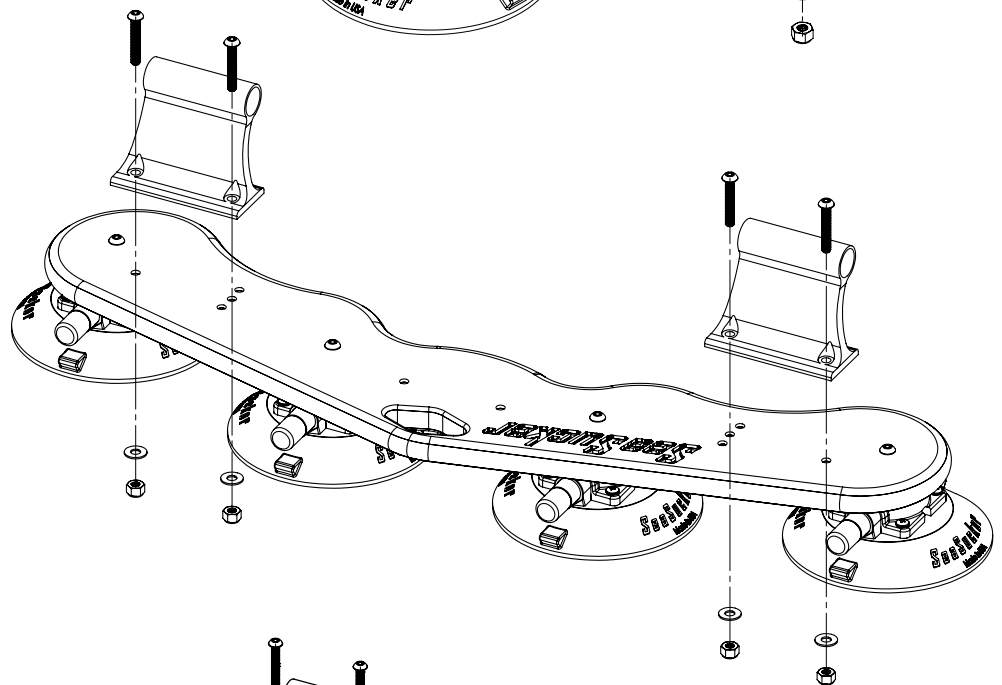

### Inserting and Removing Plugs

The HUSKE fork mount uses plugs to adapt to different hub sizes. Acquire the plugs you need for your bike's hub and press them into the HUSKE base. Make sure the plugs are seated completely in the base by simultaneously pressing them in and turning them. The rubber O-ring on the plugs will keep them in place. A small drop of Lube Tube (which came with your SeaSucker bike rack) or chain oil will help the plugs slide in and out more smoothly.

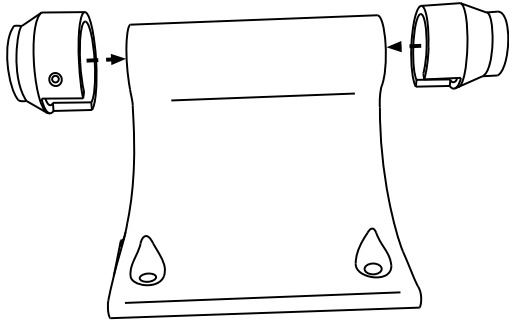
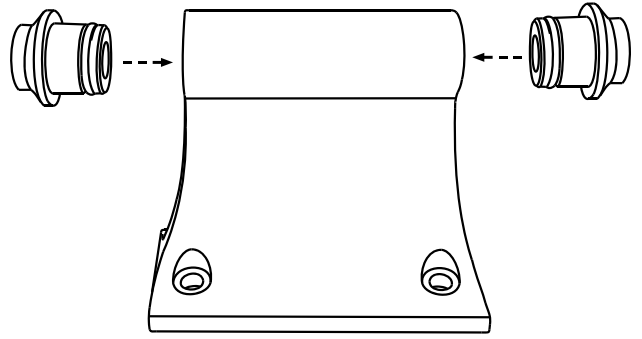

20x100mm and 20x110mm plugs fit *over* the HUSKE base rather than in. Slide the plugs over the top tube, matching the slots to the sides of the base. Once fully seated, tighten the set screw on each plug with a 2mm Allen wrench.

If you are using the 9x100m QR Plugs, insert the skewer through the plugs after installing the plugs. **Note that the wider side of the QR washer should always be touching the cam lever.** Screw the adjustment nut onto the skewer. See below for instructions on how to adjust it to fit your bike. The skewer can be placed through the plugs from either side.

**Plugs for different hub sizes can be purchased on-line at [www.SeaSucker.com](http://www.SeaSucker.com).**

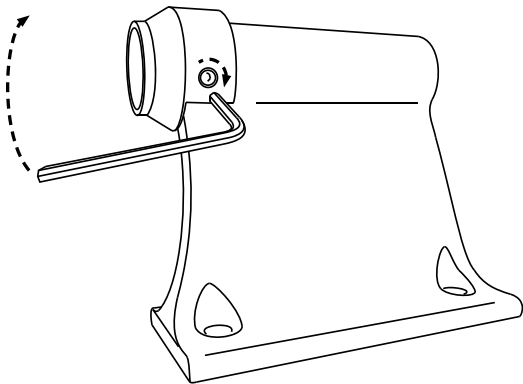

### Mounting Your Bike on a HUSKE Thru-Axle Fork Mount

1. Remove the front wheel from your bicycle.
2. Place your bike's forks on the HUSKE, lining up the axle holes on the fork and the fork mount.
3. Push your wheel's axle through the holes, entering through the un-threaded fork and ending at the threaded fork. Turn it to screw into the opposite side of the fork and close the lever. Installing your axle should be the same as when you reattach your front wheel. Consult your wheel or hub maker's instructions for more information.

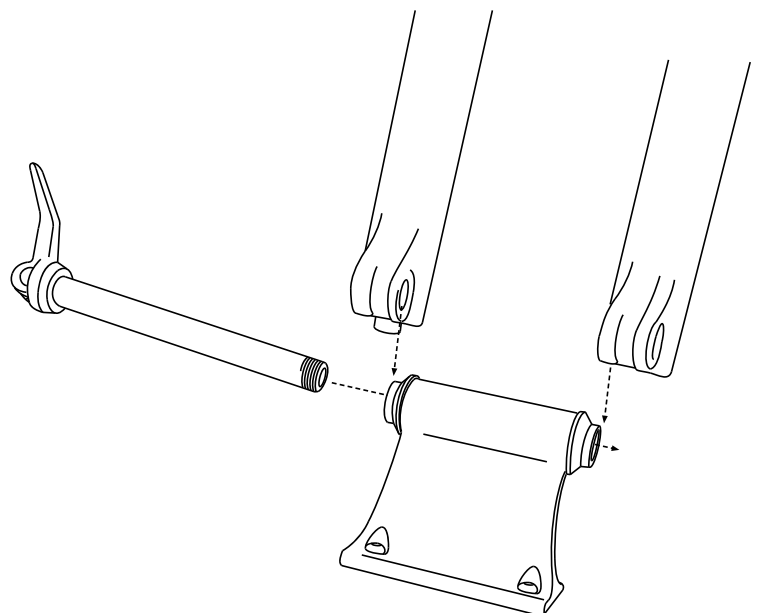

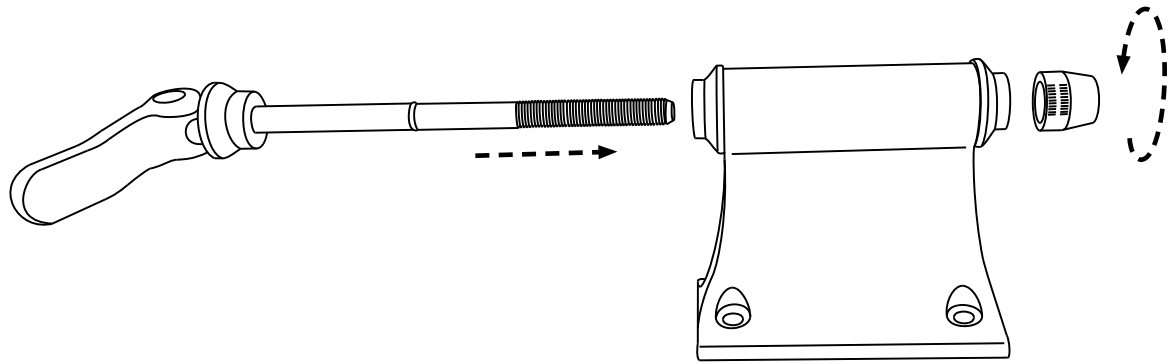

### Mounting Your Bike on a HUSKE QR Fork Mount

It is easier to set the tightness of the HUSKE QR fork mount for the first time before mounting your rack to your vehicle.

1. Place your SeaSucker rack on the floor. Leave the protective covers on the vacuum pads to avoid accidental damage to the pads.

2. Open the fork mount's quick release: place the cam lever in the open position and turn the adjustment nut counterclockwise to loosen it until it is almost at the end of the skewer.

3. Remove the front wheel from your bicycle.

4. Place your bicycle's fork dropouts onto the skewer. Make sure the wide side of the QR washer is next to the cam lever. If your bicycle won't balance on its own, have a helper hold on to it.

5. Push the skewer as far through the body of the fork mount as possible by pressing the cam lever towards your fork (while still in the open position). **IMPORTANT:** the cam lever, QR washer and the leg of your fork should be pressed tightly together against the body of the fork mount with no gaps in between them. Strike the cam lever with the heel of your palm if necessary to ensure full penetration. Then turn the adjustment nut clockwise until it is finger-tight against the other side of the fork.

6. Unscrew the adjustment nut six full turns. It is helpful to mark the nut in some way to keep track of the position and number of turns.

7. Flip the cam lever into the closed position. The cam lever should swing approximately 180 degrees. You should feel the cam lever starting to tighten just past 90 degrees of swing. It should take firm pressure to fully close the cam lever, but not so much pressure that it won't close fully. **If you are not closing it 180 degrees, or the cam lever or forks feel loose, you are doing it wrong! Go back to step 5 and try again.**

The 9mm QR fork mount has a large cam, which means that you probably won't have to loosen or tighten the adjustment nut every time you mount or remove your bicycle from the rack.

**Test the tightness of the fork mount by gripping your fork and firmly pulling and pushing. If the fork moves in the mount in any way, you should adjust the adjustment nut and re-clamp your fork to tighten the fork mount. If the HUSKE base moves on the rack, re-tighten the nuts on the underside of the rack.**

### Using the Crank Arm Strap

Wrap the orange Velcro® strap around one of your crank arms and chain stays to prevent your pedals from coming into contact with the roof of your car.

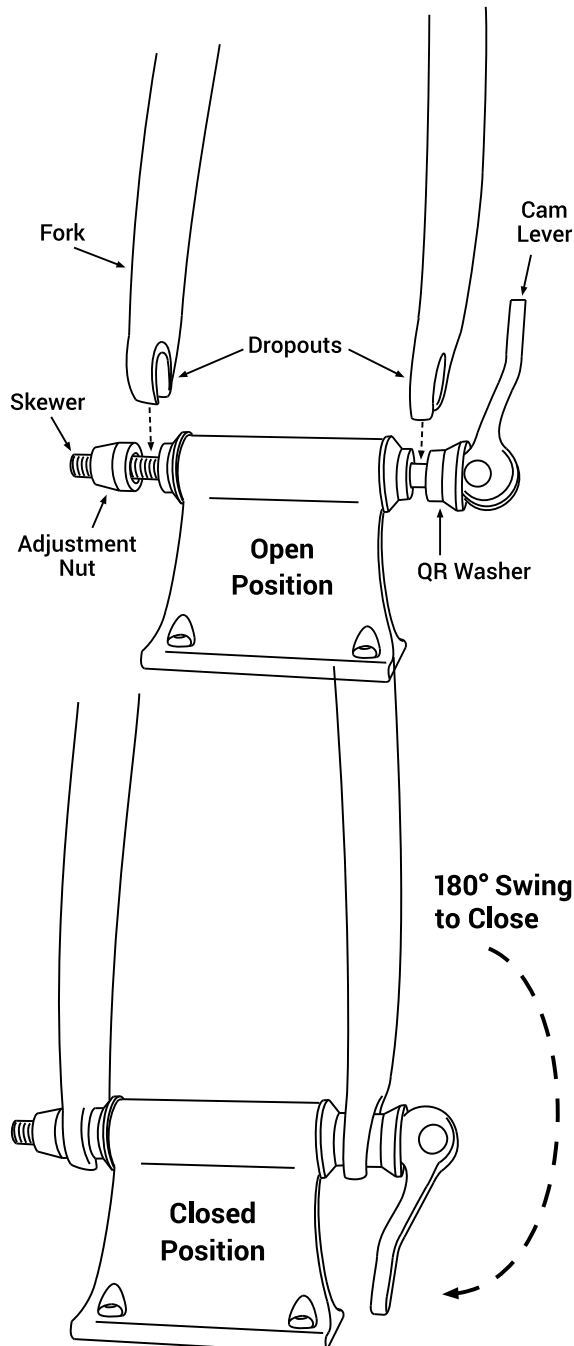

### Using the Rear Wheel Strap

Talon, Mini Bomber and Bomber racks come with a Rear Wheel Strap. The Rear Wheel Strap holds your bike's rear wheel in place when using a SeaSucker rack. Place the Rear Wheel Strap under your bike's rear tire after you mount the bike in your rack. Attach the SeaSucker as described below (Attaching Your Rack), then firmly pull one side of the Velcro® strap through your spokes and over the rim and then smooth the second Velcro® strap over the first. The strap may allow the rear wheel to move slightly even when properly attached.

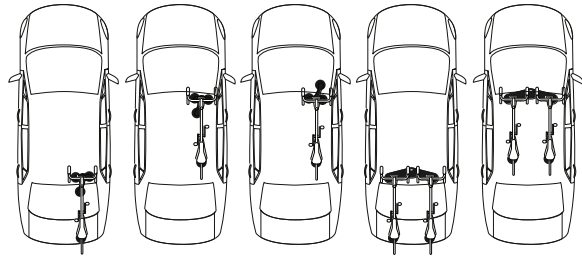

### Suggested Mounting Locations

The Talon, Mini Bomber, and Bomber racks are designed to attach to a car's roof top or the back glass of a hatchback, van, or SUV.

- **DO NOT** mount bicycles backwards, sideways, or at an angle.
- **DO NOT** let your bike's rear wheel hang lower than the bottom of your car's bumper when mounting your rack to the rear window of a hatchback, van, or SUV.
- **DO NOT** position your bike so that the rear wheel is directly behind your car's exhaust pipe when mounting your rack to the rear window of a hatchback, van, or SUV.
- **DO NOT** attach your rack over decals or on a wrapped vehicle.



**Each vacuum mount on your rack should attach to a clean, unobstructed metal, glass, fiberglass, or carbon fiber surface. The vacuum mounts will not attach over a seam or other surface incongruity.**

Do not attach your rack to a part of your car that flexes easily. Position the rack near the front or back windshield where the roof has more internal support. The metal in the middle of some car roofs may not be sturdy enough to support the weight of your bicycle and rack.



If you are attaching your rack to the rear window of your hatchback or SUV, try to position the rack so that you can attach your rear wheel strap in an appropriate place if you choose to use the Rear Wheel Strap. You are not required to use the Rear Wheel Strap when hanging your bicycle from the back glass. Try to position the rack so that it will not obstruct your view through the rear window.

If you are attaching a SeaSucker Rack to a Tesla Model 3, follow this link: <http://bit.ly/2QkqKMR>

### Attaching Your Rack: Clean and Pump

Clean the surface you're going to mount the rack to. Dust and dirt will affect your SeaSuckers' ability to create and hold vacuum. Remove the protective cover from each SeaSucker and inspect the rubber vacuum pad for damage or dirt. Do not use your rack if there is any visible damage to the vacuum pad. If the vacuum pad is dirty, clean it with a mild soap and water solution and a soft cloth or sponge.

It may help to moisten the bottom edge of each vacuum pad or the mounting surface with water - do not use cleaners, lubricants or other liquids. Press the vacuum mount against the mounting surface to make a full seal; you may need to press firmly down on the body of the rack to ensure that the vacuum pad is fully connecting with the mounting surface when pumping.

Pump the SeaSucker repeatedly until the plunger doesn't spring back and the indicator band is hidden inside the pump cylinder. Repeat this for all SeaSuckers on the rack. If the plunger won't stay seated in the pump cylinder or continues to extend out immediately after pumping, you may need to clean the mounting surface or the vacuum pad or pump, perform basic maintenance on the vacuum pad or pump, or move the rack to a more suitable mounting position. Do not use your rack without correcting the problem!

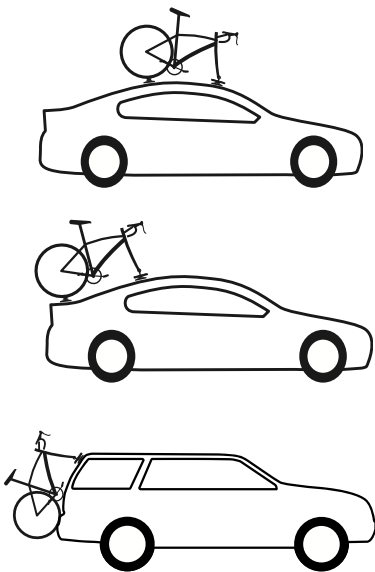

Most car roofs have a slight curve. When using the Mini Bomber or Bomber, we recommend that you first attach one of the vacuum mounts near the center of the rack and attach the other vacuum mounts in sequence moving toward the outer edge of the rack. The plastic body of the rack will bend to conform to the curve in your roof.

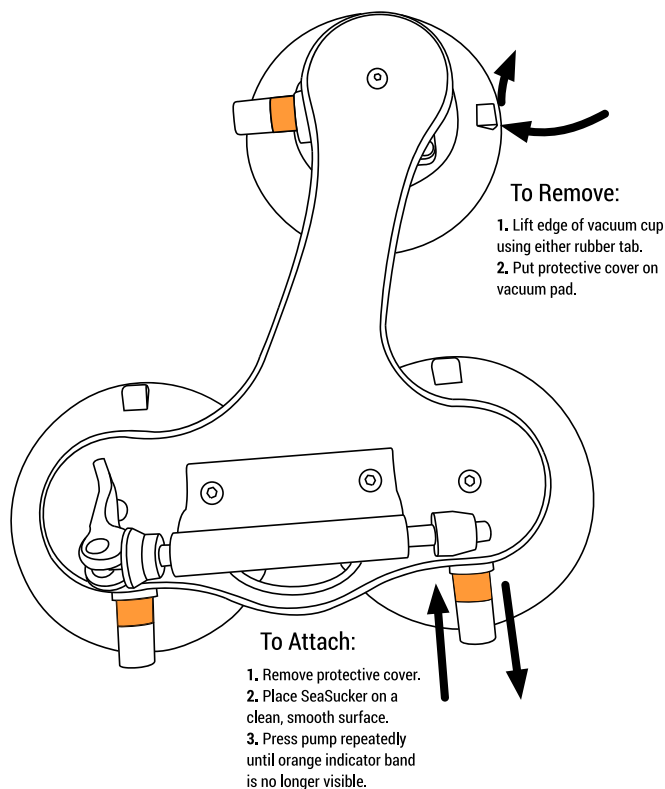

### Removing Your Rack: Lift and Cover

Remove your bike from the rack by unclamping the fork mount and opening the Velcro® on the Rear Wheel Strap. With your fingertip, use one of the tabs on the SeaSucker's vacuum pad to lift the edge of the pad up from the mounting surface and break the vacuum seal.

Always put the protective covers back on when the rack is not attached to your car to protect the vacuum pad's rubber. Make sure the pad is fully seated in the protective cover before storing it. The edge of the vacuum pad could be damaged or deformed if the vacuum pad isn't fully seated in the protective cover.

### Locking Your Bike and Rack

Because SeaSucker bike racks cannot be permanently attached to your car, you should exercise caution when leaving your bike or rack unattended. When not using your rack, we recommend that you remove and properly store the rack in your home or car. You can lock your bike and rack to your car using one of SeaSucker's Cable Anchors. Cable Anchors provide a sturdy steel attachment point for a cable-type lock.

### Check for the Indicator Band During Use

SeaSucker vacuum mounts are not intended to be permanent fixtures on your car - they will lose vacuum over time. When your vacuum mount loses vacuum, it will warn you by extending the pump's plunger, exposing an orange band. You are required to monitor your vacuum mounts during use. When getting in or out of your car, check to see if the indicator band is visible on any of the rack's vacuum mounts. If you see the band, simply pump the SeaSucker as described above.

If the indicator band appears less than four hours after being pumped to full strength, either cleaning, maintenance or repositioning may be required. If your rack is mounted on a scratched surface, move the rack to a more suitable position. If the mounting surface or vacuum mount is dirty, clean it. If these steps don't stop the vacuum mount from losing vacuum prematurely, discontinue use until the problem is resolved. Replace the pump on the suspect vacuum mount with the spare that came with your rack if necessary - additional replacement parts can be purchased in the Replacement Parts section of our on-line store.

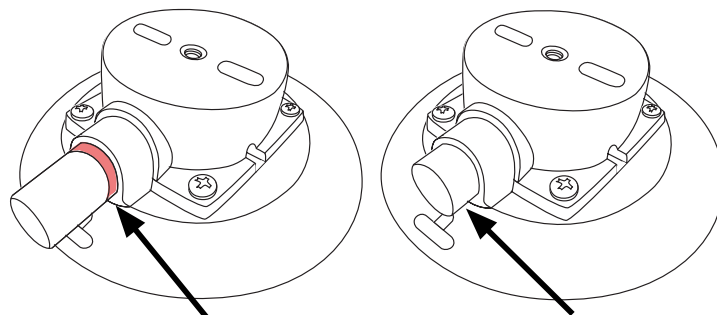

**Indicator band exposed:  
time to re-pump!**

**Full power!**

### Weather Conditions

SeaSucker products can be used in cold weather. The vacuum pads will stiffen in colder temperatures. Because the vacuum pads need to conform to the mounting surface when you attach them, it is highly recommended that you store your rack at room temperature (60°F+) prior to use. You will not be able to properly attach the vacuum mounts if they are too cold. Mounting surfaces must be free of ice, snow, dirt and any else that might prevent the vacuum pad from making a full seal. In freezing temperatures, we recommend not moistening the edge of your vacuum pads with water as discussed in "Attaching Your Rack" above.

Rain and wet weather should not affect the performance of your SeaSucker rack. If rain or water gets inside any of your vacuum pumps, pull the plunger out and dry the inside of the pump cylinder with a clean paper towel. Re-lube the plunger seal if necessary and reinsert the plunger in the pump cylinder. Screws or other metal parts that show signs of rusting or corrosion should be replaced.

### Care and Maintenance

To get the most out of your SeaSucker rack, inspect it regularly and store it with the vacuum mounts' protective covers on. Check that all screws are securely tightened, including the screws attaching the vacuum pads to the SeaSucker housing and the screws attaching the SeaSuckers to the rack deck.

Clean the vacuum pads before each use with a sponge or soft cloth, mild dish soap and water. Do not use harsh solvents or abrasive cleaning pads. Inspect the sealing edge for stiffness, cracks, roughness, or cuts. A damaged vacuum pad should be replaced.

The vacuum pump should be cleaned regularly. Pull the plunger straight out of the pump cylinder. Clean the inside of the cylinder with dish soap and a soft cloth or paper towel. Dry the inside of the cylinder – water left in the cylinder may interfere with the check-valve function of the pump.

The plunger should be wiped clean and the black rubber seal at the tip of the plunger should be re-lubed with a thin layer of silicone-based gel lubricant, such as the Lube Tube that came with your rack. After cleaning, push the plunger back into the cylinder and pump it several times to seat it properly and distribute the lubricant.

One replacement SeaSucker vacuum pump comes with your rack. Additional replacement SeaSuckers, vacuum pads, vacuum pumps, and additional tubes of Lube Tube can be purchased on-line at [www.seasucker.com](http://www.seasucker.com) in the Replacement Parts section of our on-line store.

**The Lube Tube supplied with your rack is for vacuum pump maintenance only -  
DO NOT apply lube to the vacuum pad.**

### Warranty

SeaSucker offers a lifetime, non-transferable warranty to the original purchaser covering defects in materials and workmanship. Defective products can be returned to SeaSucker for replacement or repair (at SeaSucker's option). Warranty claims must be accompanied by a sales receipt or other proof of purchase document. The cost of transportation to and from SeaSucker for the repair or replacement of any defective part or accessory is not covered by this warranty and is to be paid by the owner.

This warranty does not apply to damage or failure resulting from routine wear and tear expected in the normal use of this product, or to lack of maintenance, user error, alteration or modification of the product, accidents, misuse, abuse, or neglect.

This warranty is given in lieu of all other written or oral warranties, express or implied, including without limitation implied warranties of merchantability and fitness for a particular purpose, and are limited to the duration and specifications of this warranty.

Purchaser's exclusive remedy under this warranty is the repair or replacement of a defective product or, at SeaSucker's option, the issuance of a refund or credit for the purchase price of the product. SeaSucker's liability for any damages relating to any allegedly defective product, whether arising from the use or the inability to use the product and whether claimed under tort, contract or any other legal theory, shall be limited to the actual price paid for such product and shall in no event include loss of use, loss of time, incidental, consequential, special, or indirect damages of any kind, even if SeaSucker is aware of the possibility of such damages, to the full extent as such may be disclaimed by law.

It is the user's responsibility to ensure that the use of this product is not prohibited by any applicable local or state law.

Warranty claims can be initiated by:

Submitting this form: [https://seasucker.formstack.com/forms/rma\\_request](https://seasucker.formstack.com/forms/rma_request)

Calling this number: 1-941-900-1850

Emailing this address: [info@seasucker.com](mailto:info@seasucker.com)

### Repair and Replacement

Products with non-warrantable damage may still be repaired or replaced at your expense. Discounted replacement parts, including vacuum pads, pumps, fork mounts and hardware, can be found on-line in the Replacement Parts section of SeaSucker's on-line store at [www.seasucker.com](http://www.seasucker.com).

### Returns

If you purchased this product directly from SeaSucker and have not used it yet, you can return it for exchange or refund within 30 days of purchase. To request a Return Authorization for a return, exchange, or repair, visit [https://seasucker.formstack.com/forms/rma\\_request](https://seasucker.formstack.com/forms/rma_request).

### Patent Information

SeaSucker's Talon, Mini Bomber, and Bomber bike racks, among others, are covered by the following patents:

United States: 9,821,721 B2

European Patent Commission: 2480430

Australia: 2010298318

Mexico: 324704

Korea: 10-1860954

### IMPORTANT WARNINGS

- **Do not mount bicycles backwards, sideways or at an angle.**
- Do not exceed the posted speed limit.
- Do not use if the indicator band is exposed on any of your SeaSucker's pumps.
- Do not use if all of the rack's mounts cannot maintain a full vacuum seal for at least 4 hours.
- Clean the mounting surface before attaching.
- Clean SeaSuckers before attaching.
- Clean and lube your SeaSuckers' pumps regularly.
- Inspect screws, nuts, and bolts regularly and retighten if necessary.
- Do not use for bicycles over 45 pounds.
- Make sure the fork mount is fully clamped and secure before you transport your bicycle.
- Make sure the vacuum pads are fully seated in the protective covers when not in use.
- Do not attempt to park your car in a garage with a bicycle mounted on the roof without ensuring you have enough clearance.

### Your Responsibilities

You must read and follow the instructions in this user manual. You must attach the rack correctly to your vehicle, check it before each use, and perform any necessary maintenance. The correct attachment of the rack to your vehicle is critical and is in your exclusive control.

You must attach your bicycle(s) correctly to the rack and remove any loose parts from your bicycle, such as lights, pumps, water bottles, computers, baskets, and child seats. The correct attachment of bicycle(s) to your rack is critical and is in your exclusive control.

You must inspect the indicator bands on all SeaSuckers when entering and exiting your vehicle. A quick glance will tell you if the rack is at full power. If the indicator band is visible, you must re-pump the SeaSucker before the rack can be used.

You may need to clean, repair, or replace any of your SeaSucker vacuum mounts that do not hold vacuum for at least 4 hours. Your rack comes with an extra SeaSucker vacuum pump; keep it with your rack in case you accidentally damage one.

You must obey all posted speed limits and traffic conditions; if there is no posted speed limit, we recommend not driving above 85 miles per hour. You must adapt your driving style and speed to road conditions, weather conditions, and the load on your SeaSucker rack.

TROUBLESHOOTING GUIDE	Problem	What Might Be Wrong	How To Fix It
	Slow Leakage	Dry mounting surface or vacuum pad	Moisten the mounting surface or the vacuum pad
		Nicks or cuts on vacuum pad	Replace the vacuum pad
		Dirt in pump	Clean and re-lube the plunger and pump cylinder
		Dry pump	Re-lube the plunger seal
		Dirt on vacuum pad	Clean the vacuum pad
		Dirty or uneven mounting surface	Clean the mounting surface or move to a more suitable spot
	Severe Leakage	Nicks or cuts on vacuum pad	Replace the vacuum pad
		Damaged pump	Replace the vacuum pump
		Dirty or uneven mounting surface	Clean the mounting surface or move to a more suitable spot
	Jammed or Sluggish Pump	Dry pump	Re-lube the plunger seal
		Obstructed valve stem	Remove the obstruction; clean and re-lube the pump
		Dirt in pump	Clean and re-lube the plunger and pump cylinder