

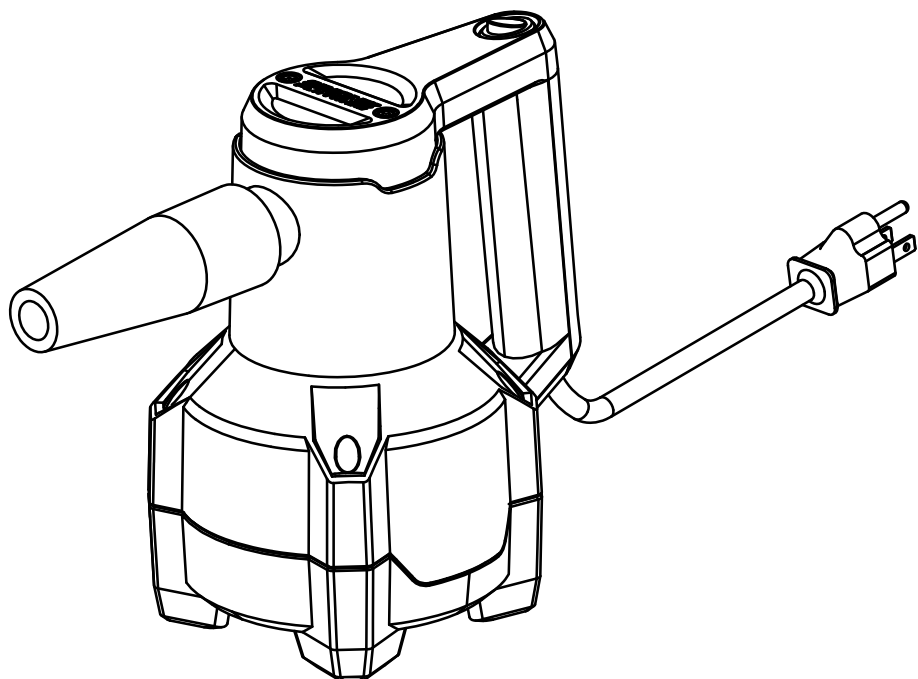

## Detail Air Blower



**Model no. 039-6567-6**

**Please read this manual carefully before using this product and save it for reference.**

**INSTRUCTION  
MANUAL**

## Detail Air Blower

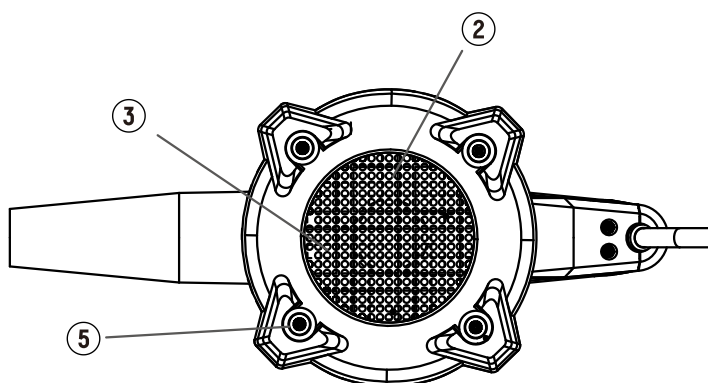
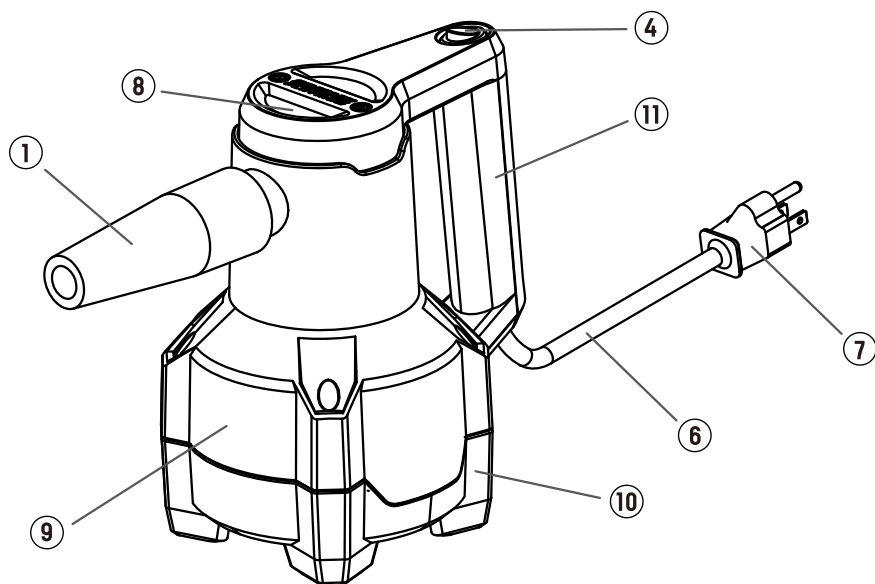

- |                |             |               |
|----------------|-------------|---------------|
| 1 Nozzle       | 2 Air Inlet | 3 Filter      |
| 4 Power Switch | 5 Feet      | 6 Power Cord  |
| 7 Power Plug   | 8 Top Body  | 9 Middle Body |
| 10 Lower Body  | 11 Handle   |               |

Model no. 039-6567-6

## WARNING

Please carefully read the manual included with this product. Misuse of the unit could cause property/equipment damage and/or personal injury.

### INSTRUCTIONS FOR USE:

1. Insert the grounded plug of the power cord (7) into a grounded three-prong outlet.

**IMPORTANT:** PRODUCT MUST BE GROUNDED

**WARNING:** IMPROPER CONNECTION OF THE EQUIPMENT

**GROUNDING CONDUCTOR CAN RESULT IN A RISK OF ELECTRIC SHOCK!**

2. Move your vehicle to a dry area of the driveway or garage to eliminate risk of electric shock. **HOLD THE BLOWER BY THE HANDLE.**

3. Operate your air blower by pushing the O/I Switch (4) up for On and down for Off.

4. Ensure Nozzle [A] is firmly connected to Nozzle [B] before use.

**DUE TO THE TREMENDOUS VELOCITY OF AIR PRODUCED BY THE AIR BLOWER, YOU MAY EXPERIENCE AIR VENTING ALONG THE BODY WHICH HELPS KEEP THE UNIT RUNNING EFFICIENTLY.**

**CAUTION:** DO NOT DROP THIS APPLIANCE. MOTOR MALFUNCTION CAUSED BY PRODUCT BEING DROPPED IS NOT COVERED UNDER WARRANTY.

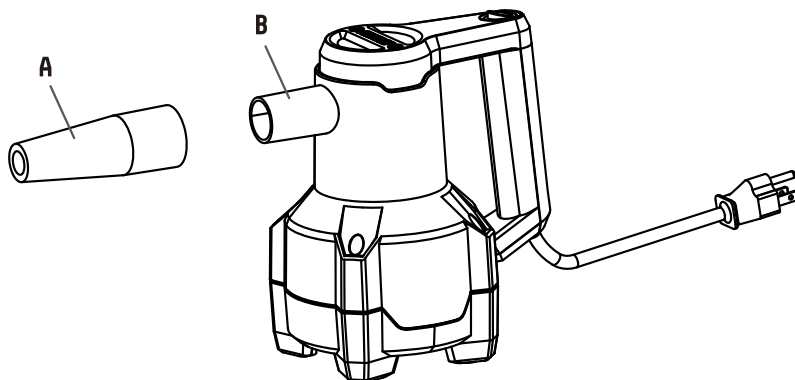

5. Air blower cannot be placed in water or on wet ground.
6. Hold the handle while the product is in use.
7. Children are not allowed to use this product.
8. Do not use this product other than for its intended use.
9. Do not disassemble the blower.
10. Before use, check that the surface of the power cable is not broken.
11. Never expose the blower to rain, frost, temperatures above 95°F (35°C) or temperatures below 32°F (0°C).
12. To ensure safety, only use accessories supplied in the box.
13. WARNING - To reduce the risk of electric shock – Do not expose to rain – Store indoors.

## IMPORTANT SAFETY INSTRUCTIONS

When using an electrical appliance, basic precautions should always be followed, including the following:

### **READ ALL INSTRUCTIONS BEFORE USING (THIS APPLIANCE)**

**WARNING** – To reduce the risk of fire, electric shock, or injury:

- a) Do not leave appliance when plugged in. Unplug from outlet when not in use and before servicing.
- b) To reduce the risk of electric shock do not expose to rain or operate on wet surfaces. Store indoors. To avoid injury disconnect the power supply before cleaning or changing accessories. Use eye protection. For household use only. Eye protection should be worn. This product can be used outdoors.
- c) Do not allow to be used as a toy. Close attention is necessary when used by or near children.
- d) Use only as described in this manual. Use only manufacturer's recommended attachments.
- e) Do not use with damaged cord or plug. If appliance is not working as it should, has been dropped, damaged, left outdoors, or dropped into water, return it to a service centre.

**Model no. 039-6567-6**

- f) Do not pull or carry by cord, use cord as a handle, close a door on cord, or pull cord around sharp edges or corners. Do not run appliance over cord. Keep cord away from heated surfaces.
- g) Do not unplug by pulling on cord. To unplug, grasp the plug, not the cord.
- h) Do not handle plug or appliance with wet hands.
- i) Do not put any object into openings. Do not use with any opening blocked; keep free of dust, lint, hair, and anything that may reduce air flow.
- j) Keep hair, loose clothing, fingers, and all parts of body away from openings and moving parts.
- k) Turn off all controls before unplugging.
- l) Use extra care when cleaning on stairs.
- m) Do not use to pick up flammable or combustible liquids, such as gasoline, or use in areas where they may be present.
- n) Connect to a properly grounded outlet only. See Grounding Instructions.

**GROUNDING INSTRUCTIONS**

This appliance must be grounded. If it should malfunction or break down, grounding provides a path of least resistance for electric current to reduce the risk of electric shock. This appliance is equipped with a cord having an equipment-grounding conductor and grounding plug. The plug must be inserted into an appropriate outlet that is properly installed and grounded in accordance with all local codes and ordinances.

**WARNING** – Improper connection of the equipment-grounding conductor can result in a risk of electric shock. Check with a qualified electrician or service person if you are in doubt as to whether the outlet is properly grounded. Do not modify the plug provided with the appliance – if it will not fit the outlet, have a proper outlet installed by a qualified electrician.

## PRODUCT INFORMATION

Product weight	3 lb 12 oz (1.7 kg) (power cord & nozzle included)
Product material	ABS
Product size	8 7/16 x 6 1/8 x 8 7/8" (215 x 155 x 226 mm)
Power cord length	7' (213.4 cm)
Product voltage	120 V AC
Product power	1000 W

### WARNING - RISK OF INJURY

During the use of this product, the air outlet temperature is about 113°F (45°C). Do not direct the air stream at the body. Do not leave the blower unattended when in use.