

model no. 039-6530-2

**SIMONIZ**®  
MD

## 6" (15.2 CM) BRUSHLESS RANDOM ORBIT POLISHER

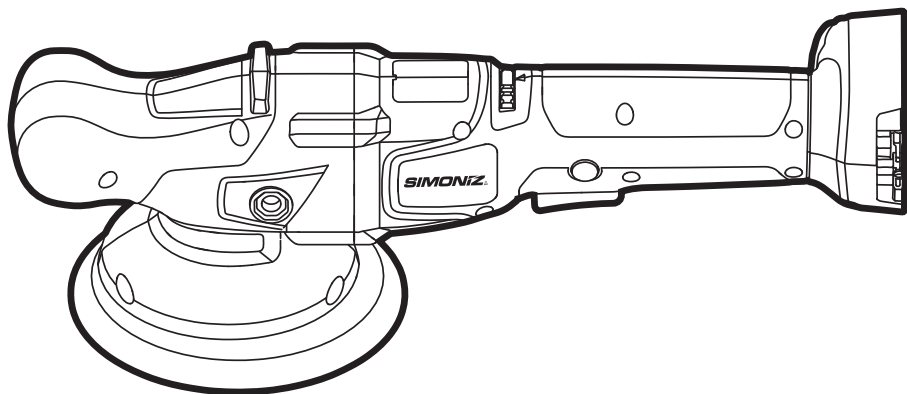

### **IMPORTANT:**

Read and understand this instruction manual thoroughly before using the product.

## **INSTRUCTION MANUAL**



**TABLE OF CONTENTS**

Technical Specifications	4
Safety Guidelines	5
Key Parts Diagram	10
Operating Instructions	11
Maintenance	14
Troubleshooting	15
Parts List	16
Warranty	18

**NOTE:**

If any parts are missing or damaged, or if you have any questions, please call our toll-free helpline at 1-866-474-6664.

**SAVE THESE INSTRUCTIONS**

- This manual contains important safety and operating instructions. Read all instructions and follow them with use of this product.

**TECHNICAL SPECIFICATIONS**

Rated Voltage	20 V d.c. max*
Pad Size	6 1/2"(16.5 cm)
Rated Speed	2300 – 3800/OPM

\*Maximum battery voltage without workload; with workload nominal voltage is 18 V.

## SAFETY GUIDELINES:



### WARNING!

Safety symbols in this Instruction Manual are used to flag possible dangers. The safety symbols and their explanations require your full understanding. The safety warnings do not, by themselves, eliminate any danger, nor are they substitutes for proper accident prevention measures.



### WARNING!

This Safety Alert Symbol indicates caution, warning, or danger. Failure to obey a safety warning can result in serious injury to yourself or others. To reduce the risk of injury, fire, or electric shock, always follow the safety precautions.

## KNOW YOUR TOOL

To operate this tool, carefully read this Instruction Manual and all labels affixed to the random orbit polisher before using. Keep this instruction manual available for future reference.

## IMPORTANT

This tool should only be serviced by a qualified service technician. For more information, call the toll-free helpline at 1-866-474-6664.

## READ ALL INSTRUCTIONS THOROUGHLY.

## SAVE THESE INSTRUCTIONS.

## GENERAL POWER TOOL SAFETY WARNINGS



### WARNING!

**Read all safety warnings, instructions, illustrations and specifications provided with this power tool.** Failure to follow all instructions listed below may result in electric shock, fire and/or serious injury.

## SAVE ALL WARNINGS AND INSTRUCTIONS FOR FUTURE REFERENCE.

The term “power tool” in the warnings refers to your mains-operated (corded) power tool or battery-operated (cordless) power tool.

## WORK AREA SAFETY

- **Keep work area clean and well lit.** Cluttered or dark areas invite accidents.
- **Do not operate power tools in explosive atmospheres, such as in the presence of flammable liquids, gases or dust.** Power tools create sparks which may ignite the dust or fumes.
- **Keep children and bystanders away while operating a power tool.** Distractions can cause you to lose control.

## ELECTRICAL SAFETY

- **Power tool plugs must match the outlet. Never modify the plug in any way. Do not use any adaptor plugs with earthed (grounded) power tools.** Unmodified plugs and matching outlets will reduce risk of electric shock.
- **Avoid body contact with earthed or grounded surfaces, such as pipes, radiators, ranges and refrigerators.** There is an increased risk of electric shock if your body is earthed or grounded.
- **Do not expose power tools to rain or wet conditions.** Water entering a power tool will increase the risk of electric shock.
- **Do not abuse the cord. Never use the cord for carrying, pulling or unplugging the power tool. Keep cord away from heat, oil, sharp edges or moving parts.** Damaged or entangled cords increase the risk of electric shock.
- **When operating a power tool outdoors, use an extension cord suitable for outdoor use.** Use of a cord suitable for outdoor use reduces the risk of electric shock.
- **If operating a power tool in a damp location is unavoidable, use a ground fault circuit interrupter (GFCI) protected supply.** Use of an GFCI reduces the risk of electric shock.

## PERSONAL SAFETY

- **Stay alert, watch what you are doing and use common sense when operating a power tool. Do not use a power tool while you are tired or under the influence of drugs, alcohol or medication.** A moment of inattention while operating power tools may result in serious personal injury.
- **Use personal protective equipment. Always wear eye protection.** Protective equipment such as a dust mask, non-skid safety shoes, hard hat or hearing protection used for appropriate conditions will reduce personal injuries.
- **Prevent unintentional starting. Ensure the switch is in the off-position before connecting to power source and/or battery pack, picking up or carrying the tool.** Carrying power tools with your finger on the switch or energising power tools that have the switch on invites accidents.
- **Remove any adjusting key or wrench before turning the power tool on.** A wrench or a key left attached to a rotating part of the power tool may result in personal injury.
- **Do not overreach. Keep proper footing and balance at all times.** This enables better control of the power tool in unexpected situations.
- **Dress properly. Do not wear loose clothing or jewellery. Keep your hair and clothing away from moving parts.** Loose clothes, jewellery or long hair can be caught in moving parts.
- **If devices are provided for the connection of dust extraction and collection facilities, ensure these are connected and properly used.** Use of dust collection can reduce dust-related hazards.
- **Do not let familiarity gained from frequent use of tools allow you to become complacent and ignore tool safety principles.** A careless action can cause severe injury within a fraction of a second.

## POWER TOOL USE AND CARE

- **Do not force the power tool. Use the correct power tool for your application.** The correct power tool will do the job better and safer at the rate for which it was designed.
- **Do not use the power tool if the switch does not turn it on and off.** Any power tool that cannot be controlled with the switch is dangerous and must be repaired.
- **Disconnect the plug from the power source and/or remove the battery pack, if detachable, from the power tool before making any adjustments, changing accessories, or storing power tools.** Such preventive safety measures reduce the risk of starting the power tool accidentally.
- **Store idle power tools out of the reach of children and do not allow persons unfamiliar with the power tool or these instructions to operate the power tool.** Power tools are dangerous in the hands of untrained users.
- **Maintain power tools and accessories. Check for misalignment or binding of moving parts, breakage of parts and any other condition that may affect the power tool's operation. If damaged, have the power tool repaired before use.** Many accidents are caused by poorly maintained power tools.
- **Keep cutting tools sharp and clean.** Properly maintained cutting tools with sharp cutting edges are less likely to bind and are easier to control.
- **Use the power tool, accessories and tool bits, etc., in accordance with these instructions, taking into account the working conditions and the work to be performed.** Use of the power tool for operations different from those intended could result in a hazardous situation.
- **Keep handles and grasping surfaces dry, clean and free from oil and grease.** Slippery handles and grasping surfaces do not allow for safe handling and control of the tool in unexpected situations.

## BATTERY TOOL USE AND CARE

- **Recharge only with the charger specified by the manufacturer.** A charger that is suitable for one type of battery pack may create a risk of fire when used with another battery pack.
- **Use power tools only with specifically designated battery packs.** Use of any other battery packs may create a risk of injury and fire.
- **When battery pack is not in use, keep it away from other metal objects, like paper clips, coins, keys, nails, screws or other small metal objects, that can make a connection from one terminal to another.** Shorting the battery terminals together may cause burns or a fire.
- **Under abusive conditions, liquid may be ejected from the battery; avoid contact. If contact accidentally occurs, flush with water. If liquid contacts eyes, additionally seek medical help.** Liquid ejected from the battery may cause irritation or burns.
- **Do not use a battery pack or tool that is damaged or modified.** Damaged or modified batteries may exhibit unpredictable behaviour resulting in fire, explosion or risk of injury.

- **Do not expose a battery pack or tool to fire or excessive temperature.** Exposure to fire or temperature above 265°F (130°C) may cause an explosion.
- **Follow all charging instructions and do not charge the battery pack or tool outside the temperature range specified in the instructions.** Charging improperly or at temperatures outside the specified range may damage the battery and increase the risk of fire.

## SERVICE

- **Have your power tool serviced by a qualified repair person using only identical replacement parts.** This will ensure that the safety of the power tool is maintained.
- **Never service damaged battery packs.** Service of battery packs should only be performed by the manufacturer or authorized service providers.

## SPECIFIC SAFETY WARNINGS FOR POLISHER

### SAFETY WARNINGS SPECIFIC FOR POLISHING OPERATIONS

- **Do not allow any loose portion of the polishing bonnet or its attachment strings to spin freely. Tuck away or trim any loose attachment strings.** Loose and spinning attachment strings can entangle your fingers or snag on the workpiece.

### ADDITIONAL SAFETY GUIDELINES FOR THE POLISHER

- **The label on your tool may include the following symbols. The symbols and their definitions are as follows:**

V ..... Volts

A ..... Amperes

Hz ..... Hertz

W ..... Watts

min ..... Minutes

 or d.c. .... Direct current

$n_0$  ..... No-load speed

.../min or  $\text{min}^{-1}$  ....Revolutions or reciprocations per minute

OPM ..... Oscillations per minute



..... WARNING – To reduce the risk of injury, user must read instruction manual.



..... WARNING – To reduce the risk of injury, always wear eye protection.



..... WARNING – To reduce the risk of injury, always wear ear protection.



**WARNING!**

To reduce the risk of electric shock or damage to the charger and battery, use only the Simoniz® and Mastercraft® batteries and chargers listed.

BRAND	BATTERY PACK	CHARGER
Mastercraft®	054-3124-0, 054-7553-4, 054-7557-6, 054-2434-8	054-3126-6, 054-7559-2
Simoniz®	5161.6, 5161.10	5320.3

- **For best results, your battery and tool should be charged, stored and used in a location where the temperature is more than 41°F (5°C) but less than 104°F (40°C).** Do not store outside or in vehicles.

**PACKAGE CONTENTS:**

Random orbit polisher, polishing pad, finishing pad, side handle, wrench and instruction manual.

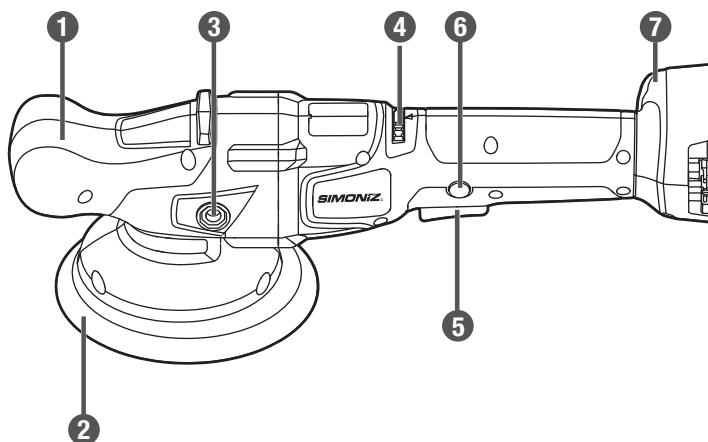
**KEY PARTS DIAGRAM**

No.	Description
1	Front handle
2	Backing plate
3	Side-handle mounting hole
4	Variable-speed dial

No.	Description
5	Variable-speed trigger switch
6	Lock-on button
7	Inlet-vent guard

**WARNING!**

- Remove the random orbit polisher from the package and examine it carefully. Do not discard the carton or any packaging material until all parts have been examined.
- If any part of the random orbit polisher is missing or damaged, do not attach the tool to a power source or use the tool until the part has been repaired or replaced. Failure to heed this warning could result in serious injury.
- Do not allow familiarity with the random orbit polisher to cause a lack of alertness. A fraction of a second of carelessness is enough to cause severe injury.

## OPERATING INSTRUCTIONS

### TO ATTACH THE BATTERY PACK (fig. 1)

1. Align the raised portion on the battery pack with the grooves on the bottom of the tool, and then slide the battery pack onto the tool.
2. Make sure that the latches on the battery pack snap into place and the battery pack is secured to the tool before beginning operation.

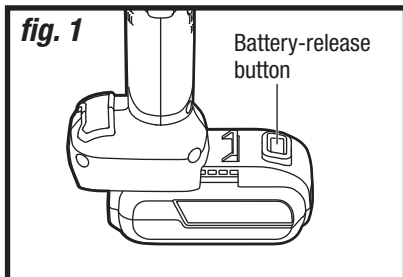

### TO DETACH THE BATTERY PACK (fig. 1)

1. Press the battery-release button to release the battery pack.
2. Pull backward on the battery pack to remove it from the tool.

### VARIABLE-SPEED TRIGGER SWITCH (fig. 2)

1. To turn the polisher on, press the variable-speed trigger switch.
2. To turn it off, release the variable-speed trigger switch.

The trigger switch delivers higher speed with increased trigger pressure and lower speed with decreased trigger pressure.

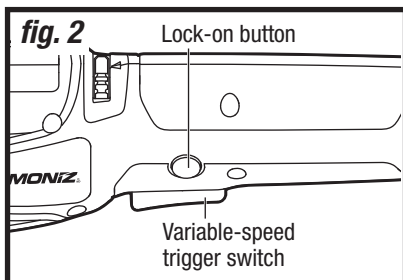

### LOCK-ON BUTTON (fig. 2)

This tool is equipped with a lock-on button, which is convenient for continuous polishing for extended periods of time.

1. To polish continuously, press and hold the trigger switch and then press the lock-on button. Release the trigger switch.
2. To unlock the lock-on button and stop continuous polishing, press the trigger switch.



#### WARNING!

- Battery tools are always in operating condition. Therefore, always remove the battery pack when the tool is not in use or when carrying the polisher at your side.

**VARIABLE-SPEED DIAL (fig. 3)**

Adjust the polishing speed with the variable-speed dial. Turn the dial to any position between “1” for the lowest speed and “5” for the highest speed.

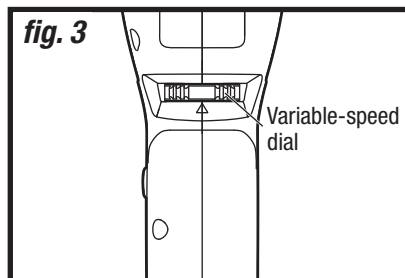
**SIDE HANDLE (fig. 4)**

The side handle may be installed on either side of the gear case. For ease of operation, position the side handle in the location that offers the best control.

1. To install the side handle, remove the battery pack, then thread the side handle into one of the side-handle mounting hole and tighten the side handle securely by turning it clockwise.
2. To remove the side handle, remove the battery pack, then loosen the side handle by turning it counter-clockwise.

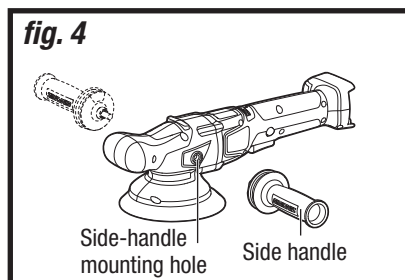
**INLET-VENT GUARD (fig. 5)**

Using the inlet-vent guard will increase the performance and extend the life of the tool.

1. To remove the inlet-vent guard, insert a flat screwdriver (not included) into the notch at the top of the inlet-vent guard, and pry it away from the tool.
2. To attach the inlet-vent guard, snap the guard into the tool's foot.

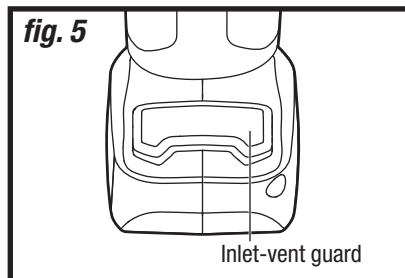

To clean the inlet-vent guard, tap it against a hard surface, or blow it clean with compressed air.

**WARNING!**

- Never change the speed while the tool is running. Failure to obey this caution could make you lose control of the tool and result in serious personal injury.
- Always wear goggles when using compressed air to clean power tools.

## INSTALL THE PAD (fig. 6)

The polisher is shipped with two pads, each designed for specific applications.

**Yellow Pad:** For removing severe oxidation, abrasions, and scratches with abrasive compounds.

**Black Pad:** Use to finish surfaces to remove swirls and apply thin coats of wax, sealants, and glazes.

1. Remove the battery from the tool.
2. Align the pad with the backing plate, and then press the fuzzy side of the pad against the plate as tightly as possible.

fig. 6

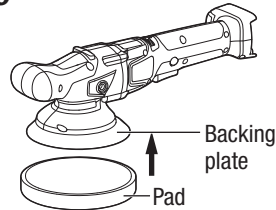

## POLISHING

1. Always use the side handle for proper control.
2. Move the polisher back and forth in long, sweeping strokes. Too much pressure, the wrong angle, or improper motion may cause swirl marks or burning.
3. For detailed polishing instructions, read the instructions provided with the finishes, waxes, and polishes.

## PREVENT BURNING THROUGH PAINT

It is easy to burn through the paint on a surface. This can occur if you polish at too high speed or if you allow the pad to stay in one spot for even a short period of time.

To prevent burning through paint, use very light pressure and keep the polisher moving constantly, especially when working near edges or where there are abrupt changes in the contour of the work surface. Be particularly careful when using higher speeds, which are more likely to burn through paint.

## PREVENT SNAGGING

Snagging occurs when polishing pads get caught on rough edges of a work surface. Snagging can cause the tool to suddenly “kick back” and it may cause the pad to burn through the paint.

To reduce the risk of snagging, use the polisher at low speeds when polishing rough surfaces. For tricky areas such as near trim or between a mirror and window on a car, do not take chances with a polisher. Polish these surfaces by hand.



### WARNING!

- Avoid snagging on rough surfaces to reduce the possibility of “kickback”.

## MAINTENANCE

### CLEANING

For safe and proper operation, always keep the tool and its ventilation slots clean. Always use only a soft, dry cloth to clean your polisher; never use detergent or alcohol.

### REMOVE/INSTALL THE BACKING PLATE (fig. 7)

1. Position the tool upside down, use the wrench to clamp the shaft connected to the backing plate, and unscrew the backing plate counter-clockwise to remove it.
2. Position the tool upside down, use the wrench to clamp the shaft, and turn the backing plate clockwise to install it and tighten securely.

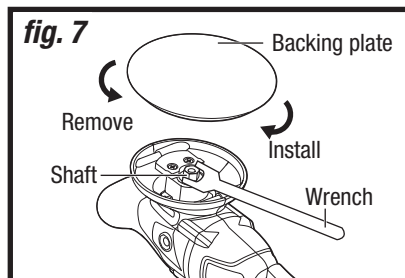

### WARNING!

- Before cleaning or performing any maintenance, remove the battery pack.
- Do not let brake fluids, gasoline, petroleum-based products, penetrating oil, etc., come into contact with plastic parts. These substances contain chemicals that can damage, weaken, or destroy plastic.
- When servicing, use only identical replacement parts. The use of any other parts may create a hazard or cause damage to the product.
- To ensure safety and reliability, all repairs should be performed by a qualified service technician.

## TROUBLESHOOTING

Problem	Possible Causes	Solution
The polisher does not start.	The battery is depleted.	Charge the battery.
	The battery is overheated.	Cool the battery and restart the tool.
	The battery is overloaded.	Decrease the load on the tool and restart the tool.
Pad can't be attached to the backing plate.	Hook-and-loop pad on backing plate is worn.	Replace with a new backing plate.
	Fuzzy side on the pad is worn.	Replace with a new pad.
Motor is overheating.	Cooling vents are obstructed.	Clean and clear vents. Do not cover vents with hand during operation.

If the problem remains unsolved after performing the checks described above, call the toll-free helpline at 1-866-474-6664.

## EXPLODED VIEW

## PARTS LIST

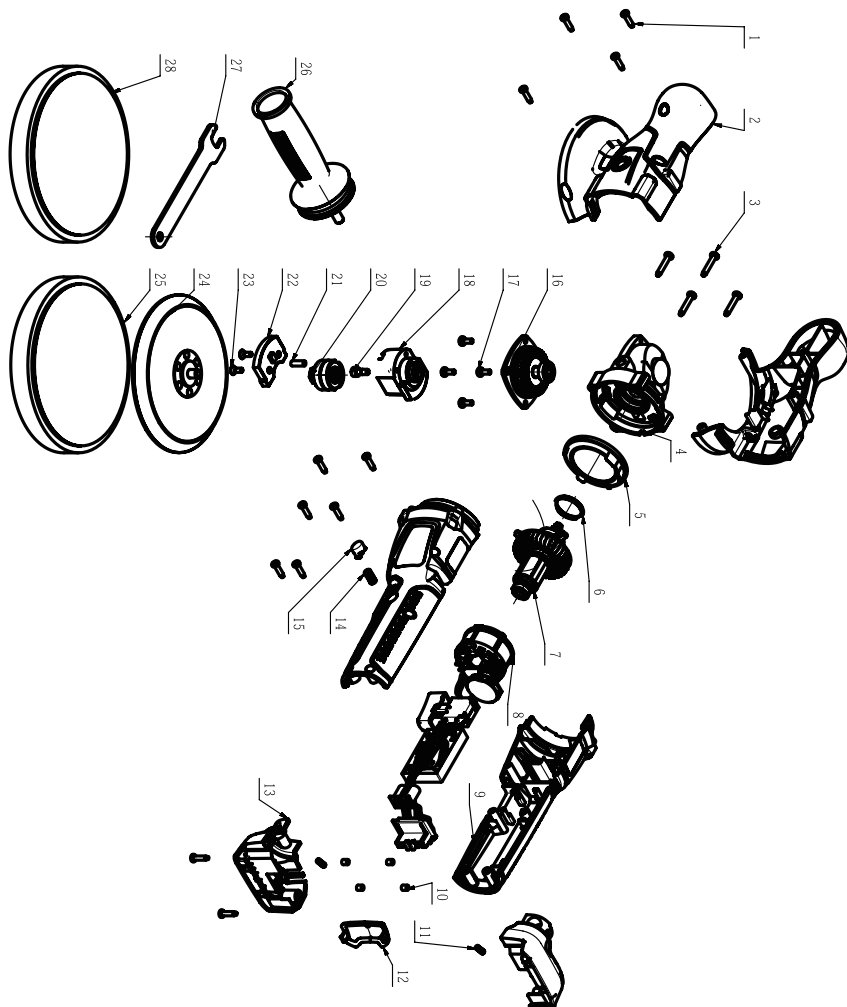



No.	Part No.	Description
1	5610290000	Tapping Screw
2	3900400000	L/R Front Housing Set
3	5610044000	Tapping Screw
4	3422711000	Gear Case
5	3125476000	Fan Baffle
6	3121601000	Rubber Ring
7	2751308000	Rotor Assembly
8	2830876000	Electric Assembly
9	3900399000	L/R Housing Set
10	3124151000	Rubber Pole
11	3660526000	Compression Spring
12	3403217000	Dust Cover
13	3900401000	Upper/Lower Housing Set
14	3660091000	Reset Spring

No.	Part No.	Description
15	3128655000	Switch Lock
16	2827358000	Output Shaft Assembly
17	5620424000	Screw
18	3422709000	Bearing Seat
19	5620018000	Hexagon Socket Screw
20	2827359000	Output Shaft Assembly
21	3130939000	Rubber Spring
22	3521243000	Counterweight
23	5620068000	Screw
24	3403179000	Base Plate
25	3810567000	Coarse Polishing Sponge
26	3323000000	Auxiliary Handle
27	5680266000	Wrench
28	3810579000	Fine Polishing Sponge

If any parts are missing or damaged, or if you have any questions, please call the toll-free helpline at 1-866-474-6664.

## 1-YEAR LIMITED WARRANTY

This Simoniz product is guaranteed for a period of **1 year from the date of original retail purchase** against defects in workmanship and materials.

Subject to the conditions and limitations described below, this product, if returned to us with proof of purchase within the stated warranty period and if covered under this warranty, will be repaired or replaced (with the same model, or one of equal value or specification), at our option. We will bear the cost of any repair or replacement and any costs of labour relating thereto.

### These warranties are subject to the following conditions and limitations:

- a) a bill of sale verifying the purchase and purchase date must be provided;
- b) this warranty will not apply to any product or part thereof which is worn or broken or which has become inoperative due to abuse, misuse, accidental damage, neglect or lack of proper installation, operation or maintenance (as outlined in the applicable owner's manual or operating instructions) or which is being used for industrial, professional, commercial or rental purposes;
- c) this warranty will not apply to normal wear and tear or to expendable parts or accessories that may be supplied with the product that are expected to become inoperative or unusable after a reasonable period of use;
- d) this warranty will not apply to routine maintenance and consumable items such as, but not limited to, fuel, lubricants, vacuum bags, blades, belts, sandpaper, bits, fluids, tune-ups or adjustments;
- e) this warranty will not apply where damage is caused by repairs made or attempted by others (i.e., persons not authorized by the manufacturer);
- f) this warranty will not apply to any product that was sold to the original purchaser as a reconditioned or refurbished product (unless otherwise specified in writing);
- g) this warranty will not apply to any product or part thereof if any part from another manufacturer is installed therein or any repairs or alterations have been made or attempted by unauthorized persons;
- h) this warranty will not apply to normal deterioration of the exterior finish, such as, but not limited to, scratches, dents, paint chips, or to any corrosion or discolouring by heat, abrasive and chemical cleaners; and
- i) this warranty will not apply to component parts sold by and identified as the product of another company, which shall be covered under the product manufacturer's warranty, if any.

### Additional Limitations

This warranty applies only to the original purchaser and may not be transferred. Neither the retailer nor the manufacturer shall be liable for any other expense, loss or damage, including, without limitation, any indirect, incidental, consequential or exemplary damages arising in connection with the sale, use or inability to use this product.

**Notice to Consumer**

This warranty gives you specific legal rights, and you may have other rights, which may vary from province to province. The provisions contained in this warranty are not intended to limit, modify, take away from, disclaim or exclude any statutory warranties set forth in any applicable provincial or federal legislation.

Made in China

Imported by

Trileaf Distribution Trifeuil Toronto, Canada M4S 2B8

