

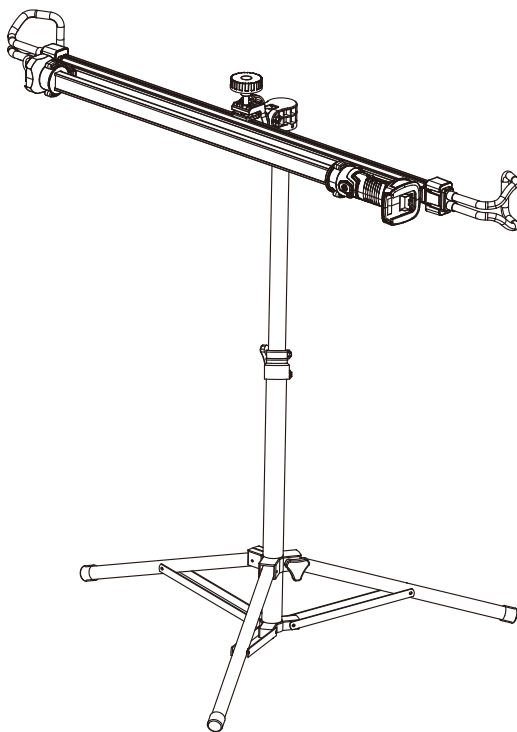

## **DUAL POWER 3-IN-1 UNDERHOOD WORKLIGHT**



model no. 037-3183-0

### **IMPORTANT:**

Please read this manual carefully before using this light and save it for reference.

**INSTRUCTION  
MANUAL**

**BEFORE YOU USE THIS DEVICE FOR THE FIRST TIME, PLEASE READ THE FOLLOWING NOTES IN THIS MANUAL AND HEED ALL WARNINGS, EVEN IF YOU ARE FAMILIAR WITH HANDLING ELECTRONIC DEVICES. KEEP THIS MANUAL IN A SAFE PLACE FOR FUTURE REFERENCE.**

### **WARNING!**

- Do not use if broken, bent, cracked or damaged parts are present. Any light that appears damaged in any way or operates abnormally must be removed from service immediately. Inspect before each use.
- This light is not to be used by children. Keep out of reach of children.
- Do not leave the light energized and unattended.
- Do not use light outdoors.
- Do not operate light in explosive atmospheres, such as in the presence of flammable liquids, gases or dust.
- Do not shine directly into eyes.
- To reduce the risk of electric shock, do not put light in water or other liquid.
- Unplug unit and allow it to cool before attempting any cleaning or maintenance.

### **CAUTION!**

- Keep AC adaptor away from heat, oil, sharp edges or moving parts. Do not unplug by pulling on the cord.
- Do not use on unstable ground when light install to the tripod.
- If the light is powered by battery pack, please use with specifically designated battery packs. Use of any other batteries may create a risk of fire.
- The light source of this product is not replaceable; when the light source reaches its end of life the whole product shall be replaced.

Your new 3-in-1 underhood worklight provides a safe and powerful light source of light when you need it. It is ideal to use during automotive repair work, roadside emergencies and home.

No.	Description	No.	Description
1	Mounting carrier	9	Locking knob
2	Carrier hooks	10	Rotating clamp
3	Carrier clips	11	Locking knob
4	LED light bar	12	Rubber cover for DC socket
5	On/off switch	13	DC socket
6	Battery bay	14	AC adaptor
7	Light bar hook	15	Tripod locking knobs
8	Folding and adjustable tripod		

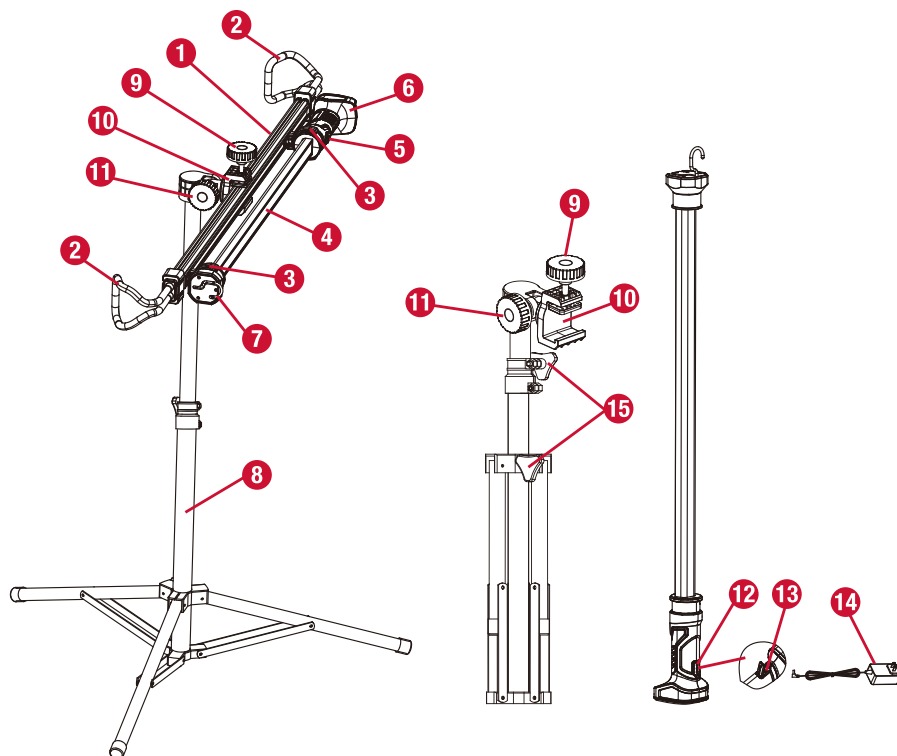

model no. 037-3183-0 | contact us 1-888-942-6686

Power requirements: 24 V, 0.75 A

Bulb type: LED

Battery type: 100% Compatible with PWR POD® Universal Battery System.

## PACKAGE CONTENTS

3-in-1 underhood worklight

AC adaptor

## ASSEMBLY

The folding and adjustable tripod extends up to 3' 11" (1.2 m) and can be quickly and easily adjusted. Your new 3-in-1 underhood worklight can be used separately or installed on the tripod depending on your needs. Tripod assembly:

- 1 Unscrew the locking knob (part 11).
- 2 Put the rotating clamp (part 10) into the middle hole.
- 3 Align the locking knob (part 11) back to the hole of the tripod and tighten the knob.

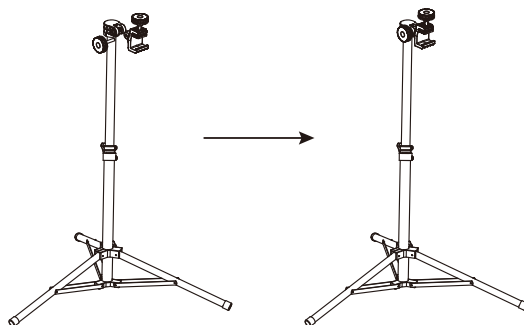

Install the light to tripod:

- 1 Unscrew the locking knob (part 9).
- 2 Put the light with mounting carrier to slot of the rotating clamp.
- 3 Align the locking knob back to the hole of the rotating clamp and tighten the knob.

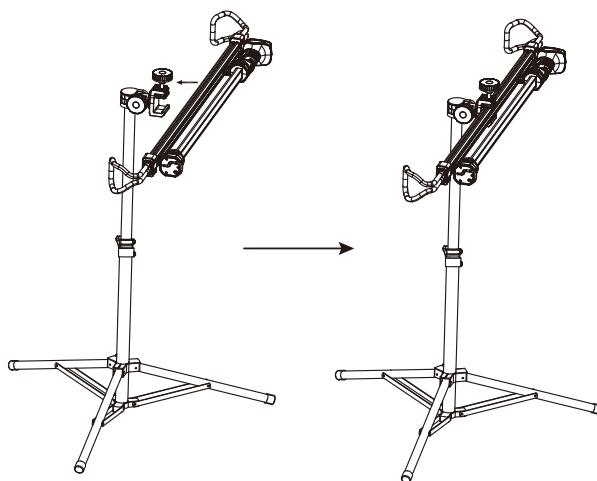

The light can also be installed onto the tripod without the mounting carrier.

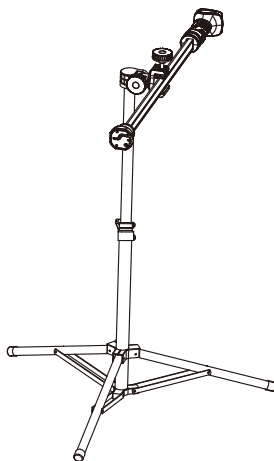

Your new 3-in-1 underhood worklight can be used with either of two power supplies:

### 1. Use with the supplied AC adaptor:

Insert the AC adaptor's jack into the DC socket (part 13) and plug the other end of the adaptor into a mains supply socket (AC power supply).

### 2. Use with specifically designated battery pack (not included):

To insert the battery pack, slide the battery pack into the battery bay (part 6). Make sure it latches securely into place.

To remove the battery pack, push in the release button and pull the battery pack away from the light.



#### **WARNING!**

Always remove the battery pack before removing accessories.

Press the on/off switch (part 5) to turn the light on or off. The switching order is: high light on, low light on, off. Select the suitable light operation mode for each application. The brightness of the light reaches 1300 lumen.

The LED light bar can be used on its own, hung using the light bar hook, or with the carrier to mount inside the hood of a car.

To mount the light to the hood of a car:

- 1** Place the mounting carrier on the hood of the car using the carrier hooks. Extend the hooks if necessary to ensure a proper fit. Make sure the carrier is fully seated on the hood.
- 2** Adjust the light bar as necessary by rotating it to the desired position and sliding it left or right along the mounting carrier.



#### **WARNING!**

Pinch hazard—keep hands out of pinch zone.

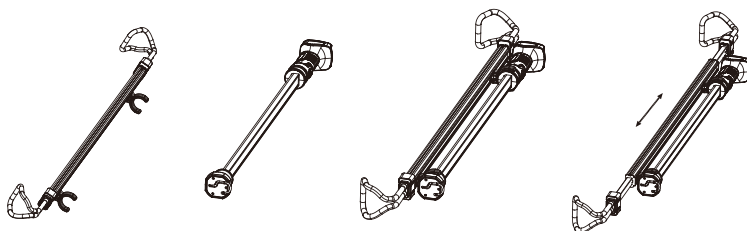

## ADJUSTING THE TRIPOD

To extend the tripod legs, loosen the tripod locking knob on the bottom of the tripod, pull the centre pole of the tripod until the legs lock in place at the bottom of tripod, then tighten the tripod locking knob.

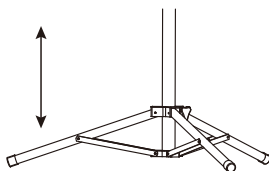

To adjust the tripod height, loosen the top tripod locking knob on the top of the tripod, adjust to the desired height, then tighten the tripod locking knob.

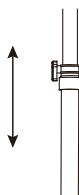

### WARNING!

Be careful of pinch points when extending the tripod legs. Place the tripod on a stable, flat surface.

To prepare for storage, loosen both tripod locking knobs and return the legs to the folded position.

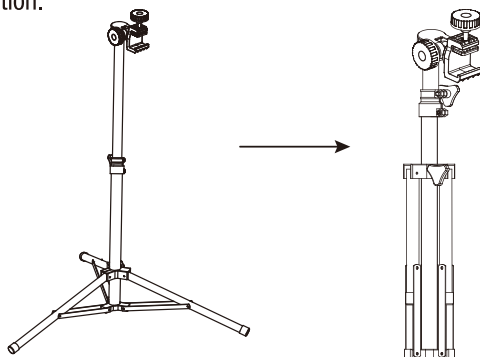

model no. 037-3183-0 | contact us 1-888-942-6686

## MAINTENANCE

Clean the cooled lens with household window cleaner, then wipe with a soft, clean, dry cloth. Clean the housing with a clean, dry cloth. Do not expose the light to direct sunlight. Dry thoroughly before use. Store the light in a dry, clean area. Avoid high humidity.

Only qualified service personnel must perform repairs. Do not open the exterior casing of the light, as there are no user-serviceable parts inside. Opening or tampering with the casing may void any guarantee and/or cause damage to the product or personal injury. LED bulbs will never wear out under normal conditions and do not need to be replaced.

## STORAGE

Store the light in a clean and dry area. Store the supplied adaptor with this product to ensure you always have the adaptor when needed. To prevent fire or burning, allow the light to cool down completely before you store it.

## ENVIRONMENTAL CONCERNS



CAN ICES-5(B)/NMB-5(B)

This product carries a three (3) year warranty against defects in workmanship and materials. MotoMaster Canada agrees to have any defective lights replaced free of charge, within the stated warranty period, when returned by the original purchaser with proof of purchase. This product is not guaranteed against wear or breakage due to misuse and/or abuse.

Made in China

Imported by MotoMaster Canada Toronto, Canada M4S 2B8