

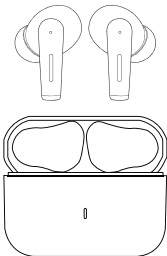

BLUEHIVE™ BLUEPODS ELITE TRUE WIRELESS EARBUDS User Manual

Model No. 035-8074-4



Key Parts Diagram

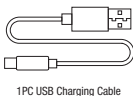
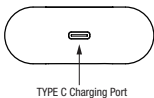
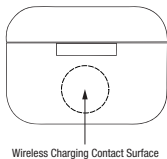
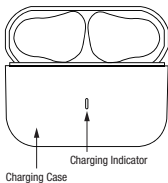
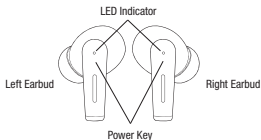

How to use



Note: Before use remove protective film from the charging connectors.



Choose the ear tips that fit your ears best.

Adjust the Earbuds to ensure the microphone is directed towards your mouth.

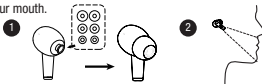

Charging You Bluepods Elite

Wipe the Earbuds with a dry cloth before charging.



Fully charge before first use.

You can charge the charging case either by using an AC adaptor (max output: 5 V, 1 A) or a PC. Alternatively, you can charge charging case wirelessly.

The charging case can charge the Earbuds 3 times when fully charged.



- White light flashes
- Orange + White light is on, both earbuds and case are being charged
- Orange light is on, the earbuds are fully charged, the case is being charged
- Steady green

Note:

Once the charging case is fully charged, remove the Type C plug from the charging case or remove from the wireless charger.

The charging case is only for charging of the Earbuds. DO NOT recharge other devices.

Do not charge continuously for more than 10 hours as this will shorten the lifespan of the product.



You can charge the charging case with a wireless charger.



Turning Your BluePods Elite On/Off

Turn On:

Method 1. Open the lid of the charging case.

Method 2. Press and hold both Earbuds for 3 seconds to power on.

Turn Off:

Method 1. Place the Earbuds into the charging case and close the lid of the charging case.

Method 2. Press and hold both Earbuds for 6 seconds to power off.

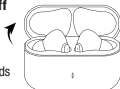

Pairing Your BluePods Elite To Your Device

Remove the Earbuds from the charging case and they will automatically pair to each other.

Open "Bluetooth® devices" on your smartphone, then find and connect "Bluehive BluePods Elite" in the Bluetooth® list on your device.



Note: If pairing is not completed within 5 minutes, the Earbuds will automatically power off. If this happens, repeat the pairing steps on previous page.



Touch Controls



X 1: Tap once
X 2: Tap 2 times
X 3: Tap 3 times
3 sec: Press and hold 3 seconds
6 sec: Press and hold 6 seconds



LED Light Indicators

Earbuds Status	LED Indication
Power on	White light flickers 3 times
Power off	White light flickers twice
Charging	Steady white
Charging completed	White light is off
In idle mode after paired	White light of left Earbud flickers quickly, white light of right Earbuds flickers once every 5 seconds
Bluetooth® paired	White light flickers once every 5 seconds

Charging Case Status	LED Indication
Earbuds are charged and case battery > 5%	White light is on
Earbuds are charged and case battery < 5%	White light flashes
Both Earbuds and case are being charged	Orange + white light is on
The Earbuds are fully charged, the case is being charged	Orange light is on
Charging completed	Steady green



Function	Voice Prompt/Audio Tone
Powering on your Earbuds	Power On
Powering off your Earbuds	Power Off
Low battery power	Battery Low
Bluetooth® Pairing	Pairing
Bluetooth® connected to device	Bluepods Elite Connected
Disconnecting from Bluetooth®	Disconnected

Specifications

Bluetooth® Specifications: V 5.2

Effective Range: Up to 32' (10 m)

Each Earbuds Battery: 40 mAh

Charger Case Battery: 300 mAh

Charging Time for Earbuds: 1 h

Charging Time for case: 2 h

Playing Time: up to 5 1/2 h (ANC ON)/7 h (ANC OFF)

Working temperature: 23°F to 113°F (-5 °C to 45 °C)

Storage temperature: -4°F to 140°F (-20 °C to 60 °C)

Usage precautions

1. Use the product for its intended purpose only.
2. Do not disassemble or throw into fire or water to avoid causing short circuit or leakage.
3. Keep away from children under the age of three. This product contains small parts which may be a choking hazard.
4. Avoid use in humid conditions or extreme temperatures. High heat will shorten lifespan of electronic components, damage battery and deform some plastic parts. Avoid extreme cold temperature as damage to the PCB board may occur.
5. Do not violently shake or crush as this can cause damage to the product and will void the warranty.
6. Do not use product while driving any vehicle as it may distract your attention. Check your local laws and regulations.
7. High volume may lead to permanent hearing damage and hearing loss. Set the volume at a reasonable setting and avoid loud volumes at all times.
8. Danger of fire, explosion and burns if the operating temperature is substantially exceeded, if the electronics housing is opened, and in case of battery short-circuit, when touching a leaking battery.

Maintenance and Care

Before using your Earbuds and charging case, examine the Earbuds to make sure that they are clean. Similarly, inspect the ports and jacks of your Earbuds and charging case to make sure that they are clear of dust and debris before charging.

Use a soft cloth or paper towel to clean your Earbuds and charging case. Do not allow moisture to get inside the Earbuds. Never use any harsh chemicals or detergents for cleaning. Make sure your Earbuds and charging case are dry before using.

When your Earbuds and charging case are not in use, they should be stored in a cool, dry place.

Never tug or yank on the USB cable while it is connected to your charging case. Connect and disconnect cables as carefully as possible.

Never expose your Earbuds and charging case to high temperatures, extreme cold, high humidity or excessive moisture or water.

The Bluetooth® word mark and logos are registered trademarks owned by Bluetooth SIG, Inc. and any use of such marks by Trileaf Distribution is under licence. Other trademarks and trade names are those of their respective owners.

This Class B digital apparatus complies with Canada ICES-003.
CAN ICES-3(B)/NMB-3(B)

IC: XXXXXXX

This device complies with Industry Canada licence-exempt RSS standard(s). Operation is subject to the following two conditions: (1) this device may not cause interference; and (2) this device must accept any interference, including interference that may cause undesired operation of the device.



Product must be recycled or disposed of properly. Dispose of as per the requirements of your local municipality.

Made in China

Imported by Trileaf Distribution Toronto, Canada M4S 2B8