



12 V Bluetooth® Receiver and USB Car Charger User manual

Model no. 035-5406-4

WARNING!

- Make sure your connected device is firmly and securely fastened.
- Follow all applicable local laws and regulations concerning the use of a mobile device.
- The USB port is not designed for transferring data. Do not connect external data storage products or any data transfer cables to the USB port.
- **DANGER!** Never let children play with packaging materials and this product. This product is not a toy! Store the product and any accessories out of the reach of children.
- Don't attempt to disassemble the unit or replace the battery.
- Do not throw device into fire.
- Keep device dry at all time.
- Avoid excessive drops, abrasions and punctures.

Key Parts Diagram

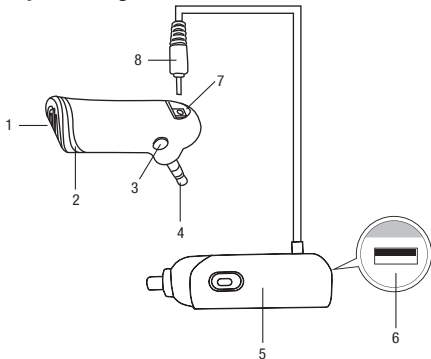

- 1 Microphone
- 2 LED indicator
- 3 Function key
- 4 3.5 mm Auxiliary Connection

- 5 12 V Plug
- 6 USB port (5 V 2.1 A)
- 7 Input port (DC 5 V)
- 8 Charging connector

LED Indicator

Bluetooth® Receiver Status	LED Indicator
Power on	Blue light flickers three times
Bluetooth® pairing	Blue and red light flickers alternatively
Low battery	Red light flickers
Charging	Red light is on
Fully charged	Red light is off
Connected	Blue light flickers

Sounds & Voice Prompt Functions

Function	Voice prompt
Powering on the receiver	Power on
Powering off the receiver	Power off
Power one and pairing	Bluetooth mode
Disconnecting from Bluetooth®	Disconnected
Bluetooth® connected	Connected
Low battery power	Please charge

Charging Bluetooth® Receiver

Important: Please fully charge the battery for the first time use. Firmly insert the Charging connector (8) into Input port (7) of Bluetooth® Receiver, Plug 12 V Plug (5) into vehicle's 12 V outlet. The red charging indicator will light up and it will turn off once fully charged. It takes 2 hours to fully charge the unit.

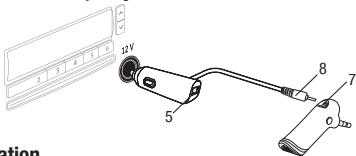

Operation

**Playback of Audio Playlists
USB Bluetooth®**

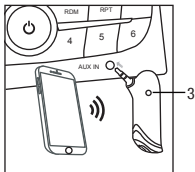



1. Plug the Bluetooth® Receiver into the 3.5 mm Auxiliary (AUX) Connection port of vehicle or other devices with AUX port.
2. Long press the function key (3) for a few seconds, blue light flickers three times and with prompt of "power on" and "Bluetooth® mode", blue and red light flickers alternatively to indicate the Bluetooth® Receiver is in pairing mode.
3. Go to the Bluetooth® settings menu on your phone / tablet / Bluetooth® devices. Make sure that Bluetooth® is turned on. Connect to the device listed as "035-5406-4". Blue light flickers and with prompt of "connected" indicates your device has been successfully connected and is ready to use.

Power off the Bluetooth® Receiver after use.

Important: Ensure the engine is turned on and the vehicle's audio system is on.

Answering, Ending and Rejecting Calls

Press Function key (3) once to answer calls.

Press Function key (3) once to end calls.

Long press Function key (3) to reject the calls.

Charging electronic devices

Insert 12 V plug (5) into the vehicle's 12 V outlet.

Connect your mobile device to USB port (6) with a charging cable (not provided).

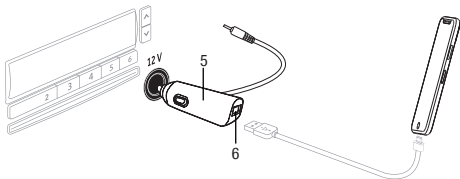

You can play music and charge your phone/tablet/Bluetooth® devices at the same time if your devices have low battery power.

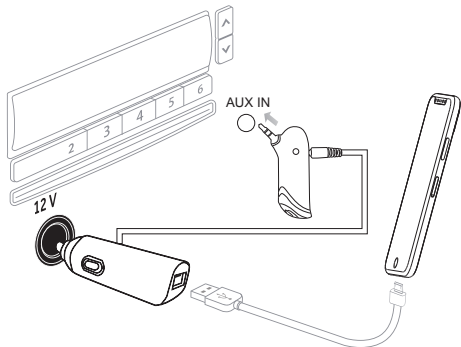

SPECIFICATIONS:

Input: DC 12 V

Battery: 90 mAH Rechargeable Battery

Effective Range: 10 m (33')

Charging time: 2 hours

Working time: 6 hours

Standby time: 8 hours

Car Charger USB output: 5 V/2.1 A



Product must be recycled or disposed of properly. Dispose of as per the requirements of your local municipality.

The Bluetooth® word mark and logos are registered trademarks owned by Bluetooth SIG, Inc. and any use of such marks by Shenzhen HS Joint Technology Co., Ltd is under licence. Other trademarks and trade names are those of their respective owners.

Made in China

Imported by Trileaf Distribution Toronto, Canada M4S 2B8