

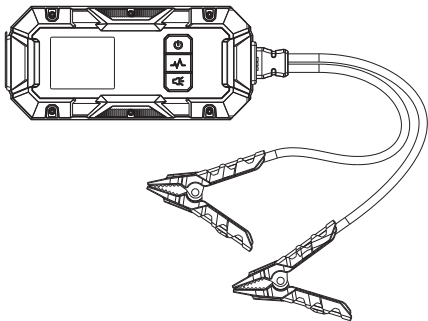

ELIMINATOR

2500A JUMP STARTER AND POWER BANK



model name: XB25

model no. 011-2096-4

IMPORTANT:

Please read this manual carefully before operating this jump starter and save it for future reference.

PRODUCT MANUAL

model no. 011-2096-4 | contact us 1-888-942-6686



Safety Instructions	3
Product Overview	6
On-Screen Information	7
Accessories	8
Before First Use	8
Charging After Each Use	8
Flashlight	9
DC Pin Outlet	9
USB-A and USB-C	10
Regular Jump Start	10
Tips for a Successful Jump Start	11
Manual Override	11
Reverse Polarity Alert	12
Warranty	12
Troubleshooting	13
Storage Instructions	13
Environmental Protection	14
Product Specifications	14

SAFETY INSTRUCTIONS

ABBREVIATIONS AND ACRONYMS

A	Amp (Ampere)
V	Volts
W	Watts
DC	Direct current
AC	Alternating current
Ah	Amp-hours
mA	Milliampere
mm	Millimetre
LED	Light emitting diode

SAVE THESE INSTRUCTIONS!

This manual contains important safety and operating instructions.
Read all instructions and follow them.

QUESTIONS? CALL CUSTOMER SERVICE 1-888-942-6686

model no. 011-2096-4 contact us 1-888-942-6686



WARNING!

- This jump starter generates a high current of up to 2500 peak amps. Read and understand all safety information before using this product. Failure to follow these safety instructions may cause ELECTRIC SHOCK, EXPLOSION, or FIRE, which may result in SERIOUS INJURY, DEATH or PROPERTY DAMAGE. This product is only compatible with 12 V lead-acid batteries. DO NOT attempt to use product with any other battery types.
- This unit is not intended to be used as a replacement vehicle battery.
- DO NOT attempt to operate a vehicle that does not have a battery installed.
- Use only the jumper cables provided with this unit. MotoMaster® is not responsible for user safety or damage when using accessories not approved by MotoMaster®.
- The cable clamps connecting the boosting cables to the vehicle's battery terminals must be positive to positive (red clamp to battery "+") and negative to negative (black clamp to battery "-").
- Do not crank the engine for more than 3 seconds at a time. The jumpstart feature is designed for short term operation only. Operating the jump start feature for more than 3 seconds may cause damage to the unit. Allow the battery booster pack to cool down for at least 3 minutes after each boost.
- Always turn the unit off when not in use.
- DO NOT use the unit to jumpstart a vehicle while charging the internal battery.
- Only charge the jump starter at ambient temperatures between 0°C and 45°C (32°F and 113°F).
- DO NOT charge the unit through the 15 V DC charging port if your vehicle's electrical system operates above 15 V. This may lead to accumulation of hydrogen, causing exposure to fire and explosion hazards.
- Ensure that there are no 12 V DC appliances connected to the jump starter while the unit is being recharged.
- DO NOT use this unit to operate appliances that need more than 12 A to operate from the 15 V DC power port.
- DO NOT insert foreign objects into either USB port or 15 V DC power port.
- This unit is not for use by children and should only be operated by adults.
- Store in a cool, dry place. DO NOT store in locations where the temperature may exceed 35°C (95°F)
- If this unit is leaking liquid, dispose of at proper recycle facility immediately.
- Product contains lithium based battery. Dispose of product according to local regulations at end of product life.

WARNING! RISK OF ELECTRIC SHOCK

- DO NOT expose product to rain, snow or use in damp conditions. NEVER submerge unit in water. Product is an electrical device that can produce shock and cause injury if used in wet environments.
- DO NOT operate the unit if it has received a sharp blow, been dropped or otherwise damaged in any way.
- DO NOT disassemble the unit; unit should only be serviced by a qualified technician. Refer to the warranty section of this manual for instructions on obtaining service. Attempting to service the unit yourself may result in a risk of electric shock or fire and will void the warranty.

WARNING! EXPLOSION HAZARD

- DO NOT operate unit near the presence of flammable/combustible liquids or gases.
- DO NOT expose unit in extreme heat, fire or incinerate.
- NEVER attempt to jump start a frozen battery.
- NEVER allow the red and black clamps to touch each other or a common piece of metal. The battery booster pack contains components that tend to produce arcs or sparks.
- Batteries generate hydrogen gas during normal operation which can be ignited by sparks from electrical connections. To prevent the risk of fire or an explosion, always operate in a well-ventilated area and follow all safety information instructions.
- Always ensure someone is nearby to help you in an emergency.

WARNING! RISK OF INJURY

- Always wear eye protection when working with batteries. Batteries can explode and cause flying debris.
- If battery acid comes into contact with eyes, flush affected area with running water immediately for at least 15 minutes and seek medical attention immediately.
- If battery acid comes into contact with skin, rinse immediately with water and wash thoroughly with soap and water. If redness, pain or irritation occurs, seek medical attention immediately.
- Be sure to remove all metal items (watches, necklaces, rings, etc.) before using the jump start system.

model no. 011-2096-4 contact us 1-888-942-6686



PRODUCT OVERVIEW

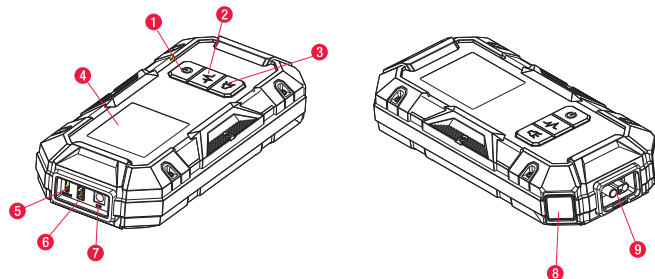

- 1 Power Button
- 2 Manual Override Button
- 3 Flashlight Button
- 4 LED Screen
- 5 USB-C In and Out Port
- 6 USB-A Out Port
- 7 DC Pin Out Port
- 8 Flashlight
- 9 Jump Start Port

ON-SCREEN INFORMATION

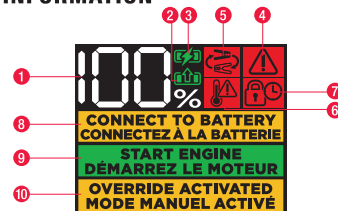

- 1 Battery Percentage:**
Shows the remaining battery percentage of the jump starter.
- 2 Output Icon:**
Icon turns on when USB or DC outputs are in use.
- 3 Charge Icon:**
Icon turns on when device is charging.
- 4 Error Icon:**
Flashes when error conditions detected (over current, short-circuit).
- 5 Reverse Polarity Icon (Error Condition):**
Icon turns on when reverse polarity at the clamps are detected.
- 6 Over/Under Temperature Icon (Error Condition):**
Icon turns on when jump starter cables are plugged in and temperature is less than -40°C (-40°F) or higher than +60°C (140°F).
- 7 Temporary Lockout Icon:**
Icon turns on if jump starter is used more than 5 times within 10 minutes. Lock out feature prevents jump starting to protect the unit. Lock out turns off / resets after 10 minutes of no use.
- 8 CONNECT TO BATTERY / CONNECTEZ À LA BATTERIE:**
Turns on when jumper cable is inserted in jump starter port and the vehicle battery connection is not detected.
- 9 START ENGINE / DÉMARREZ LE MOTEUR:**
Turns on when the jumper cable is inserted in jump starter port and correct connection to the vehicle battery is detected, or when override is activated.
- 10 OVERRIDE ACTIVATED / MODE MANUEL ACTIVÉ:**
Flashes when override is activated. override will automatically turn off after 30 seconds.

model no. 011-2096-4 contact us 1-888-942-6686



ACCESSORIES

- 1x Jumper Cable
- 1x 30W AC Adaptor
- 1x USB-C to USB-C Charging Cable
- 1x 12 V DC Adaptor
- 1x Carry Bag
- 1x User Manual

BEFORE FIRST USE

This product comes partially charged and needs to be fully charged prior to use.

CHARGING AFTER EACH USE

To prolong battery life and ensure unit is ready for use, it is recommended to charge the product immediately after each use and at least every 6 months when in storage. Charge times vary depending on the discharge level of the battery and output of charging port. It may take up to 8 hours to fully charge the unit.

When the unit is charging, the screen will display the charging icon .

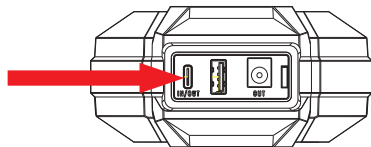

Note:

1. Improper charging may result in damage to the unit.
2. The battery level indicator will not move sequentially when the unit is charging.
3. The DC pin out and USB-A output port remain active and available for use when the unit is charging.
4. The DC pin out port is limited to 15 V, 3 A when the unit is charging.
5. Do not recharge the unit while connected to a vehicle battery.

FLASHLIGHT

This unit has a built-in multi-mode LED flashlight for convenience and emergency use. Press the button to cycle through the 4 options.

Low (white) → High (white) → SOS (red) → Off

Note:

1. The flashlight will automatically shut off after 4 hours of continuous use to avoid excessive power draw.
2. If the button is not pressed twice within 5 seconds when activating the flashlight, the next button press will turn the flashlight off.

DC PIN OUTLET

This unit is equipped with one DC outlet socket and can be used to power most 12 V accessories and appliances. To use:

1. Plug the DC cable pin into the 15 V DC power port.
2. Insert the 12 V DC plug from the appliance into the 12 V DC outlet socket on the cable.
3. Press the button to power on.
4. When the DC outlet socket is powered, the screen will display the output icon .

model no. 011-2096-4 contact us 1-888-942-6686



Important

DO NOT use this unit to operate appliances that require more than 10 A to operate from the 15 V DC pin port as this may trigger overcurrent protection and the unit will reset.

USB-A and USB-C

This unit is equipped with a PD65W USB-C port and a QC18W USB-A port with quick-charge feature. These ports are ideal for charging portable electronic devices such as smartphones, tablets and more. When the USB-A and USB-C ports are powered, the screen will display the output icon

Note:

1. Quick charge feature only compatible with Power Delivery capable devices.
2. This unit has a built-in energy saving feature that will automatically shut off the unit after 30 seconds if no load is detected or after 4 hours of continuous use.

REGULAR JUMP START

1. Plug in the jumper cable and press the button to turn on the unit.
2. The screen will display **"CONNECT TO BATTERY / CONNECTEZ A LA BATTERIE"**.
3. Connect the red clamp to the positive vehicle battery terminal, and the black clamp to the negative vehicle battery terminal.
4. When the unit detects correct connection with the vehicle battery, the screen will display **"START ENGINE / DÉMARREZ LE MOTEUR"**
5. Start the car engine.
6. Disconnect the jump starter from the vehicle battery after the engine has started successfully.
7. If jump starting is unsuccessful, wait at least 30 seconds, and then attempt to jump start again. Do not attempt more than 5 consecutive jumpstarts within a 10-minute period.

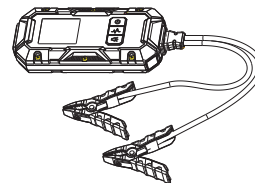

TIPS FOR A SUCCESSFUL JUMP START

1. Ensure the jump starter is stored indoors and is fully charged before each use.
2. Ensure the battery terminals are free of corrosion.
3. Ensure the clamps are connected and seated properly to the proper terminals.
4. Ensure all accessories (lights, audio, etc.) are turned off.

WARNING! EQUIPMENT DAMAGE

1. Do not crank the engine for more than 3 seconds at a time. The jump start feature is designed for short-term operation only. Operating the jump start feature for more than 3 seconds may cause damage to the unit.
2. If jump starting is unsuccessful, wait at least 30 seconds between attempts.
3. Do not attempt more than 5 consecutive jumpstarts within a 10-minute period.
4. Risk of shock, fire, combustion and burns; do not disassemble, modify, crush, heat above 60°C (140°F) or incinerate.
5. Do not attempt to jump start if the jump starter battery level is at 50% or less. Doing so lowers the chance of successfully boosting your vehicle.
6. Do not place the unit where it could fall when vehicle starts up.
7. Make sure that cables are routed away from motor fan or belts.
8. For vehicles with 12 V batteries.

MANUAL OVERRIDE

Under regular conditions, the ideal vehicle battery voltage with the engine running is between 13.7 V and 14.7 V. With the engine off, a reading of 12.6 V should be obtained. For regular jump starts, the battery that is being boosted would measure below 12.6 V. For batteries that measure significantly lower voltage (below 1.0 V), this unit has an override feature, which allows you to force "ON" the jump start function.

model no. 011-2096-4 contact us 1-888-942-6686



If the jumper cables are plugged into the jump starter and correctly attached to the battery but there is no vehicle battery detected, long press the  button for 3 seconds to activate override mode.. The screen will display **"START ENGINE / DEMARREZ LE MOTEUR"** and **"OVERRIDE ACTIVATED / MODE MANUEL ACTIVÉ"**, You may now attempt to start the car engine.

The override mode will only be active for 30 seconds. Once 30 seconds has passed, the unit will reset and another attempt will have to be made. A total of 5 attempts will be allowed before the unit will disable the manual override feature. This is to prevent excessive draining and putting strain on the unit which may damage it. If you encounter this, please seek professional help.

Important

1. When in manual override mode, all safety features will be disabled.
2. Ensure clamps are connected to the appropriate terminals before proceeding.

REVERSE POLARITY ALERT



Reverse polarity can occur when the jumper cables and the battery are connected incorrectly. When this happens, current flows in the opposite direction. This may cause damage to the battery, the jump starter, the vehicle's electrical components, and may even cause a fire hazard and potentially an explosion. When this icon lights up on the screen and an alarm sounds, this indicates that the jumper cables are connected to the battery in reverse. Before proceeding to jump start, ensure jumper cable connections are correct and follow instructions on screen.

When in reverse polarity, only the icon on the screen and the alarm will remain activated with all other functions deactivated. Once the jumper cables are connected to the proper terminals, the unit will turn on automatically.

WARRANTY

This MotoMaster® product carries a two (2) year warranty against defects in workmanship and materials. This product is not guaranteed against wear, breakage or misuse. Should this product become defective within the stated warranty period, return it to the store with proof of purchase, and it will be replaced or repaired free of charge.

TROUBLESHOOTING

Problem	Possible Cause	Solution
The engine being boosted will not start.	<ul style="list-style-type: none"> • Main power is OFF. • Vehicle battery is too low. • Unit is not fully charged. • Bad clamp connection with battery. • Vehicle battery is damaged. • Mechanical issue with vehicle. • Battery in the unit is damaged. 	<ul style="list-style-type: none"> • Press  to turn unit ON (refer to JUMP STARTING instructions). • OVERRIDE mode may need to be used (refer to JUMP STARTING instructions). • Check if unit has at least 50% charge. Recharge if necessary. • Reconnect clamps and ensure proper contact and polarity has been established. • Replace vehicle battery. • Have the vehicle serviced.
Unit will not charge.	<ul style="list-style-type: none"> • No power from USB port. • Faulty USB cable. • Power draw during recharge. 	<ul style="list-style-type: none"> • Plug in to a different USB outlet. • Replace USB cable. • Disconnect all accessories plugged into the unit and make sure all the unit functions are off.
USB power port does not work.	<ul style="list-style-type: none"> • Main power is OFF. • Unit has insufficient charge to power appliance. • Incompatible device 	<ul style="list-style-type: none"> • Press  to turn unit ON (refer to USB POWER instructions). • Check unit battery charge level. Recharge if necessary. • Check if device is compatible with this USB type/port.
LED flashlight does not work.	<ul style="list-style-type: none"> • Main power is OFF. • Unit has insufficient charge to power flashlight. 	<ul style="list-style-type: none"> • Press  to turn flashlight ON (refer to Flashlight instructions). • Check unit battery charge level. Recharge if necessary.

STORAGE INSTRUCTIONS

Please store the unit indoors when not in use.

To prolong battery life, ensure that unit is stored between -20°C and 35°C (-4°F and 95°F).

model no. 011-2096-4 contact us 1-888-942-6686



ENVIRONMENTAL PROTECTION

Do not dispose of this product in the usual household garbage at the end of its life cycle; hand it over at a collection point for the recycling of electrical and electronic appliances. The symbols on the product, the instructions for use or the packing will inform about the methods for disposal.

This product is recyclable. By recycling, material recycling or other forms of re-utilization of old appliances, you are making an important contribution toward protecting our environment.

PRODUCT SPECIFICATIONS

Internal Battery	Lithium-ion
Internal Battery Capacity	20,000 mAh/ 74 Wh
Start Current	500 A
Peak Current	2500 A
USB-C Input	PD30W (5 V 3 A, 9 V 3 A, 12 V 2.5 A, 15 V 2 A, 20 V 1.5 A)
USB-C Output	PD30W (5 V 3 A, 9 V 3 A, 12 V 2.5 A, 15 V 2 A, 20 V 1.5 A)
USB-A Output	QC18W (5 V 2 A, 9 V 2 A, 12 V 1.5 A)
DC Pin Out	15 V 10 A
Operating Temperature	-20 to 45°C (-4 to 113°F)
Charging Temperature	0 to 45°C (32 to 113°F)
Storage Temperature	-20 to 35°C (-4 to 95°F)
Dimensions	245 x 110 x 55 mm (9 5/8 x 4 5/16 x 2 3/16")
Weight	1000 g (2 lb 3 oz)