

# **CERTIFIED**™

model number 009-5211-0

## **TOP OFF TIRE INFLATOR**

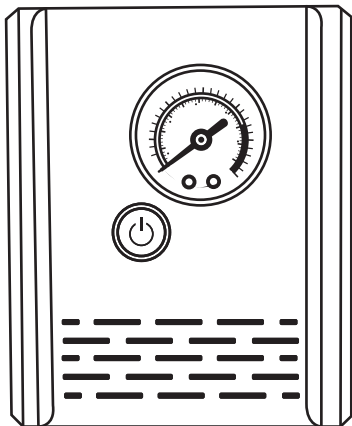

### **IMPORTANT:**

If you have questions or problems, are missing parts or require technical service, before returning to your retailer, please call our toll-free helpline: 1-844-428-7277.

**INSTRUCTION  
MANUAL**

model number 009-5211-0

## FEATURES

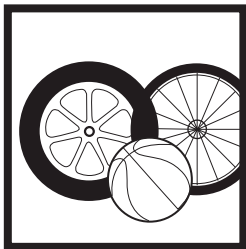

### HIGH-PRESSURE APPLICATIONS

- Car tires
- Bicycle tires
- Basketballs
- Sports equipment
- Party balloons

**WE DO NOT** recommend using this product to inflate **HIGH-VOLUME APPLICATIONS** (e.g., air mattresses, rafts), as it will be slow and could put too much stress on the unit.

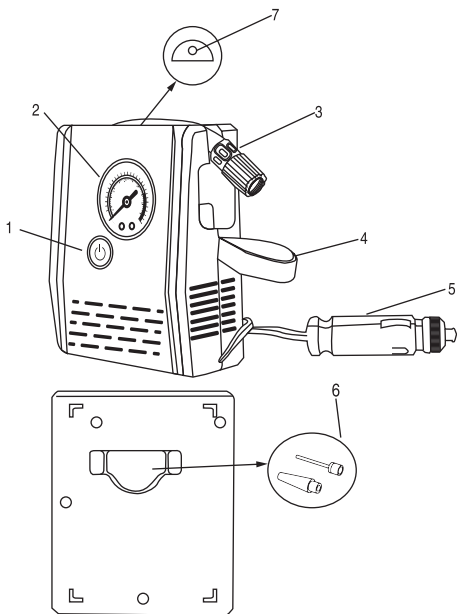

**1. Compressor button**

**3. Air hose**

**5. 12 V adaptor**

**7. LED light**

**2. Dial gauge**

**4. Cable organizer**

**6. Ball/balloon adaptors**

**WARNING**

Please carefully read the manual included with this product. Misuse of the unit could cause property/equipment damage and/or personal injury.

1. Do not overinflate products beyond manufacturer's recommendations.
2. Do not allow the compressor or its components to get wet.
3. Do not leave the air compressor unattended while in operation.
4. Do not allow children to handle or operate this compressor.
5. Do not use this product for other than its intended use.
6. Do not disassemble or tamper with this compressor.
7. Inspect air compressor before use. If cracked, broken or damaged parts are found, have them repaired or replaced by a qualified technician.
8. Never expose the air compressor to rain, frost or temperatures above 86°F (30°C) or temperatures below -22°F (-30°C).
9. This compressor must be plugged into the 12 V power outlet/socket in your vehicle only.
10. For best results it is recommended to have your vehicle running.
11. Make sure the cord is not exposed to hot objects, oil or sharp edges.
12. **WARNING!** For your own safety, you should only use accessories and parts specified in the instructions, or recommended for use by the manufacturer.
13. Your vehicle engine should be turned on and running in a open, well-ventilated area when operating air compressor.

## **OPERATION**

### **Inflating vehicle and bicycle tires**

1. Roll out the 12V cord and connect the 12V adaptor to the 12V outlet.
2. Screw the thread connection onto tire's valve stem.
3. Operate the air compressor until desired pressure is reached. Press the compressor switch to turn on the compressor and press again to turn it off.
4. Remove the thread connection from the tire and disconnect the 12V car adaptor.

### **Inflating sporting equipment (e.g., basketball) or party balloons**

1. Roll out the 12V cord and connect the 12V adaptor to the vehicle's 12V outlet.
2. Screw the ball/balloon adaptor into the thread connection.
3. Insert the ball/balloon adaptor into the valve of the object to be inflated.
4. Operate the air compressor until the desired pressure is reached. Press the button switch to turn on the compressor and press again to turn it off.
5. Remove the ball/balloon adaptor from the inflated object's valve and unscrew ball/balloon adaptor from the thread connector. Put the ball/balloon adaptor back in the storage compartment.
6. Disconnect the 12V car adaptor from the outlet.
7. Note: if a pressure reading is required during inflation, the built-in pressure gauge will provide an approximate reading only.

## **CAUTION**



To avoid overinflation of tires, please check the recommended car tire pressure in the vehicle owner's manual or on the vehicle placard located in the driver's door panel.  
For bicycle tires, please check the tire marking.

model number 009-5211-0

## FUSE REPLACEMENT

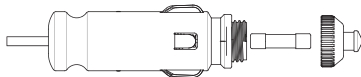

10 A 250 V

1. To replace the fuse in the plug, twist off the upper cover.
2. Remove the faulty fuse and insert a new one.
3. Twist the upper cover back on the plug.

## SPECIFICATION

Model No.#: 009-5211-0

Working Voltage: DC 12 V

Max. Pressure: 80 PSI

Fuse: 10 A

Accessories: 2 adaptors, 1 spare fuse

### CAUTION



Do not overinflate objects. Overinflation could cause damage and/or personal injury. Do not leave inflator unattended during use. Allow inflator to cool for 10 minutes after 10 minutes of continuous operation. Read instructions before use.

## ENVIRONMENTAL PROTECTION



Do not dispose of this product in household garbage at the end of its life cycle; hand it over at a collection point for the recycling of electrical and electronic appliances. The symbols on the product, the instructions for use, or the packaging will inform about methods for disposal.

The materials are recyclable. By recycling, material recycling or other forms of re-utilization of old appliances, you are making an important contribution to protection of the environment.

This Certified product carries a one (1) year warranty against defects in workmanship and materials. At its discretion, Trileaf Distribution agrees to have any defective part(s) repaired or replaced free of charge, within the stated warranty period, when returned by the original purchaser with proof of purchase. This product is not guaranteed against wear or breakage due to misuse and/or abuse.

Made in China

Imported by Trileaf Distribution Trifeuil Toronto,  
Canada M4S 2B8