

model no. 009-5097-2

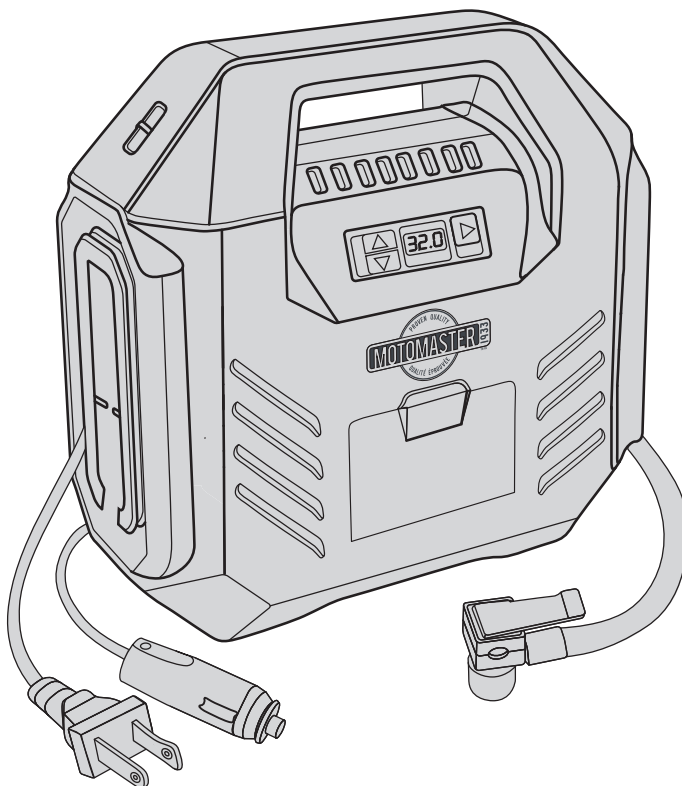

## **DUAL POWER AIR COMPRESSOR**



### **IMPORTANT:**

*Please read this manual carefully before using this tool and keep it for future reference.*

**INSTRUCTION  
MANUAL**

model no. 009-5097-2 | contact us 1-888-942-6686

**IF ANY PARTS ARE MISSING OR DAMAGED, OR IF YOU HAVE ANY QUESTIONS, PLEASE CALL OUR TOLL-FREE HELPLINE AT 1-888-942-6686**



Read and understand this instruction manual thoroughly before using the product. It contains important information for your safety as well as operating and maintenance advice.

Keep this instruction manual for future use. Should this product be passed on to a third party, this instruction manual must be included.



**Intertek**  
3184655



This MotoMaster® product carries a three-year warranty against defects in workmanship and materials. At its discretion, MotoMaster Canada agrees to have any defective part(s) repaired or replaced free of charge, within the stated warranty period, when returned by the original purchaser with proof of purchase. This product is not guaranteed against wear or breakage due to misuse and/or abuse.



## TABLE OF CONTENTS

<b>Specifications</b>	<b>4</b>
<b>Safety</b>	<b>5</b>
<i>Introduction</i>	5
<i>Safety</i>	6
<i>Danger</i>	6
<i>Warning</i>	7
<i>Caution</i>	8
<b>Know Your Air Compressor</b>	<b>9</b>
<i>Preparation</i>	9
<b>Key Parts Diagram</b>	<b>11</b>
<b>Parts List</b>	<b>12</b>
<b>Operation</b>	<b>13</b>
<i>Operation - 12 V DC Mode</i>	13
<i>Operation - 120 V AC Mode</i>	16
<b>Maintenance</b>	<b>19</b>
<i>Cleaning and Storage</i>	19
<b>Troubleshooting</b>	<b>20</b>

## SAVE THESE INSTRUCTIONS

This manual contains important safety and operating instructions. Read all instructions and follow them while using this product.

*model no. 009-5097-2 / contact us 1-888-942-6686*

## **SPECIFICATIONS**

<i>MODEL</i>	<i>009-5097-2</i>
<i>VOLTAGE/HERTZ/PHASE/CURRENT</i>	<i>120/60/1/1.5 A</i>
<i>MAXIMUM WORKING PRESSURE</i>	<i>120 PSI</i>
<i>VOLTAGE DC</i>	<i>12 V</i>
<i>POWER REQUIREMENT DC</i>	<i>12 V (For use with 12 V DC power outlet only)</i>

### **NOTE:**

*This unit is equipped with fuse protection.*

*If at some point the air compressor fails to operate when using the 12 V DC power method, check the fuse in the end of the 12 V plug. To replace the fuse, simply unscrew the 12 V power plug tip, remove the existing fuse, install the new fuse and reassemble the power plug tip. Use only an AGC – 10 A replacement fuse.*



## INTRODUCTION

This air compressor is designed to inflate the tires of cars, bikes, ATVs, sports equipment and other small inflatable items. Carefully read and understand all of the safety, operation, maintenance and troubleshooting information contained within this Instruction Manual for safe, efficient and trouble-free operation.

This manual contains information that relates to PROTECTING PERSONAL SAFETY and PREVENTING EQUIPMENT PROBLEMS. It is very important to read this manual carefully and understand it thoroughly before using the product.

The symbols listed below are used to indicate this information.



### **DANGER!**

*Potential hazard that will result in serious injury or loss of life.*



### **WARNING!**

*Potential hazard that could result in serious injury or loss of life.*



### **CAUTION!**

*Potential hazard that may result in moderate injury or damage to equipment.*

## **NOTE:**

*The word "Note" is used to inform the reader of something that he/she needs to know about the tool.*

## **SAFETY**

- The warnings, cautions and instructions discussed in this instruction manual may not cover all possible conditions and situations that may occur during operation. Always use common sense and pay attention while using/operating the product.
- Use the air compressor for the purpose for which it is intended. **DO NOT use it for any purpose it is not designed to perform.**
- Read and understand all instructions before using this product. Keep this manual for the safety warnings and precautions, operating, inspection and maintenance instructions. When using the product, basic precautions should always be followed to reduce the risk of personal injury and/or damage to the equipment. Note that when this manual refers to a part number, it refers to the parts list included. Before allowing others to use this product, make sure they are aware of all safety information.

## **DANGER**

- **Keep children away from the work area.** Do not allow bystanders and visitors to handle the product. Distractions may cause you to lose control.
- **DO NOT use the power tool in an explosive atmosphere** or in the presence of flammable liquids, gases or dust. Sparks that are created during use may ignite gases.
- For best results and more efficient power, it is recommended that you **operate the air compressor with your vehicle's engine running.**
- **Always operate the air compressor in an open, well-ventilated area** and not inside a confined area such as a garage, as doing so may lead to bodily injury or asphyxiation resulting in death.
- **Always allow for proper ventilation.** Most vehicles' 12 V power outlets will operate with the vehicle ignition off; however, some vehicles require that the ignition be turned on.



## WARNING

- **DO NOT allow unskilled or untrained individuals to operate the power tool.**
- This air compressor operates on DC 12 V and AC 120 V. **DO NOT attempt to operate this air compressor with any other source or voltage.** DO NOT rewire or reconfigure the air compressor from its original design, as doing so may lead to personal injury or bodily harm.
- **Wear suitable protective equipment** like gloves, hard hat, ANSI-approved earplugs, electrically non-conductive clothes and non-skid footwear when working.
- Ensure that your vehicle's 12 V power outlet is free of any ash residue or debris. **A dirty 12 V power outlet can cause the air compressor and power cord to overheat.** Overheating can cause damage to your air compressor/ vehicle and could cause bodily harm or injury. Disconnect power when not in use.
- **Risk of eye injury:** Wear safety glasses with side shields when operating the tool and verify that others in the work area are also wearing safety glasses. Safety glasses must conform to American National Standards Institute (ANSI Z87.1) requirements and must provide protection from flying particles from the front and the sides.
- **Inhalation risk:** Wear a full face shield if your work creates metal filings or wood chips. Wear an ANSI-approved dust mask or respirator when working around metal, wood, and chemical dusts and mists.

*model no. 009-5097-2 / contact us 1-888-942-6686*

### **CAUTION**

- **Do not wear watches, rings, bracelets or loose clothing** when using the tool. These can get caught in the moving parts, resulting in damage to the tool and/or serious injury.
- **Maintain proper footing at all times in order to ensure correct balance.**
- **Do not overload the tool.** Allow the tool to operate at its optimum speed for maximum efficiency.
- Do not use a tool that is leaking, with missing or damaged parts, or that requires repairs. **Verify that all screws are securely tightened.**
- **Keep your work area clean and ventilated.** Cluttered benches and dark areas increase the possibility of personal injury or property damage.
- **Allow air compressor to cool down** for 10 minutes, after each 10 minutes of continuous operation.
- **After using the air compressor, turn off the power supply.**
- **The air compressor is not a toy. Handle it with caution.**
- **DO NOT carry the air compressor by the air hose or power cord, as doing so may lead to damage.**
- **DO NOT leave the air compressor unattended while in operation.**
- **DO NOT overinflate.** Please follow the manufacturer's instructions for the item you are inflating.
- **DO NOT operate the air compressor in wet or damp areas.**
- **Operate the air compressor only with the attachments and accessories that are included.**
- **This air compressor is not designed to fill air tanks or air shocks.**





## PREPARATION

- The vehicle's 12 V battery should be fully charged to get the best performance from your air compressor. If your vehicle's battery is weak, the air compressor will not work at its maximum output level.
- This appliance has a polarized plug (one blade is wider than the other), which fits in a polarized outlet only one way. If the plug does not fit fully in the outlet, reverse the plug. If it still does not fit, contact a qualified electrician to install the proper outlet. Do not change the plug in any way.
- Operate in a safe work environment. Keep your work area clean and well lit. **DO NOT** expose the air compressor to rain or any other kind of bad weather. **DO NOT** use in damp or wet locations and **DO NOT** expose this tool to rain. Water entering a power tool will increase the risk of electric shock. **DO NOT** use in the presence of flammable gases or liquids.
- Use only a two-wire extension cord that has a two-blade plug and a two-slot receptacle that will accept the plug on the product. Make sure your extension cord is in good condition. When using an extension cord, be sure to use one heavy enough to carry the current your product will draw. For lengths less than 6' (1.8 m) 18 AWG extension cords should be used. An undersized cord will cause a drop in line voltage resulting in loss of power and overheating.
- In a double-insulated product, two systems of insulation are provided instead of grounding. No grounding means is provided on a double-insulated product, nor should a means for grounding be added to the product. Servicing of a double-insulated product requires extreme care and knowledge of the system and should be done only by a qualified electrician. Replacement parts for a double-insulated product must be identical to those parts in the product.

A double-insulated product is marked with the words “Double insulation” or “Double insulated.” The double-insulation symbol may also be marked on the product.

- Store unused equipment. When not in use, tools must be stored in a dry location to prevent rust. ALWAYS keep the tools out of the reach of children.

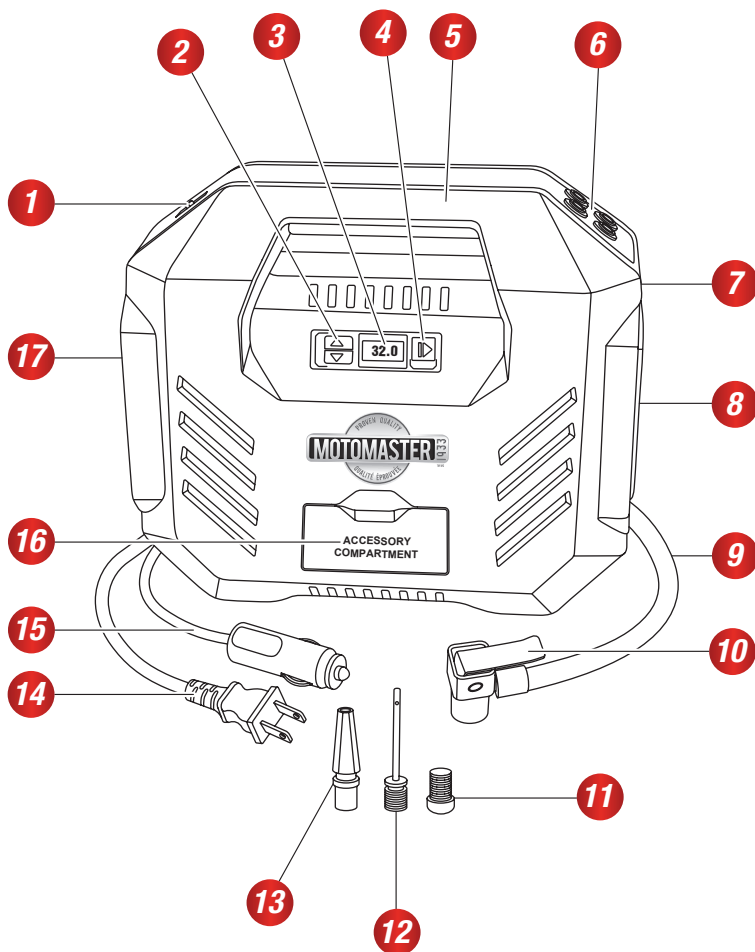

*model no. 009-5097-2 / contact us 1-888-942-6686*

## **PARTS LIST**

<b>No.</b>	<b>Description</b>	<b>Qty</b>	<b>No.</b>	<b>Description</b>	<b>Qty</b>
1	Power selector switch	1	10	Quick-connect valve adaptor	1
2	Increase/decrease preset PSI level button	1	11	Presta valve adaptor	1
3	Digital pressure gauge	1	12	Sports needle	1
4	Run/pause power switch	1	13	Mattress nozzle	1
5	Carrying handle	1	14	120 V AC power cord	1
6	Tire valve cap storage	4	15	12 V DC power cord	1
7	12 V DC power cord storage	1	16	Accessory compartment	1
8	Air hose storage	1	17	120 V AC power cord storage	1
9	Air hose	1			

If any parts are missing or damaged, or if you have any questions, please call 1-888-942-6686.

## OPERATION - 12 V DC MODE

- 1** Place the air compressor on a flat and stable surface.
- 2** Insert the 12 V DC power cord (1) into 12 V DC power outlet (2) for automatic continuous supply of 12 V current to the air compressor (*fig. A*).
- 3** Connect the quick-connect valve adaptor (1) to the item that you are inflating, and push the valve lock lever down to secure the connection (*fig. B*).
- 4** Push the power selector switch (1) in the top left corner of the air compressor to the 12 V position (*fig. C*).

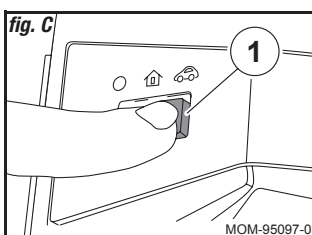
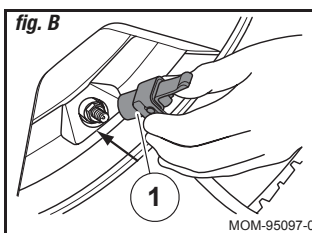
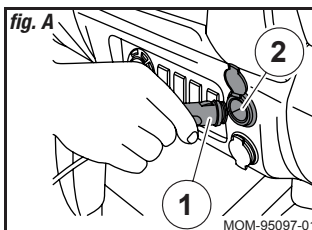

### CAUTION!

Do not overinflate the item being inflated. Failure to comply could lead to moderate injury or damage to the equipment.

model no. 009-5097-2 / contact us 1-888-942-6686

- 5 The digital pressure gauge displays the current pressure of the item you are inflating. The LCD reading (1) will be static when the LCD readout screen is displaying the current PSI (fig. D).

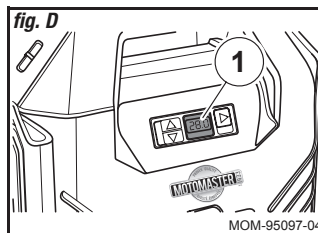

- 6 Press the button (1) on the digital pressure gauge to set the desired PSI. The preset range of the digital pressure gauge is between 3 and 120 PSI. When the LCD readout screen is displaying the target PSI, the LCD readout will blink three times at the desired preset level, and it will then change back to the current PSI level of the item that you are inflating (fig. E).

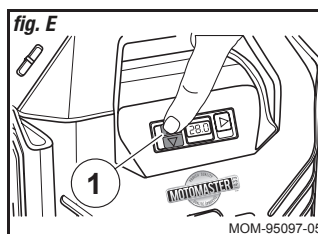

### NOTE:

If the current pressure of the item you are inflating is greater than the preset level, the inflator will not turn on.

- 7** Press the run/pause button (1) to turn on the air compressor. The preset PSI level can be changed during inflation, by pressing the buttons to the new desired PSI level. The air compressor will shut off automatically at the desired preset PSI level that you have programmed into the digital pressure gauge (*fig. F*).

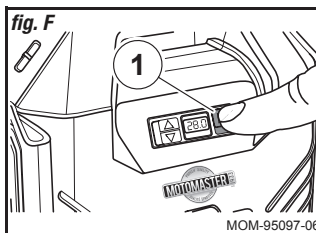

- 8** To stop the air compressor before it reaches the preset PSI level, push the run/pause button (1). To resume inflation, simply press the run/pause button again (*fig. G*).

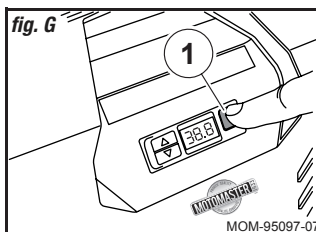
**NOTE:**

Disconnecting the inflator from the 12 V DC power outlet will clear the previous preset PSI setting.

**NOTE:**

The inflator has a tolerance of + or - 2 PSI and will automatically shut off accordingly.

**OPERATION - 120 V AC  
MODE**

- ➊ Place the air compressor on a flat and stable surface.
- ➋ Insert the 120 V AC power cord (1) into a grounded 120 V AC outlet (2) for automatic continuous power supply of 120 V current to the air compressor (*fig. H*).
- ➌ Connect the quick-connect valve adaptor (1) to the item that you are inflating, and push the valve lock lever down to secure the connection (*fig. I*).
- ➍ Push the power selector switch (1) in the top left corner of the air compressor to the 120 V position (*fig. J*).

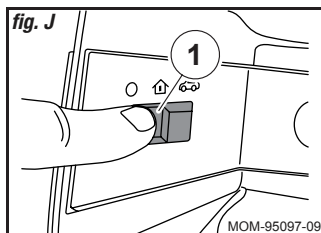
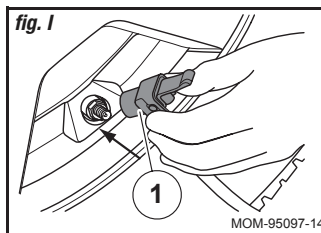
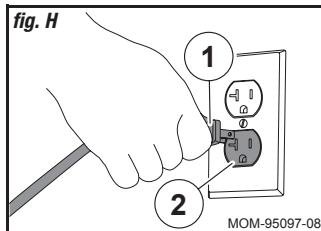



- 5 The digital pressure gauge will display the current pressure of the item you are inflating. The LCD reading (1) will be static when the LCD readout screen is displaying the current PSI (*fig. K*).

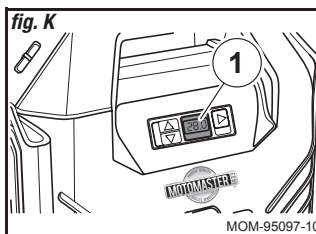

- 6 Press the button (1) on the digital pressure gauge to set the desired PSI. The preset range of the digital pressure gauge is between 3 and 120 PSI. When the LCD readout screen is displaying the target PSI, the LCD readout will blink three times at the desired preset level, and it will then change back to the current PSI level of the item that you are inflating (*fig. L*).

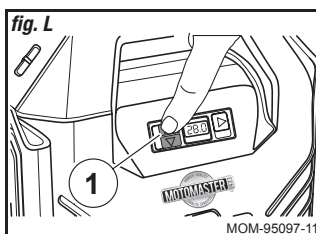
**NOTE:**

If the current pressure of the item you are inflating is greater than the preset level, the inflator will not turn on.

- 7** To turn the air compressor on, push the run/pause button (1). The preset PSI level can be changed during inflation by pressing the buttons to the new desired PSI level. The air compressor will shut off automatically at the desired preset PSI level that you have programmed into the digital pressure gauge (*fig. M*).

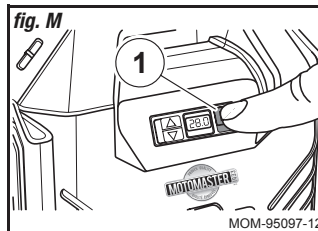

- 8** To stop the air compressor before it reaches the preset PSI level, push the run/pause button (1). To resume inflation, simply press the run/pause button again (*fig. N*).

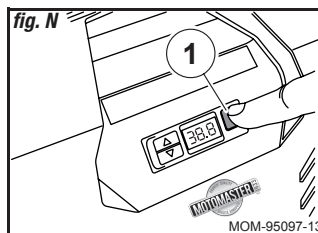
**NOTE:**

The air compressor has a tolerance of + or - 2 PSI and will automatically shut off accordingly.

**NOTE:**

Disconnecting the air compressor from the 120 V AC outlet will clear the previous preset PSI setting.



## CLEANING AND STORAGE

- Turn the power selector switch to “Off” position and unplug the cord.
- Wipe the plastic parts clean using mild soap and warm water. DO NOT allow moisture or water to get into the interior moving parts.
- Unplug the cord and disconnect from the power supply when the tool is not in use and store the unused tool to prevent rust.
- The tool should be stored in a clean and dry environment.
- ALWAYS keep the tool out of the reach of children.



### **CAUTION!**

*ALWAYS keep the tool out of the reach of children.*

*model no. 009-5097-2 / contact us 1-888-942-6686*

The following chart lists common operating issues and solutions. Please read it carefully and follow all instructions closely.

<b><i>Problem</i></b>	<b><i>Possible Causes</i></b>	<b><i>Solutions</i></b>
Unit does not start.	<ol style="list-style-type: none"> <li>1. Preset pressure setting is below the actual pressure of the item that you are inflating.</li> <li>2. Cord is not plugged in.</li> <li>3. Circuit breaker is tripped.</li> <li>4. Fuse in 12 V DC power cord is blown.</li> </ol>	<ol style="list-style-type: none"> <li>1. Adjust the preset pressure setting to higher pressure.</li> <li>2. Plug into a working 120 V AC or 12 V DC power outlet.</li> <li>3. Reset circuit breaker.</li> <li>4. Replace the 10 A fuse in 12 V DC power cord.</li> </ol>

### ***DISPOSING OF THE TOOL***

If the tool is damaged beyond repair, do not throw it out. Bring it to the appropriate recycling facility.



#### ***WARNING!***

*If any of the above symptoms appear while the tool is in use, turn it off and disconnect it from the power supply immediately. Failure to heed this warning will result in serious personal injury.*

#### ***NOTE:***

*For further information, please call 1-888-942-6686.*