

Model no. 009-5067-4

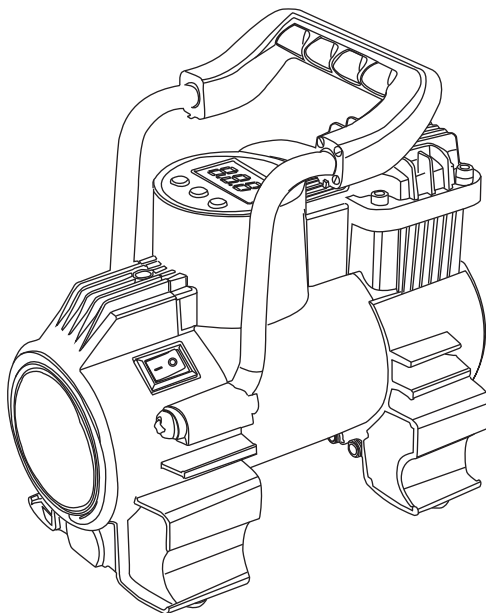

Programmable Direct Drive Air Compressor



IMPORTANT:

Questions, problems, missing parts or for technical service? Before returning to your retailer, call our customer service department at 1-888-942-6686.

INSTRUCTION MANUAL

Model no. 009-5067-4 / Contact us 1-888-942-6686

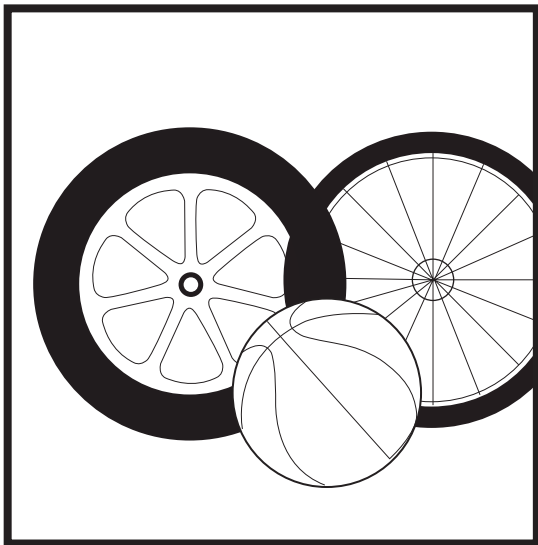

HIGH-PRESSURE APPLICATIONS

- Car tires
- Bicycle tires
- Basketballs
- Sporting equipment
- Party balloons

FEATURES

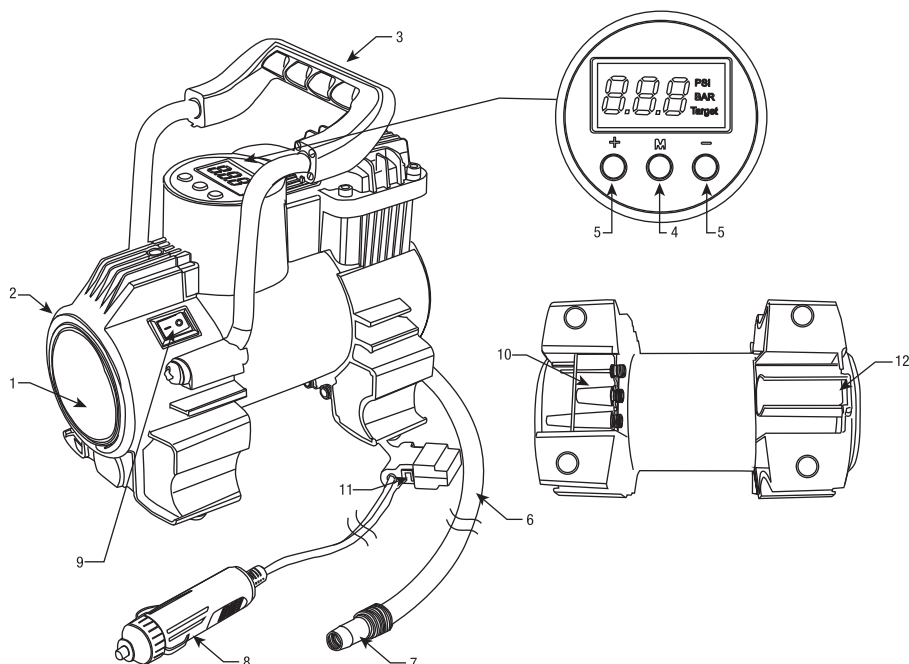

- | | | | |
|---|------------------------------|---|--------------------------|
| ① | LED Light | ② | Led Light Button |
| ③ | Carry Handle | ④ | PSI/Bar Switch 'M' |
| ⑤ | Pressure Setting Buttons +/- | ⑥ | Air Hose |
| ⑦ | Thread Connection | ⑧ | 12 Volt Plug |
| ⑨ | Compressor Button | ⑩ | Ball/Balloon Adaptors |
| ⑪ | Fuse | ⑫ | 12 V Adaptor Compartment |

WARNING

Please carefully read the manual included with this product. Misuse of the unit could cause property/equipment damage and/or personal injury.

- ❶ Do not overinflate products beyond manufacturer's recommendations.
- ❷ Do not allow the compressor or its components to get wet.
- ❸ Do not leave the air compressor unattended while in operation.
- ❹ Do not allow children to handle or operate this compressor.
- ❺ Do not use this product for other than its intended use.
- ❻ Do not disassemble or tamper with this compressor.
- ❼ Inspect air compressor before use. If cracked, broken or damaged parts are found, have them repaired or replaced by a qualified technician.
- ❽ Never expose the air compressor to rain, frost or temperatures above 30°C (86°F) or temperatures below -30°C (-22°F).
- ❾ Never use on people or animals.
- ❿ Make sure the cord is not exposed to hot objects, oil or sharp edges.
- ⓫  **WARNING!** For your own safety, you should only use accessories and parts specified in the instructions, or recommended for use by the manufacturer.
- ⓬ Your vehicle engine should be turned on and running when operating air compressor.
- ⓭ Make sure the air compressor used in an open, well-ventilated area.

OPERATION

This product is equipped with an auto shut-off digital pressure gauge. The digital gauge can be used to monitor air pressure when inflating your desired objects, and will automatically shut off the compressor once pre-set desired pressure is reached.

Pressure Pre-set

The pre-set pressure is factory set at 0 PSI when manufactured. When the pre-set pressure setting is set to 0, the compressor cannot shut off automatically. When the desired pressure is reached, turn the compressor button to off manually.

- ① Press pressure setting buttons '+' or '-' to check the pre-set pressure. When the gauge shows "Target", then the setting showing on the gauge is the pre-set pressure.
- ② Adjust to your desired pressure by pressing the pressure setting buttons '+/-'. Press button '+' to increase the pressure and press button '-' to decrease the pressure. Once the desired pressure is reached, stop pressing the buttons. The display will return to 0 PSI automatically. That means the pressure is preset successfully. The product is ready for inflating.
- ③ In the process of inflating, the pre-set pressure can not be adjusted.

Inflating tires

- ① Roll out the 12 V cord and connect the 12 V adaptor to the 12 V outlet.
- ② Adjust to your desired pressure (refer to Pressure Pre-Set).
- ③ Screw the thread connection onto tire's valve stem.
- ④ Press the compressor button and compressor will begin to inflate.
- ⑤ Press LED light button for visibility in the dark. Press again to turn it off.
- ⑥ When the tire's pressure reaches the pre-set pressure, the air compressor will stop automatically.
- ⑦ Remove the thread connection from the tire and disconnect the 12 V car adaptor.

Inflating sports equipment and/or small inflatables

- ① Roll out the 12 V cord and connect the 12 V adaptor to the 12 V outlet.
- ② Adjust to your desired pressure (refer to Pressure Pre-Set).
- ③ Screw the ball/ballon adaptors into the thread connection.
- ④ Insert the adaptors into valve of object to be inflated.
- ⑤ Press the compressor button and compressor will begin to inflate.
- ⑥ Press working light button for visibility in the dark. Press again to turn it off.
- ⑦ When the pre-set pressure is reached, the air compressor will stop automatically.
- ⑧ Remove the adaptors from the inflated object's valve and unscrew the adaptors from the thread connection. Put the adaptors back into the storage compartment.

⚠ IMPORTANT

1. The product records the previous pre-set pressure. For example, if your pre-set pressure is set at 35 PSI, the product records the pre-set pressure at 35 PSI for the next time.
2. Before reaching the pre-set pressure, the compressor can be shut off manually by pressing the compressor button.
3. When the compressor shuts off automatically, turn the compressor button to off, then restart the unit if needed.

FUSE REPLACEMENT

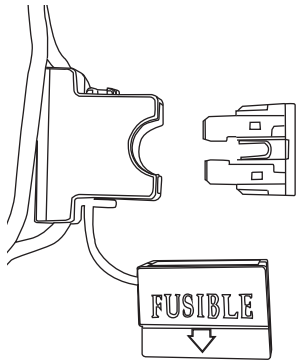

- 1 To replace the fuse on the cable, open the cap.
- 2 Remove the faulty fuse and insert a new one.
- 3 Close the cap.

SPECIFICATIONS

SKU#: 009-5067-4

Working Voltage: 12 V DC

Max. Pressure: 120 PSI

Fuse: 15 A

Accessories: ball/ballon adaptors, 1 spare fuse.

CAUTION

Allow compressor to cool for 10 minutes after 10 minutes of continuous operation.

ENVIRONMENTAL PROTECTION



Do not dispose of this product with household garbage at the end of its life cycle; hand it over at a collection point for the recycling of electrical and electronic appliances. The symbols on the product, the instructions for use or the packing will provide information about methods for disposal.

The materials are recyclable as mentioned in its marking. By recycling, material recycling or other forms of re-utilization of old appliances, you are making an important contribution to protect our environment.

Made in China

Imported by MotoMaster Canada Toronto, Canada M4S 2B8

This MotoMaster product carries a one (1) year warranty against defects in workmanship and materials. This product is not guaranteed against wear, breakage or misuse. Should this product become defective within the stated warranty period, return it to the store with proof of purchase, and it will be replaced or repaired free of charge.