

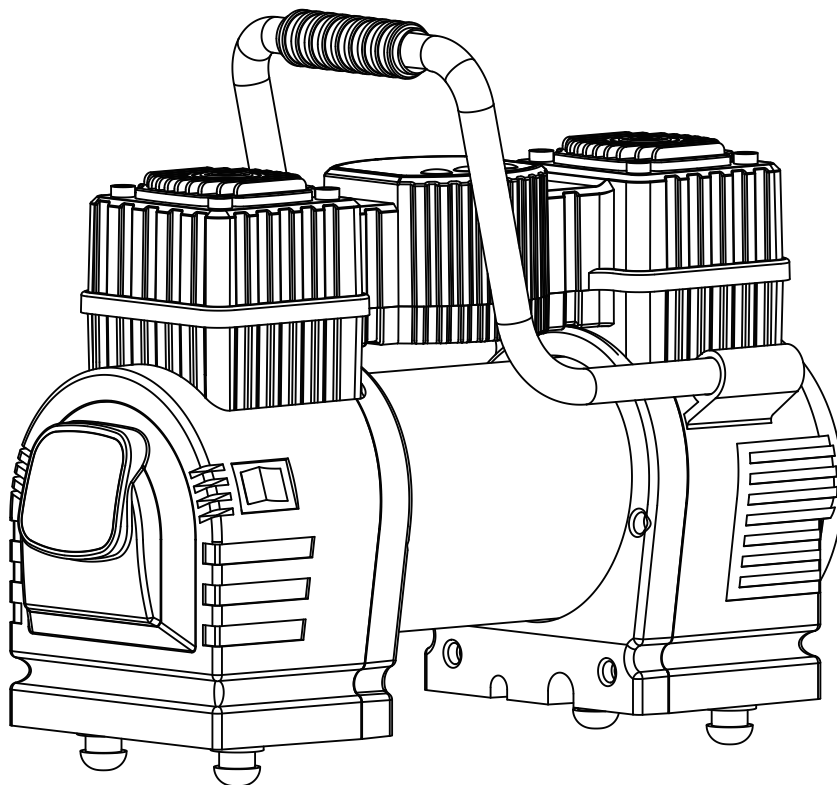

ELIMINATOR

HEAVY-DUTY TIRE INFLATOR



Model no. 009-5032-6

IMPORTANT:

Questions, problems, missing parts or for technical service? Before returning to your retailer, call our customer service department at 1-888-942-6686.

INSTRUCTION MANUAL

HIGH-PRESSURE APPLICATIONS

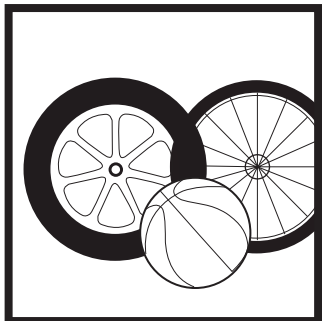

- Car tires/truck tires
- Bicycle tires
- Basketball
- Sporting equipment
- Party balloons

FEATURES

- 1 LED light
- 2 Light switch
- 3 Compressor switch
- 4 Carry handle
- 5 Pre-set button (for auto shut-off)
- 6 Pressure setting buttons '▲'/'▼'
- 7 Rubber air hose

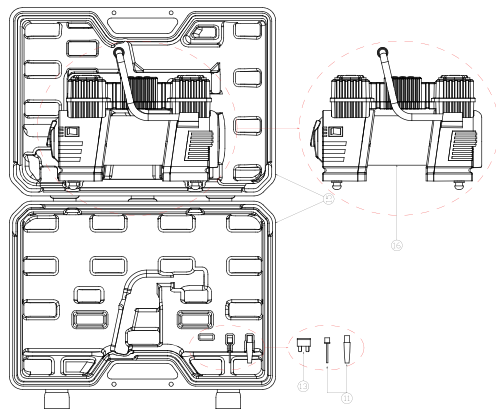
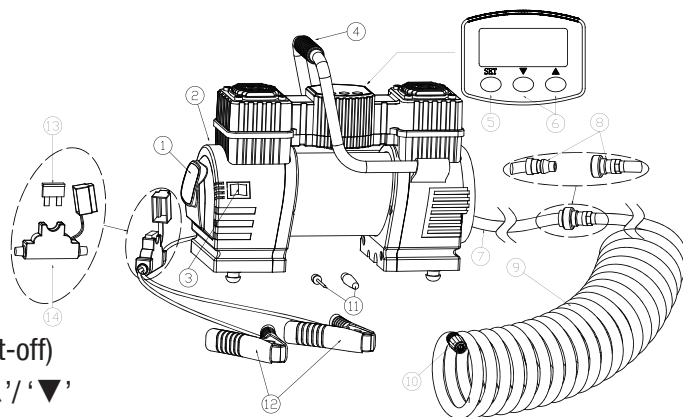

- 8 Quick-connect coupler
- 9 Coiled air hose
- 10 Screw-on valve
- 11 Ball/balloon adaptors
- 12 Battery clip
- 13 Fuse
- 14 Fuse compartment
- 15 Carry case

WARNING

Please carefully read the manual included with this product. Misuse of the unit could cause property/equipment damage and/or personal injury.

- 1 Do not overinflate products beyond manufacturers' recommendations.
- 2 Do not allow the compressor or its components to get wet.
- 3 Do not leave the air compressor unattended while in operation.
- 4 Do not allow children to handle or operate this compressor.
- 5 Do not use this product for other than its intended use.
- 6 Do not disassemble or tamper with this compressor.
- 7 Inspect air compressor before use. If cracked, broken or damaged parts are found, qualified technicians should repair damaged parts.
- 8 Never expose the air compressor to rain, frost or temperatures above 30°C (86°F) or temperatures below -30°C (-22°F).
- 9 Never use on people or animals.
- 10 Make sure the cord is not exposed to hot objects, oil or sharp edges.
- 11 **WARNING!** For your own safety, you should only use accessories and parts specified in the instructions, or recommended for use by the manufacturer.

OPERATION

This product is equipped with a Programmable Digital Pressure Gauge. The digital gauge can be used to monitor air pressure when inflating your desired objects and can automatically shut off once pre-set desired pressure is reached.

Pressure Pre-set

The pre-set pressure is factory set at 45 PSI when manufactured.

- 1 Press button 'set' for 3 seconds to check the pre-set pressure. The pre-set pressure is set at 45 PSI when manufactured.
- 2 Adjust your desired pressure by pressing button '▲'/'▼'. Press button '▲' to increase the pressure gauge and press button '▼' to decrease the pressure gauge. Once the desired pressure is reached, the displayed figure will flicker for several times, then return to 0.0 PSI. That means the pressure is pre-set successfully. The product is ready for inflating.
- 3 Press button 'set' to display pressure in PSI/BAR.

NOTE

Don't pre-set pressure during operating, otherwise it will stop operating.
Always start your vehicle engine when operating the compressor.

Inflating tires

- 1 Connect the coiled air hose to the compressor by pulling back on the quick-connect coupler collar and inserting this on valve located on the end of rubber air hose. Push in firmly and pull the quick-connect coupler back until you hear a click to lock the coiled air hose in place.
- 2 Connect the 12 V power cord clips to your vehicle battery by connecting the red positive (+) clip to the vehicle's positive battery terminal first. Next connect the black negative (-) clip to vehicle's negative battery terminal.
- 3 Adjust to your desired pressure (refer to Pressure Pre-set).
- 4 Connect the screw-on valve connector to tire air valve by twisting clockwise until it is securely attached to the tire air valve.
- 5 Move the compressor switch to 'I' position and the compressor will begin to operate. The compressor will automatically shut off once the pre-set pressure is reached.
- 6 Move the light switch to 'I' position for visibility in the dark. Move the light switch to 'O' position to turn light off.
- 7 To remove the air hose from your tire air valve, twist the screw-on valve connector counter-clockwise.
- 8 Remove the 12 V power cord clips from the vehicle's battery terminals.
- 9 Remove the coiled air hose from the compressor by pulling back on the quick-connect collar and pulling away from the valve located on the end of rubber air hose.
- 10 Return 12 V compressor to the carry case.

Inflating sports equipment and/or small inflatables

- 1 Connect the coiled air hose to the compressor by pulling back on the quick-connect coupler collar and inserting this on valve located on the end of rubber air hose. Push in firmly and pull the quick-connect coupler back until you hear a click to lock the coiled air hose in place.
- 2 Connect the 12 V power cord clips to your vehicle battery by connecting the red positive (+) clip to the vehicle's positive battery terminal first. Next connect the black negative (-) clip to vehicle's negative battery terminal.
- 3 Screw the ball/balloon adaptor into the thread connection.
- 4 Adjust to your desired pressure (refer to Pressure Pre-set).
- 5 Insert the ball/balloon adaptor into valve of the object to be inflated.
- 6 Move the compressor switch to 'I' position and the compressor will begin to operate. The compressor will automatically shut off once the pre-set pressure is reached.
- 7 Move the light switch to 'I' position for visibility in the dark. Move the light switch to 'O' position to turn light off.
- 8 To remove the air hose from your tire air valve, twist the screw-on valve connector counter-clockwise.
- 9 Remove the 12 V power cord clips from the vehicle's battery terminals.
- 10 Remove the coiled air hose from the compressor by pulling back on the quick-connect collar and pulling away from the valve located on the end of rubber air hose.
- 11 Return 12 V compressor to the carry case.

TECHNICAL SPECIFICATIONS

SKU#: 009-5032-6

Working Voltage: 12 V DC

Max. Pressure: 120 PSI

Fuse: 30 A

Accessories: 2 adaptors, 1 spare fuse

**IMPORTANT**

1. The product records latest pre-set pressure. For example, if your pre-set pressure gauge is 45 PSI, the product records the pre-set pressure at 45 PSI the next time.
2. Before reaching desired pressure, the compressor can be shut off manually by moving the compressor switch to 'O' position.

**CAUTION**

Allow compressor to cool for 10 minutes after 10 minutes of continuous operation.

ENVIRONMENTAL PROTECTION

Do not dispose of this product in the usual household garbage at the end of its life cycle: bring to a collection point for recycling of electrical and electronic appliances. The symbol on the product, the instructions for use or the packing will inform about the methods for disposal.

The materials are recyclable as mentioned in its marking. By recycling, material recycling or other forms of re-utilization of old appliances, you are making an important contribution to protect our environment.

This MotoMaster product carries a one-(1)-year warranty against defects in workmanship and materials. This product is not guaranteed against wear, breakage or misuse. Should this product become defective within the stated warranty period, return it to the store with proof of purchase, and it will be replaced or repaired free of charge.

Made in China

**Imported by MotoMaster Canada Toronto,
Canada M4S 2B8**